

02 TECHNICAL PROPOSAL

Wisal ALDbais & Husssein ALBayati

01 PROJECT ABJECTIONS :

Address Community Need & Aspirations

The Park, is being designed as a unique , iconic and site responsive multipurpose, multi-generational facility that aims to complement the existing uses and facilities, a central social hub empower the community by having them involved in the making process .

Community Park aims to enhance the existing community indoor and outdoor by the creation of a significant outdoor civic gathering space for passive community use and programmed special , festival events and public gatherings To design for the current community demand and their future needs through a strategic plan aims :

- To provide a diverse range of accessible recreational opportunities and associated facilities for a broad range of ages, abilities and interests.
- To improve multi-use recreational facilities and services through ongoing public / private partnerships
- To encourage and support volunteer participation in a range of recreational activities to provide economic development and fund
- To promote youth involvement in recreational and social activities and events
- To adhere to sustainability principles in the delivery of recreational facilities, activities and events
- To develop, manage and maintain recreational facilities to best practice standards in a cost effective and sustainable manner



02 DESIGN VISION :

Address Community Need & Aspirations

Design as a whole can be broken into two main categories. There is usability, how the park is used by skaters, and functionality, how the park is used by the broader public and skaters when they're not physically rolling around the facility.

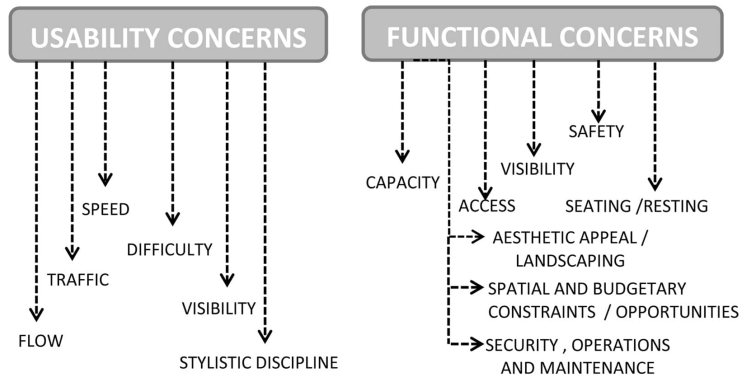

A complex that brings together multiple different types of programs in order to create skating , waiting and social place .

CREATING A COMMUNITY INSPIRED DESIGN

The consultation process is an integral component of the development of a youth precinct and skate space. In order to ensure the success and longevity of these key community assets it is essential to engage with the future users of the space.

Through the community working group the consultation process aims to empower youth and their communities to take stewardship of and pride in their public spaces.

There is a certain type of landscape where people just feel good, without realizing the reason for that. A place which has something more to offer. A feeling, a sensation, a perfect harmony.

↓
experience of a place

Parallel to the idea of creating an open public space arises the thought of making the most of the site. Instead of being divided into several structures

↓
A grid cell

Is a type of neuron in the brains of many species that allows them to understand their position in space.

↓
Modular grid system

We based the overall landscape framework on a modular grid system. From softscape, to paving, to outdoor furniture and installation, landscape elements are arranged on this modular system so that they are easy to construct, assemble, and replace.

Chaos Versus Order

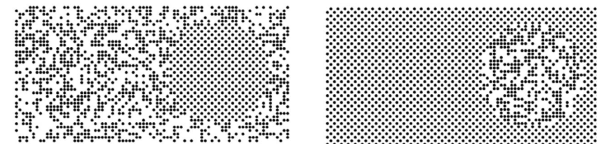

03 CONCEPTUAL PROGRESSION

Gathering Information From Respondents
Extracting Social Events Based on Timeline

Space-time maps are shown the fluidity of users through and around the park over the course of the day and days of the week, and these maps are documented where people spend time ,their movement and behavior through the space

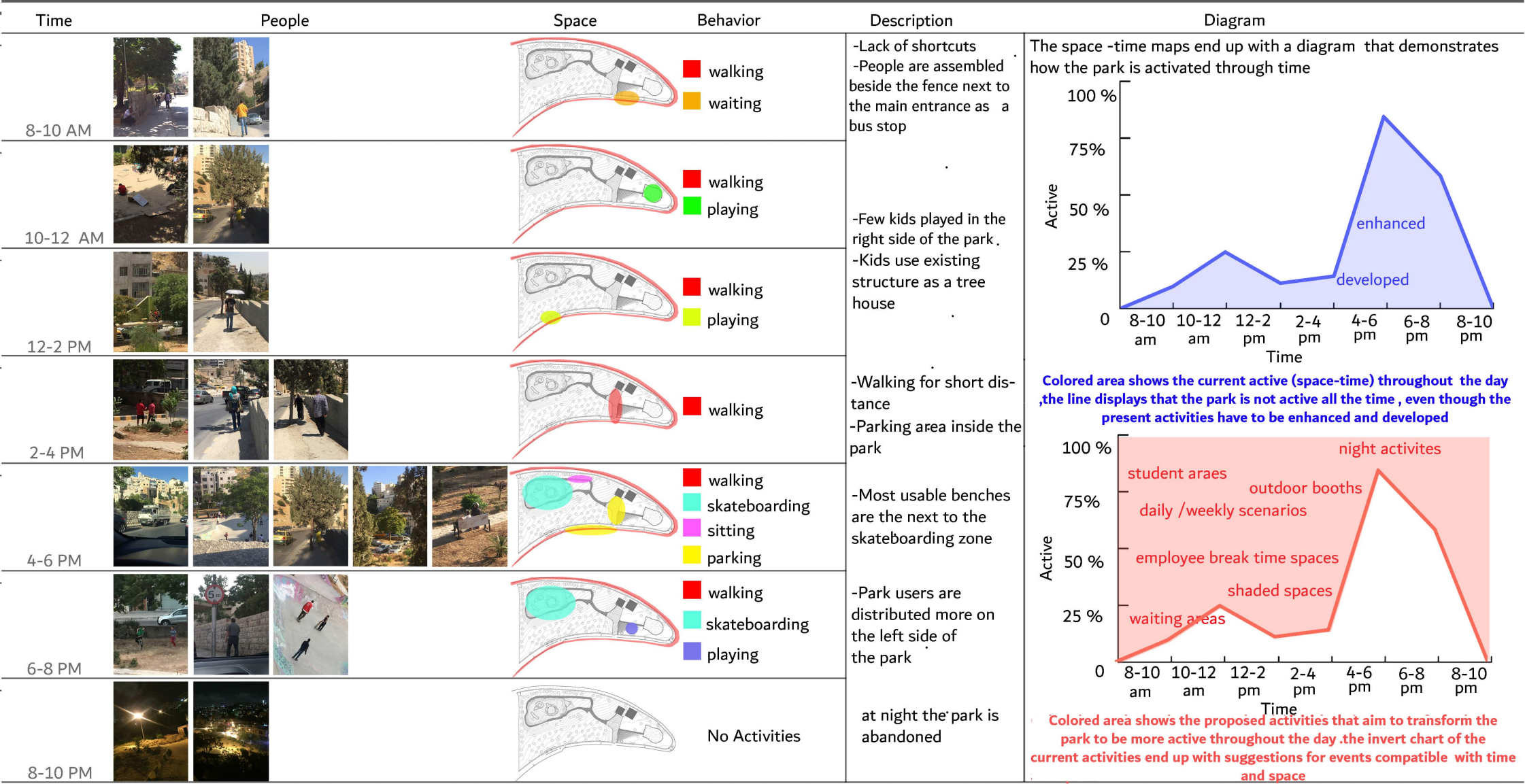

03 CONCEPTUAL PROGRESSION

The park is formed based on informations that have collected,observed and suggested .each idea has a major transformation on the existing conditions

1-Site Today



For now , the park is used as skateboarding zone in the first place,and other activities

4-Accessibility & Connectivity

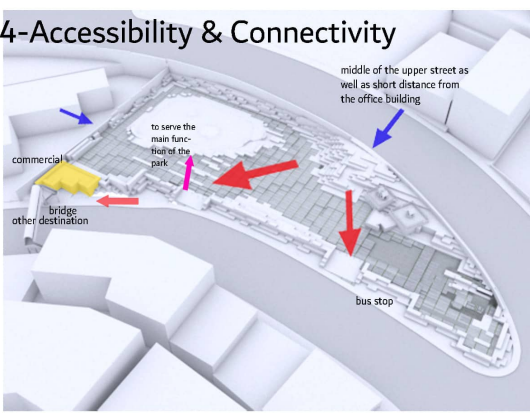

a fully accessible paths optimize the park, linking important corners and ensuring connections to the neighboring through the site

7-Passersby

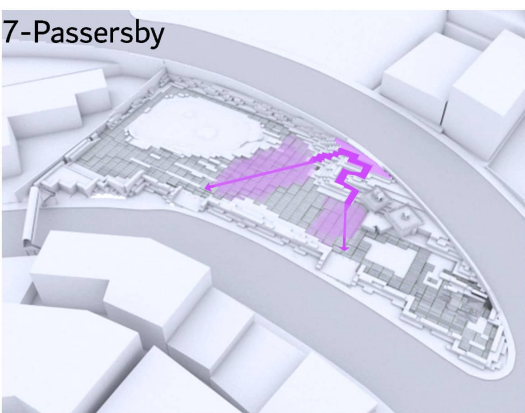

the principle of the plan is a continuous public space along the park ,the paths various in character connecting the upper street with the lower one

2-Order

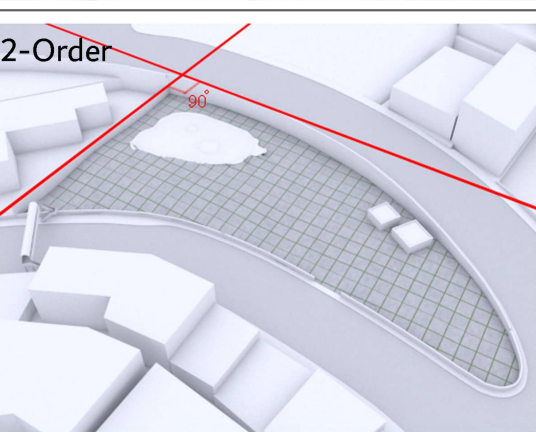

Because of irregular shape of the park and in order to give a layout system (grid) .the reference point from the most prominent elements represented by the retaining wall and the fence's school

5-Balance The Park

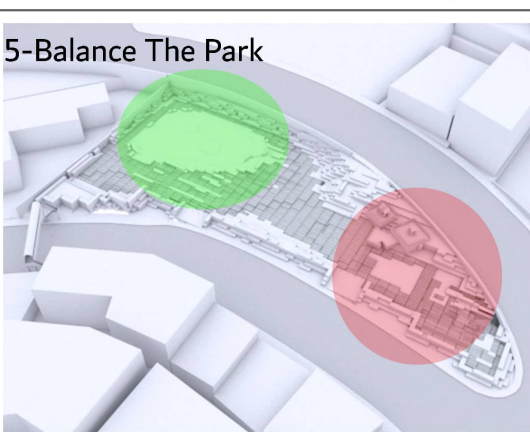

since the skateboarding podium has built years ago,most users are gathered around it.enhance the existing part of playing area and acquire new properties to the right part will re distribute the visitors

8-Concave

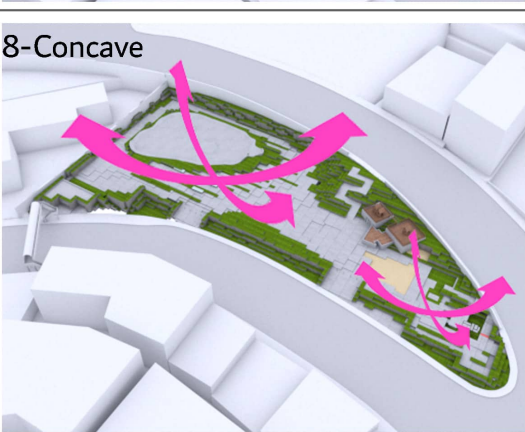

segmented theater and roofscape are tied together that is carefully formed to create a bowl,keeping views open to the middle of the site .accessible roofscape will bring public life to a new level

3-Segmented Theater

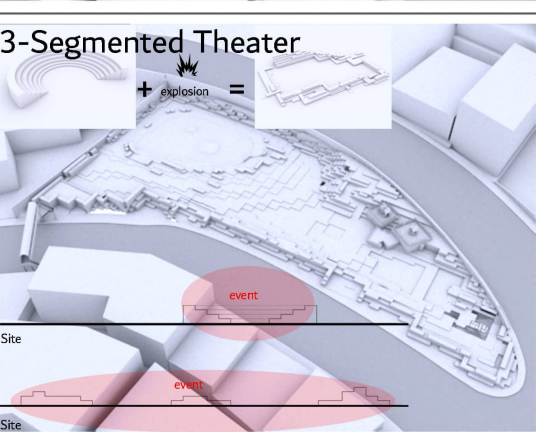

In order to make the . park more active traditional theater end up with single and concentrated event,segmented theater that is distributed along the site allows the users to experience the event among the site

6-Plazas

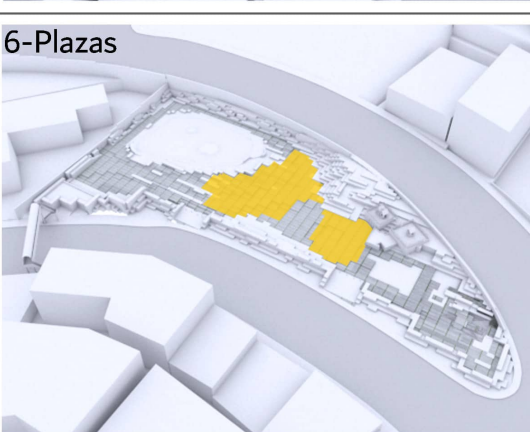

plazas create critical scale throughout the open space they are found among segmented theater to establish meeting areas,they provide space for events and creating unobstructed visual connection across the site

9-View Corridor

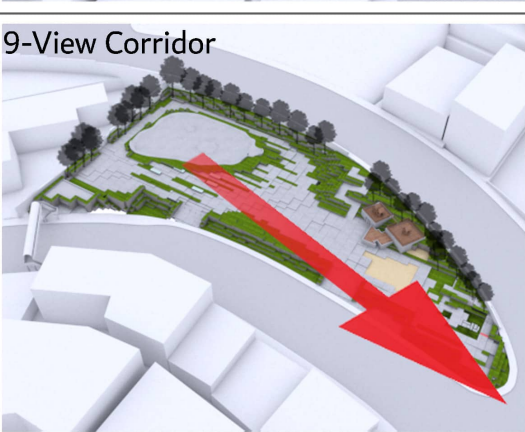

the bowl shaped and trees' position preserve views toward the city

03 CONCEPTUAL PROGRESSION

Sustainability

1-Gabion Box

Gabion box structure unites are rectangular wire mesh baskets that are usually filled with rock at the project site to form flexible, permeable structures

- Baskets can be filled with stone or concrete rubble
- Inexpensive materials are used for fill
- construction and excavations debris to be used to fill the boxes
- reduce waste in landfill
- reduce co emissions from transportation



2-Trees

A- xeriscaping tress

is landscaping and gardening that reduces or eliminates the need for supplemental water from irrigation. It is promoted in regions that do not have easily accessible, plentiful, or reliable supplies of fresh water, and is gaining acceptance in other areas as access to water becomes more limited

B- Replant Trees

all the existing trees that conflict with intention plan will be removed and replant in the proposed zone



3-Open Grid Paving

is a range of sustainable materials and techniques for permeable pavements that allow the movement of stormwater through the surface. In addition to reducing runoff, this effectively traps suspended solids and filters pollutants from the water

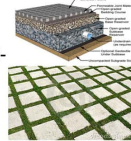

4-Rainwater Harvesting

is the accumulation and deposition of rainwater for reuse on-site, rather than allowing it to run off. Rainwater can be collected from rivers or roofs, and in many places, the water collected is redirected to a deep pit (well, shaft, or borehole), a reservoir with percolation, or collected from dew or fog with nets or other tools. Its uses include water for gardens, livestock, irrigation, flushing for toilets, domestic use with proper treatment

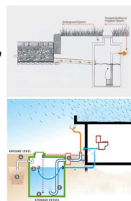

Park's Different Scenarios

1-Linear Event



2-running tracks

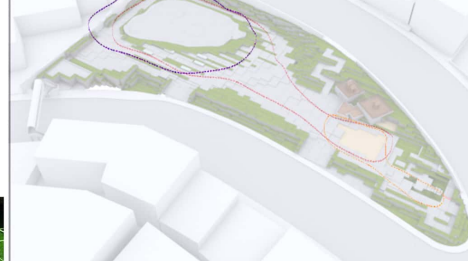

3-Big And Small Events



5-Solar Light

Solar street light uses solar energy as an energy source. The photovoltaic panels charge a rechargeable battery, which powers a LED lamp during the night



- Solar lights are independent of the utility grid. Hence, the operation costs are minimized
- Solar lights require much less maintenance compared to conventional lights
- Since external wires are eliminated, risk of accidents is minimized
- This is a non polluting source of elect
- Separate parts of solar system can be easily carried to the remote areas

the flexible design of the park allows the users to experience different events and activities in the same space rather than traditional parks that have specific zones for specific function ,one of the requirements is to propose running track instead of one long path the park allows the runner to choose what is compatible with the intention (short or long path) .what is interesting is that the park can accommodate a linear event such as market ,hand-made products etc.... and these events are arranged daily ,weekly or monthly,the form of the gabion boxes and how they are arranged allow the community to use them as a theater for big event as well as the others as fence small event

Kids Games To Be Interpreted To Reality

Visionary



balance games

rope swing

sand pit

tree house

Reality

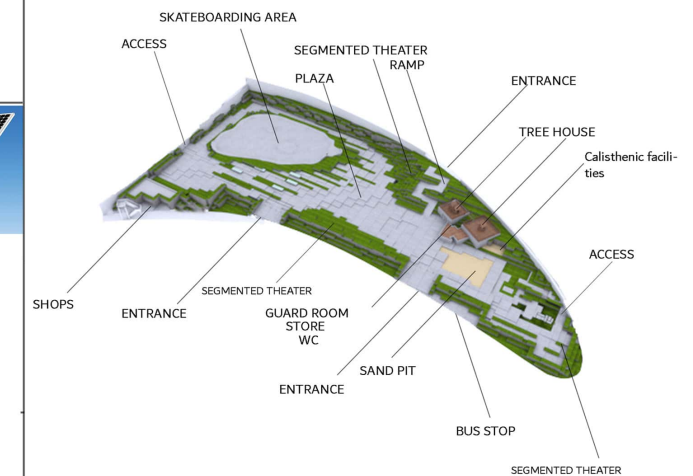

04 PROPOSED DESIGN

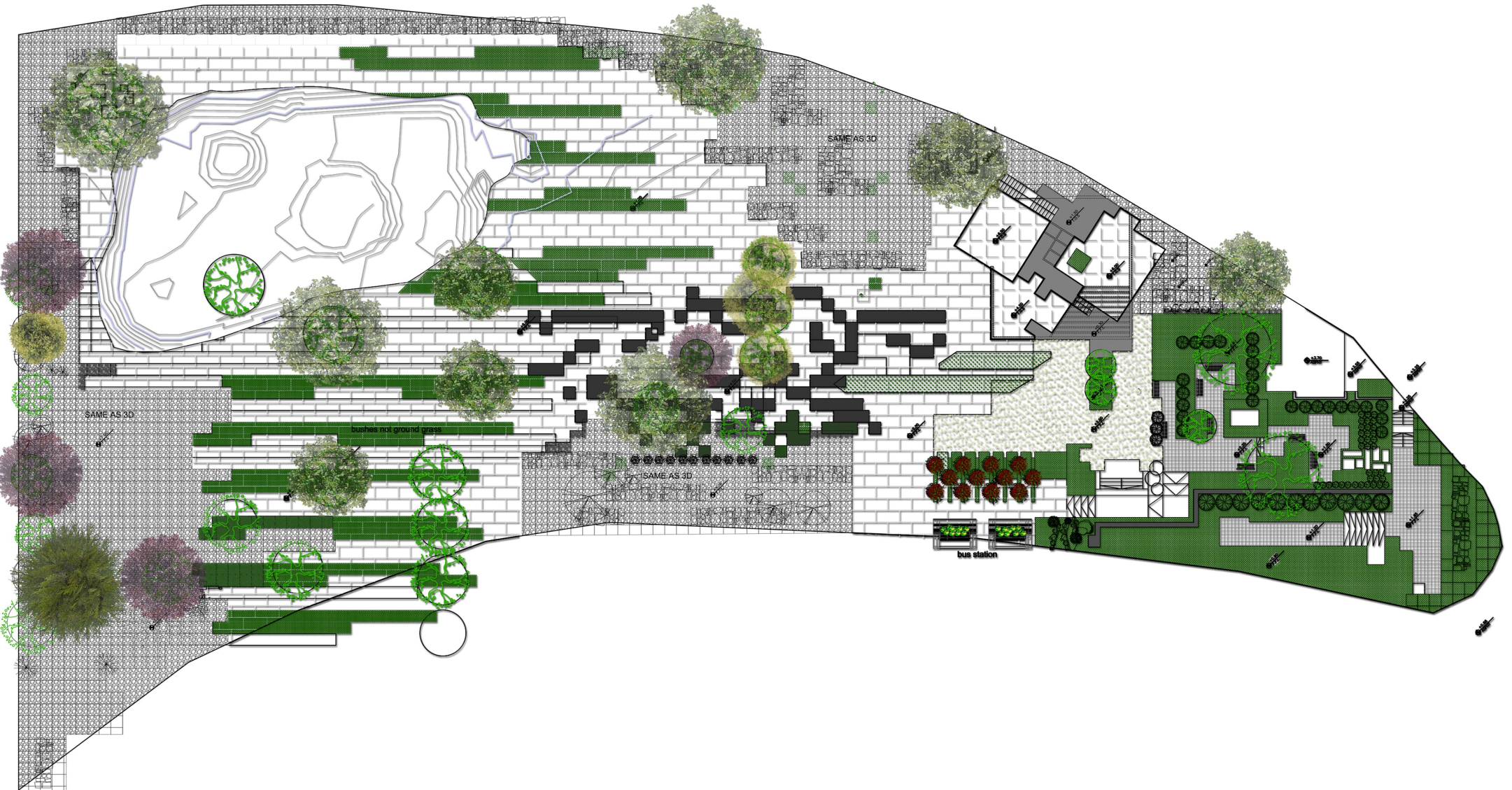

04 PROPOSED DESIGN

SERVICE AREA PLANS

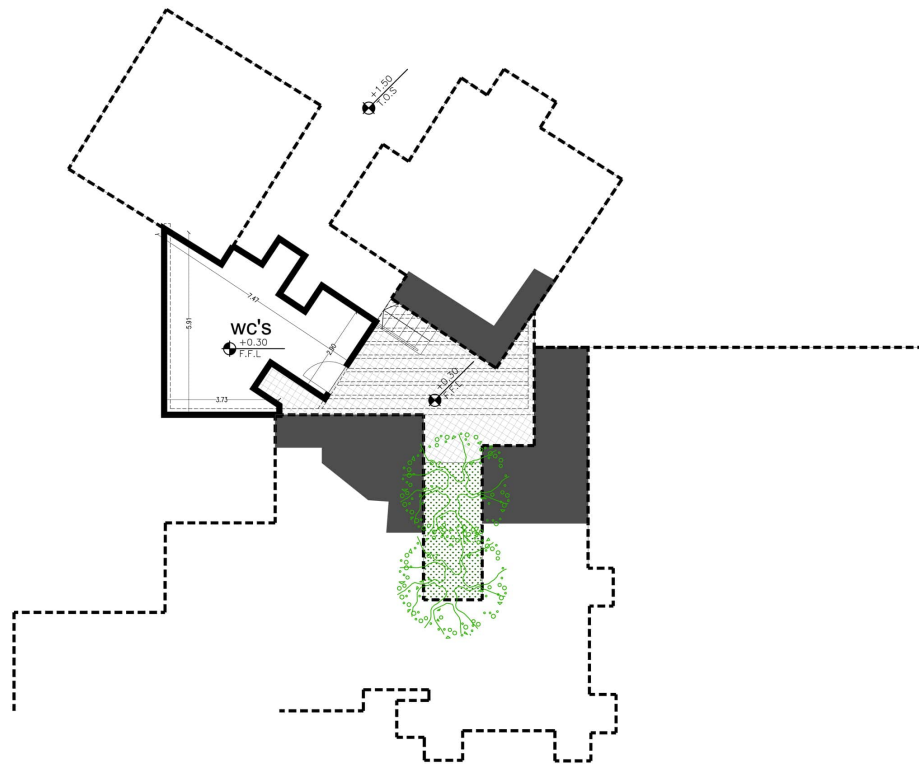
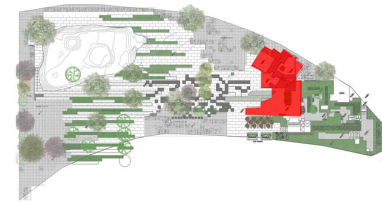

04 PROPOSED DESIGN

SITE SECTIONS

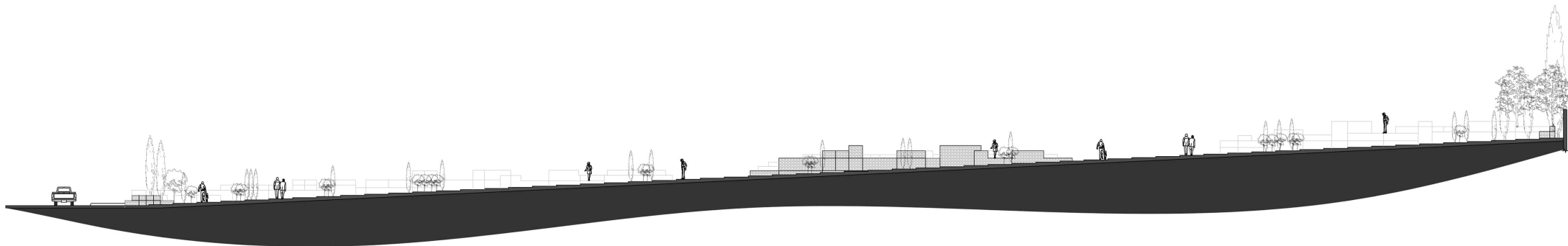
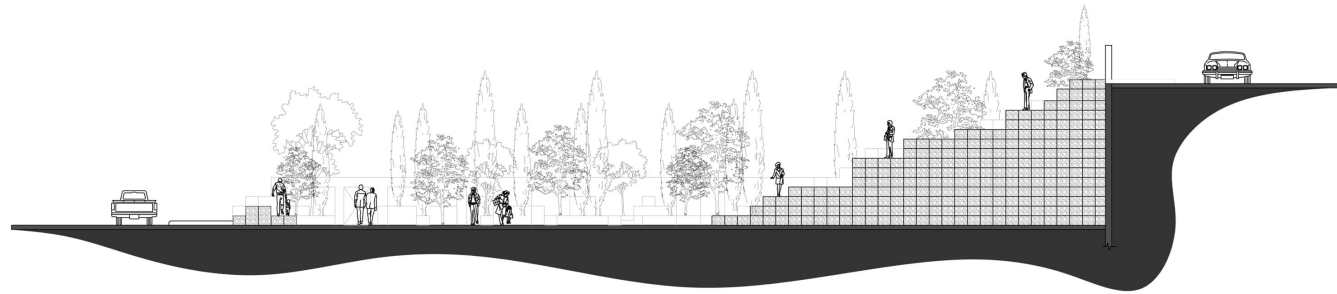
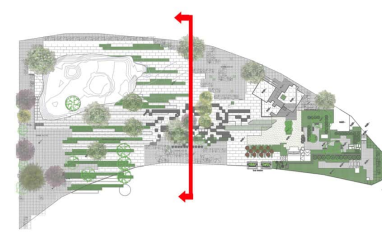

04 PROPOSED DESIGN

PERSPECTIVES



04 PROPOSED DESIGN

PERSPECTIVES

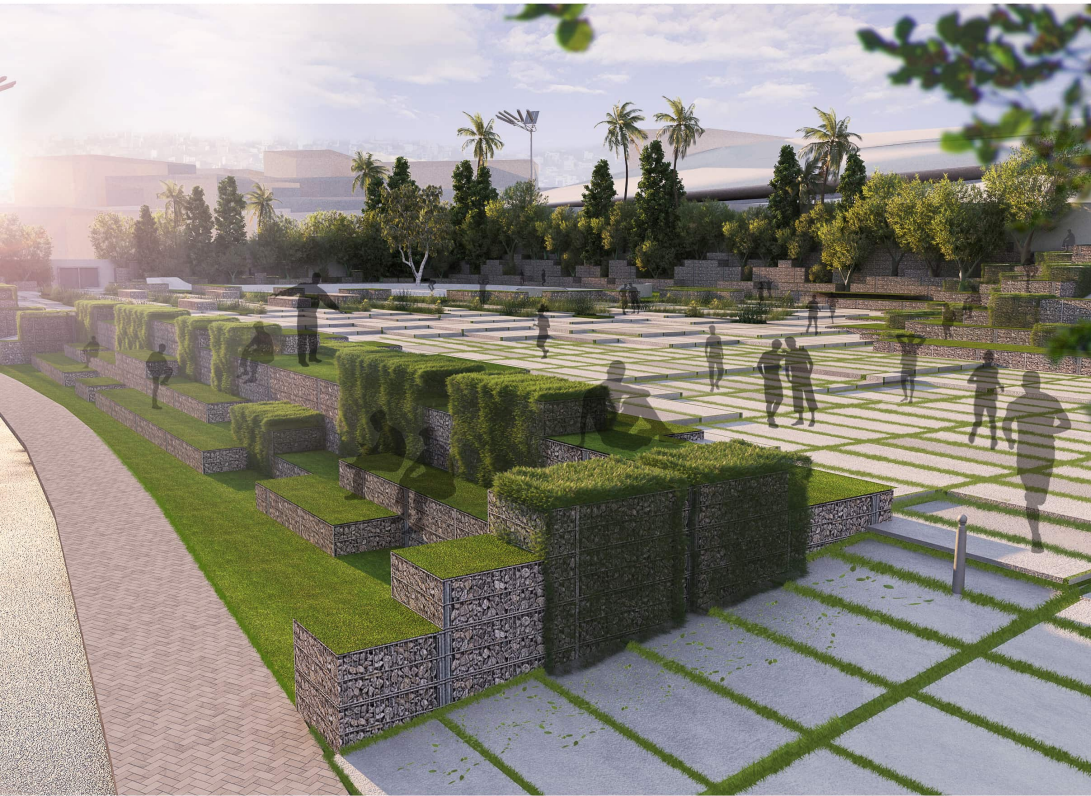

05 NEXT PHASE

The final concept design is responsive to the feedback from the draft concept consultation and ensures the community views are accommodated , where possible and practicable , within the design of the facility

The concept creates a facility design that is a holistic approach and integrated into the existing ongoing community consultation and involvement enables the community to connect with the project design process and to ultimately have a vested interest in the final outcome creating a stewardship of their community public spaces

Whats Next,

Skateboarders sometimes have the unfortunate and misguided reputation of being rebellious ‘anarchists’ with no regard for law and order, and often this is due to their use of public space. The lack of dedicated spaces for them to practice their sport forces them to use shared open space which often clash with other users.

NEXT is to expand the skating facility to accommodates for beginner and professional users, with various obstacles that add to the interest but also has multiple uses which will give the professional user more variety.

This design illustrates how innovative thinking and design development is suitable to a potentially upgrades as shown below :

