



## Denewood Coppice Lane, Heapey PR6 9DA

A four bedroom detached property set in an elevated position with far reaching open views to front and rear. Requiring refurbishment throughout with potential for extension to rear and side, The property briefly comprises lounge, dining room, dining kitchen, four bedrooms, family bathroom. Good sized gardens to rear and side and detached garage.

Price Guide £595,000



# Denewood Coppice Lane

, Heapey, PR6 9DA



- Four bedroom detached property set in an elevated position
- Current property briefly comprises lounge, dining room, dining kitchen, study, four bedrooms, bathroom and separate w,c,
- Stunning open views to front and rear
- In need of refurbishment throughout
- Good sized rear and side gardens
- Potential for extension to front and rear subject to usual p.p.
- Rural position close to White Coppice
- Side driveway giving access to detached garage

ACCOMMODATION COMPRISES:	BEDROOM 1
ENTRANCE PORCH	BEDROOM 2
ENTRANCE HALL	BEDROOM 3
LOUNGE	BEDROOM 4
DINING ROOM	BATHROOM
OFFICE/SNUG	SEPARATE W.C.
DINING KITCHEN	FRONT
REAR LOBBY/UTILITY	REAR

FIRST FLOOR ACCOMMODATION

HALF LANDING

LANDING



Directions





## ▼ Ground Floor

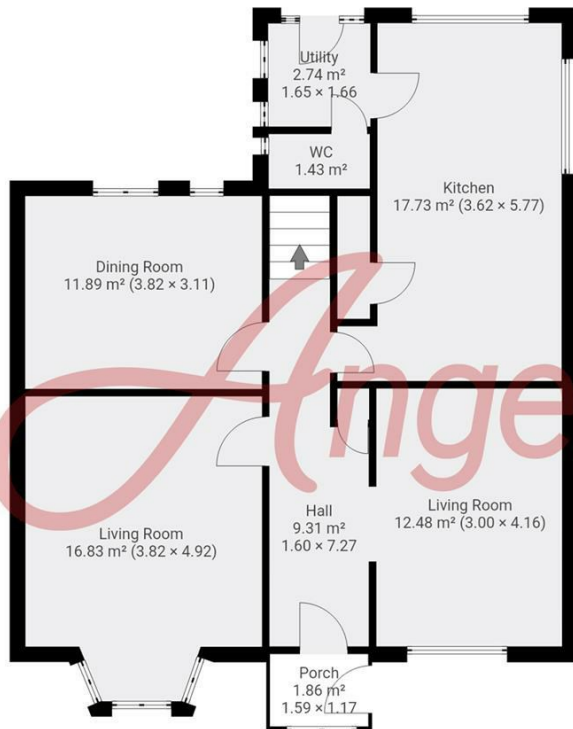

## ▼ 1st Floor

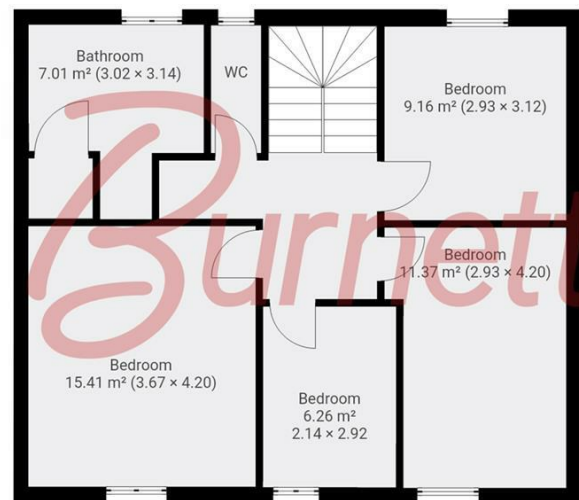

Total area: 136.82 m²

Disclaimer: This floor plan is for illustrative purposes only and is not intended to be an exact representation of the property. All measurements, dimensions, and spatial relationships are approximate and should be independently verified. The layout, fixtures, and features depicted may differ from the actual property. This floor plan is not a substitute for a professional survey or architectural drawing. Angela Burnett & Co does not assume liability for any errors, omissions, or inaccuracies in this floor plan.

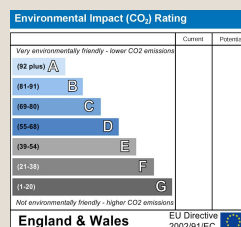
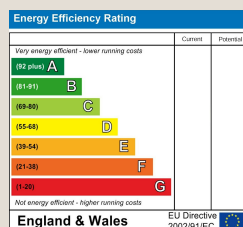

## Property Specialists

Blacksmith's Barn Hall Lane, Mawdesley, Lancashire, L40 2QY Telephone: 01704 821393

Email: [sales@angelaburnett.com](mailto:sales@angelaburnett.com) [www.angelaburnett.com](http://www.angelaburnett.com)

These particulars, whilst believed to be accurate are set out as a general outline only for guidance and do not constitute any part of an offer or contract. Intending purchasers should not rely on them as statements of representation of fact, but must satisfy themselves by inspection or otherwise as to their accuracy. No person in this firm's employment has the authority to make or give any representation or warranty in respect of the property.