



USER INSTRUCTIONS

PRE- PURCHASE INFORMATION

INSTALLATION INSTRUCTIONS

CHIMNEY HOOD

MODELS: K240 90CM and 100CM



Britannia Living,
Glen Dimplex Home Appliances,
Eastern Rise, Trentham Lakes,
Stoke-on-Trent
ST4 8WG

Britannia service & spares department
Tel: 0844 463 9705 (Option 1)
Email: service@britannialiving.co.uk

Important safety information

These warnings are provided in the interests of safety. Ensure that you understand them all before installing or using this appliance. Your safety is of paramount importance. If you are unsure about the meaning of any of these warnings please contact the help line above.

Installation

This hood must be installed in accordance with the installation instructions and all measurements must be adhered to.

A qualified electrician or competent person must undertake any installation work.

If the cooker hood is installed for use above a gas appliance the provision for ventilation must be in accordance with the latest edition of the Gas Safety Codes of Practice, and the Gas Safety (Installation & Use) Regulations, the Building Regulations issued by the Department of the Environment, the Building Standards (Scotland) (Consolidated) Regulations issued by the Scottish Development Dept.

The fan motor of this cooker hood incorporates a cut -out device, which will operate if the cooker hood is installed below the minimum height, or if the motor becomes overheated. If the cutout device is activated, switch off the fan motor and allow the cooker hood to cool down. The cutout device will reset itself when the fan motor has cooled significantly.

It is dangerous to alter the specifications or modify the product in any way.

When installed between adjoining wall cabinets, the wall cabinets must not overhang the hob/hotplate.

The following applies when ducting out

If the room where the cooker hood is to be used contains a fossil fuel burning appliance such as a gas or oil central heating boiler then its flue must be of the room sealed or balanced flue type. This hood is not suitable for use in a room where any open flue appliance is in use. There shall be adequate ventilation of the room when the range hood is used at the same time as appliances burning gas or other fuels. Any local regulations concerning the discharge of exhaust air must be checked and fulfilled prior to use of the hood. The ducting system for this appliance must not be connected to any existing ventilation or flue system that is being used for any other purpose.

High level grills

Do not install this hood above a cooker with a high level grill.

Child safety

This appliance is designed to be operated by adults. Children should not be allowed to tamper with the appliance.

During use

This product is for domestic use only.

Never leave frying pans unattended during use as overheated fats and oils may catch fire.

Do not flambé foods under the cooker hood

Always turn on your hood every time you use your cooker.

Always use pans with lids.

Do not leave naked flames under the cooker hood.

Maintenance and service

This appliance can be a fire hazard if the grease filters and charcoal filters are not cleaned and replaced in accordance with instructions.

Always insist on genuine spare parts.

Under no circumstances should you attempt to repair the appliance yourself. Repairs carried out by inexperienced persons may cause injury or a more serious malfunction.

In the event of service being required for your cooker hood please contact the service helpline.

Any service work will generally entail removal of the telescopic flue assembly to access key components including the motor. If the flue assembly has been boxed in by means of a bridging shelf or any type of furniture this must be removed prior to our engineer's visit.

Technical

SPECIFICATION

MODEL K240			
SPEED	1	2	3
Air capacity cubic metres per hour *	355	465	545
Pressure PA mmH ² O	34	39	42
Input - watts	110	150	180
Noise level - dbA **	45	61	64

Finish	Stainless Steel
Size	900mm or 1000mm
Controls	Push button
Air outlet	150mm diameter
Illumination	2 x lamps 40 watts
Motor	1 x 250watts (3 speeds)
Total wattage	330 watts
Mains supply	230 volts 50 Hz
Connection	via a 13 amp fused spur outlet fused at 5 amps

* Performance data according to Standard EN61591, Free air delivery.

** Noise level according to Standard IEC60704-2-13 method.

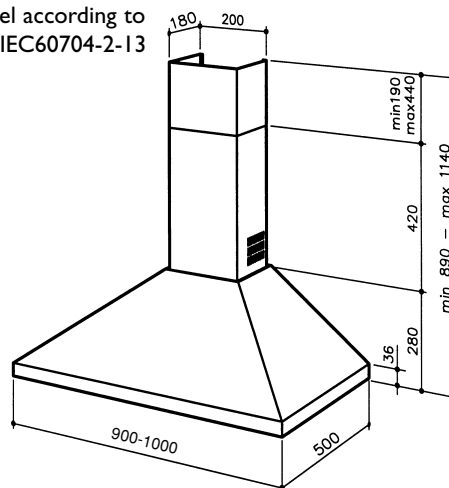

Electrical connections

Important: Ensure that the electricity supply is switched off before connecting.

Your appliance must be connected to fixed wiring via the use of a double pole switched fused spur outlet with at least 3mm contact separation. (See technical data for fuse rating).

We strongly recommend the appliance is connected by a qualified electrician who is a member of the N.I.C.E.I.C. or Corgi who will comply with the I.E.E. and any local regulations.

Note: The terminology "double pole" means that both the live and neutral supplies are switched and disconnected at the same time.

The terminations labelled SUPPLY are for the internal house wiring and the terminations labelled LOAD are for connection for the appliance.

WARNING - THIS APPLIANCE MUST BE EARTHED

Important: The wires in this mains lead are coloured in accordance with the following code:-
Green/Yellow = Earth, Blue = Neutral, Brown = Live

As the colours of the wires in the mains lead of this appliance may not correspond with the coloured markings identifying the terminals in your spur box, proceed as follows:

The wire which is coloured green and yellow must be connected to the terminal which is marked with the letter 'E' or by the earth symbol or coloured green or green and yellow. The wire which is coloured blue must be connected to the terminal which is marked with the letter 'N' or coloured black. The wire which is coloured brown must be connected to the terminal which is marked with the letter 'L' or coloured red.

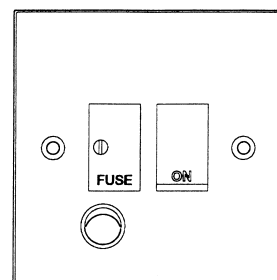

BLUE (NEUTRAL) BROWN (LIVE)

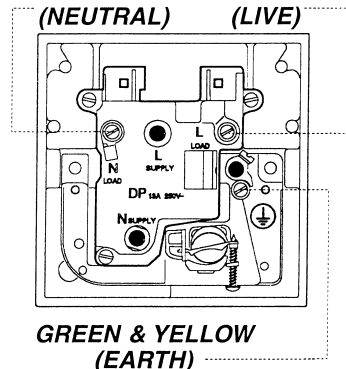

GREEN & YELLOW (EARTH)

Technical Data
Fuse rating:
5 AMP

Installation

Height above hotplates

For best performance we suggest that the hood is installed at a distance between 65cm to 75cm from the hotplate surface. Under no circumstances should the hood be installed lower than 65cm above the hotplate surface.

Ducting out/filtering

The hood can be used as a filtering version or as a ducted version. It is always preferable to install the hood as a ducted version i.e. duct to an outside wall. If this is not practical, charcoal filters can be fitted. In the filtering mode the air drawn in is purified as it passes through the charcoal filters, the air is then recycled back into the kitchen. It is realistic to assume that using a hood in filtering mode will circulate 30% less air than by ducting out. Charcoal filters are an optional extra and will require replacing after 120 hours of use or at least every 6 months. Charcoal filters are not required if you duct out. If the hood is used as a filtering version, please note that the filters will help reduce cooking odours but will not reduce steam or condensation. If you wish to reduce steam, condensation and cooking odours then you must duct out.

We strongly recommend that the hood is only used as a filtering version if it is impossible to duct out.

Ducting information

To obtain the best possible extraction performance use 150mm diameter ducting. Wherever possible utilise rigid circular pipe or "Mega duct" ducting - both types are available via your Britannia dealer. Do not use expanding concertina type ducting as this is not smooth on the interior and can cause air flow restrictions. Do not use ducting that has a smaller diameter than 150mm as this will reduce extraction rates and can increase noise levels. Please note ducting kits and ducting components are optional accessories and have to be ordered - they are not supplied with the hood.

One metre length pipe

Code DUCT/1100-6



90 degree bend

Code DUCT/690



Two metre length pipe

Code DUCT/1200-6

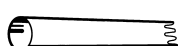

Pipe connector

Code DUCT/693



One metre and two metre length pipes can be cut to the desired length

Wall vent with gravity flaps

Code DUCT/6900



One metre ducting kit

Comprising: one metre length pipe, wall vent and 90 degree bend.

Code DUCT/2609

Megaduct Ducting Kit

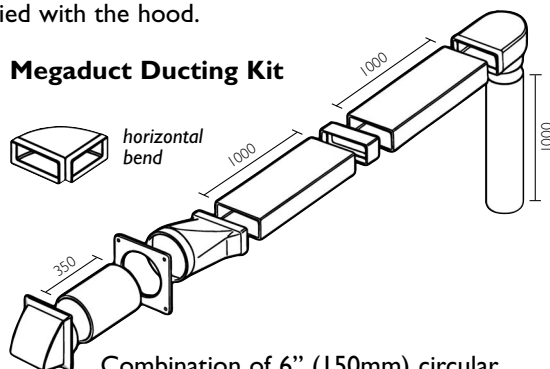

Combination of 6" (150mm) circular pipe and flat channel (220mm x 90mm) which is ideal for running on top of wall units or between ceiling joists.

Megaduct kit Code DUCT/2652B

Horizontal bend Code DUCT/950

Maximum length of ducting run

4 metres with 1 x 90 degree bend

3 metres with 2 x 90 degree bends

2 metres with 3 x 90 degree bends

Note: the shorter the ducting run and the least number of bends give the best extraction performance.

Warning: Any ducting used must be fire retardant.

Unpacking the hood

On some models components are packed inside the polystyrene protection pieces.

Do not throw away the box and packaging until installation is fully completed.

Installation

Attention:

The appliance should be installed by a qualified electrician or competent person.

- 1 Decide from the outset on the type of installation (filtering fig. ① or ducted fig. ②)
Note that the ducting run can go out through the rear wall or through the ceiling.

Installation - ducted version

- 1 Before fixing the hood install the ducting run for air evacuation to the outside. We recommend 150mm diameter for this model, anything less will impair performance.
- 2 Turn off electricity before preparing a suitable power supply. For the electrical connection requirements follow the details on page 2.
- 3 Remove the metal grease filters by pressing the catch and pulling the filter outwards. See fig. ③
- 4 Draw a vertical line on the wall to mark the centre line of the hob. Then draw a horizontal line to mark the bottom edge of the hood. Using the template supplied mark the holes to be drilled for the fixing screws. Take into account that the minimum distance between the underside of the hood and the hob is 650mm. See fig. ④. Drill the two holes and secure the hood to the wall with the screws and wall plugs provided. See (A) fig. ④. For added security two additional fixing screws and rawl plugs must be fitted, see (B) fig. ④.
- 5 Ensure the electric supply is turned off. Connect hood supply cable to the power supply.
- 6 Connect the ducting to the outlet spigot of the hood.
- 7 Fit bracket 'W', fig. ⑤, to the wall.
- 8 See fig. ⑥. Place the telescopic flue assembly carefully onto the hood and extend the upper section to the ceiling. Secure to the support bracket using the screws provided.
- 9 Refit the metal grease filters.

Installation in filtering version

- 1 Proceed with the installation, making reference to the instructions for the ducted version (follow points 2,3,4,5&7 above). Then follow the instructions below.
- 2 Fit the air diverter to the top section of the telescopic flue. See fig. ⑦
- 3 Place the telescopic flue assembly carefully onto the hood and extend the upper section to the ceiling. Secure to the support bracket using the screws provided. See fig. ⑥
- 4 Fit the charcoal filters. Refer to fig. ⑧
- 5 Re-fit the metal grease filters.

Operation

See fig. ⑨

- A Button A** turns the lights on/off.
- B Button B** turns the motor on to the first speed. It also turns the motor off.
- C Button C** turns the motor on to 2nd speed.
- D Button D** turns the motor on to 3rd speed.
- E Indicator Light E** to signify power on to the motor.

Cleaning and maintenance

Always turn off the electricity supply before conducting any cleaning or maintenance. To remove the metal grease filter for cleaning, see fig. ③. These can be cleaned by hand in hot soapy water or cleaned in a dishwasher. Use a reputable stainless steel cleaner for cleaning the exterior of the hood and follow the manufacturers instructions. If your hood is being used on filtering mode refer to fig. ⑩ to change the charcoal filters.

Changing the bulb

First turn off the electricity supply to the hood.

Remove the retaining screw that holds the light diffuser in position. Remove light diffuser. Unscrew the light bulb and replace it only with Candle Halogen Lamp Ø35 E14, 220/240Vac - 28W or Incandescent. Lamp E14, 220/240Vac - 40W.

Please note

The information contained in this booklet is given in good faith and has been written for the use of hoods over Britannia domestic appliances. Some of the information may not be applicable over other makes of appliances. We reserve the right to alter any design or specification without notice.

APPLIANCE WITH SPECIAL CABLE

Important: this appliance features a specially prepared power cable; in the event of damage to the cable, it must be replaced by another special cable or assembly, available from the manufacturer or after-sales service dealers.

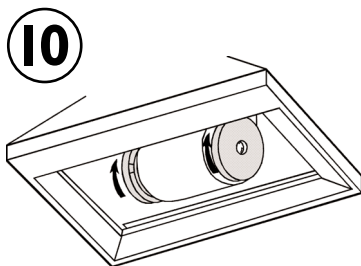
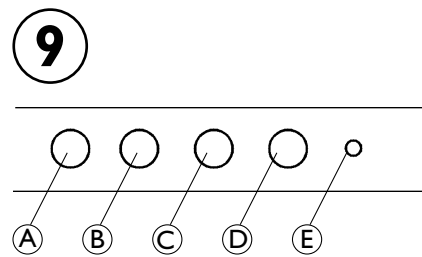
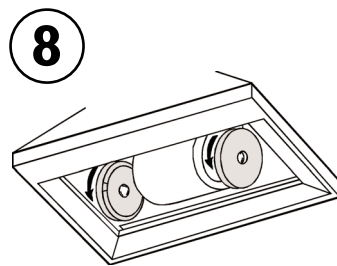
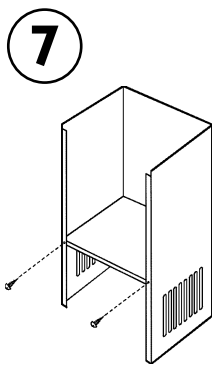
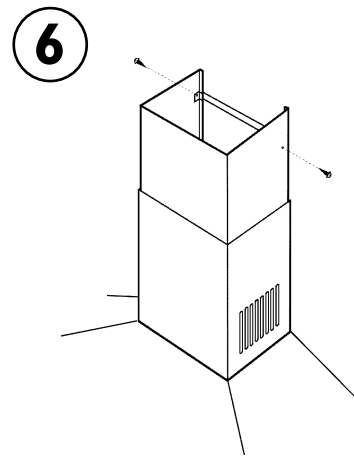
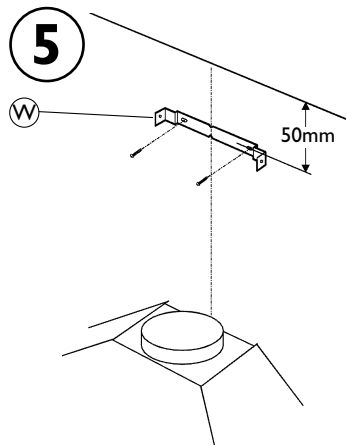
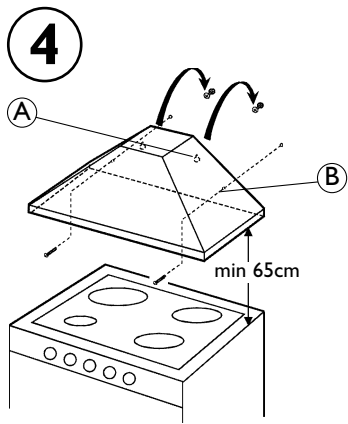
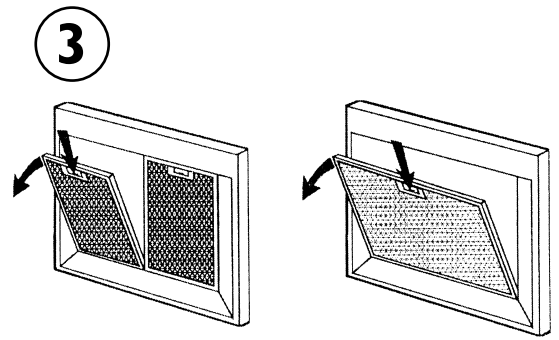
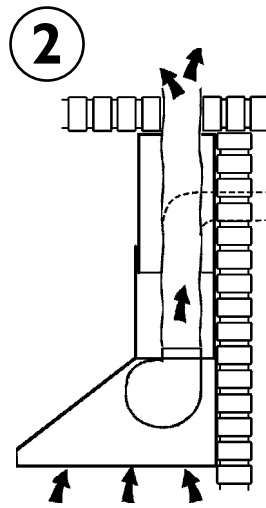
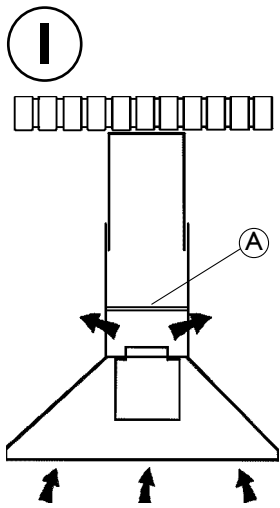

FOR NATIONWIDE SERVICE

Tel: +44 (0)844 463 9705 (Option 1)
Email: service@britannialiving.co.uk

GUARANTEE

What the Guarantee covers

Our service division will repair or replace free of charge any defect or component that is due to faulty material or workmanship, provided that such a defect occurs within 2 years of date of purchase and that:

- 1** Our service division is notified promptly of any defects. Under the terms of the guarantee the appliance must be made available for service during normal working hours, Monday to Friday.
- 2** The appliance is installed in accordance with these instructions and for normal domestic use.
- 3** The guarantee does not apply if the appliance is repaired or modified by any other person than a member of our service division. The guarantee does not cover misuse, improper installation or any installation in commercial premises. This product is for domestic use only.
- 4** Any service work will generally entail removal of the telescopic flue assembly to access key components including the motor. If the flue assembly has been boxed in by means of a bridging shelf or any type of furniture this must be removed prior to our engineer's visit.

Before calling for service, please check the following:

- 1** Is there a power failure? Turn on the appliance to check the mains supply.
- 2** check that the fuse has not blown.
- 3** Please note that bulbs are not covered under the guarantee.

In the event of service being required, our service division will request the following information:

- 1** Your name, address and postcode.
- 2** Your telephone numbers for home and work.
- 3** The model number and colour of the appliance.
- 4** Precise details of the fault.
- 5** Date of purchase.

Please note that when the service engineer visits he will require seeing your proof of purchase date so please retain your receipt.