

BTH-C-950  
BTH-C-1150  
BTH-C-1400  
BTH-CT-950  
BTH-CT-1150  
BTH-CT-1400

# Latour Canopy Hood

## Installation, Operation & Maintenance Instructions

### 1. INTRODUCTION

Your range cooker is a semi-professional unit which gives you the power and flexibility to realise your full potential in the kitchen. Inevitably, during the cooking process, there will be heat, vapours and fumes produced. Your Latour extractor has been designed to complement the range cooker both in looks and performance in order to create the ideal environment for creative cooking.

### 2. EXTRACTION PERFORMANCE

The most important influence on the performance of the extractor is the design of the ducting which takes the exhaust air from the extractor to the outside wall louvre. The duct route should be a prime consideration during the initial stages of the kitchen design. Please note the following:

- This hood is designed for ducting out, i.e. duct to an outside wall.
- The extractor is provided with a spigot suitable for connecting 150mm diameter duct. **Twin (2000 m<sup>3</sup>/hr versions) have two blower assemblies complete with two separate exhaust spigots for independent ducting to the outside.**
- Note: 150mm is the minimum duct diameter consistent with efficient extraction.
- The exhaust duct route length should be kept as short as possible with as few bends as possible.
- The most efficient configuration is to duct straight through an outside wall so try to position the cooker against an outside wall when designing your kitchen layout.
- Rigid 150mm round ducting or an equivalent flat channel system will perform best, with semi-rigid being the second best solution. Flexible ducting is economical but its use should be minimised as it gives the worst performance and should only be used for short duct runs or initial connection and be pulled taut to prevent significant losses in extraction efficiency. *See section 6: Additional Ducting Information*
- A route with more than two 90° bends will significantly degrade the performance of the extraction system. If possible, avoid having a 90° bend at the extractor exhaust spigot; keep bend radii as large as possible to maintain a smooth airflow without vortices; avoid kinks in flexible ducting; pull flexible ducting taut over straight runs to ensure that the internal surface is as smooth as possible.
- Duct runs in excess of 5 metres are not recommended and will seriously impair efficiency - if you are concerned then please call for advice.
- Please also note that a 90° bend in the flexible or semi rigid ducting will require 215mm minimum headroom to give a smooth radius with no kinking.

### 3. IMPORTANT INFORMATION

Compliance with the following notices will ensure that the installed product is safely installed and is safe to use.

Cooker-to-canopy clearance (minimum):	700 mm
Recommended clearance range:	750 - 850 mm
Canopy height (excluding Duct Spigot):	280 mm

- The minimum distance between the hob and the bottom of the extractor is essential to prevent overheating of the extractor and its components.
- The exhaust air must not be discharged into a flue which is used for exhausting fumes from appliances supplied with energy other than electricity, e.g. oil or gas-fired central heating boilers, gas-fired water heaters, etc.
- Requirements of the relevant authorities concerning the discharge of exhaust air must be complied with.
- **Attention:** This appliance requires an earth connection.  
Ensure that the supply voltage corresponds to that marked on the rating label inside the extractor.  
The extractor must be isolated from the electrical supply before carrying out any cleaning or maintenance operations.

#### Warning

**The following is a requirement of UK and European legislation and is in the interests of your safety.**

If the room where the cooker hood is to be used contains a fossil fuel burning appliance such as a gas or oil central heating boiler, then its flue must be of the room sealed or balanced flue type. A ducted hood is not suitable for use in a room where any open flue is in use, as dangerous fumes of combustion can be sucked back in to the room. This would include the following open flue appliances – central heating boilers, coal fires, log fires, gas fires, wood burning stoves etc. Therefore, if you have an open flue fossil fuel burning appliance in your kitchen, you are automatically compelled to select a hood that is capable of working in recycling mode.

- **Pay particular attention to fire risk when frying. To minimise the risk of fire, all instructions relating to cleaning the grease filters and removing grease deposits must be adhered to.**
- **Do not flambé under the extractor.**

**See Section 7 for PRODUCT GUARANTEE information.**

### 4. INSTALLATION

**Do not throw away the box and any internal packaging until installation is fully completed - the packaging may be required in the unlikely event that hood must be returned.**

The Latour Canopy range of built in hoods are designed to slot into an opening made in a horizontal soffit panel - usually the underside of kitchen furniture, timber canopies or false/real chimney breasts.

#### 4.1. Prepare Opening

The soffit panel into which the unit is to be fixed must be between 15mm and 22mm thick.

Prepare an opening where the extractor is to be installed. Opening and Extractor dimensions are shown in Section 8: *Latour Canopy General Arrangement Drawings*.

#### 4.2. Duct Installation

Make holes, as necessary, in the walls or ceiling to take the 150mm diameter ducting from the extractor exhaust spigot to the outside. If your extractor has twin spigots you will require two separate duct runs to the outside

The exhaust duct route length should be kept as short as possible with as few bends as possible - see Section 2.

If terminating on an outside wall a suitable weather louvre, designed for connection to 150mm ducting or larger, should be fitted - an airbrick must never be used. A variety of ducting components and complete kits are available. *See Section 6: Additional Ducting Information*.

For roof or chimney duct terminations please contact your supplier or seek alternative specialist advice.

#### Recirculating Models Only

We do not recommend recirculating air installations and they should be avoided wherever possible (see section 2).

For recirculating installations you must allow for the exhaust air to blow back into the kitchen (or an adjacent room - e.g. utility room). Open topped furniture or ducting to a vent back into the room are common ways of achieving this as the air leaving the extractor spigot must have somewhere to go.

Any ducting or openings used for return air must be at least equivalent in cross sectional area to that of 125mm diameter duct otherwise the unit may overheat and fail and you will invalidate your warranty.

**Additional ducting information and components can be found in Section 6**

### 4.3. Electrical Installation

**ELECTRICAL HAZARD  
DISCONNECT ELECTRICAL SUPPLY  
BEFORE PROCEEDING FURTHER**

The extractor is a stationary appliance designed to be connected by fixed wiring to the electrical supply. A competent electrical technician must perform the electrical installation.

The extractor must be fed from a 220-240Vac single phase electrical supply using a switched spur fitted with a 3A fuse. The spur should be located such that the supply can be disconnected from the hood using the switch after installation (adjacent to the hood or cooker or cooker is best). The means of disconnecting from the supply must have a minimum contact separation of 3mm in all poles. Alternatively a means of disconnection in the fixed wiring according to the relevant wiring regulations must be fitted.

A supply cord for connecting the extractor to the spur is included.

The mains supply is connected to the free end of this cord as follows:

Core	Live	Neutral	Protective Earth
Core Colour	Brown	Blue	Green/Yellow

### 4.4. Connecting the Ducting

Terminate the ducting where it exits the building. If using a wall mount weather louvre secure the ducting to the louvre spigot and attach the louvre to the wall. Ensure that the air fins are directed downwards. If you are fitting an alternative termination ensure that the ducting is secure.

If using expanding foam make sure that any flexible ducting is supported internally to prevent it crushing or use rigid ducting through the wall where foamed.

Pull any flexible ducting back along its route such that it is as smooth as possible. Position the extractor face down and as close to the opening as is practical and cut off excess before connecting the ducting to the extractor exhaust spigot(s) using plastic tie straps or a suitable alternative (e.g. jubilee clip).

Secure the louvre to the outside wall. Ensure that any air fins are directed downwards.

Check that the duct has not been flattened or kinked.

### 4.5. Fixing the Extractor in position.

Fixing the extractor safely into position requires two people so do not start if assistance is unavailable.

- Remove the grease filters as described in Section 10.
- The extractor is held securely in place by 4 adjustable spring toggles (only visible on the outer casing of the unit).  
Screws for adjusting the height of each spring toggle are located behind the grease filters on the outer filter housing flange (see Figure 1). The spring toggles are moved up by turning the screws anti-clockwise and down by turning clockwise.  
Ensure that each spring toggle height is set such that when pushed from outside it moves freely and fully into the outer casing of the unit and when slowly released returns to an open position just below the top of the spring toggle slot. The spring toggle should protrude from the casing by at least 8mm (see Figure 1).
- Supplementary support of the unit is provided by sprung safety clips which are intended to hold the unit safely in place during removal (see later). The safety clips (See Figure 1) should be disabled for installation by pulling the clip release into the body until the clip latch is clear of its slot and then sliding to one side so that the clip latch rests against the inner casing of the unit.
- Check that the electrical supply chord has been connected, that power is switched off and that the ducting is securely fastened to the spigot. Check, if applicable, that any external fans are plugged into the unit.
- Push the extractor up through the prepared opening until the spring toggles are heard to snap over the edge of the opening – we recommend that two people do this supporting one end of the extractor each. Carefully release the unit ensuring that it is supported within the opening by all four spring toggles. If a spring toggle fails to catch try pushing upwards again and if this fails remove the unit as described later and check the panel thickness and setting of the spring toggles as described earlier.

Figure 1.

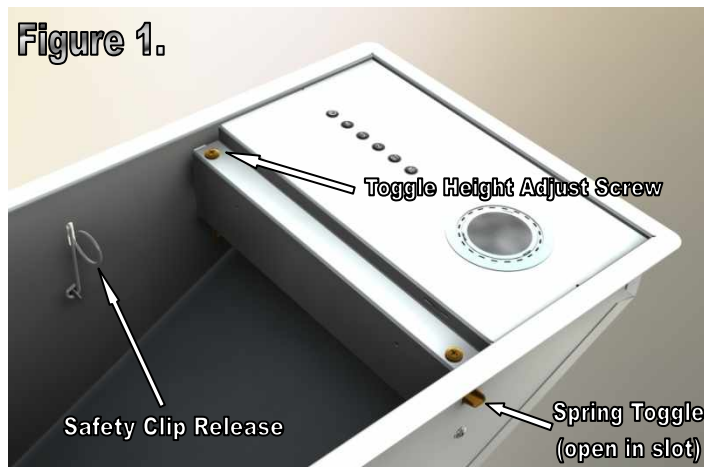

- Re-enable the two sprung safety clips** by once again pulling the safety clip release (Figure 1.) and sliding the clip latch back into the slot from which it was earlier withdrawn. The clip latch should pass fully through the outer casing.
- Close up any gaps between the soffit panel and the units outer flange (often referred to as the fixing flange) by turning the spring toggle adjustment screws clockwise. If the gap is larger than 1-2mm then this should be done in stages of approximately 1mm, working your way around each of the four adjustment screws in turn until the unit has been pulled up into position.
- Note: Ideally, although not always possible, access to the ducting should be provided for when the unit is in place, for straightening the duct following installation, inspection and future repair work.

### 5. REMOVING THE CANOPY HOOD

First remove the grease filters and ensure that the sprung safety clip is correctly set. Only the clip release grip and mounting arm should be on the inside of the unit (as in Figure 1) with the latch fully through the slot in the hood casing. If in doubt pull the clip release to reveal the clip latch and make sure that it passes fully back through the casing when released.

With the safety clips correctly set turn the spring toggle adjustment screws anti-clockwise. The extractor will gradually start to lower. This is best done in stages, working your way around the 4 screws thus lowering the unit evenly and avoiding undue stress on any one spring toggle. *Note: as you turn the adjustment screws the spring toggles gradually rise until they reach the top of their slots after which they start to retract into the hood casing.*

You will know when the spring toggles start to retract because the hood will start to rise up slightly into the soffit rather than lower. When this happens you should support the extractor and continue to turn the screws carefully clockwise. When the spring toggles have retracted sufficiently the unit will lower once again - this will happen suddenly if you are not supporting the hood.

The sprung safety clips are there to catch the unit and to prevent it falling from the opening in the soffit should you let go of the hood. If you do need to let go of the hood then do so carefully, ensuring that the safety clips have indeed trapped the unit in the opening before letting go of the hood. This is a supplementary support system intended to lessen the risk of dropping the unit and, when correctly engaged, to provide momentary support.

**Two people are required to lower the unit safely.** The unit is released for final lowering by each person pulling the safety clip release into the body whilst supporting the unit with their other hand. When the clips are pulled into the body the spring latch will disengage from the soffit and the unit can be lowered.

## 6. ADDITIONAL DUCTING INFORMATION

This hood is designed for ducting out, i.e. duct to an outside wall. To obtain the best possible extraction performance use 150mm diameter ducting. Wherever possible utilise rigid circular pipe or "Mega duct" ducting - both types are available via your Britannia dealer. Do not use flexible expanding concertina type ducting unless it is absolutely necessary and then only for short runs (of less than 1 metre) or initial connection as this is not smooth on the interior and will cause air flow restrictions.

Do not use ducting that has a smaller diameter than 150mm as this will reduce extraction rates and can increase noise levels. Please note ducting kits and ducting components are optional accessories and have to be ordered - they are not supplied with the hood.

### Recommended maximum length of ducting run.

4 metres with 1 x 90 degree bend

3 metres with 2 x 90 degree bends

2 metres with 3 x 90 degree bends

Note: The shorter the ducting run and the least number of bends gives the best extraction performance.

**Warning:** Any ducting used must be fire retardant.

### One metre length pipe

Code DUCT/1100-6



### Two metre length pipe

Code DUCT/1200-6



Note: One metre and two metre length pipes can be cut to the desired length.

### Wall vent with gravity flaps

Code DUCT/6900



### 90 degree bend

Code DUCT/690



### One metre ducting kit

Comprising: one metre length pipe, wall vent and 90 degree bend.

Code DUCT/2609

### Pipe connector

Code DUCT/693



### Megaduct Ducting Kit

Combination of 6" (150mm) circular pipe and flat channel (220mm x 90mm) which is ideal for running on top of wall units or between ceiling joists.

Code DUCT/2652B

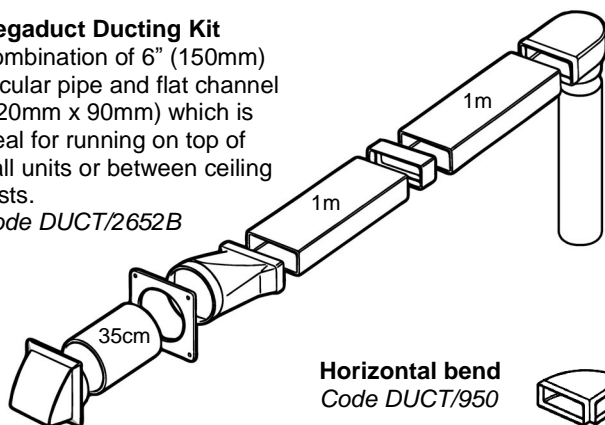

### Horizontal bend

Code DUCT/950



## 7. PRODUCT GUARANTEE

**Britannia service & spare department**

**Tel: +44 (0)844 463 9705 (option 1)**

**Email: service@britannialiving.co.uk**

## GUARANTEE

### What the Guarantee covers

**Our service division will repair or replace free of charge any defect or component that is due to faulty material or workmanship, provided that such a defect occurs within 2 years of date of purchase and that:**

1. Our service division is notified promptly of any defects. Under the terms of the guarantee the appliance must be made available for service during normal working hours, Monday to Friday.
2. The appliance is installed in accordance with these instructions and for normal domestic use.
3. The guarantee does not apply if the appliance is repaired or modified by any other person than a member of our service division. The guarantee does not cover misuse, improper installation or any installation in commercial premises. This product is for domestic use only.
4. Any service work will generally entail removal of the telescopic flue assembly to access key components including the motor. If the flue assembly has been boxed in by means of a bridging shelf or any type of furniture this must be removed prior to our engineer's visit.

### Before calling for service, please check the following:

1. Is there a power failure? Turn on the appliance to check the mains supply.
2. Check that the fuse has not blown.
3. Please note that bulbs are not covered under the guarantee.

**In the event of service being required, our service division will request the following information:**

1. Your name, address and postcode.
2. Your telephone numbers for home and work.
3. The model number and colour of the appliance.
4. Precise details of the fault.
5. Date of purchase.

*Please note that when the service engineer visits he will require seeing your proof of purchase date so please retain your receipt.*

# 8. LATOUR CANOPY GENERAL ARRANGEMENT DRAWINGS

**Single Fan Models**  
BTH-C-950, BTH-C-1150, BTH-C-1400

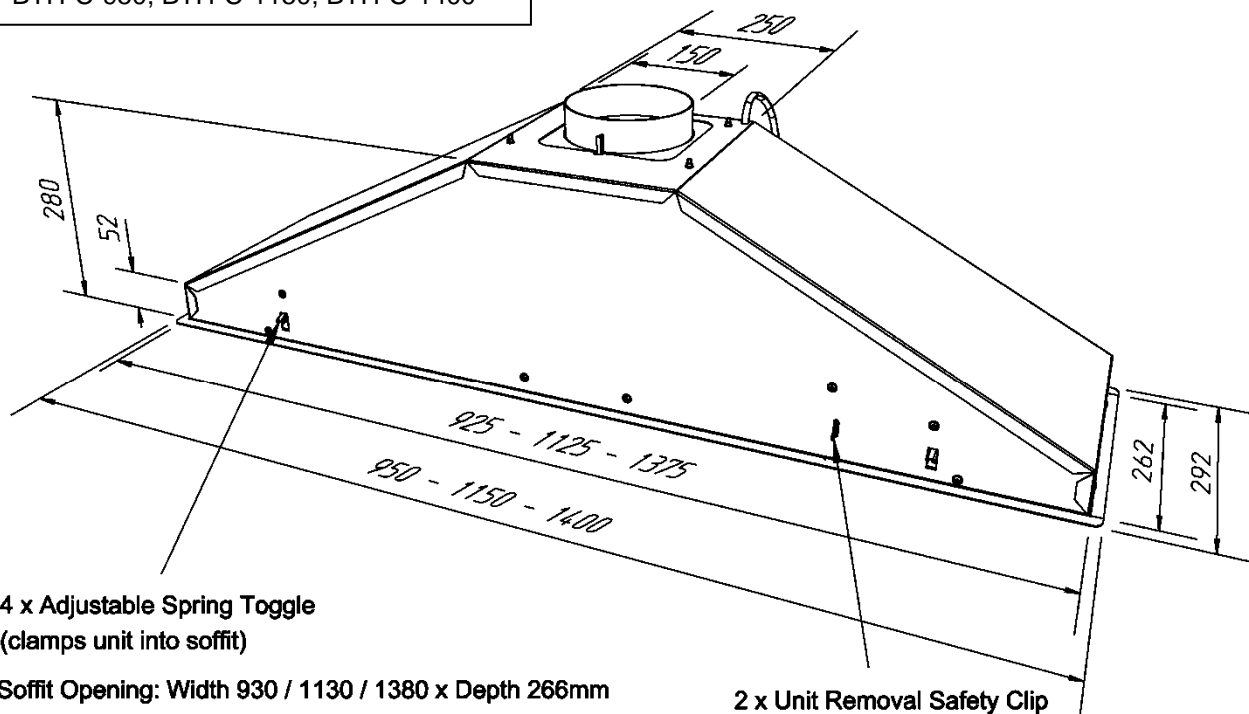

4 x Adjustable Spring Toggle  
(clamps unit into soffit)

Soffit Opening: Width 930 / 1130 / 1380 x Depth 266mm  
Soffit Thickness: Min 15mm, Max 22mm

2 x Unit Removal Safety Clip

**Twin Fan Models**  
BTH-CT-950, BTH-CT-1150, BTH-CT-1400

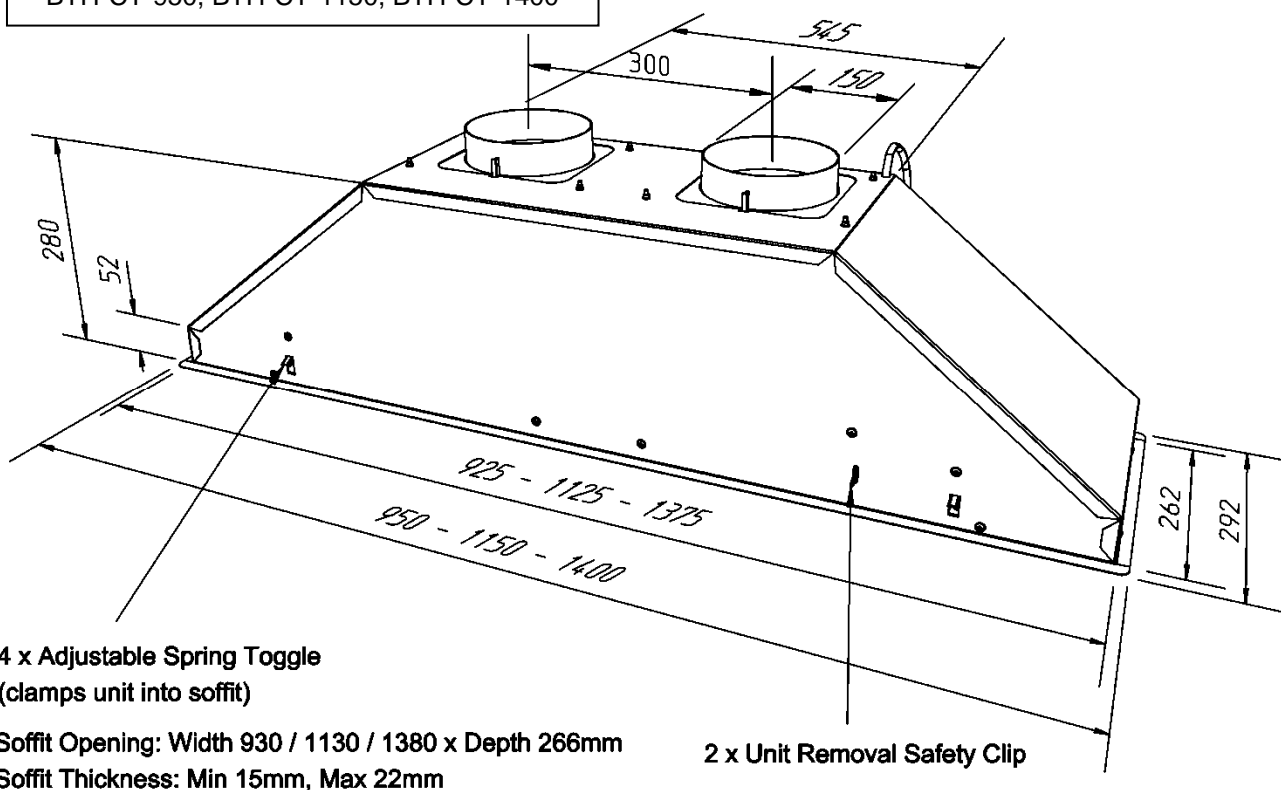

4 x Adjustable Spring Toggle  
(clamps unit into soffit)

Soffit Opening: Width 930 / 1130 / 1380 x Depth 266mm  
Soffit Thickness: Min 15mm, Max 22mm

2 x Unit Removal Safety Clip

## 9. OPERATING INSTRUCTIONS

- Switch on the power at the fused spur.
- The extractor has 6 push-buttons which illuminate when selected. Their functions are summarised in the table below.
- After 30 hours accumulated running GREASE FILTER SATURATION will be signalled by all 6 indicators flashing. Reset by pressing Push-button FAN OFF (delay).
- The extractor controller will automatically switch off the appliance if there has been no operator action for 4 hours.



LIGHTS  
ON/OFF



FAN ON  
SPEED 1



FAN ON  
SPEED 2



FAN ON  
SPEED 3



FAN ON  
SPEED 4



FAN OFF  
(Immediate)

FAN OFF  
Delayed for  
10 Minutes  
to clear  
fumes

## 10. MAINTENANCE

### CAUTION

To minimise the risk of fire, all instructions relating to cleaning the grease filters and removing grease deposits must be adhered to.

Regular maintenance is essential to ensure good performance and long-life.

To clean the stainless steel surfaces of the extractor use a suitable cleaning agent (*Stainless Steel Cleaner and Polish*). Glass surfaces should be cleaned with a suitable glass cleaning agent.

### Do not use abrasive cleaning materials or products.

Clean the grease filters in a dishwasher or by hand-washing in hot water and detergent. Wash the filters at least every 2 months - sooner if the extractor is used extensively.

To maintain the immaculate appearance of the extractor, and to minimise fire risk, ensure that grease deposits on the extractor surfaces are kept to a minimum by regular cleaning.

### Removing the Grease Filters

The filters have an integrated sprung latch and release mechanism. Release the latch by pulling the lever and remove the filter. The filter is replaced by locating the fixed tabs on the filter into corresponding slots in the extractor base and then pushing the filter into position with the latch held open. Once the filter is in position carefully release the lever, allowing the latch to engage.

### Replacing Light Bulbs

The unit is fitted with 20W (20 Watt) 12V (12 Volt Low Voltage) G4 halogen capsule bulbs (lamps). Replacement lamps must be of the same type (G4 12V 20W).

### Never use lamps rated at over 20W.

- Remove the frosted glass lens by carefully prising off the lens retention ring (Figure 2), taking care to support the glass so that it does not fall. (a fingernail, flat screwdriver, butter knife or similar can be used to prise off the ring – take care not to scratch the chrome bezel)
- Grasp the lamp and carefully pull it sideways away from and out of its connection block.
- Insert replacement lamp.
- Place the frosted lens with smooth face facing downwards (the face you will see) into retention ring, offer the ring up and align the ring clips with the corresponding innermost slots in the chrome bezel and push the ring back into place - this is easiest if one clip is inserted with the ring at a slight angle (so that you can see it has located properly) and then pushing up to engage the remaining two clips.

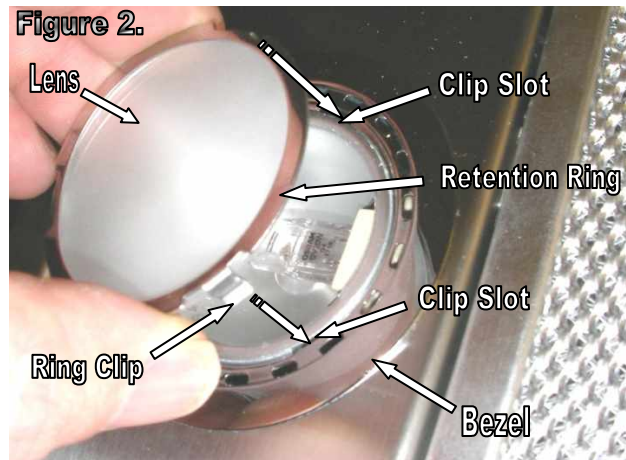

## 11. SPECIFICATIONS

BTH-C-950,1150,1400 with INTERNAL BLOWER			
Blower airflow, nominal:	1,000 m³/hr per fan		
Noise level:	52dBA Single Fan 56dBA Twin Fan		
Supply voltage:	220-240 volts~ 50Hz		
Halogen lamp voltage:	12 volts		
Blower power input:	250 watts Per Fan		
Halogen lamp power:	BTH-C/CT-950:	2 x 20 watts	
	BTH-C/CT-1150:	3 x 20 watts	
	BTH-C/CT-1400:	4 x 20 watts	
Total power:	Single Fan Models:	BTH-C-950:	290 watts
		BTH-C-1150:	310 watts
	Twin Fan Models:	BTH-C-950:	540 watts
		BTH-C-1150:	560 watts
Electrical supply fuse rating:	Single Fan Models:		3 amp
	Twin Fan Models:		5 amp
Blower spigot diameter:	150mm		

### Britannia Living

Eastern Rise, Trentham Lakes, Stoke-on-Trent, ST4 8WG  
Tel: 0844 463 9705 Email: enquiry@britannialiving.co.uk

-oOo-