



Siemens
SR66T090GB
Dishwasher fully integrated 45cm

Predecessor:

Successor:

EAN code:
4242003705711

sales programme:

iQ500

SR66T090GB stainless steel
Dishwasher 45cm
Fully-integrated

Performance

- Energy Efficiency Class: A++
- 10 place settings
- Energy consumption in Eco 50 programme: 211 kwh per year, based on 280 standard cleaning cycles
- Water consumption in Eco 50 programme: 2660 litres per year, based on 280 standard cleaning cycles
- Programme time in Eco 50 programme: 195 minutes
- Noise level dB (A) re 1pW: 44 dB
- Water consumption in Eco 50 programme: 9.5 litres

Programmes/functions

- 6 programmes:
Auto 35-45 °C, Auto 45-65 °C, Auto 65-75 °C,
Eco 50 °C, Quick Wash 45 °C, Pre Rinse
- 3 additional functions: intensiveZone, VarioSpeed Plus, Hygiene Plus
- 5 temperatures

Flexible design elements

- varioDrawer on upper level
- varioFlex Plus basket system
- 3 stage rackMatic height-adjustable top basket
- Silver baskets with handle and stainless steel inlay
- 3 foldable plate racks in top basket
- 4 foldable plate racks in bottom basket
- Cup shelf in top basket and cup shelf in bottom basket
- Glass rack in bottom basket

Innovations and technology

- hydroDry hygienic and efficient drying
- dosageAssist detergent dispenser
- Automatic detergent-aware system
- hydroSensor, loadSensor
- hydroMix glass care protection technology
- hydroSafe - ultimate 24hr anti leak system with guarantee

Design features

- Controls on top edge of door
- acoustic end of cycle indicator, internal remaining programme time indicator (minutes), timeLight information projection, water inlet indicator
- timeLight information projection
- Large item spray head, steam protection plate
- Colour of indicators: Red LED Indicators
- LED salt refill indicator, LED rinse aid refill indicator
- Self-cleaning filter system with 3 piece corrugated filter
- Dimensions (HxWxD): 81 5 x 44 8 x 55cm

Included accessories

baking-sheet spray head grey, vapor barrier plate

Optional accessories

- SZ73005 Compensating + fixing kit, stainl. steel
- SZ73000 Dishwashing aid set
- SZ72010 inlet and outlet hose extention 2 m

Technical Data

Characteristics

Water consumption (l) : 9.5
Design : Built-in
Height of removable worktop (mm) : 815
Required niche size for installation (HxWxD) : 815-875 x 450 x 550
Depth with open door 90 degree (mm) : 1150
Adjustable feet : Yes - front only
Maximum adjustability feet (mm) : 60
Adjustable plinth : both horizontal and vertical
Net weight (kg) : 35.0
Gross weight (kg) : 37.0
Connection rating (W) : 2400
Current (A) : 13
Nominal power (kW) : 220-240
Frequency (Hz) : 60; 50
Length of electrical supply cord (cm) : 175
Plug type : GB plug
Length inlet hose (cm) : 165
Length outlet hose (cm) : 205.0
EAN code : 4242003705711

Consumption and connection features

Number of place settings : 10
Energy efficiency : A++: very efficient
Energy consumption annual (kWh/ annum) - NEW (2010/30/EC) : 211
Energy consumption (kWh) : 0.75
Power consumption in left-on mode (W) - NEW (2010/30/EC) : 0.10
Power consumption in off-mode (W) - NEW (2010/30/EC) : 0.10
Water consumption annual (l/annum) - NEW (2010/30/EC) : 2660
Drying performance : A
Reference programme : Eco
Total cycle time of reference programme (min) : 195
Noise level (dB) : 44
Installation type : Built-in

Alternative colors available

iQ500
SR66T090GB stainless steel
Dishwasher 45cm
Fully-integrated

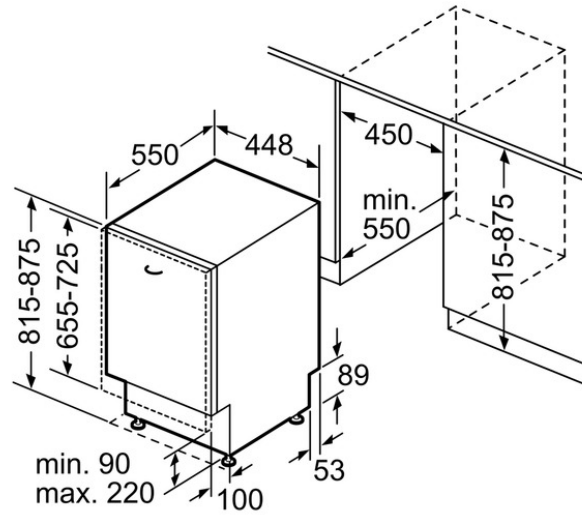

measurements in mm

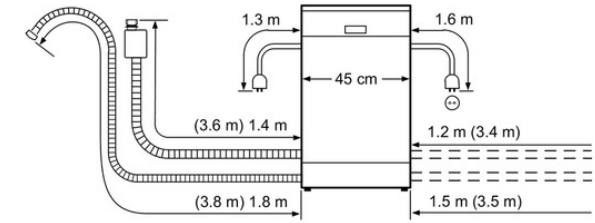

() values with extension kit