

For Sale by Private Treaty

myhome.ie

# 7 Galtee View

Cahir o Co. Tipperary



Michael Dorgan Auctioneers & Valuers are delighted to present this superb opportunity to the market, a stones throw from the amenities of Cahir town centre, 15minutes from Clonmel & 50minutes from the Jack Lynch Tunnel. This prominent detached property benefits from 5 bedrooms & a wealth of living space, cobble block driveway, twin side accesses & a substantial garden to the rear set out in lawn & decking. Rare opportunity.

Michael Dorgan, Auctioneers & Valuers, Mitchelstown, Co. Cork  
[www.michaeldorgan.ie](http://www.michaeldorgan.ie)  
T: 025 85700 F: 025 85708

[www.daft.ie](http://www.daft.ie)  
[www.myhome.ie](http://www.myhome.ie)





## *Location:*



Located just off the r640 Clonmel road, in a mature and exclusive residential settlement & a short walk from the town Centre with its wealth of amenities, schools & shops. This substantial property is just over 15minutes from Clonmel, 4.5km from J10 of the M8 Motorway & just under 50mins to the Jack Lynch tunnel.



Location Map



## *Features:*



This well located property is situated on a superb south/western facing site, benefiting from generous front & rear gardens, mainly mature shrubs, trees and flower beds with the remainder set out in lawn and decking:

- Sought after property in a private location.
- 5 minutes from junction 10 of the M8 Motorway.
- 15minutes from Clonmel.
- 50minutes to the Jack Lynch tunnel.
- Within walking distance of shops and schools.
- OFCH, mains water & sewerage.
- Generous front & rear gardens incorporating mature specimen shrubs, Flower beds, Garden shed (with power), Dual side access to garden.
- Excellently insulated- BER D2 Rating.
- Lots of built in storage.
- Double glazed windows







## *Accommodation:*



### W/C:

1.57 x 1.1

(5' 2" x 3' 6")

- Ceramic floor tiles.
- WHB & Toilet.

### Entrance hallway:

4.85 x 2.18

(15' 11" x 7' 2")

- Ceramic floor tiles.
- Power & Telephone points.
- Wired smoke detector.
- Teak stair case
- Radiator.





**Diningroom/second reception room:**

4.85 x 3.73

(15' 11" x 12' 3")

- Semi solid timber floor.
- Power & Television points.
- Patio door onto garden.
- Radiator.



**Livingroom:**

4.70 x 3.73

(15' 5" x 12' 3")

- Semi solid timber floor.
- Feature fireplace (open) with granite hearth.
- Power & Television points.
- Bay window.
- Radiator.





**Kitchen with dining area:**

5.84 x 3.28

(19' 2" x 10' 9")

- Shaker style wall & floor units with dark work surfaces.
- Ceramic floor tiles.
- Integrated oven & microwave.
- Integrated dishwasher & hob.
- Power & Television points.
- Extractor fan.

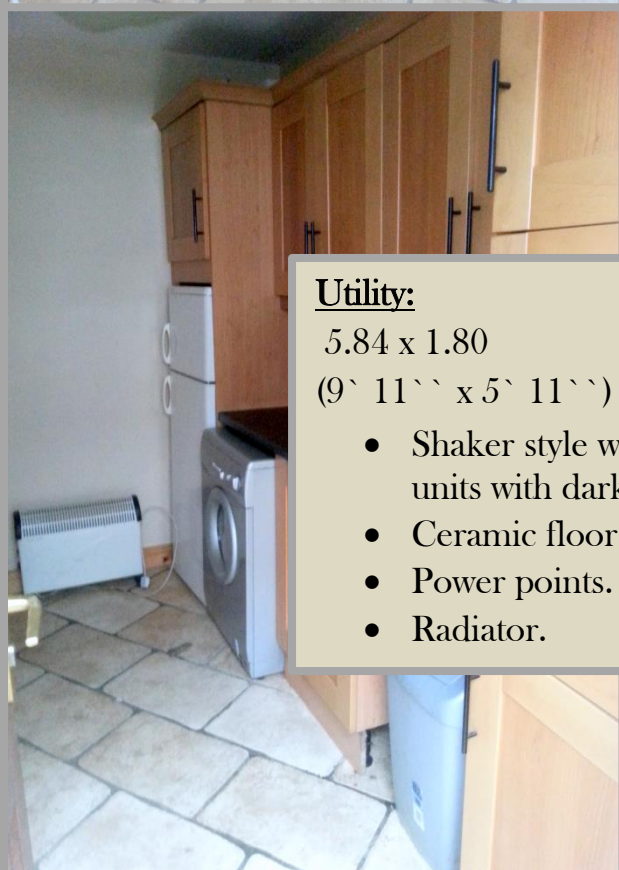

**Utility:**

5.84 x 1.80

(9' 11" x 5' 11")

- Shaker style wall & floor units with dark work surface.
- Ceramic floor tiles.
- Power points.
- Radiator.



### **Bedroom 1:**

Ground floor

4.34 x 3.02

(14' 3" x 9' 11")

- Laminate timber floor.
- Power & television points.
- Bay window & Radiator.



### **Bedroom 2:**

First floor

3.38 x 2.85

(11' 1" x 9' 4")

- Solid timber floor.
- Built in wardrobe.
- Radiator & power points.



### **Bedroom 3:**

First floor

2.95 x 2.82

(9' 8" x 9' 3")

- Solid timber floor.
- Built in wardrobe.
- Radiator & power points.



### **Bedroom 4:**

First floor

2.79 x 2.49

(9' 2" x 8' 2")

- Solid timber floor.
- Built in wardrobe.
- Radiator & power points.



### **Bathroom:**

First floor

1.78 x 1.70

(5' 10" x 5' 7")

- Ceramic floor tiles.
- Tiled to border.
- Toilet & WHB
- Bath-immersion type shower.
- Shaving light.



### **Bedroom 5:**

First floor

3.66 x 3.63

(11' 12" x 11' 11")

- Solid timber floor.
- Built in wardrobe.
- Radiator & power points.
- Television point.

### **Ensuite:**

2.20 x 1.42

(7' 3" x 4' 8")

- Ceramic floor tiles.
- Tiled to border.
- Toilet & WHB
- Shower, triton elec.
- Shaving light.





# Directions:





Take an immediate right turn & the property  
is the second house on the LHS.



7 GALTEE VIEW

FARRANLAHASSERY

CAHIR

CO. TIPPERARY

E21 PW24

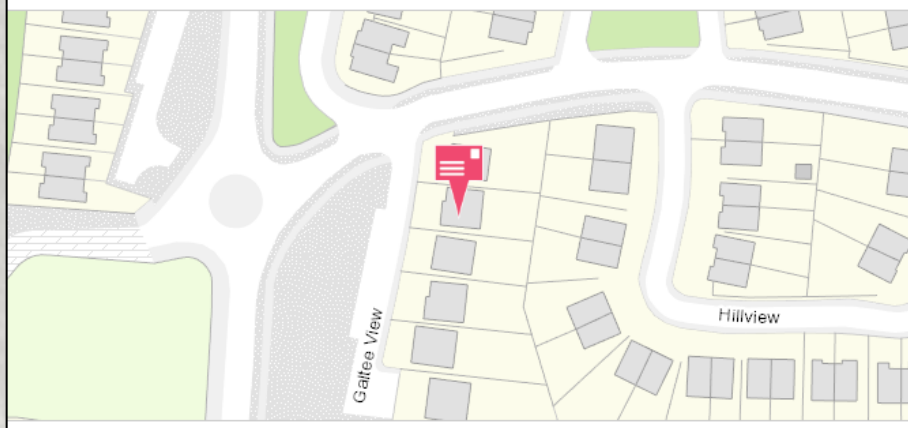



# Documents:

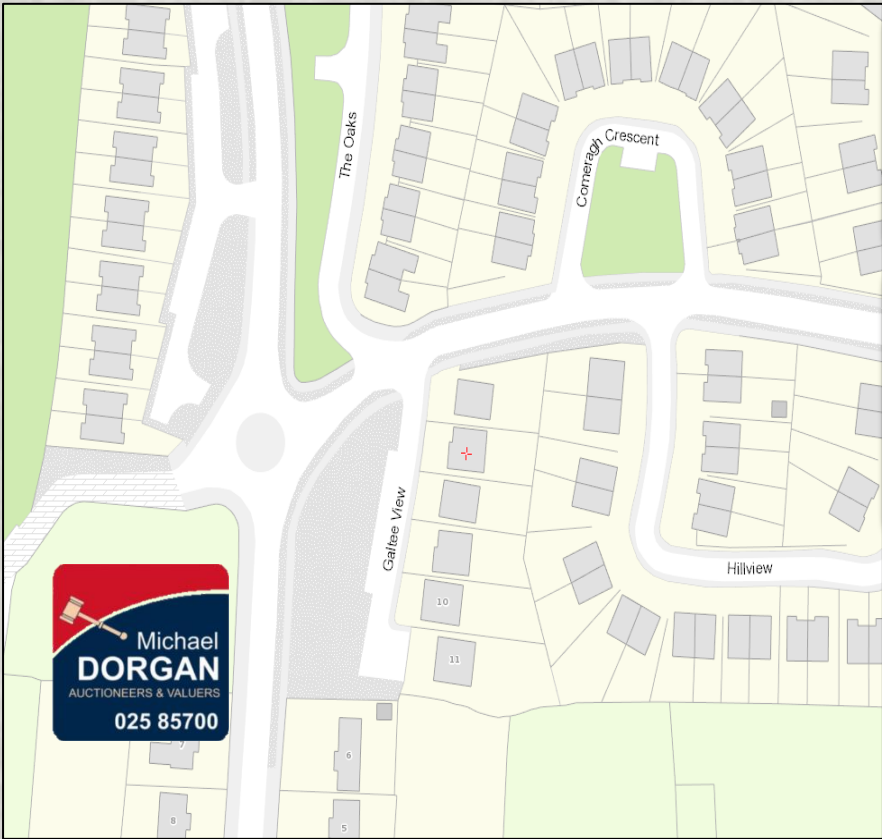
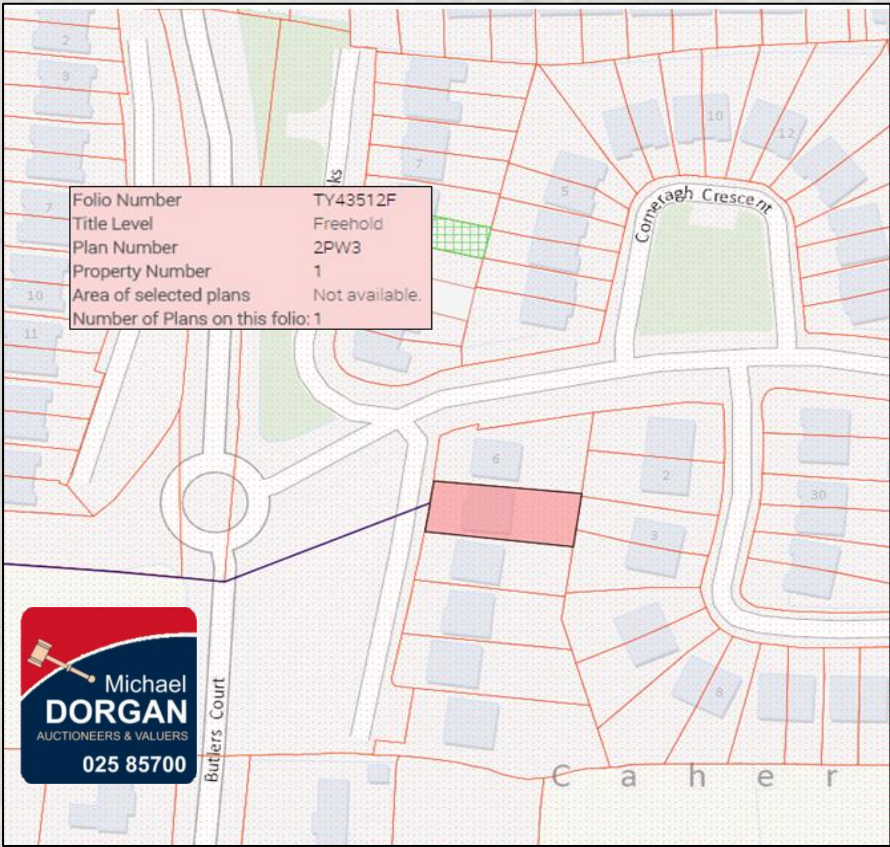



# Terms:



## Guide: €170,000

This well-appointed Property is being offered for Sale by private treaty. Terms are available and to be negotiated on application with sole agents:

Michael Dorgan Auctioneers & Valuers  
Baldwin Street  
Mitchelstown  
Co. Cork

(025) 85700

Email: [Info@michaeldorgan.ie](mailto:Info@michaeldorgan.ie)

**Viewing:** Strictly by Appointment only.



**Building Energy Rating**  
BER: D2

BER No. 108501040

EPI: 267.02kWh/m²/yr

Full BER Certs & Advisory  
reports available on request.

The above particulars are issued by Michael Dorgan, Auctioneers & Valuers on the understanding that all negotiations are conducted through them. Every care is taken in preparing particulars but the company do not hold themselves responsible for any inaccuracies. All reasonable offers will be submitted to vendors. These particulars do not form any contract for Sale subsequently entered into.