

Summary

Available Size	27,850 sq ft
Business Rates	N/A
Service Charge	N/A
EPC Rating	Upon Enquiry

Description

The design and build opportunity is situated on the well-established and thriving Old Mill Business Park with access to the property directly off Gibraltar Island Road.

Old Mill Business Park is a proven location for regional and national companies seeking well located, flexible space.

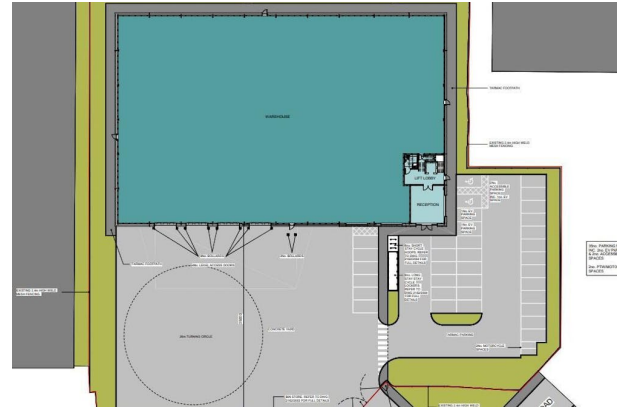
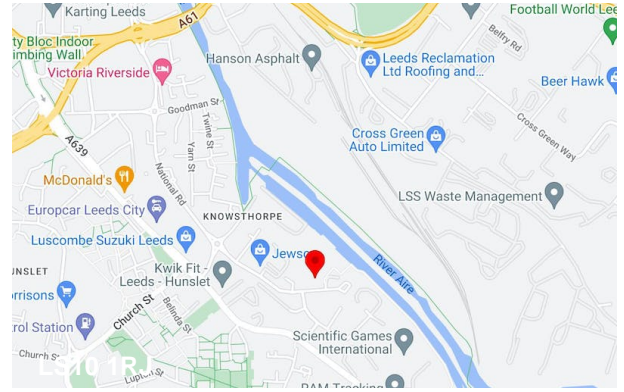

Viewing & Further Information



Sarah-jayne Lishman

0113 457 5551 | 07725 365 997

sarah-jayne.lishman@dhp.org.uk



Simon Dove

0113 457 5550 | 07527 388054

darryl+5153-Simon-Dove@tld.co.uk