



## 3 Haberdasher Street, London, N16BS

Fully fitted workspace available on the ground and first floors.  
Flexible terms available on a fully managed basis.

- Fully fitted and furnished
- Flexible Term
- Cycle Storage
- Fully Managed
- EPC: B
- Shower Facilities

# 3 Haberdasher Street

London, N16BS

**Instant**  
RETHINKING WORKSPACE

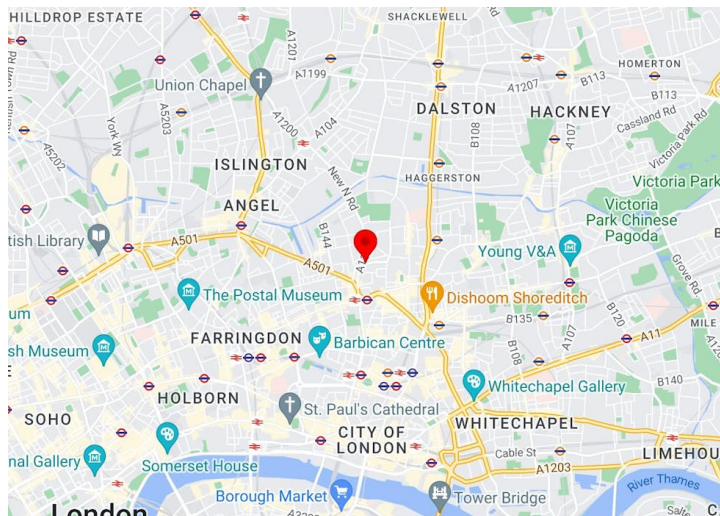
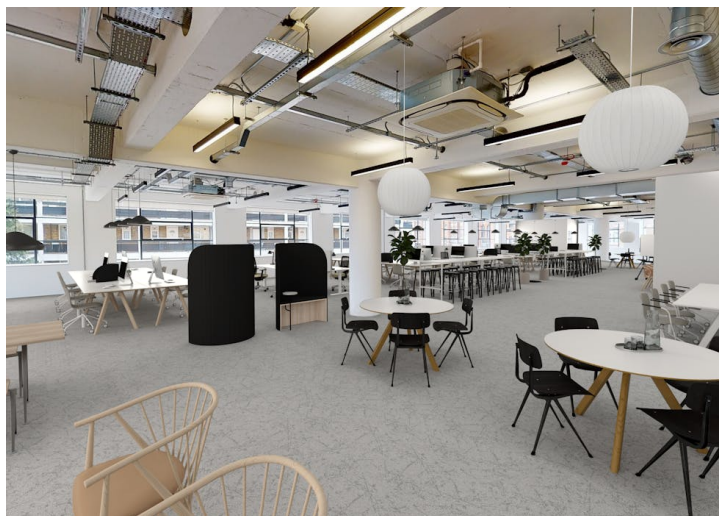

## Summary

Available Size	5,317 to 12,690 sq ft / 493.97 to 1,178.94 sq m
Rent	Rent on Application
Service Charge	N/A
Car Parking	Upon Enquiry
Estate Charge	Upon Enquiry
EPC	Upon Enquiry

## Description

Both the ground and first floor offers a workspace with an optimal environment for businesses, featuring high-quality and fully furnished floors with meeting rooms, a large kitchen and breakout areas.

The building provides amenities such as gated access, cycle storage and shower facilities.

## Location

Shoreditch and Hoxton provides numerous local amenities such as restaurants, cafes, shops and bars.

Conveniently positioned in the tech and creative hub of Hoxton/Shoreditch, the office is just a short walk from Hoxton station and Old Street tube station.

## Accommodation

The accommodation comprises the following areas:

Name	sq ft	sq m	Availability
Ground	5,371	498.98	Available
1st	7,319	679.96	Available
<b>Total</b>	<b>12,690</b>	<b>1,178.94</b>	



**Sam Wash**

01234567890 | 07777777777

testing+7348@kato.app

