

## 1-3 UPPER JAMES STREET, SOHO, W1F

Office To Let – 4,178 sq. ft.

**Plug and play media style office.**



### LOCATION

Located on the corner of Upper James Street and Beak Street in the heart of Soho. With Golden Square to the south and Carnaby Street to the north, the property benefits from the superb leisure facilities of Soho such as restaurants, bars and flagship retail stores.

Oxford Circus, Tottenham Court Road and Piccadilly tube stations are all within a 10 minute walk, offering links to the Central, Bakerloo, Northern, Victoria and Piccadilly lines.

### DESCRIPTION

The first floor offers an accommodation of 4,178 sq. ft. of high quality media style office space, with great levels of natural light. The building comprises 7 floors (Basement to 5<sup>th</sup>).

The floor is mainly open plan with internal meeting rooms and a break out area.

Misrepresentation Act 1967. Montagu Evans LLP for themselves and for the vendors or lessors of this property whose agents they are, give notice that: (i) The particulars are set out as a general guideline only for the guidance of intending purchasers or lessees and do not constitute the whole or any part of an offer or contract. (ii) All descriptions, dimensions, references to condition and necessary permissions of the use and occupation, and other details are given in good faith without responsibility whatsoever and any intending purchasers or tenants should not rely on them as statements or representations of fact, but must satisfy themselves by inspection or otherwise as to the correctness of each of them. (iii) Neither Montagu Evans LLP nor their employees has any authority to make or give any representation or warranties whatsoever in relation to the property. (iv) Unless otherwise stated, all prices and rents are quoted exclusive of VAT and intending purchasers or lessees must satisfy themselves independently as to the applicable VAT position. (v) All the plans and maps provided within the particulars are for identification purposes only. Generated on 07/02/2020

### TRANSPORT LINKS

Piccadilly Circus  4 minutes

Oxford Circus  7 minutes

Tottenham Court Road  11 minutes

### AMENITIES

The accommodation benefits from the following amenities:

- Air cooling
- Raised floor
- Fully fitted
- Meeting rooms
- Kitchenettes
- Demised WC's
- Passenger lift

### AVAILABILITY

1<sup>st</sup> floor – 4,178 sq. ft.

2<sup>nd</sup> floor – 4,178 sq. ft.

### TERMS

Available by way of a flexible sublease.

**Rent:** £75.00 per sq. ft.

**Rates:** £31.00 per sq. ft.

**Service charge:** £12.00 per sq. ft.

### CONTACT

For further information or to arrange a viewing please contact:

**Angus Marlow-Thomas: 020 7866 8612**

[angus.marlow-thomas@montagu-evans.co.uk](mailto:angus.marlow-thomas@montagu-evans.co.uk)

**Katie Stewart: 020 7866 8692**

[katie.stewart@montagu-evans.co.uk](mailto:katie.stewart@montagu-evans.co.uk)

**Lucie Sergeant: 07920417991**

[lucie.sergeant@montagu-evans.co.uk](mailto:lucie.sergeant@montagu-evans.co.uk)

## PHOTOGRAPHS



## FLOOR PLANS

### FIRST FLOOR

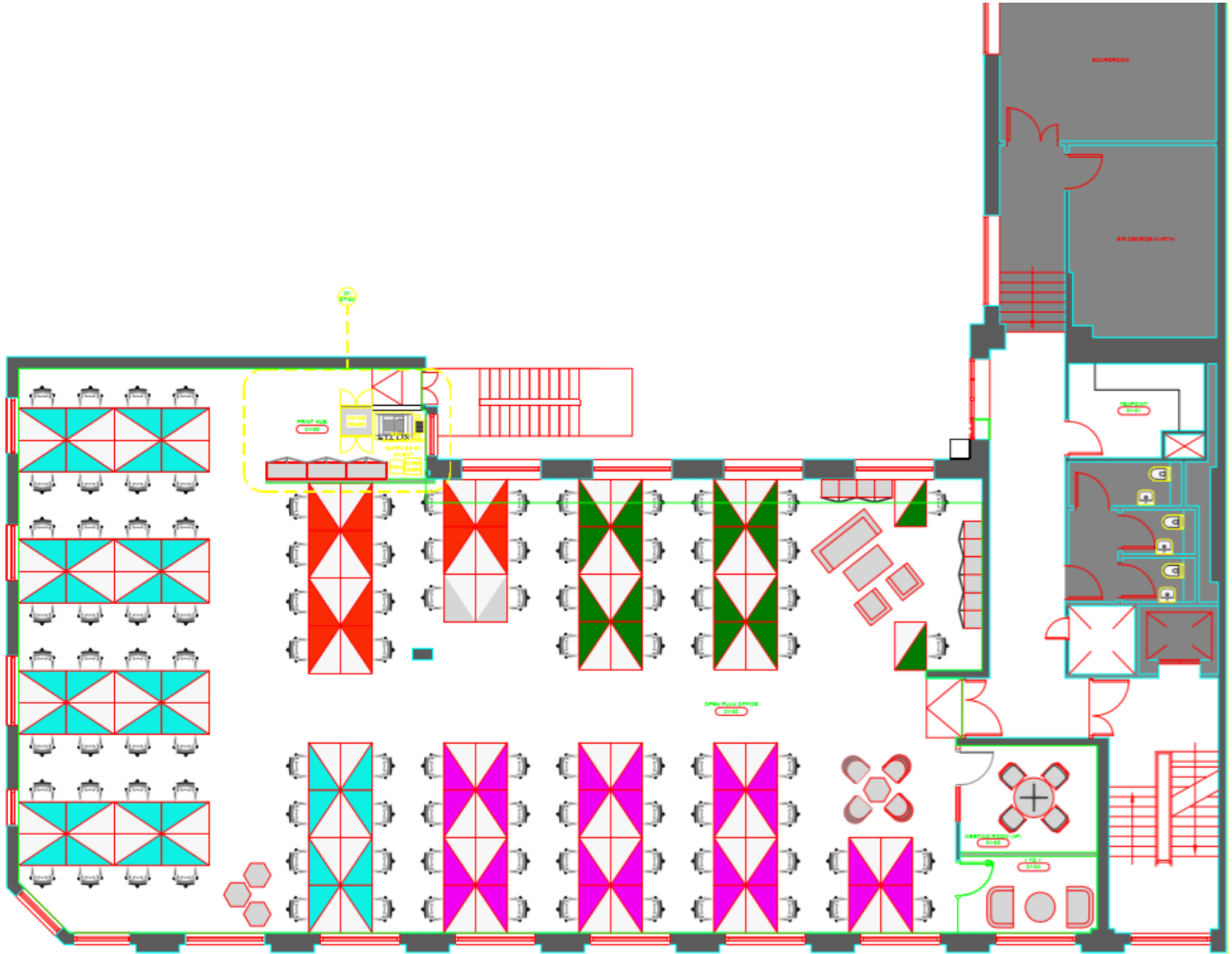

**SECOND FLOOR**

