

**Notes:**

1. All structural elements to be confirmed by Engineer.
2. Drawing to be read in conjunction with schedule of works/specifications.

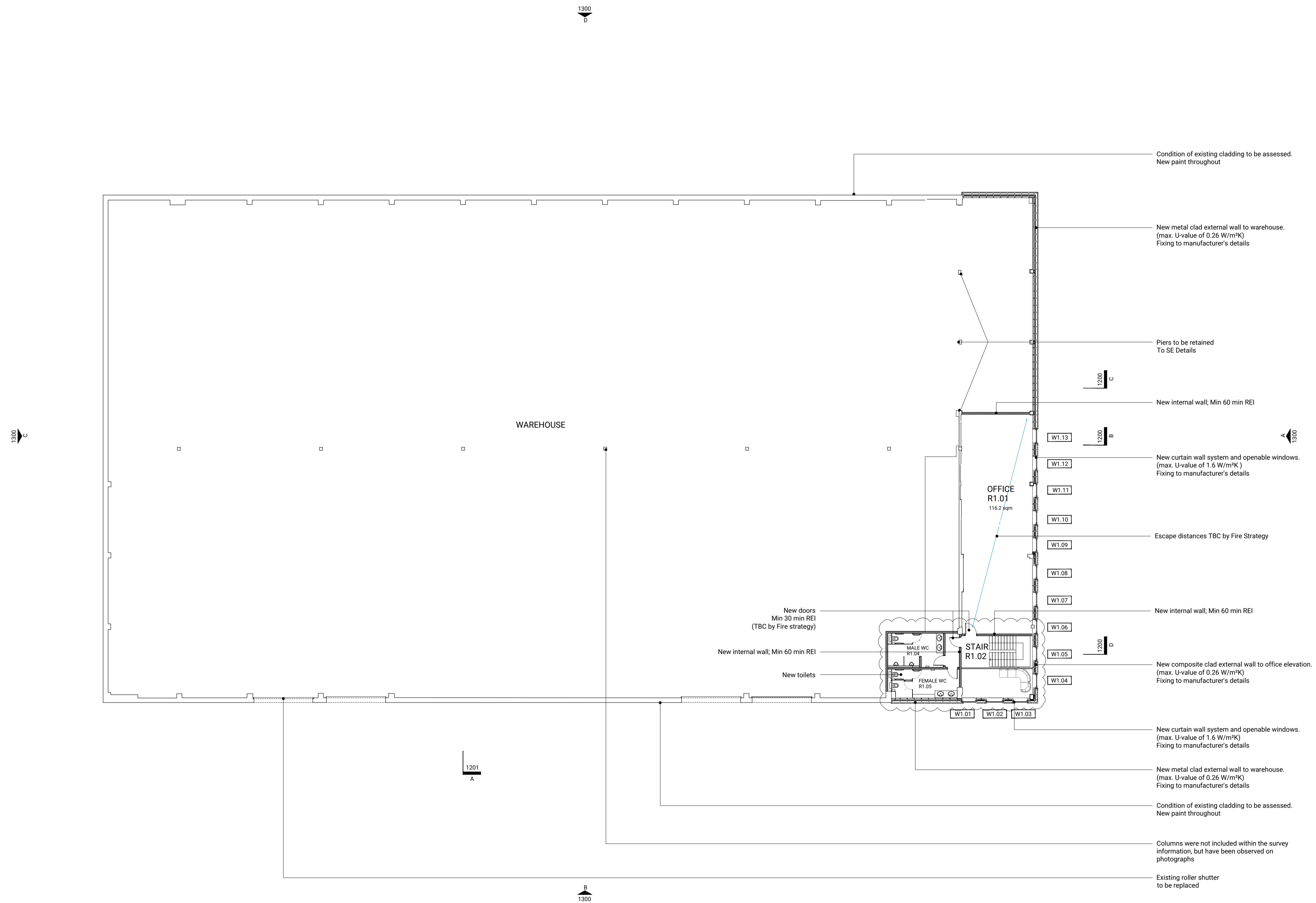

**Note/Heading:**

Assumptions have been made with regard to the existing structure. These will need to be confirmed during investigative works on site.  
 All structure to be confirmed by a Structural Engineer.  
 Architectural design to Cat A only. Cat B layout shown for reference only.

REV.	DATE	ISSUE
T0	29.08.25	For comment
T1	31.10.25	Stage 3 issue
T2	19.12.25	Stage 4 issue
T3	20.01.26	Section marker added
T4	30.01.26	WC block added
T5	17.02.26	Layout amended

**552 FAIRLIE ROAD**  
 Slough Trading Estate, SL1 4PY

**Proposed First Floor Plan**

STATUS	SIZE	REV.
Tender	A1	T5

DRAWING NO.  
**24453-FA-XX-00-DR-A-01101**

