

PRIOR TO THE COMMENCEMENT OF ANY WORKS, THE BUILDER IS TO CHECK AND/OR DETERMINE ALL CONSTRUCTION DETAILS, INCLUDING CHECKING EXISTING SITE LEVELS AND DIMENSIONS. THE DRAWING IS TO BE READ IN CONJUNCTION WITH ALL OTHER PROJECT DRAWINGS, CONSTRUCTION NOTES AND/OR PROJECT SPECIFICATION. ALL DISCREPANCIES SHOULD BE REPORTED IMMEDIATELY.

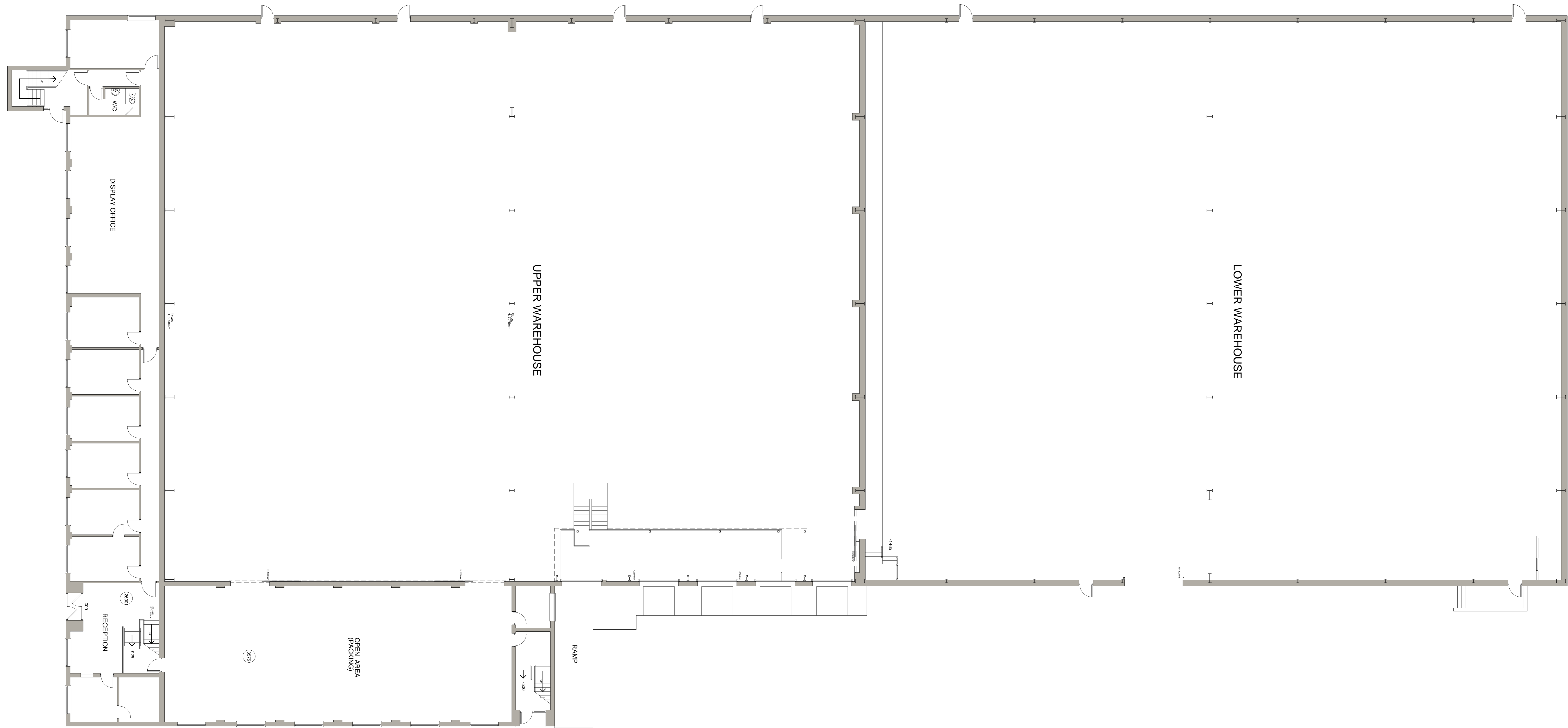

GROUND FLOOR PLAN 1:100 @ A0

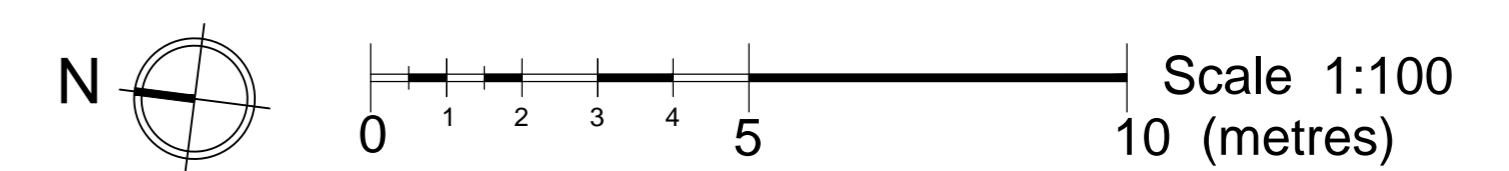

Revision Date Description By



STP Solutions, 19 The Row, Main Road, Eberndrope, Kent, TN8 8PX  
T: 020 8666 9522 E: info@stp-solutions.co.uk www.stp-solutions.co.uk

Client

Project Title  
Western House  
Armstrong Road  
Daneshill Industrial Estate  
Basingstoke, RG24 8QE

Drawing Title  
Existing Ground Floor

Scale 1:100 @ A1 Date 2020-07-22 Drawn By RDC  
CAD Reference STP2020-WH01-01.dwg  
Drawing Number STP2020-WH01-01 Revision

Preliminary  For Approval  Construction  
 For Information  Tender  As Built

THIS DRAWING IS THE COPYRIGHT OF STP SOLUTIONS AND MUST NOT BE USED IN CONJUNCTION WITH ANY OTHER PROJECT WITHOUT WRITTEN CONSENT