



TARGET
BREEAM®
OUTSTANDING

Logistics City Milton Keynes



Milton Keynes

TO LET | MK15 8HQ

AVAILABLE NOW

- 126,106 sq ft
- Grade A logistics building adjacent to the M1 motorway
- 'Net Zero Carbon' in Construction
- Targeting BREEAM 'Outstanding'

///masterpiece.respects.superbly



Logistics City Milton Keynes

Welcome to Logistics City Milton Keynes

A brand new, market-leading distribution and logistics unit in a prime M1 location. Totalling 126,106 sq ft (11,715 sq m) the development is situated on Michigan Drive with prominence onto the M1 motorway, and only a 5 minute (1.9 miles) drive

to J14 of the M1. Developed with operational efficiencies and ESG features at the heart of its design to ensure that it meets the needs of industrial and logistics operators alike, now and in the future.

Scroll over each icon to show further information

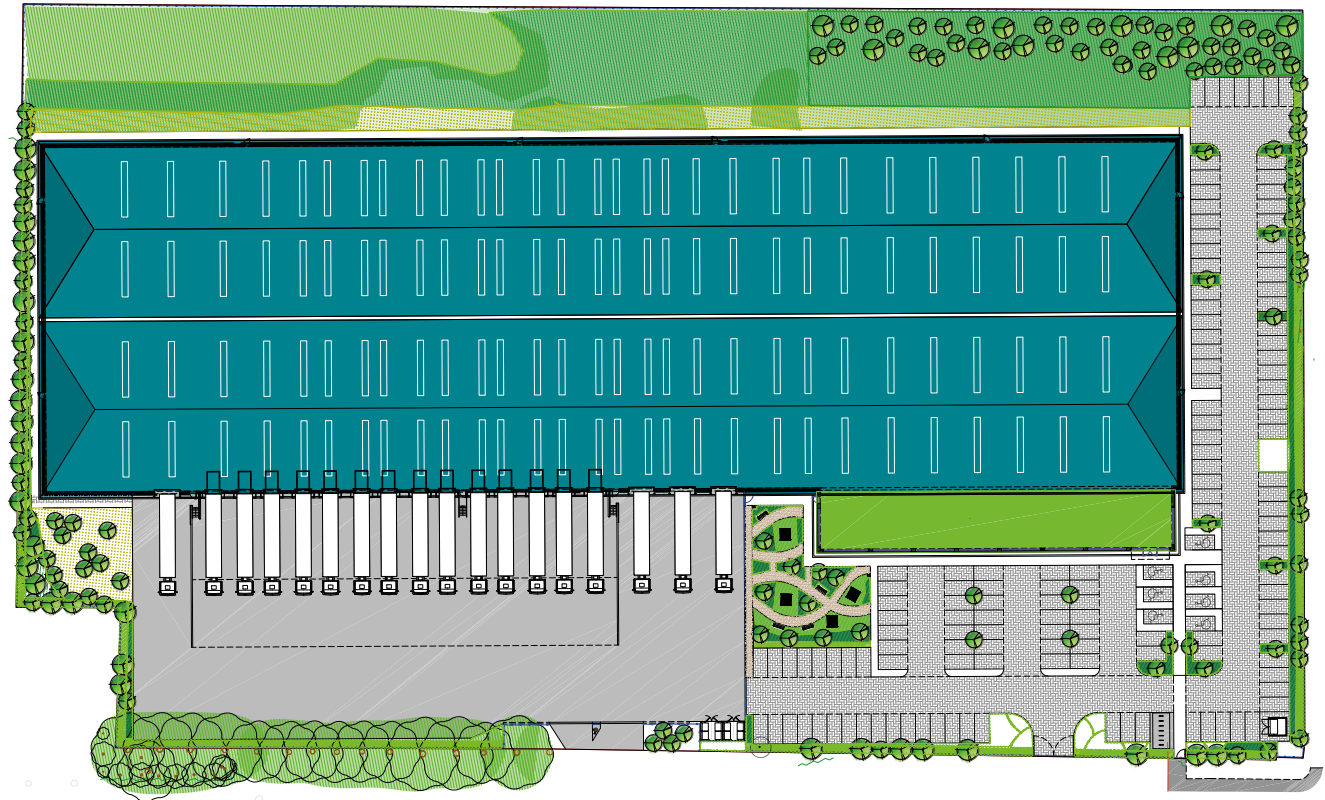

Accommodation

	Sq ft	Sq m
Logistic City MK (GEA)	126,106	11,715
Warehouse	112,950	10,493
Ground floor office	6,542	608
First floor office	6,614	614
Total	126,106	11,715
	Acres	HA
Site area	6.1	2.47

Indicative GEA areas



Scroll over each icon to show further information ▼

Sustainability

Our Trade City and Logistics City concepts have evolved to be market leading in terms of environmental credentials, ensuring our developments, and the materials used, are sustainable.

From the initial design through to the final completion, our units are built with sustainable materials and energy efficient features, ensuring a lower environmental impact as well as reduced end-costs for the user. Using recycled and low-carbon materials wherever possible.



Built to Net Zero Carbon Standards



Targeting BREEAM Outstanding



Solar PV cells

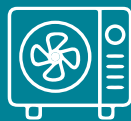

Air-source heat pump



High efficiency LED lighting



Grade A offices with green roof



Cycle storage



Electric vehicle charging



Target EPC Rating of A+



Highly efficient building, reducing costs



Sustainably sourced construction materials



Built for efficiency

Reducing environmental impact

A large, modern industrial building with a grey corrugated metal facade and a long row of windows. In the foreground, there is an outdoor seating area with several wooden picnic tables and benches, a paved path, and a brown trash can. The area is landscaped with green grass and young trees. The sky is blue with scattered white clouds.

Prioritising well-being



M1 J14

Only 1.9 miles
(5 mins)

Logistics City Milton Keynes

**Prominently placed and
strategically located**

Logistics City Milton Keynes' ideal location makes it extremely well placed to serve the majority of the UK within 4.5 hours HGV drive time, 87% of the population, making it a prime logistics location.



HGV drive times

- 1 hour
- 2 hours
- 3 hours

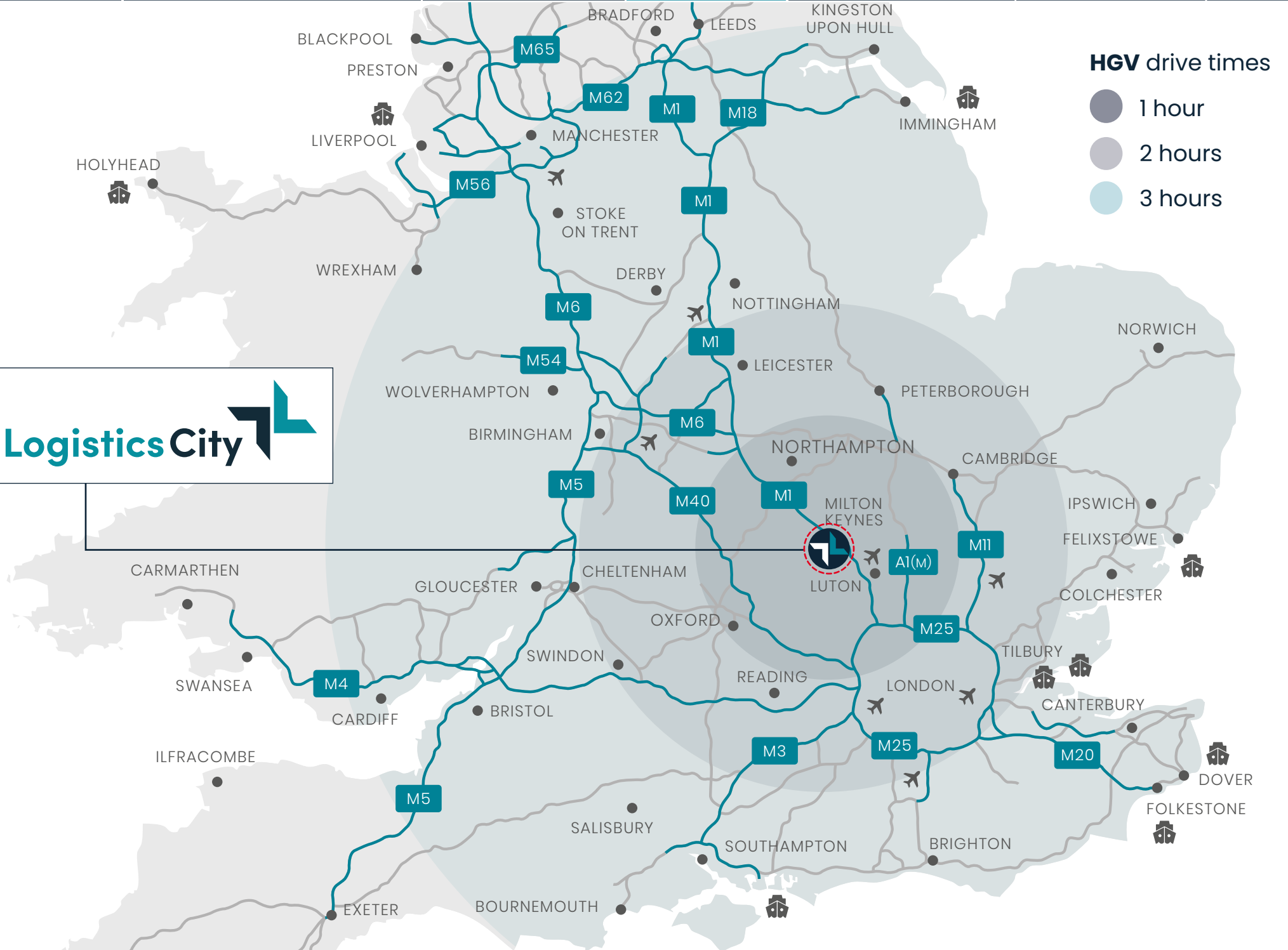

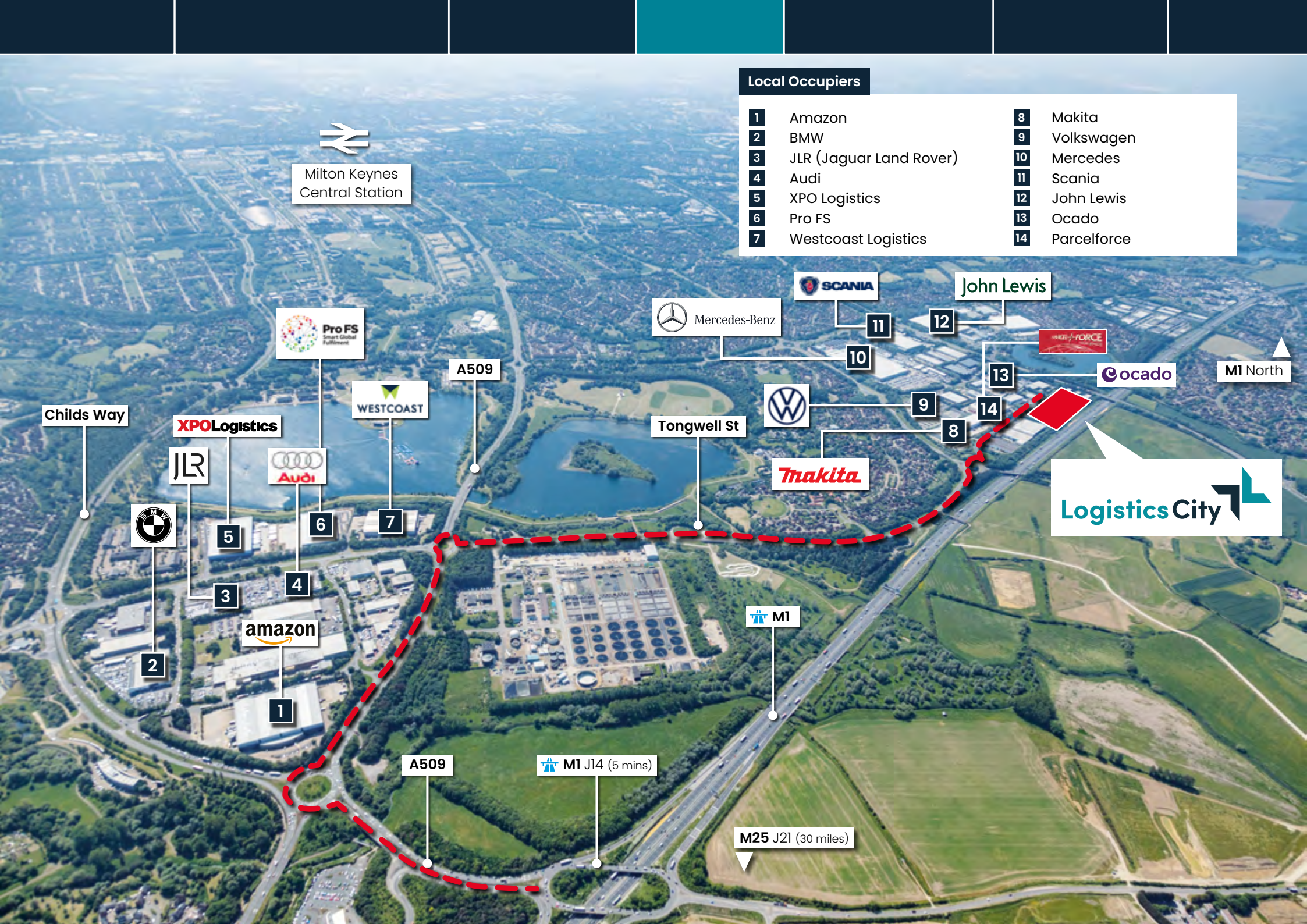

Local Occupiers

- | | | | |
|---|-------------------------|----|-------------|
| 1 | Amazon | 8 | Makita |
| 2 | BMW | 9 | Volkswagen |
| 3 | JLR (Jaguar Land Rover) | 10 | Mercedes |
| 4 | Audi | 11 | Scania |
| 5 | XPO Logistics | 12 | John Lewis |
| 6 | Pro FS | 13 | Ocado |
| 7 | Westcoast Logistics | 14 | Parcelforce |

Milton Keynes Central Station

Pro FS
Smart Global Fulfillment

WESTCOAST

A509

Childs Way

XPO Logistics

JLR

Audi

BMW

5

6

7

3

4

amazon

2

1

A509

M1 J14 (5 mins)

M25 J21 (30 miles)

Mercedes-Benz

SCANIA

John Lewis

11

12

WARRIOR FORCE

ocado

M1 North

VW

10

13

14

Tongwell St

Makita

9

8

Logistics City

M1

Drive times (by car)

Destination	Miles	Time
M1 Jct 14	1.9 miles	5 mins
MK Central Station	4.1 miles	9 mins
City Centre	4.4 miles	10 mins
M1 Jct 13	7 miles	12 mins
M25 Jct 21	30 miles	35 mins
London	51 miles	1 hr 10 mins
Birmingham	71 miles	1 hr 20 mins
Manchester	154 miles	2 hrs 50 mins

Drive times (Ports by HGV)

Destination	Miles	Time
Tilbury	76 miles	1 hr 25 mins
Southampton	106 miles	2 hrs 5 mins
Felixstowe	115 miles	2 hrs 10 mins
Liverpool	168 miles	3 hrs 5 mins

Train times (from Milton Keynes Central)

Destination	Time
London Euston	35 mins
Birmingham	55 mins
Manchester	1 hr 35 mins

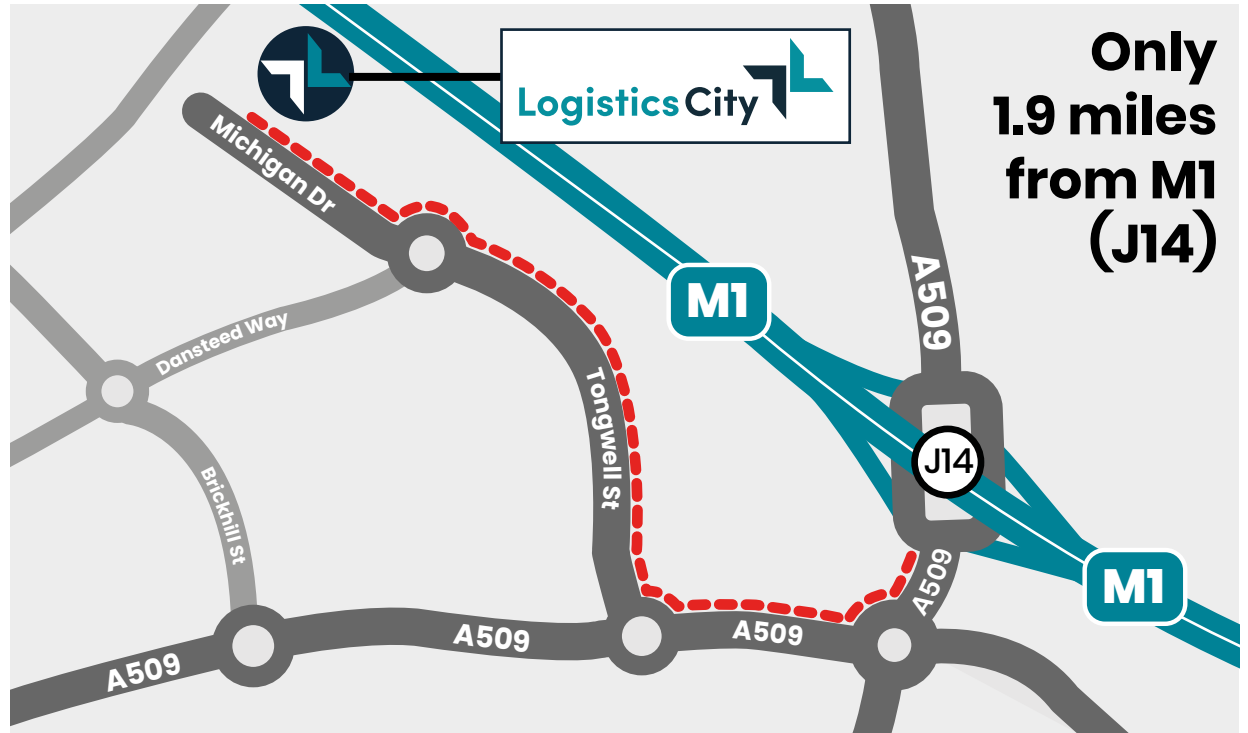

SatNav

1 Michigan Drive
Tongwell
Milton Keynes
MK15 8HQ

what3words

masterpiece.respects.superbly

**Population estimates
and projections:
30 min drive time catchment**

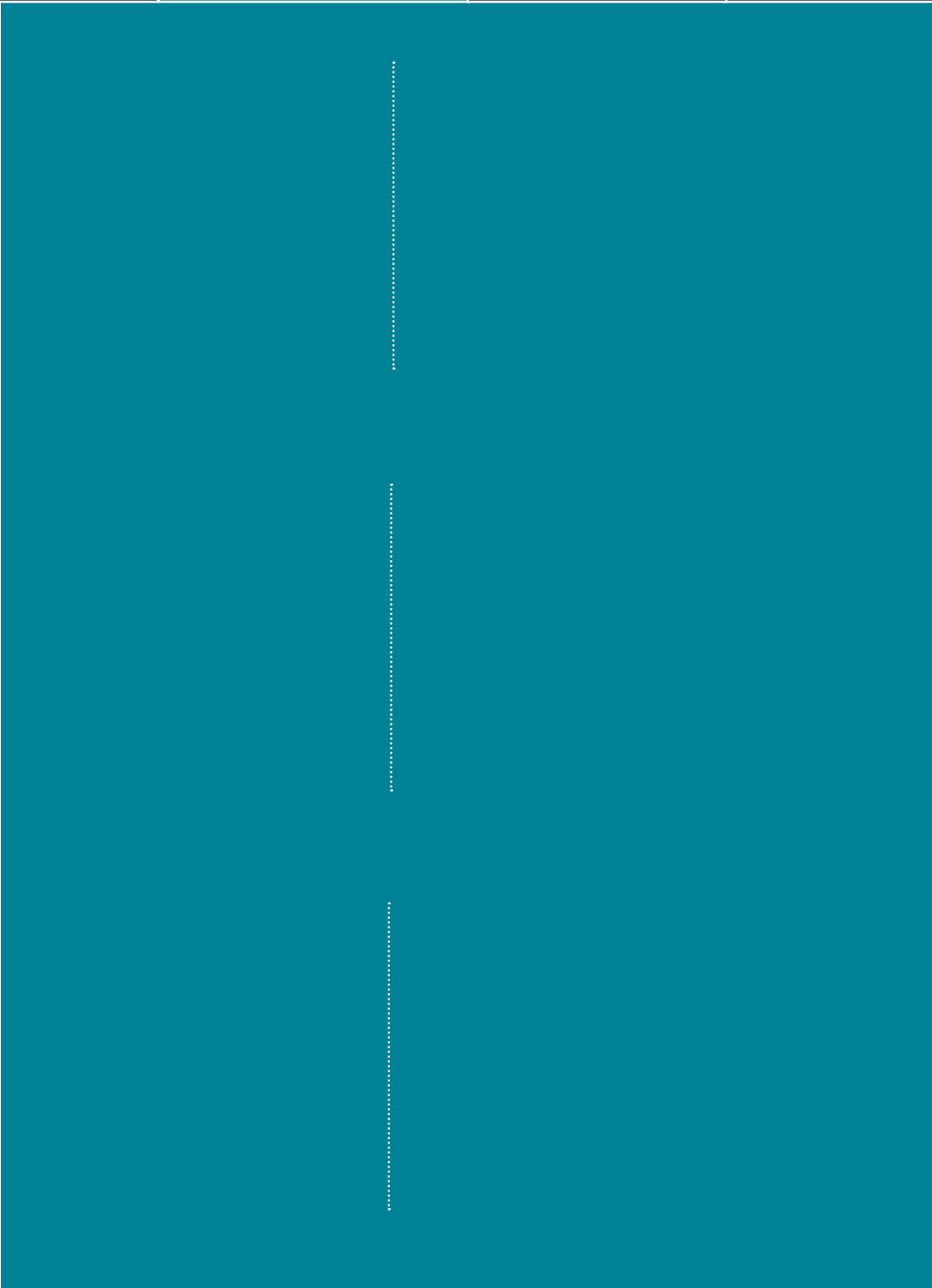



Logistics City Basingstoke

Kier Property in joint venture with Investec completed the development of Logistics City Basingstoke in April 2019. The scheme consisted of 109,235 sqft across three industrial units on a five-acre site.

Basingstoke is a dominant south east industrial centre benefiting from exceptional transport links via road, rail and air. Situated within one of the town's most recognised industrial/warehouse areas, close to (J6) M3.

A former office and distribution warehouse Kier Property let Unit A to Network Rail and Unit B to Oxoid Limited, who trade as Thermofisher. Both units were then sold to a private US Fund.



Tri-Link 140, Normanton

Kier's scheme provided an excellent industrial and warehouse opportunity, comprised of 142,338 sq ft facility incorporating 136,231 sq ft warehouse and 6,107 sq ft of office space.

Located in Wakefield, Europort is an established location at J31 of the M62. Tri-Link 140 is regarded as a flagship industrial and warehouse development that offered high quality buildings in a highly accessible and strategic motorway location.

The location benefited from the European rail freight access through the Europort freight terminal and has ready access to the deep water ports of Goole and Hull and five international airports within a one hour's drive.





Matt Ryan
Senior Development Manager
M 07936 031822
E Matt.Ryan@kier.co.uk

what3words
masterpiece.respects.superbly



Tom Fairlie
M 07747 441858
E tom.Fairlie@dtre.com

Jamie Durrant
M 07341 661962
E jamie.durrant@dtre.com

Sam Cooper
M 07880 585950
E sam.cooper@dtre.com



James Saxby
M 07801 667692
E james.Saxby@jll.com

Tom Watkins
M 07917 093167
E tom.watkins@jll.com

Raj Suresh
M 07928 507141
E raj.Suresh@jll.com



Akhtar Alibhai
M 07909 684801
E aalibhai@lsh.co.uk

Louis Day
M 07708 479451
E lday@lsh.co.uk

Joe Skinner
M 07739 973929
E jskinner@lsh.co.uk

SatNav

1 Michigan Drive
Tongwell
Milton Keynes
MK15 8HQ

All statements contained within these particulars are believed to be correct but their accuracy is not guaranteed nor do they form part of any contract or warranty. Unless specified to the contrary, interested parties should note the following: All dimensions, distances and floor areas are approximate and are given for guidance purposes only. May 2026.

Logistics City 
tradeandlogistics.co.uk

CERVIDAE



A Kier Property development