

GENERAL NOTES & COPYRIGHT NOTICE

This drawing is to be read in conjunction with all other relevant drawings, specifications and employers requirements documentation. Do not scale or measure from this drawing. Use figured dimensions only. All levels and dimensions to be checked on site. All levels / dimensional discrepancies are to be brought to the immediate attention of c2:concepts Ltd.

Responsibility cannot be accepted for alteration and / or deviation from this design without acknowledgment of c2:concepts Ltd. and the contractor must verify that the works can be executed as drawn and specified, before works are commenced. All workmanship and materials to be the best of their respective kind and at least equivalent to the appropriate British Standard Code of Practice.

Copyright reserved: This drawing may only be used for the client and location specified in the title block. All drawings and specifications related to this project are copyright of c2:concepts Ltd and may not in whole or part, be copied, distributed, reproduced, disclosed to any other third party without written consent from c2:concepts Ltd, or used for any other purpose than that agreed with c2 concepts Ltd, or used in any capacity by any third party without permission of c2 concepts Ltd. All parts of the drawings and documents referred to within this notice are covered by the Copyright, Designs and Patents Act 1988 and are owned in totality by c2 concepts Ltd.

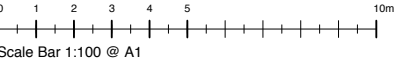

GENERAL NOTES:

1. ALL DIMENSIONS TO BE VERIFIED ON SITE PRIOR TO CONSTRUCTION

FLOOR FINISHES NOTES:

1. All floor finishes to be installed as per manufacturers recommendation.

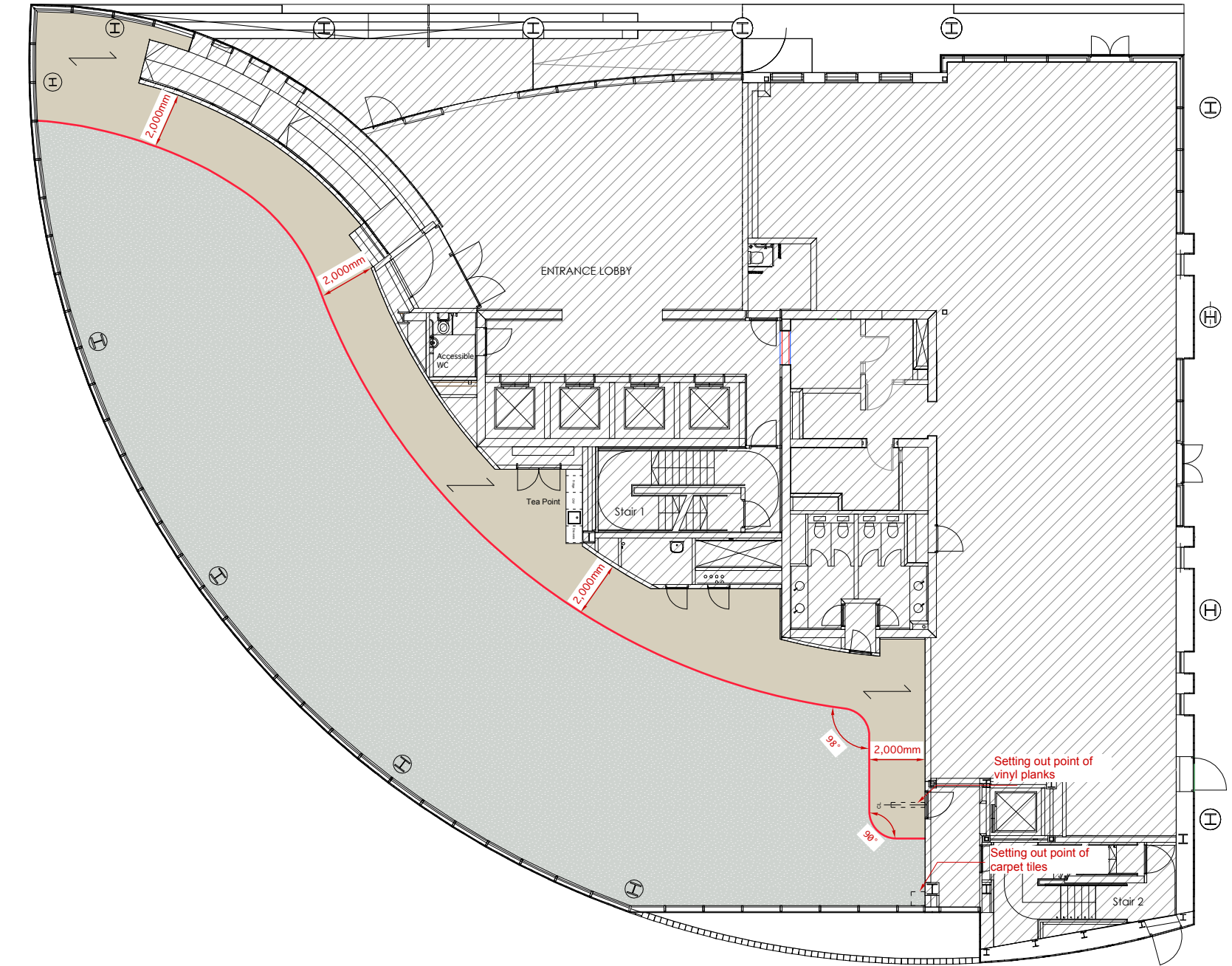

GROUND FLOOR - PROPOSED FLOORING LAYOUT

Scale 1:100 @ A1

FLOOR FINISHES KEY



NOT In scope

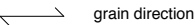

grain direction

(F1)



Carpet tiles

Manufacturer: ShawContract
Collection: Floor Architecture III
Style: Fragment Colours 5T505
Colour: Oatmeal (LRV 27.0)
Code: 04111
Size: 500mm x 500mm

Approx 326 sqm

Alternative to floor adhesive
Manufacturer: IOBAC MagTab - Self
adhesive magnetic tabs
Colour: Black
Contat: lan@iobac.com / 07703 132 4494

(F2)



Timber Vinyl Planks

Manufacturer: Karndean
Collection: Van Gogh
Colour: Natural Prime Oak (LRV 35)
Code: VGW121T
Size: Approx 1219mm x 178mm

Allow for 6mm plywood substrate

Approx 108 sqm

(T1)



Transition Strips

New transition strip from vinyl to carpet tile
Manufacturer: Gradus
Code: ET806
Finish: Silver Anodised Aluminium

Revisions:	
------------	--

Status	TENDER
--------	--------



c2:concepts
Consulting, creative.
www.c2concepts.co.uk

• Glasgow: 0141 221 9229
Queens House, 29 St Vincent Place
Glasgow, G1 2DT
London: 0203 011 1984
Henry Wood House, 2 Riding House St
London, W1W 7FA

Project	Name Street Town Postcode
---------	------------------------------------

Client	Name / Logo
--------	-------------

Title	Ground Floor Proposed Floor Finishes Layout
-------	--

Drawn	Checked	Date
ZP	JC	24.04.24

Scale	Project no.	Drawing no.	Rev.
1:xxx @ A1	c2:1063	AL(43)G.01	-