

**GENERAL NOTES**

1. CONSULT OWNER THE CONTRACT AND ALL OTHER APPLICABLE PROVISIONS.
2. THE CONTRACTOR SHALL BE RESPONSIBLE FOR OBTAINING ALL NECESSARY PERMITS AND APPROVALS FOR CONSTRUCTION OF THIS PROJECT TO COMPLY WITH ALL APPLICABLE LOCAL, STATE, AND FEDERAL REGULATIONS AND ORDINANCES.
3. THE CONTRACTOR SHALL BE RESPONSIBLE FOR OBTAINING ALL NECESSARY PERMITS AND APPROVALS FOR CONSTRUCTION OF THIS PROJECT TO COMPLY WITH ALL APPLICABLE LOCAL, STATE, AND FEDERAL REGULATIONS AND ORDINANCES.
4. THE CONTRACTOR SHALL BE RESPONSIBLE FOR OBTAINING ALL NECESSARY PERMITS AND APPROVALS FOR CONSTRUCTION OF THIS PROJECT TO COMPLY WITH ALL APPLICABLE LOCAL, STATE, AND FEDERAL REGULATIONS AND ORDINANCES.
5. THE CONTRACTOR SHALL BE RESPONSIBLE FOR OBTAINING ALL NECESSARY PERMITS AND APPROVALS FOR CONSTRUCTION OF THIS PROJECT TO COMPLY WITH ALL APPLICABLE LOCAL, STATE, AND FEDERAL REGULATIONS AND ORDINANCES.
6. THE CONTRACTOR SHALL BE RESPONSIBLE FOR OBTAINING ALL NECESSARY PERMITS AND APPROVALS FOR CONSTRUCTION OF THIS PROJECT TO COMPLY WITH ALL APPLICABLE LOCAL, STATE, AND FEDERAL REGULATIONS AND ORDINANCES.
7. THE CONTRACTOR SHALL BE RESPONSIBLE FOR OBTAINING ALL NECESSARY PERMITS AND APPROVALS FOR CONSTRUCTION OF THIS PROJECT TO COMPLY WITH ALL APPLICABLE LOCAL, STATE, AND FEDERAL REGULATIONS AND ORDINANCES.
8. THE CONTRACTOR SHALL BE RESPONSIBLE FOR OBTAINING ALL NECESSARY PERMITS AND APPROVALS FOR CONSTRUCTION OF THIS PROJECT TO COMPLY WITH ALL APPLICABLE LOCAL, STATE, AND FEDERAL REGULATIONS AND ORDINANCES.
9. THE CONTRACTOR SHALL BE RESPONSIBLE FOR OBTAINING ALL NECESSARY PERMITS AND APPROVALS FOR CONSTRUCTION OF THIS PROJECT TO COMPLY WITH ALL APPLICABLE LOCAL, STATE, AND FEDERAL REGULATIONS AND ORDINANCES.
10. THE CONTRACTOR SHALL BE RESPONSIBLE FOR OBTAINING ALL NECESSARY PERMITS AND APPROVALS FOR CONSTRUCTION OF THIS PROJECT TO COMPLY WITH ALL APPLICABLE LOCAL, STATE, AND FEDERAL REGULATIONS AND ORDINANCES.



**ISSUE STAMP**

DATE	REVISION	DESCRIPTION/COMMENT
2/15/24	1	ISSUE FOR PERMIT
2/15/24	2	REVISIONS
2/15/24	3	REVISIONS
2/15/24	4	REVISIONS
2/15/24	5	REVISIONS
2/15/24	6	REVISIONS
2/15/24	7	REVISIONS
2/15/24	8	REVISIONS
2/15/24	9	REVISIONS
2/15/24	10	REVISIONS
2/15/24	11	REVISIONS
2/15/24	12	REVISIONS
2/15/24	13	REVISIONS
2/15/24	14	REVISIONS
2/15/24	15	REVISIONS
2/15/24	16	REVISIONS
2/15/24	17	REVISIONS
2/15/24	18	REVISIONS
2/15/24	19	REVISIONS
2/15/24	20	REVISIONS
2/15/24	21	REVISIONS
2/15/24	22	REVISIONS
2/15/24	23	REVISIONS
2/15/24	24	REVISIONS
2/15/24	25	REVISIONS
2/15/24	26	REVISIONS
2/15/24	27	REVISIONS
2/15/24	28	REVISIONS
2/15/24	29	REVISIONS
2/15/24	30	REVISIONS

**BRIGHTON SQUARE CENTURION GROUP**

**BRIGHTON SQUARE GROUND FLOOR (00)**

**FLOOR PLAN**

1150 sqft

SCALE	DATE	DESIGNED BY	DRAWN BY	CHECKED BY	DATE
1/8"=1'-0"	03/07/24	CD	ED	23/07/24	
23/04/24					REV



7

8

19

FIRE ESCAPE  
STAIRCASE



GENERAL NOTES

1. CONTRACTOR SHALL VERIFY ALL UTILITIES (ELECTRIC, WATER, GAS, SEWER) PRIOR TO COMMENCEMENT OF WORK.
2. ALL WORK SHALL BE COMPLETED WITHIN THE SPECIFIED TIME FRAME.
3. THE CONTRACTOR SHALL BE RESPONSIBLE FOR OBTAINING ALL NECESSARY PERMITS AND APPROVALS.
4. THE CONTRACTOR SHALL MAINTAIN ACCESS TO ALL ADJACENT PROPERTIES AT ALL TIMES.
5. THE CONTRACTOR SHALL PROTECT ALL EXISTING SERVICES AND STRUCTURES.
6. THE CONTRACTOR SHALL MAINTAIN A SAFE WORKING ENVIRONMENT AT ALL TIMES.
7. THE CONTRACTOR SHALL BE RESPONSIBLE FOR THE PROTECTION OF ALL ADJACENT PROPERTIES.
8. THE CONTRACTOR SHALL BE RESPONSIBLE FOR THE PROTECTION OF ALL EXISTING SERVICES AND STRUCTURES.
9. THE CONTRACTOR SHALL BE RESPONSIBLE FOR THE PROTECTION OF ALL ADJACENT PROPERTIES.
10. THE CONTRACTOR SHALL BE RESPONSIBLE FOR THE PROTECTION OF ALL EXISTING SERVICES AND STRUCTURES.

SITE / LOCATION PLAN

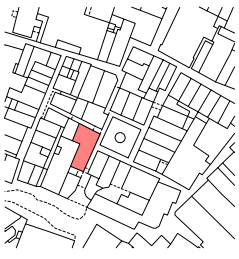
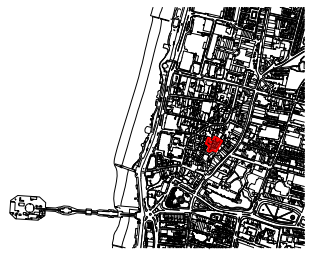

ISSUE STAMP

REVISIONS

DATE	REVISION	DESCRIPTION / COMMENT
20/04/24	1	ISSUE FOR PERMIT
15/04/24	2	REVISED PERMIT REQUIREMENTS
10/04/24	3	REVISED PERMIT REQUIREMENTS
05/04/24	4	REVISED PERMIT REQUIREMENTS
01/04/24	5	REVISED PERMIT REQUIREMENTS
28/03/24	6	REVISED PERMIT REQUIREMENTS
25/03/24	7	REVISED PERMIT REQUIREMENTS
22/03/24	8	REVISED PERMIT REQUIREMENTS
19/03/24	9	REVISED PERMIT REQUIREMENTS
16/03/24	10	REVISED PERMIT REQUIREMENTS
13/03/24	11	REVISED PERMIT REQUIREMENTS
10/03/24	12	REVISED PERMIT REQUIREMENTS
07/03/24	13	REVISED PERMIT REQUIREMENTS
04/03/24	14	REVISED PERMIT REQUIREMENTS
01/03/24	15	REVISED PERMIT REQUIREMENTS
28/02/24	16	REVISED PERMIT REQUIREMENTS
25/02/24	17	REVISED PERMIT REQUIREMENTS
22/02/24	18	REVISED PERMIT REQUIREMENTS
19/02/24	19	REVISED PERMIT REQUIREMENTS
16/02/24	20	REVISED PERMIT REQUIREMENTS
13/02/24	21	REVISED PERMIT REQUIREMENTS
10/02/24	22	REVISED PERMIT REQUIREMENTS
07/02/24	23	REVISED PERMIT REQUIREMENTS
04/02/24	24	REVISED PERMIT REQUIREMENTS
01/02/24	25	REVISED PERMIT REQUIREMENTS
29/01/24	26	REVISED PERMIT REQUIREMENTS
26/01/24	27	REVISED PERMIT REQUIREMENTS
23/01/24	28	REVISED PERMIT REQUIREMENTS
20/01/24	29	REVISED PERMIT REQUIREMENTS
17/01/24	30	REVISED PERMIT REQUIREMENTS
14/01/24	31	REVISED PERMIT REQUIREMENTS
11/01/24	32	REVISED PERMIT REQUIREMENTS
08/01/24	33	REVISED PERMIT REQUIREMENTS
05/01/24	34	REVISED PERMIT REQUIREMENTS
02/01/24	35	REVISED PERMIT REQUIREMENTS
30/12/23	36	REVISED PERMIT REQUIREMENTS
27/12/23	37	REVISED PERMIT REQUIREMENTS
24/12/23	38	REVISED PERMIT REQUIREMENTS
21/12/23	39	REVISED PERMIT REQUIREMENTS
18/12/23	40	REVISED PERMIT REQUIREMENTS
15/12/23	41	REVISED PERMIT REQUIREMENTS
12/12/23	42	REVISED PERMIT REQUIREMENTS
09/12/23	43	REVISED PERMIT REQUIREMENTS
06/12/23	44	REVISED PERMIT REQUIREMENTS
03/12/23	45	REVISED PERMIT REQUIREMENTS
30/11/23	46	REVISED PERMIT REQUIREMENTS
27/11/23	47	REVISED PERMIT REQUIREMENTS
24/11/23	48	REVISED PERMIT REQUIREMENTS
21/11/23	49	REVISED PERMIT REQUIREMENTS
18/11/23	50	REVISED PERMIT REQUIREMENTS
15/11/23	51	REVISED PERMIT REQUIREMENTS
12/11/23	52	REVISED PERMIT REQUIREMENTS
09/11/23	53	REVISED PERMIT REQUIREMENTS
06/11/23	54	REVISED PERMIT REQUIREMENTS
03/11/23	55	REVISED PERMIT REQUIREMENTS
31/10/23	56	REVISED PERMIT REQUIREMENTS
28/10/23	57	REVISED PERMIT REQUIREMENTS
25/10/23	58	REVISED PERMIT REQUIREMENTS
22/10/23	59	REVISED PERMIT REQUIREMENTS
19/10/23	60	REVISED PERMIT REQUIREMENTS
16/10/23	61	REVISED PERMIT REQUIREMENTS
13/10/23	62	REVISED PERMIT REQUIREMENTS
10/10/23	63	REVISED PERMIT REQUIREMENTS
07/10/23	64	REVISED PERMIT REQUIREMENTS
04/10/23	65	REVISED PERMIT REQUIREMENTS
01/10/23	66	REVISED PERMIT REQUIREMENTS
28/09/23	67	REVISED PERMIT REQUIREMENTS
25/09/23	68	REVISED PERMIT REQUIREMENTS
22/09/23	69	REVISED PERMIT REQUIREMENTS
19/09/23	70	REVISED PERMIT REQUIREMENTS
16/09/23	71	REVISED PERMIT REQUIREMENTS
13/09/23	72	REVISED PERMIT REQUIREMENTS
10/09/23	73	REVISED PERMIT REQUIREMENTS
07/09/23	74	REVISED PERMIT REQUIREMENTS
04/09/23	75	REVISED PERMIT REQUIREMENTS
01/09/23	76	REVISED PERMIT REQUIREMENTS
29/08/23	77	REVISED PERMIT REQUIREMENTS
26/08/23	78	REVISED PERMIT REQUIREMENTS
23/08/23	79	REVISED PERMIT REQUIREMENTS
20/08/23	80	REVISED PERMIT REQUIREMENTS
17/08/23	81	REVISED PERMIT REQUIREMENTS
14/08/23	82	REVISED PERMIT REQUIREMENTS
11/08/23	83	REVISED PERMIT REQUIREMENTS
08/08/23	84	REVISED PERMIT REQUIREMENTS
05/08/23	85	REVISED PERMIT REQUIREMENTS
02/08/23	86	REVISED PERMIT REQUIREMENTS
30/07/23	87	REVISED PERMIT REQUIREMENTS
27/07/23	88	REVISED PERMIT REQUIREMENTS
24/07/23	89	REVISED PERMIT REQUIREMENTS
21/07/23	90	REVISED PERMIT REQUIREMENTS
18/07/23	91	REVISED PERMIT REQUIREMENTS
15/07/23	92	REVISED PERMIT REQUIREMENTS
12/07/23	93	REVISED PERMIT REQUIREMENTS
09/07/23	94	REVISED PERMIT REQUIREMENTS
06/07/23	95	REVISED PERMIT REQUIREMENTS
03/07/23	96	REVISED PERMIT REQUIREMENTS
30/06/23	97	REVISED PERMIT REQUIREMENTS
27/06/23	98	REVISED PERMIT REQUIREMENTS
24/06/23	99	REVISED PERMIT REQUIREMENTS
21/06/23	100	REVISED PERMIT REQUIREMENTS



BRIGHTON SQUARE  
BASEMENT (01)

FLOOR PLAN  
POTENTIAL BASEMENT FOR 5

SCALE	DATE	DESIGNED BY	DRAWN BY	CHECKED BY	DATE
1:500 (A1)	02/07/24	CD	ED	23/07/24	
230424					