

**CRAFTING THE  
PARK OF TOMORROW**

**THE HEAL'S BUILDING**  
**FITZROVIA W1**



# A PLACE TO INSPIRE

For over 200 years, The Heal's Building has been a hub for British design and creativity. Today, it has been reimagined as a 200,000 sq ft destination for contemporary brands shaping what comes next.

Blending heritage character with a modern, hospitality-inspired offer, it provides a rich ecosystem of shared spaces - from a café bar and private landscaped courtyard to a communal club lounge, and dedicated cycle facilities - designed for connection, culture and experience.

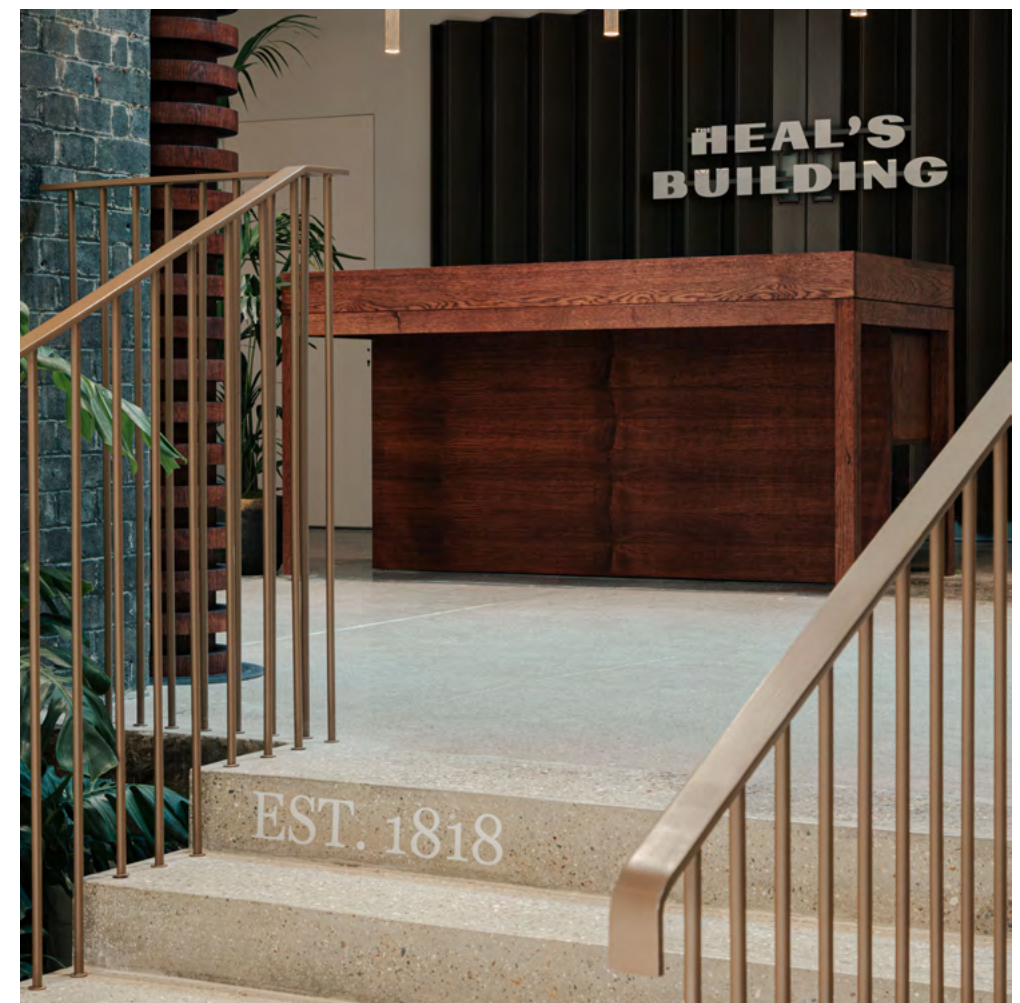
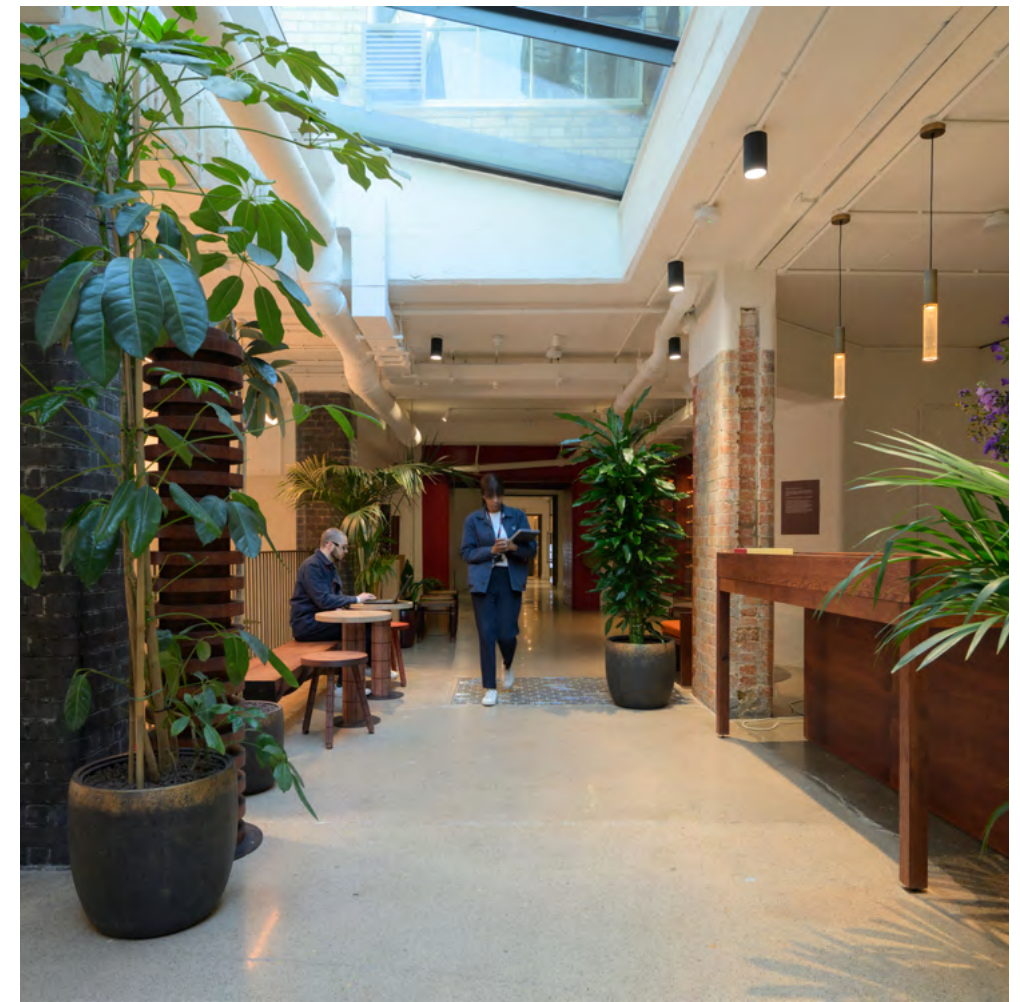

The 200-year-old dispatch area for Heal's has been repurposed into a new reception and cafe



# A COLLECTION OF DISTINCTIVE BUILDINGS

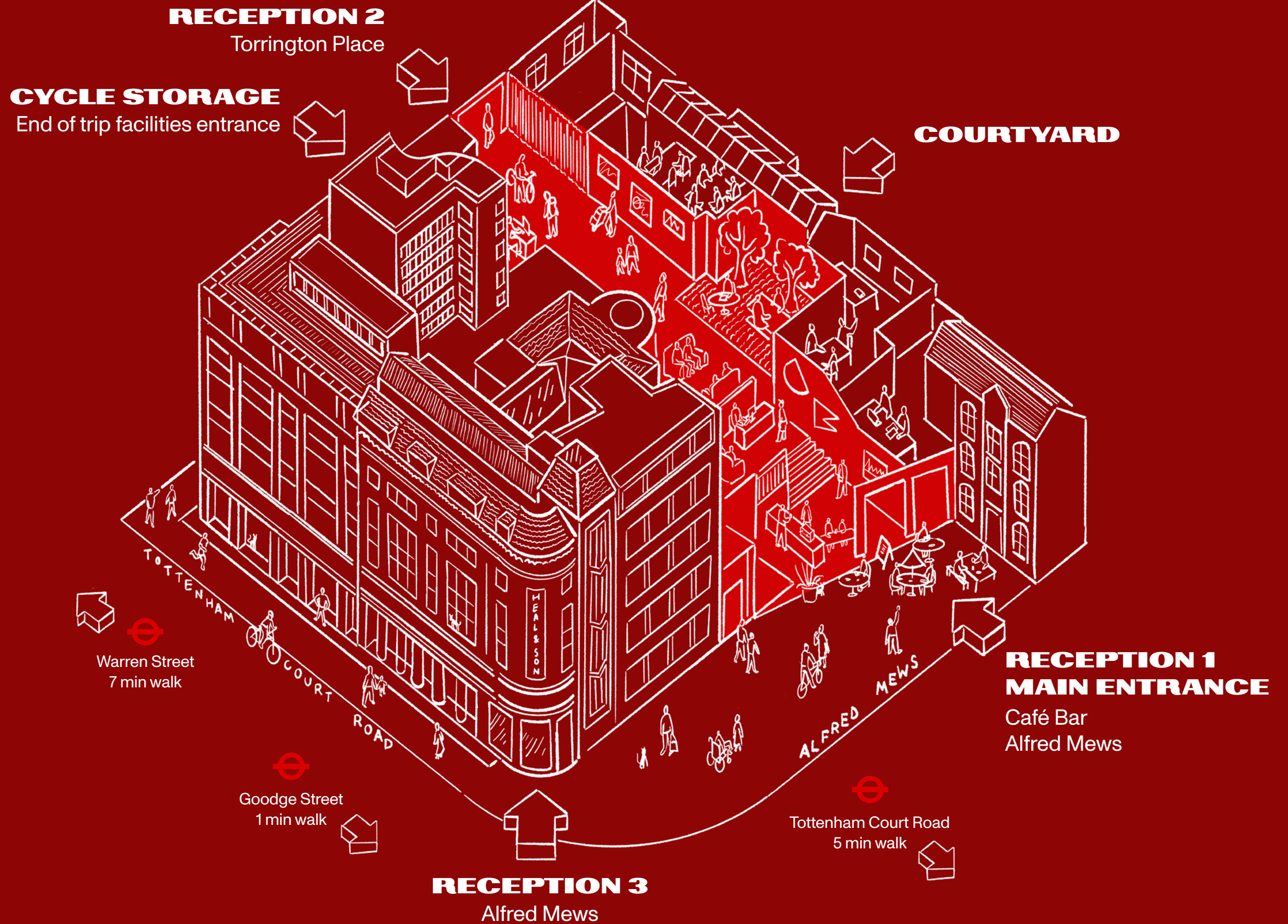

NORTH

# SELECTED HIGHLIGHTS



## CAFÉ

Reception area with café bar



## ENTRANCE

Self-contained entrance opportunity for **Unit 1**

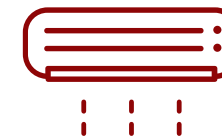

## REFURBISHED

CAT A+ Suite available on **Part 1<sup>st</sup> Floor**

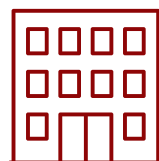

## GRADE II\*

Iconic Grade II\* listed building in the West End, sensitively restored



## END OF JOURNEY

Dedicated cycle entrance with 95 bike parking spots, 12 shower facilities, 98 lockers



## EFFICIENT

EPC A and BREEAM 'Excellent' rating on all newly delivered spaces

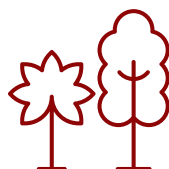

## COURTYARD

Landscaped communal courtyard

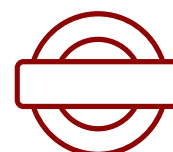

## CONNECTED

1 minute to Goodge Street and 5 minutes to Elizabeth Line at Tottenham Court Road



## LOCAL AMENITY

Surrounded by an unmatched retail, leisure and hospitality offering.

AVAILABILITY

TABLE

UNIT	FLOOR	SQ FT	SQ M	CONDITION
1	G	2,158	201	Shell
	LG	2,197	204	Shell
	Total	4,355	405	
2	G	1,372	128	Shell
	LG	3,588	333	Shell
	Total	4,960	461	
PART FIRST FLOOR	1	3,354	311	CAT A+

All areas subject to final measurement on completion of refurbishment works

# UNIT 1

## Areas

	sq ft	sq m
G	2,158	201
LG	2,197	204
Total	4,355	405



Ground



Lower Ground

- Demise
- Reception
- Common parts



NORTH



Graphical Scale 1:200



# UNIT ONE



UNIT 1 - Entrance

Unit 1 Ground Floor self-contained entrance CGI. A one of a kind blank canvas opportunity for an experience-led occupier



# UNIT 2

## Lower Ground Floor

	sq ft	sq m
G	1,372	128
LG	3,558	333
Total	4,960	461

- Demise
- Common parts
- Reception
- Courtyard
- Coworking



Ground

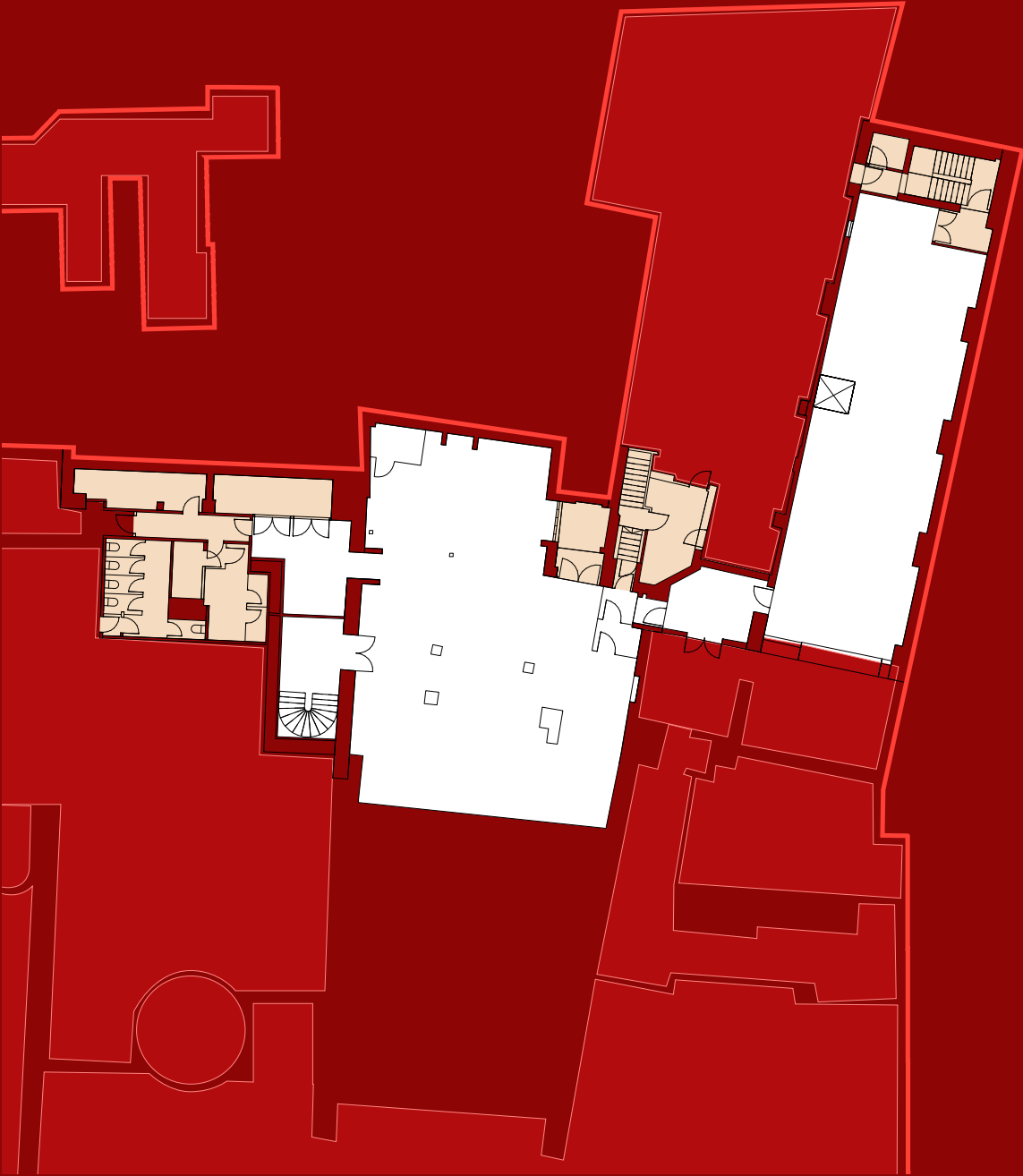

Lower Ground

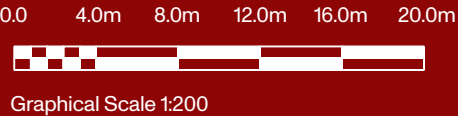





Unit 2 Ground Floor Arrival with internal staircase to Lower Ground Floor CGI



# PART FIRST FLOOR

1st Floor

3,354 sq ft / 311 sq m



- Demise
- Common parts



NORTH

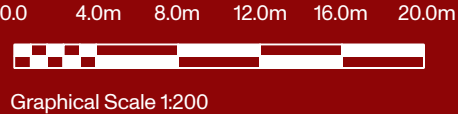

Graphical Scale 1:200



# PART FIRST FLOOR

1st Floor

3,354 sq ft / 311 sq m

Desks	30
Collab Areas	2
Meeting Rooms	1
Call Booths	1
Teapoints	1
Breakout	3



- Demise
- Common parts



NORTH

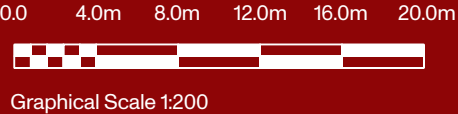



# PART FIRST FLOOR



Part First Floor CGIs for indicative purposes



# ARTS, CULTURE AND LEISURE

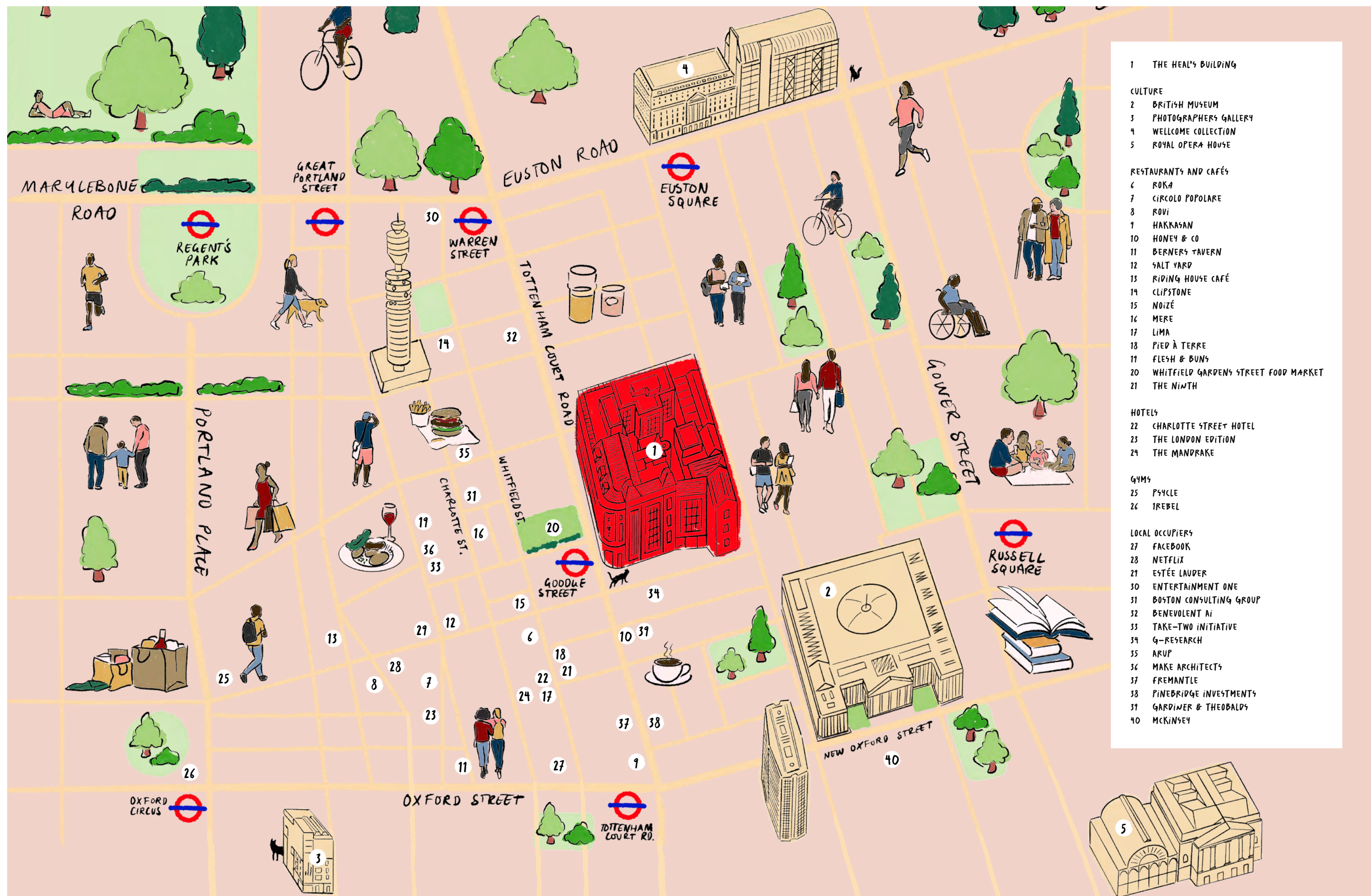

- 1 THE HEAL'S BUILDING
- CULTURE
- 2 BRITISH MUSEUM
- 3 PHOTOGRAPHERS GALLERY
- 4 WELLCOME COLLECTION
- 5 ROYAL OPERA HOUSE
- RESTAURANTS AND CAFÉS
- 6 ROKA
- 7 CIRCOLO POPOLARE
- 8 ROVI
- 9 HAKKASAN
- 10 HONEY & CO
- 11 BERNERS TAVERN
- 12 SALT YARD
- 13 RIDING HOUSE CAFÉ
- 14 CLIPSTONE
- 15 NOIZÉ
- 16 MERE
- 17 LIMA
- 18 PIED À TERRE
- 19 FLESH & BUNS
- 20 WHITFIELD GARDENS STREET FOOD MARKET
- 21 THE NINTH
- HOTELS
- 22 CHARLOTTE STREET HOTEL
- 23 THE LONDON EDITION
- 24 THE MANDRAKE
- Gyms
- 25 PSYCLE
- 26 TREBEL
- LOCAL OCCUPIERS
- 27 FACEBOOK
- 28 NETFLIX
- 29 ESTÉE LAUDER
- 30 ENTERTAINMENT ONE
- 31 BOSTON CONSULTING GROUP
- 32 BENEVOLENT AI
- 33 TAKE-TWO INITIATIVE
- 34 G-RESEARCH
- 35 ARUP
- 36 MAKE ARCHITECTS
- 37 FREMANTLE
- 38 PINEBRIDGE INVESTMENTS
- 39 GARDINER & THEOBALDS
- 40 MCKINSEY

# SUPERB CONNECTIVITY

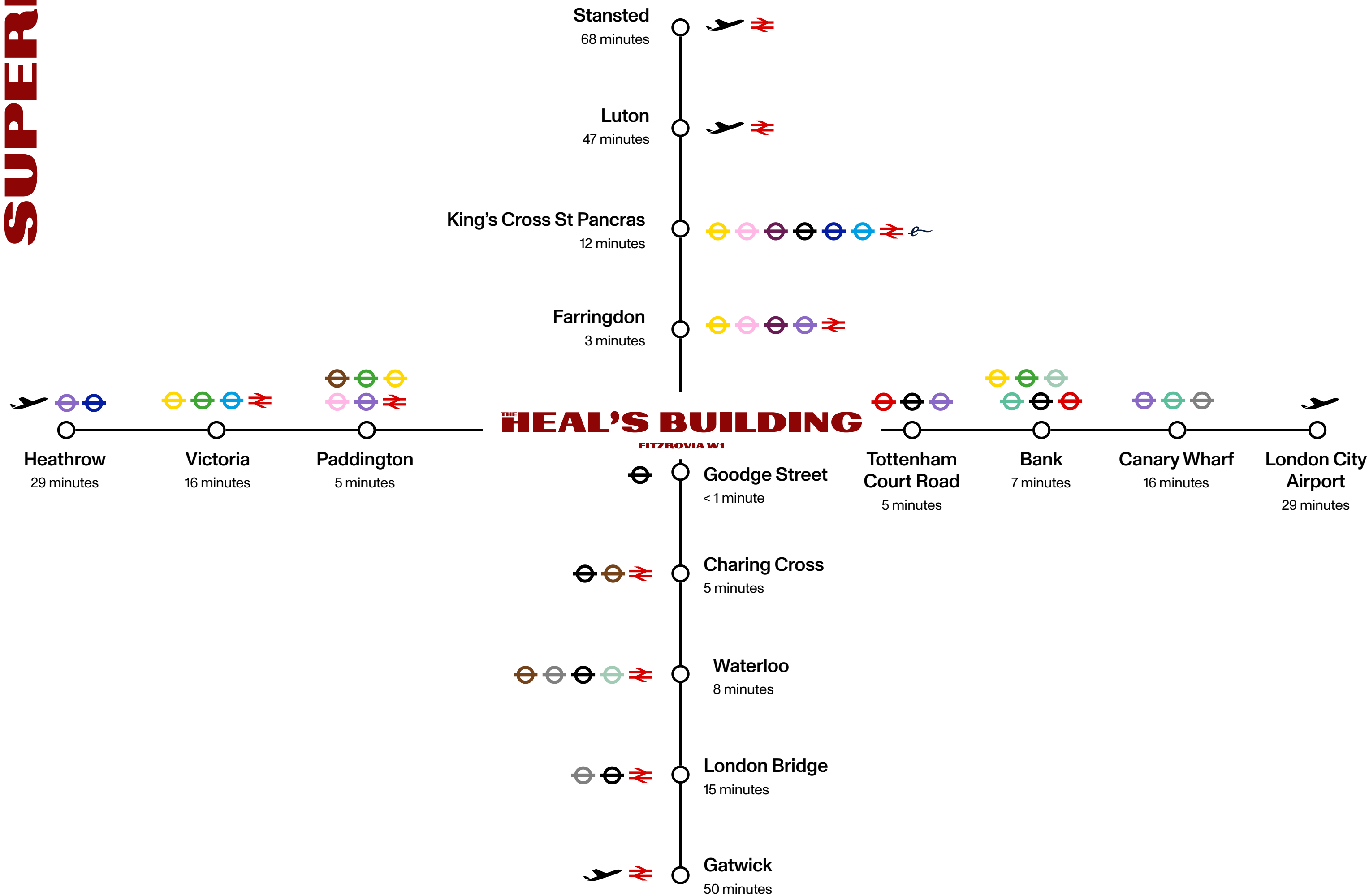



# CONTACT

Edward Charles  
Craig Norton  
+44 (0)7818 424 764  
cnorton@edwardcharles.co.uk

Ian Bradshaw  
+44 (0)7468 525 486  
ibradshaw@edwardcharles.co.uk

Amy Skidmore  
+44 (0)7734 924 146  
askidmore@edwardcharles.co.uk

RX London  
Ed Betts  
+44 (0)7771 513 169  
ed.betts@rx.london

Jack Rose  
+44 (0)7590 814 753  
jack.rose@rx.london

Alfie John  
+44 (0)7377 885 814  
alfie.john@rx.london

The Heal's Building  
196 Tottenham Court Rd  
W1T 7LQ London

[thehealsbuilding.com](http://thehealsbuilding.com)

Designed by a visionary team

**General Projects**  
General Projects is a contemporary real estate developer specialising in design and the thoughtful reinvention of places.

**Buckley Gray Yeoman**  
Buckley Gray Yeoman is one of London's leading architecture practices and has a track record of sensitive renewal of buildings such as One Poultry and YY London.

**THE HEAL'S BUILDING**  
**FITZROVIA W1**

Misrepresentation Act 1967 and Declaration Edward Charles and RX London for themselves and for the Vendors as Agents for the Vendors give notice that: 1. This information is set out as a general outline only for guidance to intending Purchasers and do not constitute any part of an offer or contract. 2. Details are given without any responsibility and any intending Purchasers or Third Parties should not rely on them as statements or representations of fact, but must satisfy themselves by inspection or otherwise as to the correctness of each of them. 3. No person in

the employment of Edward Charles and RX London has any authority to make any representation or warranty whatsoever in relation to this property. 4. Unless otherwise stated, all prices and rents are quoted exclusive of VAT. Subject to Contract. March 2024.

Design and production: [www.stuartchapmandesign.co.uk](http://www.stuartchapmandesign.co.uk) 020 3983 1665