



ECCLES M30 0DF

CHURCH ^{ST.} PLACE

6 brand new individual units available to let
From **863 sqft 1,055 sqft**

**Suitable for retail,
F&B use (STP)**

LOCATION AND DESCRIPTION

**Church Street, Eccles,
Manchester M30 0DF,
4 miles west of
Manchester, split by
the M602 motorway.**

The Church St. Place development is a multi-storey building comprising of 272 apartments along with 7,000 square feet of ground floor commercial space split across 6 separate units.

The podium is three sided and addresses Church Street, Vicarage Grove and Birkdale Grove. The podium contains commercial space, apartment entrances, plant and service areas.



SPECIFICATIONS

Unit 1

1,037 sqft
96 sqm

Unit 2

1,038 sqft
96.5 sqm

Unit 3

1,075 sqft
100 sqm

Unit 4

863 sqft
89 sqm

Unit 5

1,055 sqft
98 sqm

Unit 6

1,055 sqft
98 sqm

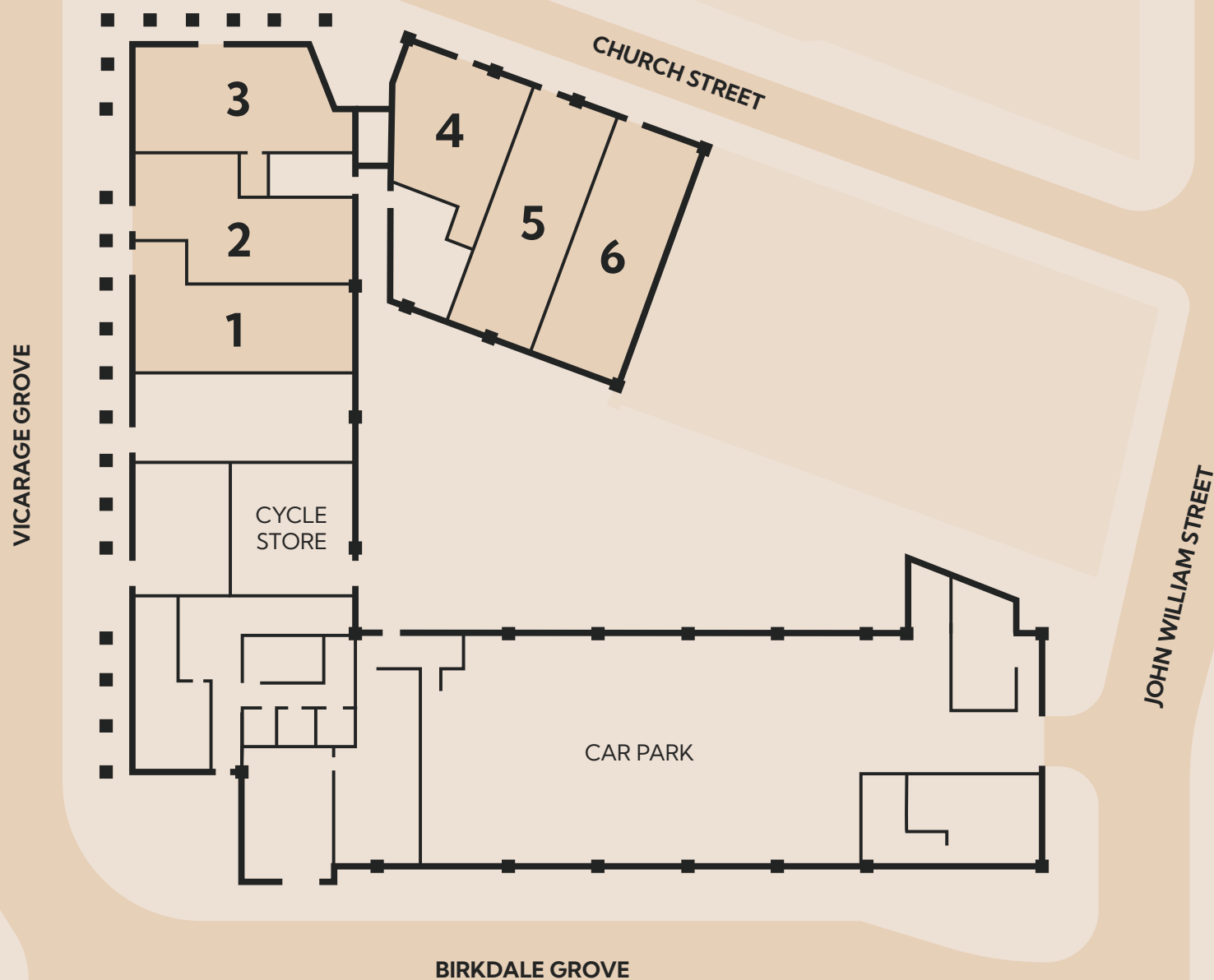

03

Each unit is available on a new effective FRI lease for a term to be agreed.

For further information regarding commercial space at Church St. Place please contact:

RICHARD LYONS

rlyons@ltlproperty.com
0161 260 0063

ELLIOTT GAGAN

egagan@ltlproperty.com
0161 260 0075

 **LYONS
THOMPSON
LETTES**
PROPERTY CONSULTANTS

Misrepresentation Act: The agent, for themselves and for the vendors or lessors of this property for whom they act, give notice, that; (i) these particulars are a general outline only, for the guidance of prospective purchasers or tenants, and do not constitute the whole or any part of any offer or contract; (ii) the agent cannot guarantee the accuracy of any description, dimensions, references to condition, necessary permission for use and occupation and any other details contained herein and prospective purchasers or tenants must not rely on them as statement of fact or representation and must satisfy themselves as to their accuracy; (iii) no employee of the agent has any authority to make any representation or warranty or enter into any contract in relation to the property; (iv) prices/rents quoted in these particulars may be subject to VAT; (v) the agent will not be liable, in negligence or otherwise, for any loss arising from use of these particulars. Any photographs and plans attached to these particulars were correct at the time of production and are for reference, rather than fact. May 2025. Designed by Bella Design.