

IPMS AREA PLAN

138 SOUTHWARK BRIDGE ROAD

138 Southwark Bridge Road, LONDON, SE1



Ground Floor

IPMS 3 - Office

	IPMS 3	336.9 sq m	3626 sq ft
---	--------	------------	------------

LIMITED USE AREAS (Included in the Total Area)

Area Difference from IDF	2.3 sq m	25 sq ft
Plinth	1.5 sq m	16 sq ft
Restricted Headroom	1.7 sq m	18 sq ft
Structure	4.4 sq m	47 sq ft

LEGEND	
	FLOOR TO FALSE CEILING HEIGHT (METRES)
	AREA DIFFERENCE FROM INTERNAL DOMINANT FACE

PRESENTATION SCALE 1:200 @ A3

ISSUE DATE: January 2023

PC PROJECT No. 48120 REVISION

A

DRAWING No.

48120-IPMS-AG

Plowman Craven

Plowman Craven House
2 Lea Business Park
Lower Luton Road
Harpenden
Hertfordshire
AL5 5EQ
Tel: +44 (0)1582 765566
Email: post@plowmancraven.co.uk
Web: www.plowmancraven.co.uk

115 Southwark Bridge Road
London
SE1 0AX
Tel: +44 (0)20 7490 7700

 **© PLOWMAN CRAVEN LIMITED**
NOT TO BE REPRODUCED WITHOUT PERMISSION

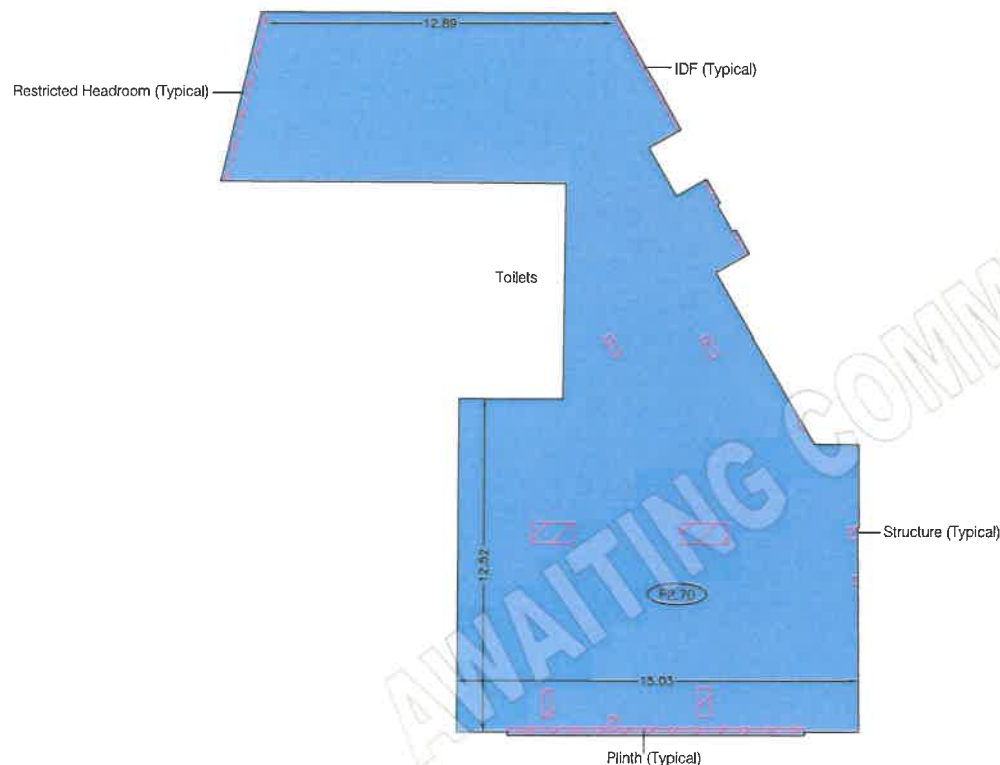

SOUTHWARK BRIDGE ROAD

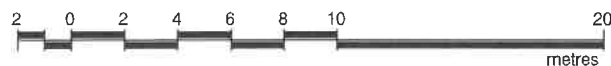

Condition of Site:
Occupied
Vacant
Under Construction
Heavy Fit-Out
Cat A Fit-Out
Shell & Core

Notes:
This drawing complies with RICS Property Measurement, 2nd edition (January 2018) and indicates the extent of the areas measured, produced to an accuracy commensurate with the standard. It is held in a scaled digital CAD format.

REVISIONS		
Revision	Details	Date
A	Original Issue	January 2023