



FAREHAM **REACH**

**TO LET**

**INDUSTRIAL / WAREHOUSE UNIT  
FULLY REFURBISHED**



**Unit 305**

**READY FOR OCCUPATION  
SUMMER 2026**

**23,321 sq ft** (2,166.52 sq m)



**Features:**

- Insulated profile metal sheet roof
- Ample car parking
- Secure site / 24 hour security
- 2 Dock level loading doors
- Grade A air conditioned offices
- PIR LED Warehouse lighting

**Fareham Reach Business Park**  
Fareham Road, Gosport PO13 0FW

[www.farehamreach.co.uk](http://www.farehamreach.co.uk)

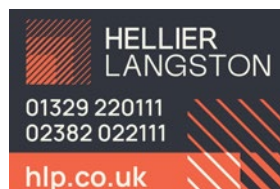



# FAREHAM REACH

## Unit 305



### Location

Fareham Reach is an established commercial area situated approximately 1 mile to the south of Fareham Town Centre, midway between Southampton and Portsmouth. There is excellent motorway access onto the M27 at Junction 11.

### Description

The premises will be available in the summer of 2026 to occupy after Unit 300 has been split. The unit was refurbished in 2022 with a new roof. Various improvement works will take place during the split works to increase the internal warehouse storage height by removing the tie rods at eaves height, creating clear span warehouse space.

### Accommodation

The property has been measured on a GIA basis.

**Total** **23,321 sq ft** (2,166.52 sq m)

The premises benefit from the following:

#### Warehouse

- PIR LED lighting
- Insulated profile metal sheet roof
- 2 x Dock loading doors - 4.49m width
- Minimum height - 4.33m
- Maximum height - 8.17m
- Gas supply
- 3-phase power
- Painted concrete floor
- Ample car parking
- Onsite security Mon-Fri 0730-1630 with out of hours mobile patrols
- Perimeter fencing with gated entrances

#### Open plan office

- PIR LED lighting
- VRF Air Conditioning system
- Perimeter trunking with data and electric cable
- Internal warehouse viewing windows
- Carpets
- Male, Female and Disabled WC



### Terms

The premises are available on a new full repairing and insuring lease for a term to be agreed.

### Rent

Rent on application.

### Rateable Value

To be reassessed after the premises have been split.

### Energy Performance Certificate (EPC)

The Energy Performance Asset Rating is **C51**.

### Service Charge

Upon Application.

### Legal Costs

Each party to be responsible for their own legal costs incurred in the transaction.

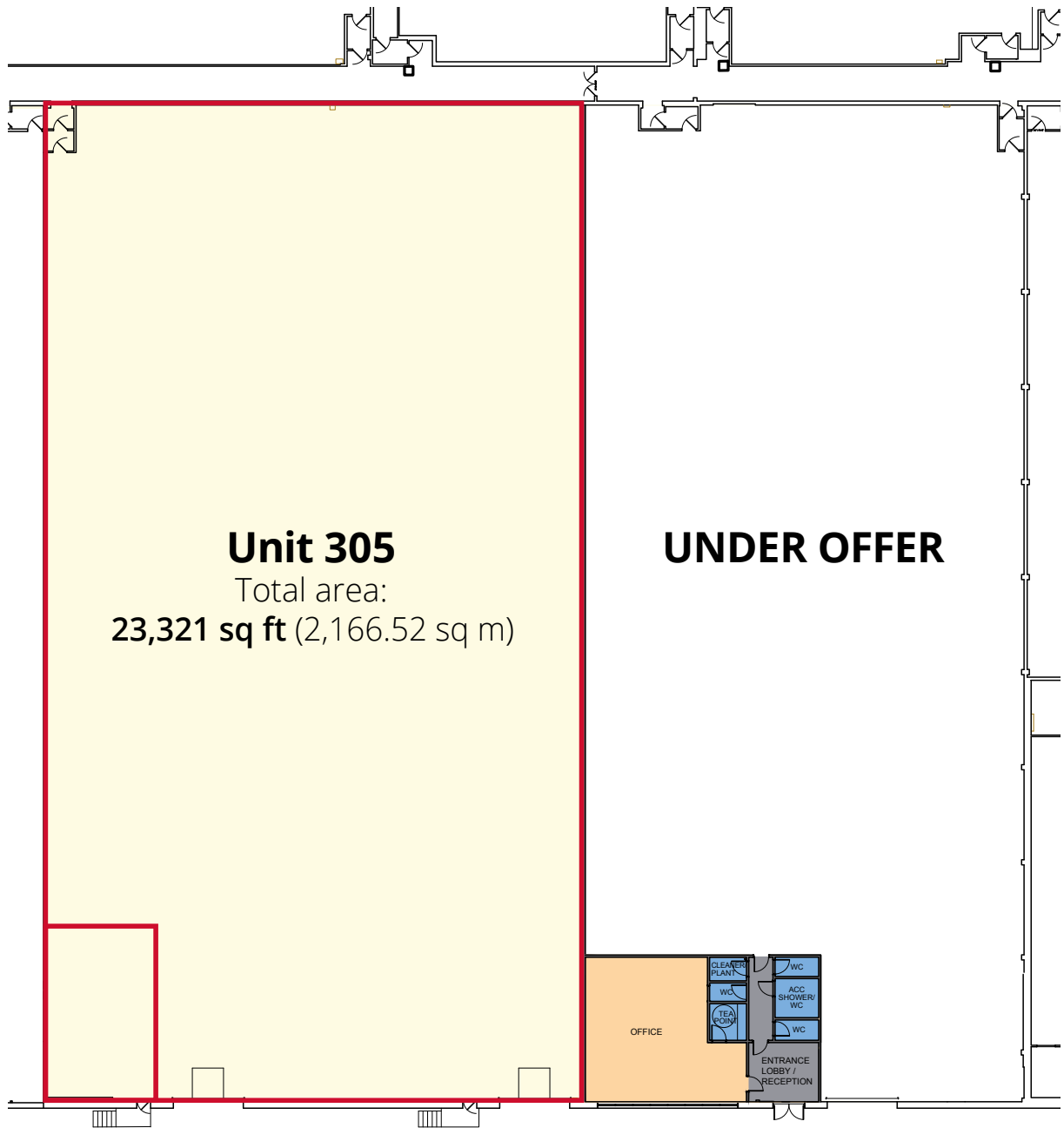

Warehouse Area:  
**21,745 sq ft** (2,020.1 sq m)

Office and Ancillary Area:  
**1,576 sq ft** (146.4 sq m)

Total GIA:  
**23,321 sq ft** (2,166.52 sq m)





Aerial photograph of Fareham Reach Business Park looking south west.



Ordnance Survey © Crown Copyright 2013. All rights reserved. Licence number 100022432.



# FAREHAM REACH

## Fareham Reach Business Park

Fareham Road, Gosport PO13 0FW

### Towns

Distance from  
Fareham Reach Business Park:

Portsmouth:	10 miles
Southampton:	16 miles
Winchester:	26 miles
Basingstoke:	45 miles
Bournemouth:	48 miles
Brighton:	55 miles
London:	78 miles

### Airports

Distance from  
Fareham Reach Business Park:

Southampton:	16 miles
Bournemouth:	45 miles
Heathrow:	75 miles
Gatwick:	73 miles

### Rail

Journey times from  
Fareham train station:

Southampton:	21 minutes
Portsmouth:	27 minutes
Salisbury:	52 minutes
Bournemouth:	66 minutes
Brighton:	78 minutes
London:	115 minutes

### Ports

Distance to major ports:

Portsmouth:	10 miles
Southampton:	16 miles
Poole:	52 miles

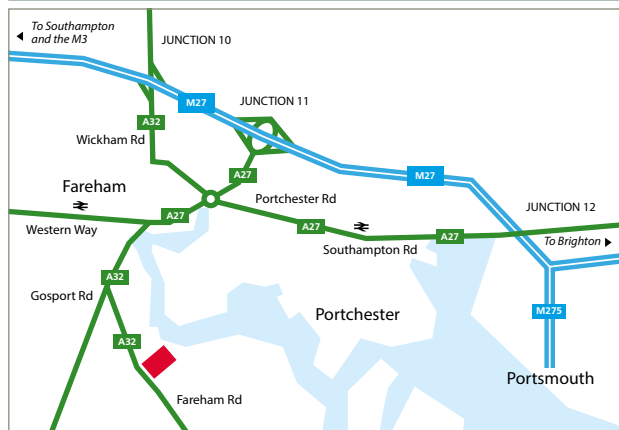

### Viewing

Strictly by appointment through joint sole agents:

#### Matthew Poppett

DDI: 02380 574512  
M: 07971 824525  
E: [matt@hlp.co.uk](mailto:matt@hlp.co.uk)

#### Elise Evans

M: 07703 393120  
E: [eevans@lsh.co.uk](mailto:eevans@lsh.co.uk)

#### Andy Hellier

DDI: 01329 225744  
M: 07930 661782  
E: [andy@hlp.co.uk](mailto:andy@hlp.co.uk)

#### George Cook

M: 07596 578707  
E: [gcook@lsh.co.uk](mailto:gcook@lsh.co.uk)



IMPORTANT NOTICE: Hellier Langston, Lambert Smith Hampton and their clients give notice that: (i) they have no authority to make or give any representations or warranties in relation to the property. These particulars do not form part of any offer or contract and must not be relied upon as statements or representations of fact. (ii) Any areas, measurements or distances are approximate. The text, photographs and plans are for guidance only and are not necessarily comprehensive. It should not be assumed that the property has all necessary planning, building regulation or other consents. Hellier Langston and Lambert Smith Hampton have not tested any services, equipment or facilities. (iii) Purchasers must satisfy themselves by inspection or otherwise.