

- Dimensions are in millimeters, unless stated otherwise.
 - Scaling of this drawing is not recommended.
 - It is the recipient's responsibility to print this document to the correct scale.
 - All relevant drawings and specifications should be read in conjunction with this drawing.

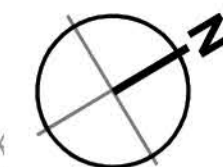

- Layout to be confirmed
 C1 - Revision reference

Schedule of Accommodation (GEA)

Unit 1		
Warehouse Area	- 29,051 sq ft	2,699 sq m
Ground Floor Core	- 1,259 sq ft	117 sq m
First Floor Offices	- 6,426 sq ft	597 sq m
Total GEA	- 36,736 sq ft	3,413 sq m

Car Parking Spaces	- 36 N ^o
Motorcycle Spaces	- 1 N ^o
Cycle Spaces	- 22 N ^o
Dock Doors	- 2 N ^o
Level Access Doors	- 2 N ^o

Unit 1 Site Area - 1.64 Acres / 0.66 Hectares

Unit 2		
Warehouse Area	- 58,361 sq ft	5,422 sq m
Ground Floor Core	- 1,184 sq ft	110 sq m
First Floor Offices	- 8,159 sq ft	758 sq m
Total GEA	- 67,704 sq ft	6,290 sq m

Gatehouse	- 190 sq ft	17 sq m
Car Parking Spaces	- 58 N ^o	
Motorcycle Spaces	- 1 N ^o	
Cycle Spaces	- 30 N ^o	
Dock Doors	- 5 N ^o	
Level Access Doors	- 2 N ^o	

Unit 2 Site Area - 2.83 Acres / 1.14 Hectares

Unit 3		
Warehouse Area	- 20,871 sq ft	1,939 sq m
Ground Floor Core	- 947 sq ft	88 sq m
First Floor Offices	- 3,444 sq ft	320 sq m
Total GEA	- 25,262 sq ft	2,347 sq m

Car Parking Spaces	- 19 N ^o
Motorcycle Spaces	- 1 N ^o
Cycle Spaces	- 14 N ^o
Level Access Doors	- 2 N ^o

Unit 3 Site Area - 1.09 Acres / 0.44 Hectares

Unit 4		
Warehouse Area	- 26,231 sq ft	2,437 sq m
Ground Floor Core	- 936 sq ft	87 sq m
First Floor Offices	- 4,057 sq ft	377 sq m
Total GEA	- 31,224 sq ft	2,901 sq m

Car Parking Spaces	- 28 N ^o
Motorcycle Spaces	- 1 N ^o
Cycle Spaces	- 18 N ^o
Level Access Doors	- 3 N ^o

Unit 4 Site Area - 1.30 Acres / 0.52 Hectares

Total Development Area - 160,926 sq ft / 14,951 sq m

Development Area - 8.48 Acres / 3.43 Hectares

- Key:
- Charging Spaces - Active Ducts - (10% provision min.)
 - Charging Spaces Passive Ducts - (10% provision)
 - Development Boundary
 - Plot Boundary
 - Retaining Wall Location
 - Foul Sewer Easement (4m easement)
 - Highway Safety Easement
 - Water Meter
 - Fire Hydrant

rev	amendments	by	ckd	date
-----	------------	----	-----	------

Reading International Logistics Park

Masterplan - GEA Figures

LOD 3	LOI 3
-------	-------



RIBA PoW Stage:	4 - Technical Design
Document Suitability:	S2
Drawn / Checked:	LF / LF
Date:	20.05.2025
Scale:	1:500 A1
UMC Project Number:	23545
Document Reference:	Drawing no: Revision:
23545 - UMC - SI01 - SI - DR - A	0034 P01

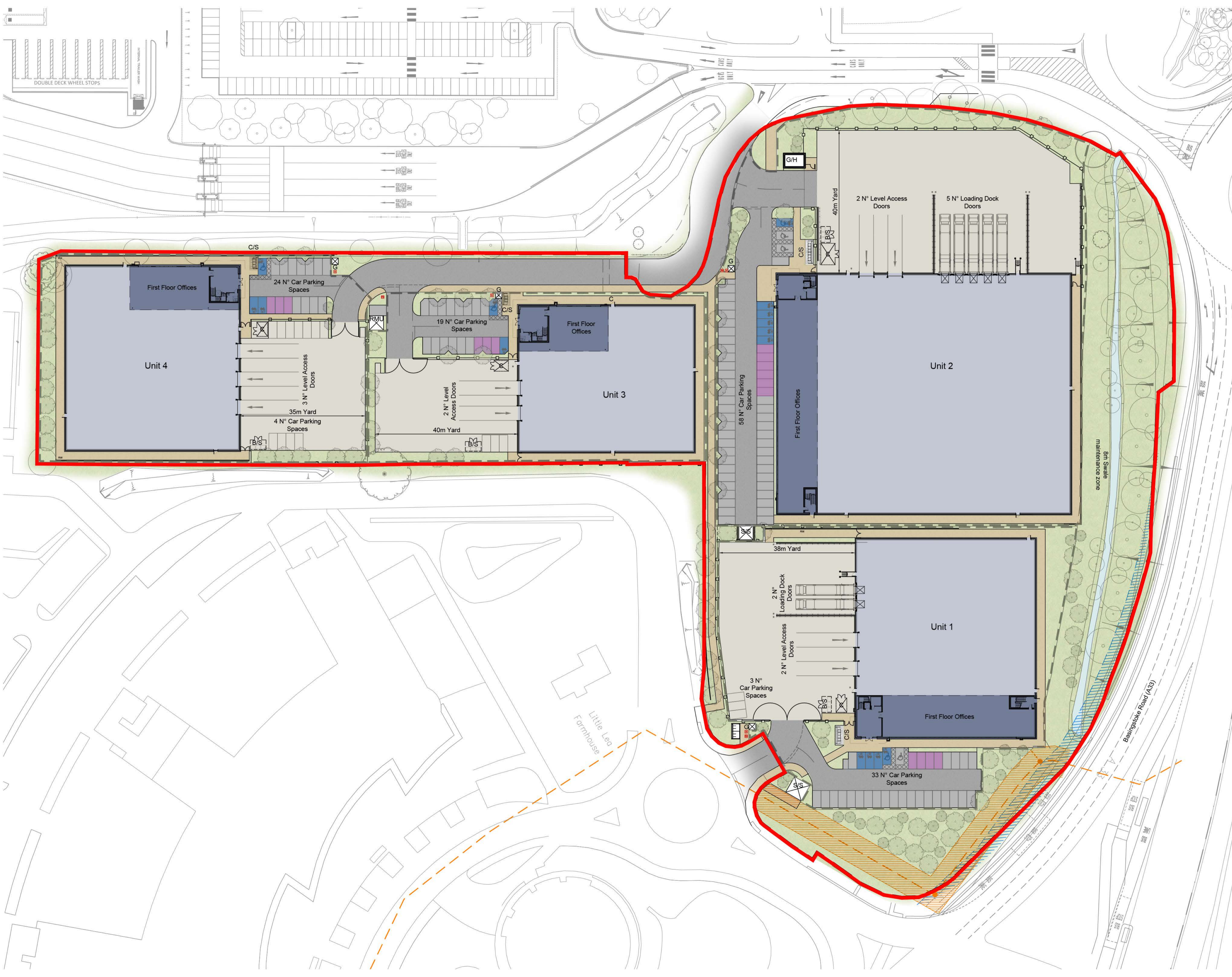

10m SCALE 1:500