

SUBJECT TO FULL SITE SURVEYS AND BUILDING REGULATION CHECKS

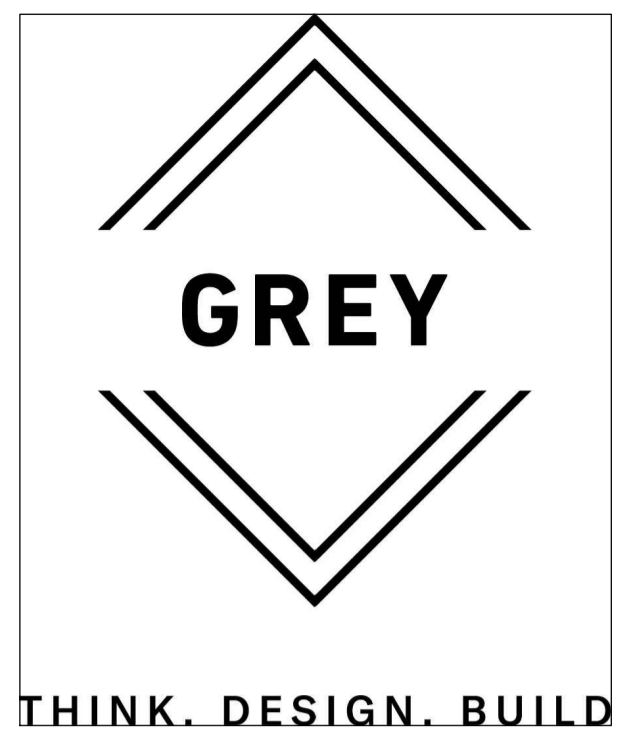

7 MURRELL GREEN
BUSINESS PARK
LONDON ROAD
RG27 9GR

T. 01252 543097
hello@grey.limited
www.greyinteriors.co.uk

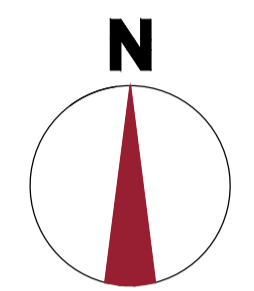

THIS DRAWING IS PROTECTED UNDER COPYRIGHT. THIS DRAWING IS NOT TO BE REPRODUCED IN WHOLE OR PART UNLESS AUTHORISED BY GREY.

© COPYRIGHT
THIS DRAWING IS NOT TO BE SCALED
THE GENERAL CONTRACTOR IS TO CHECK ALL DIMENSIONS AND NOTIFY THE DESIGNERS OF ANY DISCREPANCIES OR OMISSIONS.

APPROX AREA: 126.6 sqm/
1363 sq ft

12- 18 NEW BRIDGE STREET 6th FLOOR DRAWING DATA - AREA= 1363 sqft/126.6 sqm						
Area	No	Seats	Total Fixed desks	Total spaces to work	Total closed spaces to meet	Total open spaces to meet
Holding Area	1	2	0	0	0	1
Meeting rooms	1	8	0	0	1	0
Tea point	1	0	0	0	0	0
Breakout	1	4	0	4	0	1
Print Points	1	0	0	0	0	0
Open Plan desks(1400 x 800)	17	17	17	17	0	0
comms	1	0	0	0	0	0
Lockers	tbc	0	0	0	0	0
1 Person Booth	2	2	0	0	1	0
TOTALS	25	33	17	21	2	2

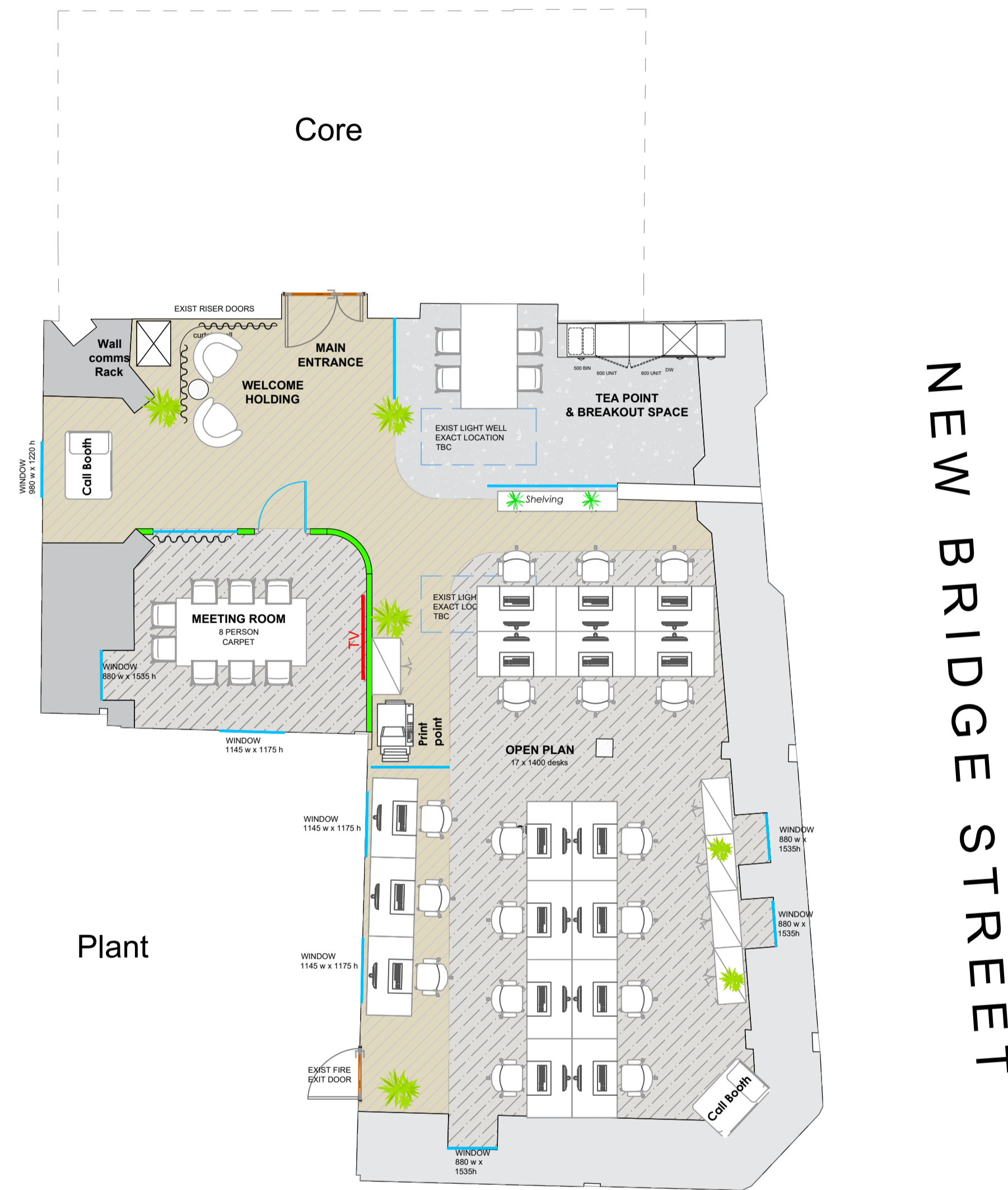

Restricted Headroom (Typical)

01.01.24 A specify revisions here....

DATE	REV	REVISIONS	SIGN

CLIENT
Landlord.

PROJECT
16-18 New Bridge Street
London
EC2V

TITLE
Proposed Sixth Floor General
Arrangement Plan Opt 2

SCALE: 1:75@A1	PROJECT NO: 2026_2419
DATE: 05.05.2026	DESIGNER: AT

DRAWING:
G_26_2419_06_GA Opt 2

DRAWING STATUS:
PRELIMINARY

CLIENT SIGNATURE: _____ SIGNOFF DATE: _____