

DO NOT SCALE FROM THIS DRAWING. WORK TO FIGURED DIMENSION ONLY.

NOTES

- All NARRO drawings are to be read in conjunction with the relevant NARRO Specification and all relevant Architect's and Service Engineer's drawings and Specifications.
- All dimensions and setting out to be confirmed by the Architect.
- For other notes refer to drawing 24.1940-NAR-XX-XX-DR-S-0001.

CDM - RESIDUAL RISKS

# Indicates key residual health and safety risks. For full list of residual risks, hazards and notes, refer to CDM Table on drawing 0001.

LEGEND

- Denotes existing wall.
- Denotes new 7N blockwork with M4 mortar wall infill.

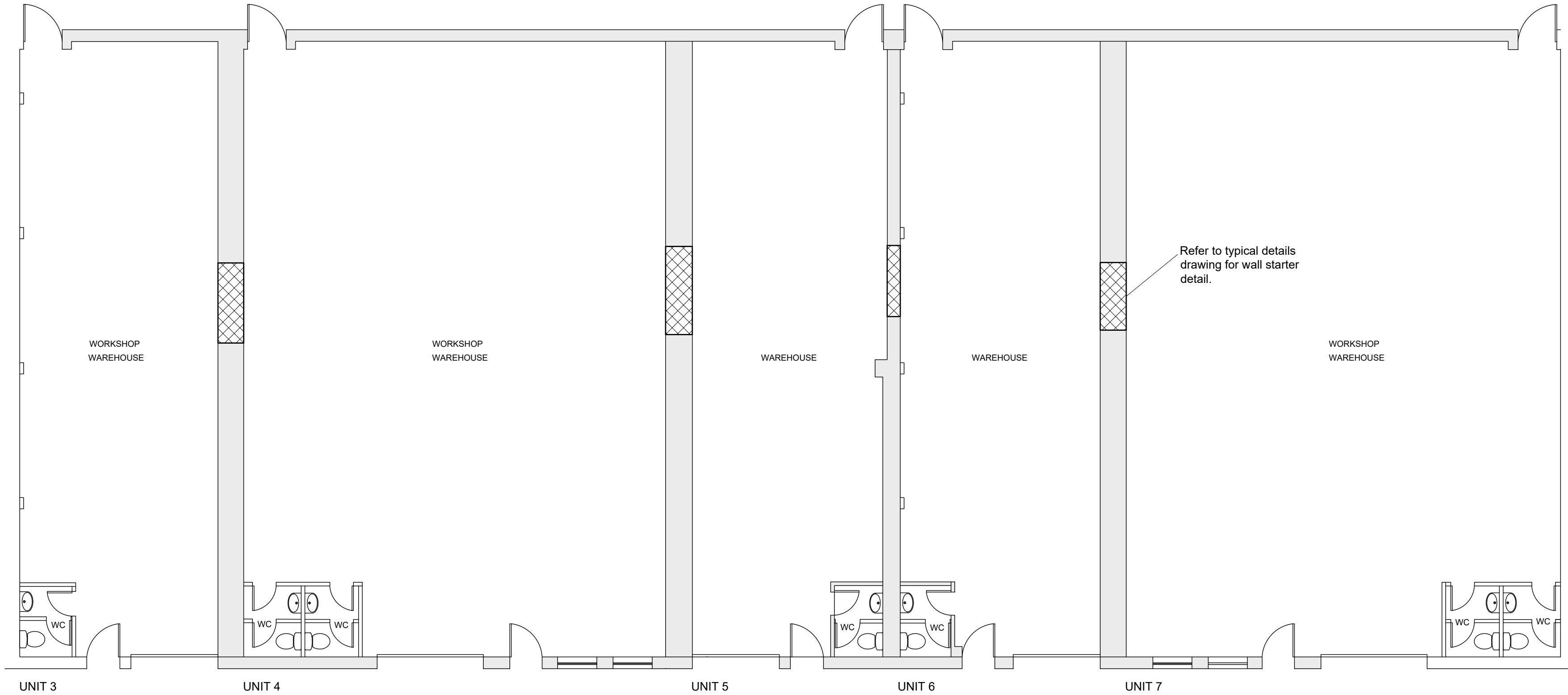

GROUND FLOOR LAYOUT  
SCALE 1:100

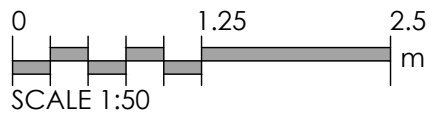

Rev	Description	Chk	Dn	Date
Status				
BUILDING WARRANT				
<b>NARRO</b>				
Edinburgh   Glasgow   Inverness   Stirling   Aberdeen   Newcastle				
26 James Morrison Street, Glasgow, G1 5PE +44 141 552 6080				
Wwww.narroassociates.com   E mail@narroassociates.com				
Client				
THE ASHTENNE INDUSTRIAL FUND LTD				
Architect				
TRIANGLE BUILDING CONSULTING				
Job Title				
UNITS 3-7, ARROL PLACE LONDON ROAD INDUSTRIAL ESTATE, GLASGOW				
Sheet Title				
PROPOSED GROUND FLOOR LAYOUT				
Project Reference: 24.1940				
Drawn by	Designed	Checked		
JD	MS			
Scale @ A1	Date		Revision	
N/A	DEC 24			
File Name	24.1940-NAR-XX-ZZ-DR-S-1100			