



First Floor, East Wing

Southern House, Otterbourne, Winchester
SO21 2RU

TO LET

3,340 sq ft (310.3 sq m) – 7,155 sq ft (664.7 sq m)



**HELLIER
LANGSTON**

www.hlp.co.uk

02382 022111 southampton@hlp.co.uk

Open plan offices in landscaped grounds

Description

Southern House provides approximately 2,873 sq m (30,929 sq ft) of self-contained office accommodation in two wings,. The property is set within an attractive parkland site that extends to 2.39 hectares (5.91 acres).

The property is constructed in a L-shape with a central service core containing a ground floor reception and a canteen. The east wing provides office accommodation on the ground and first floors levels with a second floor mezzanine.

The available space will be comprehensively refurbished to provide open plan, flexible accommodation benefitting from good natural light. And a new HVAC system.

Specification

- Solid concrete floors
- LED lighting
- Car parking ratio of 1:123 sq ft
- Air conditioned
- Extensive landscaped grounds and picnic area
- Good motorway access
- Secure cycle storage
- Access to 18 car charging spaces
- Open plan
- EPC-70 (will be improved following refurbishment)



Open plan offices in landscaped grounds

Floor plan

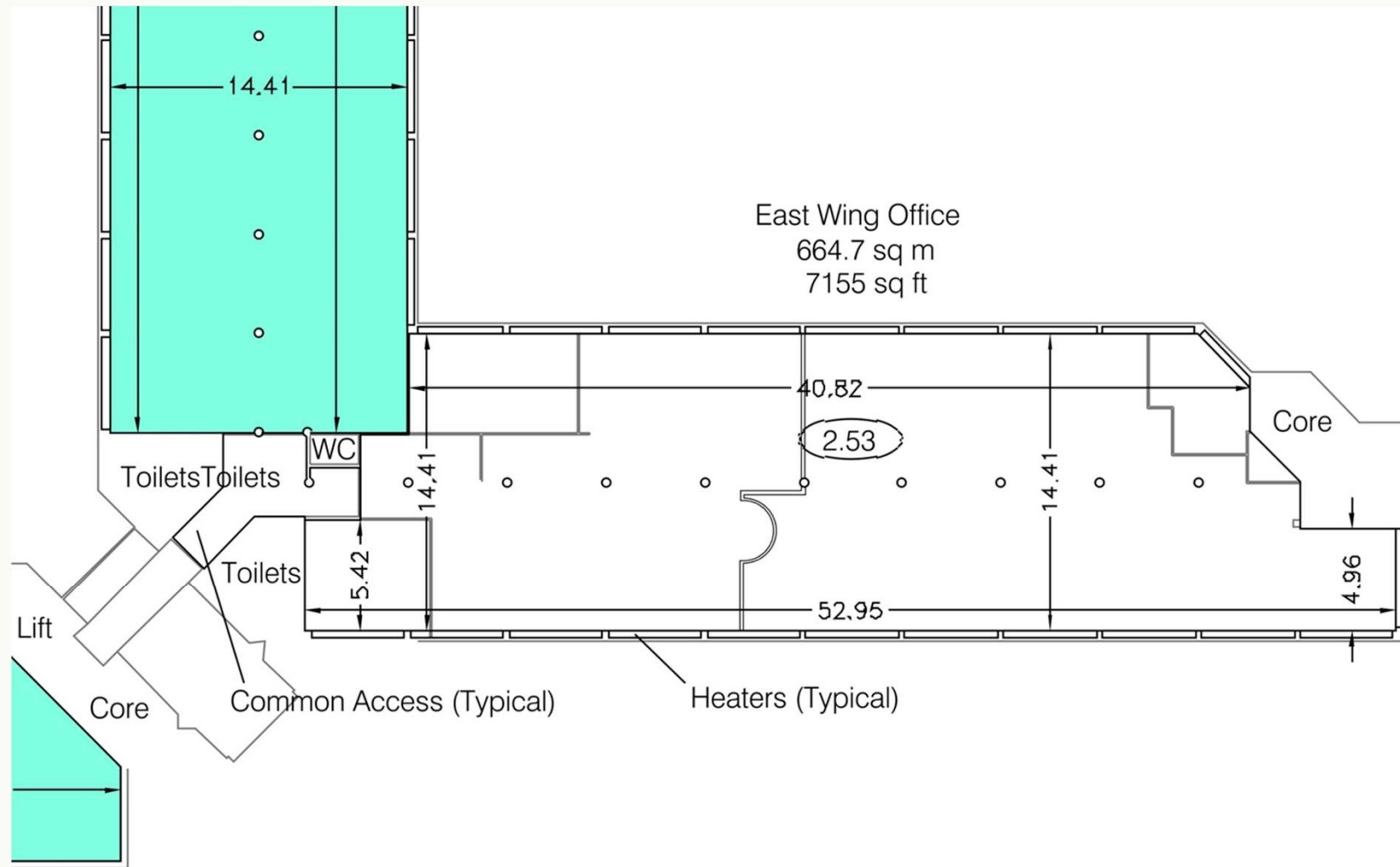

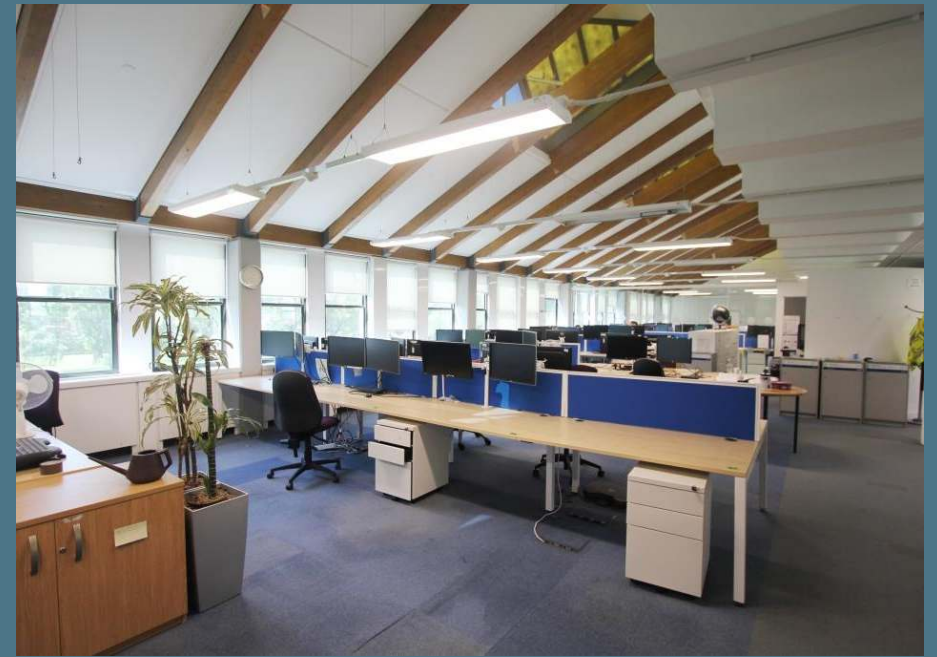

Open plan offices in landscaped grounds

Accommodation

The accommodation has been measured in accordance with the RICS Code of Measuring practice (6th Edition) to NIA as follows:

	Sq m	Sq ft
First Floor, East Wing	664.7	7,155

Business Rates

The premises are currently is two separate assessments with a 2026 main rate of £167.75 sq m (£15.58 sq ft) making 2026/27 rates payable £6.70 sq ft (Source: tax.service.gov.uk)

Service Charge

A service charge will be levied, further detail upon application.

EPC

C-70

Terms

The suite is available either as a whole, or in part by way of new effectively Full Repairing lease for a term to be agreed.

Rent

£21.00 sq ft.

VAT

Unless otherwise stated terms are strictly exclusive of Value Added Tax and interested parties must satisfy themselves.

AML

In order to comply with Anti-Money Laundering Regulations 2017 (as amended) and the Proceeds of Crime Act 2002, Hellier Langston are required to identify all prospective purchasers and tenants.

Code for Leasing Business Premises

In England and Wales the Code for Leasing Business Premises, 1st edition, strongly recommends that any party entering into a business tenancy or lease agreement takes professional advice from a surveyor or solicitor. A copy of the Code (1st edition, February 2020) can be found on the RICS website.

Location

Southern House is located just off the Otterbourne Road, conveniently positioned within 5 minutes' drive of both Junctions 11 and 12 of the M3 motorway. Winchester City Centre is 6 km (4 miles) north of the subject property. Public transport links to the City centre are good with a regular bus service and frequent commuter rail services from the nearby railway station of Shawford, which is on the London to Southampton line.

The property is accessed via Sparrowgrove and onto Waterworks Road which run through a high quality and desirable residential area.

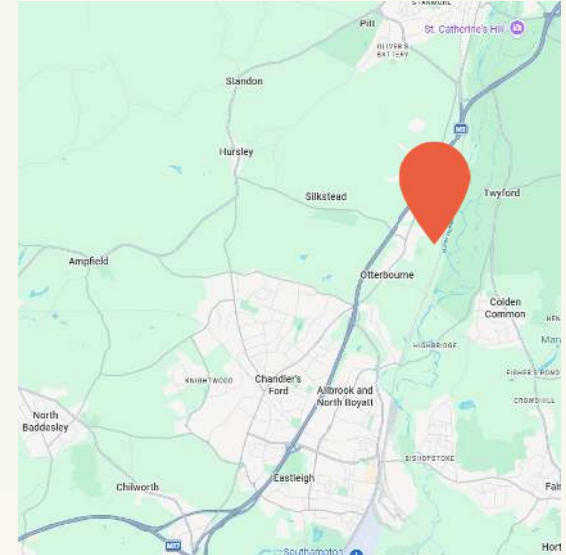

www.hlp.co.uk

02382 022111 southampton@hlp.co.uk

Disclaimer: Hellier Langston Limited gives notice that these particulars are set out as a general outline only for the guidance of intending Purchasers or Lessees and do not constitute any part of an offer or contract. Details are given without any responsibility and any intending Purchasers, Lessees or Third Party should not rely on them as statements or representations of fact but must satisfy themselves by inspection or otherwise as to the correctness of each of them. No person employed or engaged by Hellier Langston Limited has any authority to make any representation or warranty whatsoever in relation to this property.



Contact us

Direct your viewing requests and enquiries to:



Jason Webb

07989 959064

jason@hlp.co.uk



Matthew Poppett

07971 824525

matt@hlp.co.uk



Strictly by appointment with sole agents Hellier Langston