



# The Capella Building, Glasgow

## Ground Floor Marketing Plan

23<sup>rd</sup> June 2026

c2-1203

**c2:concepts**

Considered, creative.



# Ground Floor **Marketing Plan**

c2:concepts  
Considered, creative.

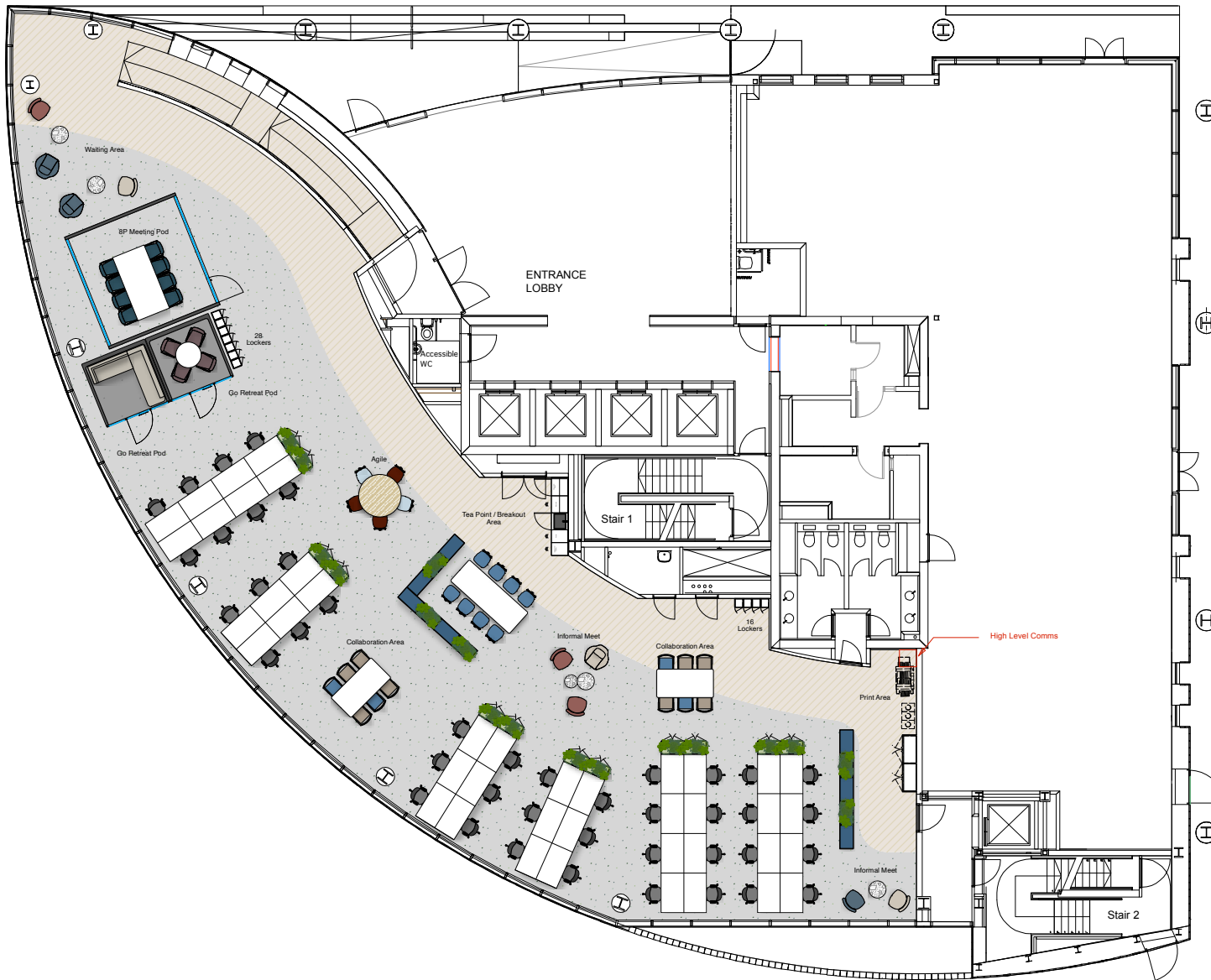

**Suite G.01**

N.I.A: Approx. 452 Sqm / 4,875 Sq ft

**STANDARD WORKING**

03 x 1400x800mm (Bank of 8)

03 x 1400x800mm (Bank of 6)

Total: 42 x Workstation @ 1:10 sqm per person

**MEETING PODS**

01 x 8 Person Meeting Pod

02 x 4 Person Meeting Pod

**SUPPORT SETTINGS**

01 x Waiting Area

02 x Informal Meet

01 x Tea Prep / Breakout Area

01 x Agile Work

02 x Collaboration

01 x Print / Copy Area

02 x Lockers (Bank of 7) & (Bank of 4)  
Total 44

**Ground Floor  
Marketing Plan**



c2:concepts  
Considered, creative.

[www.c2concepts.co.uk](http://www.c2concepts.co.uk)



Copyright reserved: The drawings and information in this document may only be used for the client and location specified in the title. All drawings and specifications related to this project are copyright of c2:concepts Ltd and may not in whole or part, be copied, distributed, reproduced, disclosed to any other third party without written consent from c2:concepts Ltd, or used for any other purpose than that agreed with c2 concepts Ltd, or used in any capacity by any third party without permission of c2 concepts Ltd. All parts of the drawings and documents referred to within this notice are covered by the Copyright, Designs and Patents Act 1988 and are owned in totality by c2 concepts Ltd.

**Glasgow office:**

c2:concepts  
Queens House  
29 St Vincent Place  
Glasgow  
G1 2DT

0141 221 9229

**London office:**

c2:concepts  
Henry Wood House  
2 Riding House Street  
London  
W1W 7FA

0203 011 1984

**c2:concepts**

Considered, creative.