

36,866 sq ft of unique flexible commercial space in the Centre of West London.

Four units available from c.4,704 to c.9,440 sq ft.

**Available now**

# Bloom Fulham



# A one-of-a-kind opportunity

Bloom have brought Imperial Studios to the market following a light refurbishment to ensure the capabilities of this site are as high as possible. Positioned on the eastern side of Imperial Road close to the junction with the New Kings Road, the site benefits from links to the nearby A308, A217 and A4, as well as quick access to Wandsworth Bridge.

Delivering six varying units across the ground and first floors, Bloom Fulham is designed with employee wellbeing and ESG credentials at the forefront.

Bloom Fulham accounts for a significant proportion of its borough's industrial space available, meaning its occupier will have a unique opportunity to thrive.



36,866 sq ft of  
prime, ultra-urban  
commercial space





# Designed to suit your business needs

Bloom Fulham provides a wide range of unit sizes and capabilities to meet individual business’ needs.

Units are available individually or on a combined basis.

Unit	Ground Floor (sq ft)	First Floor (sq ft)	Total (sq ft)
Unit 1	3,348	3,681	<b>7,029</b>
Unit 2	2,336	2,368	<b>4,704</b>
Unit 3	3,584	3,638	<b>7,222</b>
Unit 4	2,411	2,443	<b>4,854</b>
Unit 5	4,682	4,758	<b>9,440</b>
Unit 6	1,798	1,819	<b>3,617</b>

● **Let**

First Floor

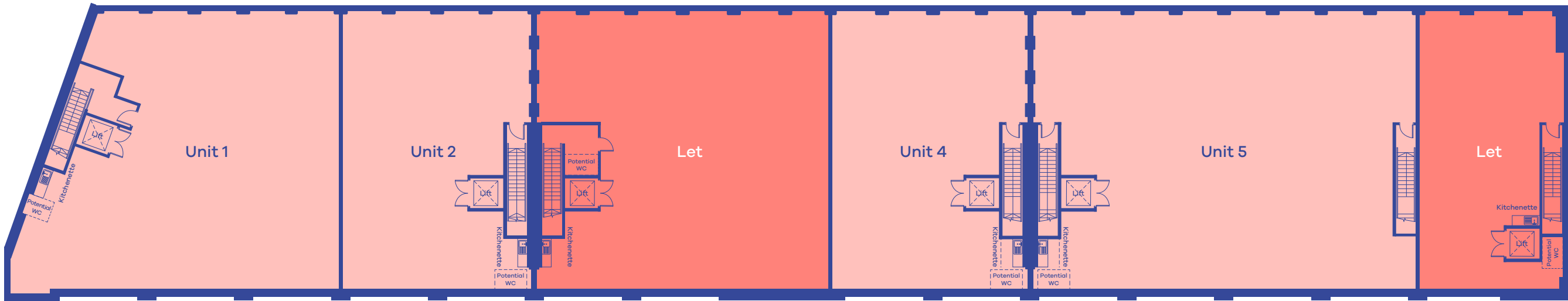

Ground Floor

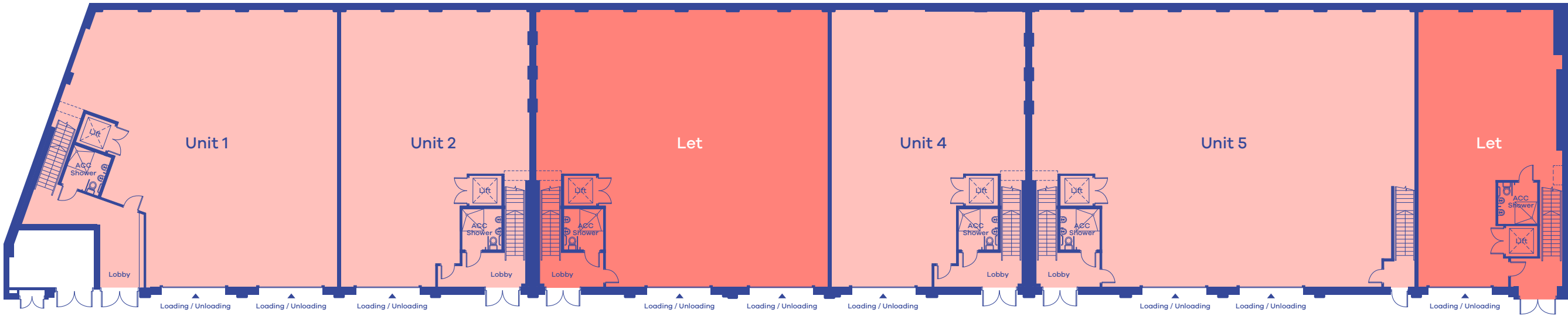



South Kensington

The City

Chelsea

Battersea ↗

Bloom Fulham

← Earl's Court

↙ A308

Putney →



# Space designed to help your business grow

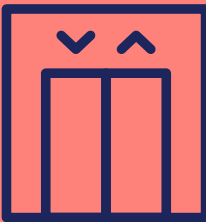

1,000kg goods lift



Loading facility:  
Level access loading  
doors on all units



Power capacity:  
1 MVA



Loading capacity:  
Ground Floor: 37.5KN  
First Floor: 7.5KN

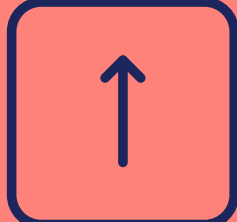

Up to 4.25m clear  
internal eaves height



EPC: A+



BREEAM:  
'Very Good'



Net zero carbon  
operation

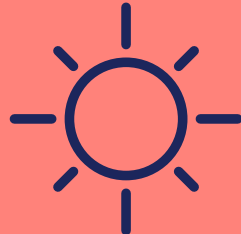

148 kWp  
PV system



EV charging and  
cycle provisions for  
sustainable travel





● ● REIMAGINED **ULTRA-URBAN** WAREHOUSING

Internal warehouse space



Internal warehouse space



Imperial Studios / 3-9 Imperial Road / Fulham **SW6 2AG**

**BLOOM** FULHAM

Internal warehouse space



# A prime West London location

Located in Zone 2, Bloom Fulham is just a short walk from the many amenities of the Kings Road (A308) and Fulham Broadway tube station. The scheme benefits from excellent bus connections and cycle routes to the West End and the City, as well as to wider London.

Of course, Fulham itself is also a hub of activity, with all the best of West London on offer.

- 1

Fulham Broadway Retail Centre
- 2

Quadra
- 3

District
- 4

Megan's by the Green
- 5

The White Horse
- 6

Amuse Bouche Champagne Bar
- 7

Parsons Green
- 8

Cocotte Parsons Green
- 9

Nayaab Fulham
- 10

Flavourtown Bakery
- 11

Local Hero
- 12

T'Amini Lebanese Bakery
- 13

The Fox & Pheasant
- 14

Jak's
- 15

Chelsea Funhouse
- 16

La Famiglia
- 17

Mucci's

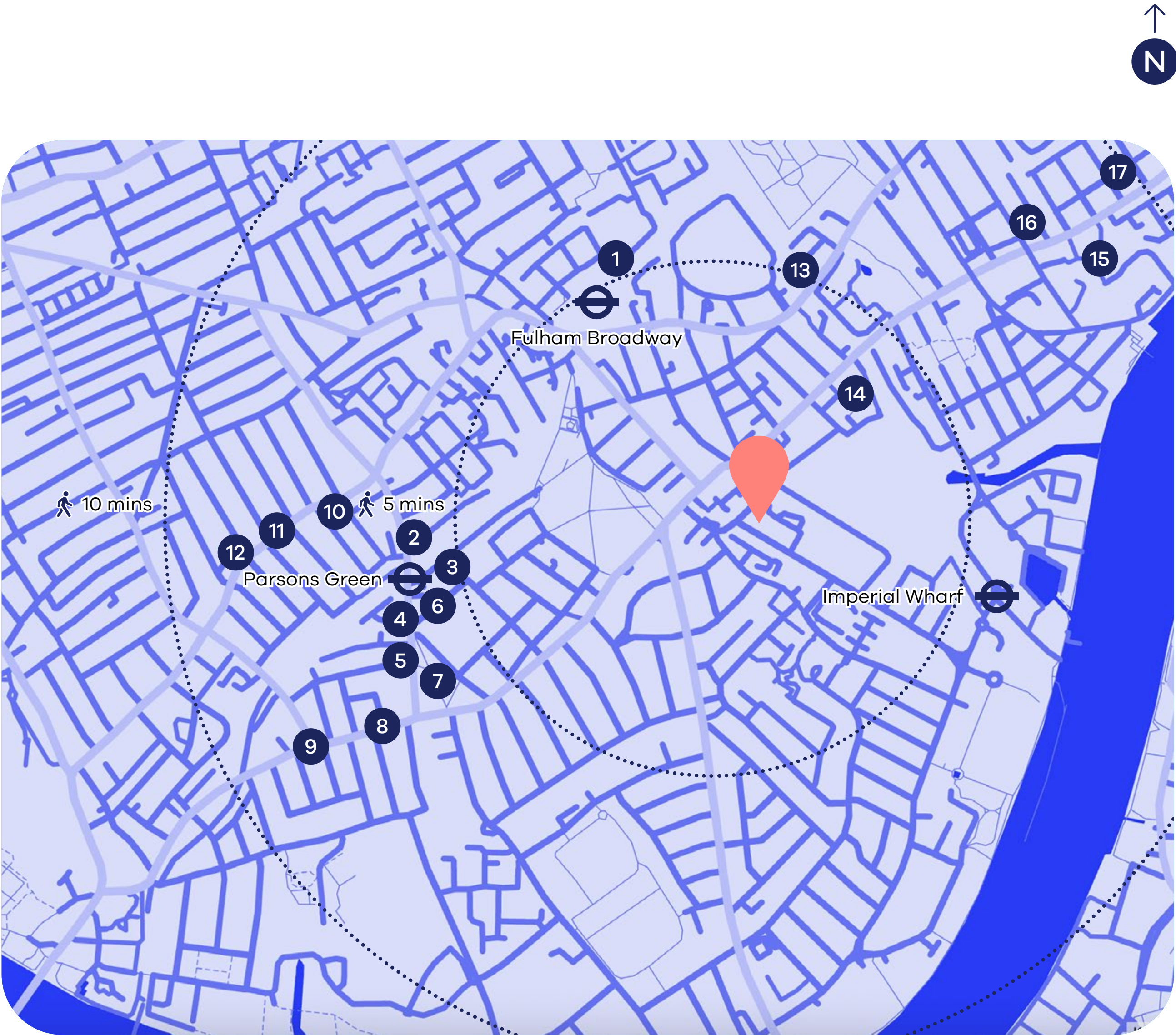



# Fast, local connections

Fulham Broadway, Parsons Green and Imperial Wharf stations are all a short walk away, providing access to the District line, London Overground and wider National Rail Services.

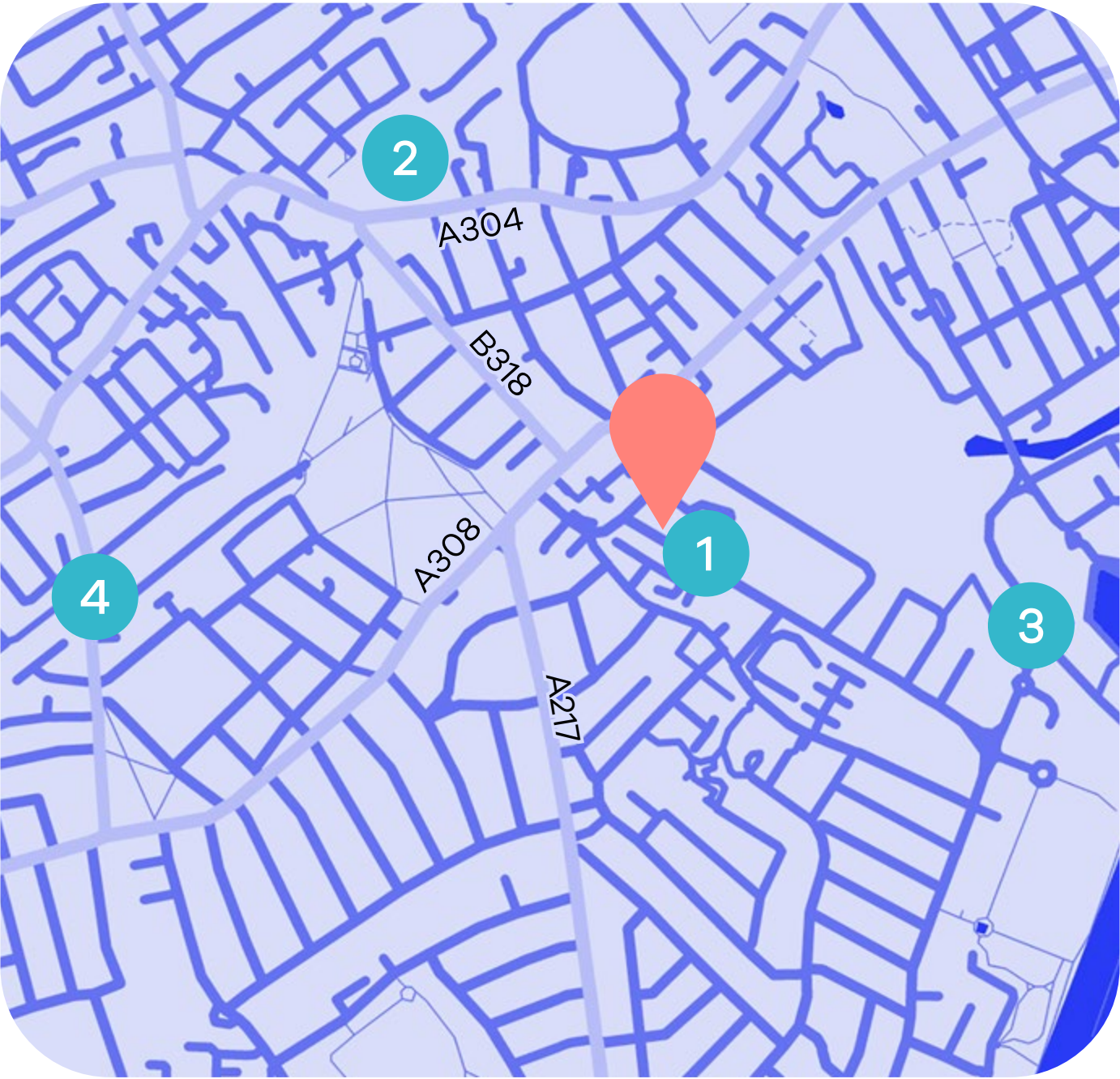

- 1 **Harwood Terrace (Stop N)**  
🚶 1 min
- 2 **Fulham Broadway**  
🚶 8 mins
- 3 **Imperial Wharf**  
🚶 8 mins
- 4 **Parsons Green**  
🚶 16 mins

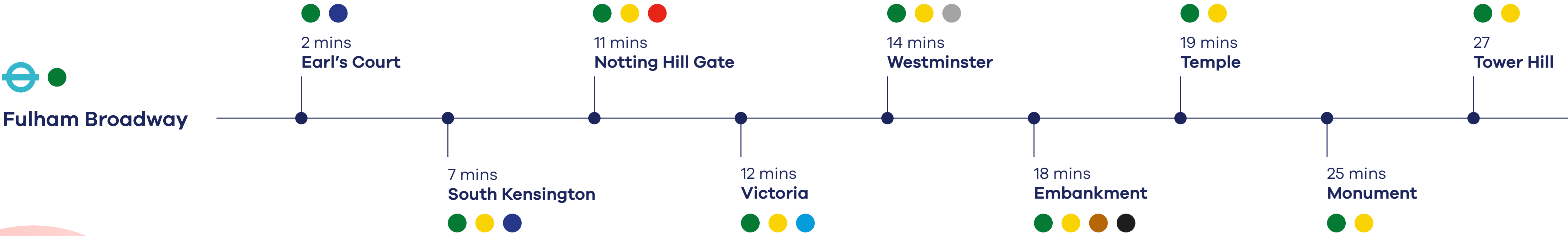



# Local insight

📍 3 mile radius

## 810k

Population projection by 2025

## 376k

Household numbers by 2025

## 597k

Projected employees by 2025

## £52k

Average household income







# The perfect fit

Bloom Fulham has been designed to suit the needs of an enormous variety of different sectors. The flexibility of the space itself, alongside its amenities, makes it ideal for sectors including builders' merchants, food & beverage, retail, film, manufacturing, light industrial, fitness, workshops, E-commerce and many more.





# Bloom

## URBAN WAREHOUSES

### For more information:

**visit:** [bloom-urban.com](https://bloom-urban.com)

**email:** [enquiries@bloom-urban.com](mailto:enquiries@bloom-urban.com)

### For letting enquiries:

#### NEWMARK

**Freddie John**

[freddie.john@nmrk.com](mailto:freddie.john@nmrk.com)

07788 394 341

**Emily Pearson**

[emily.pearson@nmrk.com](mailto:emily.pearson@nmrk.com)

07387 134 126



**Cameron Aitchison**

[cameron.aitchison@montagu-evans.co.uk](mailto:cameron.aitchison@montagu-evans.co.uk)

07721 599 643

**Luca Nardini**

[luca.nardini@montagu-evans.co.uk](mailto:luca.nardini@montagu-evans.co.uk)

07795 501 905

The particulars are set out as a general outline for guidance and information only and should not be considered a formal offer. They are not to be taken as forming any part of a resulting contract nor be relied upon as statements or representations of fact, meaning no liability can be accepted for their accuracy. All dimensions are approximate and computer generated images are for illustrative purpose only. November 2025.



# Our Portfolio

