

MARKET PLACE
FITZROVIA W1



THE BUILDING

30 Market Place offers high quality, light-filled office space in the heart of the West End, redeveloped by award-winning architects Buckley Gray Yeoman.

Featuring a fully glazed entrance, concierge reception and modern end-of-journey facilities, the building provides an impressive arrival experience. The available 3rd floor is newly refurbished to Cat A condition with fitted meeting rooms and a kitchen, offering flexible space ready for immediate occupation.



ACCOMMODATION

Indicative 3rd Floor Space Plan • 4,465 sq ft 414.81 sq m

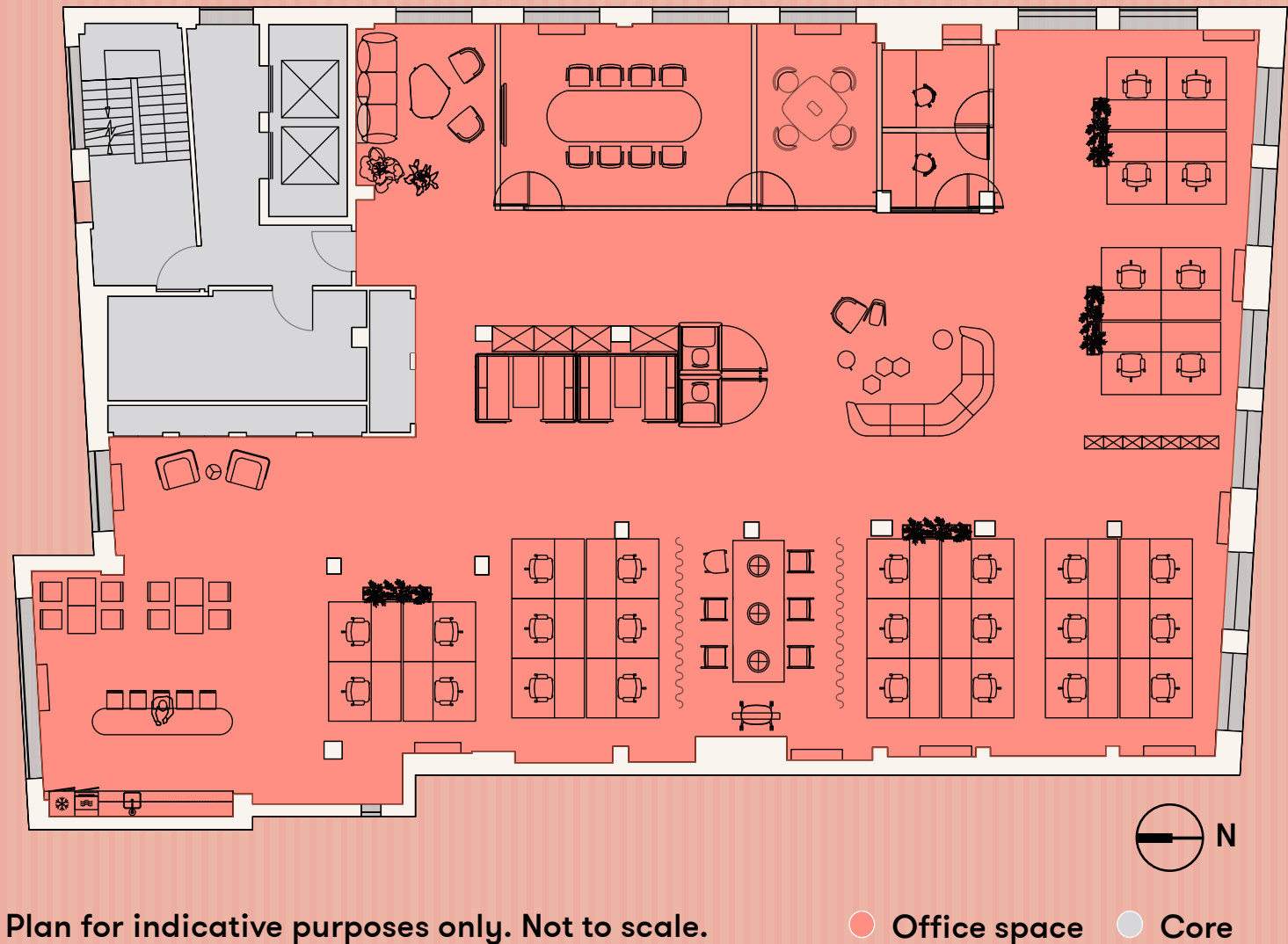

Plan for indicative purposes only. Not to scale.

Office space Core

SPECIFICATION

- | | | | |
|--|---|--|---|
| 
Manned reception | 
Bike storage & showers | 
Meeting rooms | 
Fully fitted kitchen |
| 
VRF heating cooling | 
LED lighting | 
Raised floors | 
EPC Rating B |

THE LOCATION

In the heart of the Fitzrovia Quarter on The Langham Estate, 30 Market Place is perfectly positioned between Marylebone, Soho and Fitzrovia — four of London’s most vibrant neighbourhoods.

Set just behind the bustle of Oxford Circus, the building enjoys a calm setting with immediate access to world class shopping, dining and amenities. Oxford Circus underground station is just a two-minute walk away, while the Elizabeth Line at Tottenham Court Road station is reached in five minutes, providing excellent connectivity across Central and Greater London.



WALK TIMES

Source: TfL & Google Maps.
Times taken from the building.



Oxford Circus



Bond Street

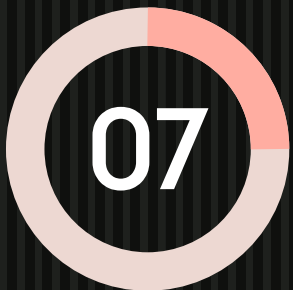

Tottenham Court Rd

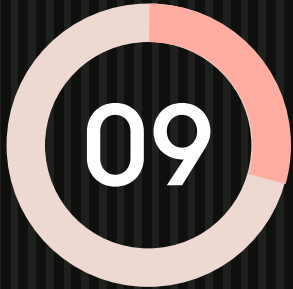

Piccadilly Circus

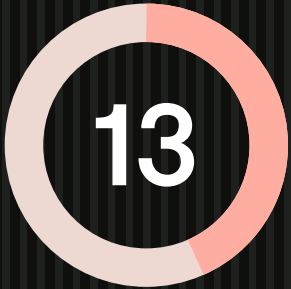

Great Portland Street

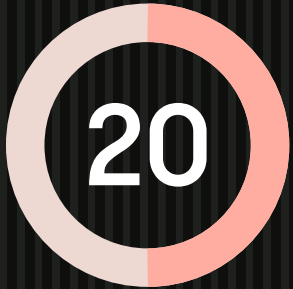

Euston



VIEWINGS

Through sole agent:

Mark Phillips
07768 857 003
mphillips@edwardcharles.co.uk

Amy Skidmore
07734 924 146
askidmore@edwardcharles.co.uk

EDWARD CHARLES
& PARTNERS W 1
CHARTERED SURVEYORS

TERMS

Upon application.

Daniel Yershon
07731 985 129
daniel.yershon@langhamestate.com

Malcolm Cohen
07526 189 462
malcolm.cohen@langhamestate.com



Misrepresentations Act 1967 - Whist all the information in this brochure is believed to be correct, neither the agent nor the client guarantee its accuracy nor is it intended to form any part of any contract. All areas quoted are approximate. July 2025.