

Manufacturers must submit shop drawings and all finish samples prior to production for apparel by designer.

All dimensions in millimeters unless noted otherwise.

NOTES:

1. This drawing is representative of design intent only and to be read in conjunction with Spaco's plans, elevations, details, schedules and specifications where applicable.
2. Spaco does not accept responsibility for any errors and dimensions arising from the preparation of base build drawings, which are derived from original material provided by others and while accurate is not Spaco's responsibility prior to manufacture and installation.
3. Refer to architect's drawing for base building set out information, all substrate, fixing details to be as architect's and structural engineer's specifications.
4. All services shown i.e. mechanical, electrical, lighting, fire, security, façade, catering and audio visual equipment are indicative only.
5. Please read in conjunction with the consultant's details and specifications where applicable.
6. The contractor is to supply, for designers, approval shop drawings and setting out rods to fully illustrate methods of construction of all millwork, case-goods, cabinetry, joinery work and other specialist finishes and features. Contractor must provide samples for the designers approval prior to manufacture.
7. Contractor to ensure that all works comply with the relevant national and/or local authority statutory requirements and in accordance with local building control and codes of practice. Contractor to ensure all appropriate certifications are provided where required.
8. The contractor must confirm that the interior fit out is achievable together with the installed services and built structure.
9. All dimensions are to finished face unless specified otherwise.
10. Interior design documentation based on information provided by the client/architect. Main contractor is required to carry out full survey and provide shop drawings to co-ordinate information between interior design documentation and existing site conditions.

[illegible]

SPACIO

Unit 12 | Beehive Business Centre |
Chelmsford | Essex | CM2 9TE

t: 01245 320900
e: hello@spacio.co.uk
w: www.spacio.co.uk

CLIENT: CYGNET PROPERTIES

PROJECT TITLE: CAM ROAD

DRAWING TITLE: *FIRST FLOOR
GENERAL ARRANGEMENT PLAN*

Scale: 1:75 Sheet size: A1 Date: 05/11/20 Drawn: ZW

Drawing no: Rev: Checked By: ZW

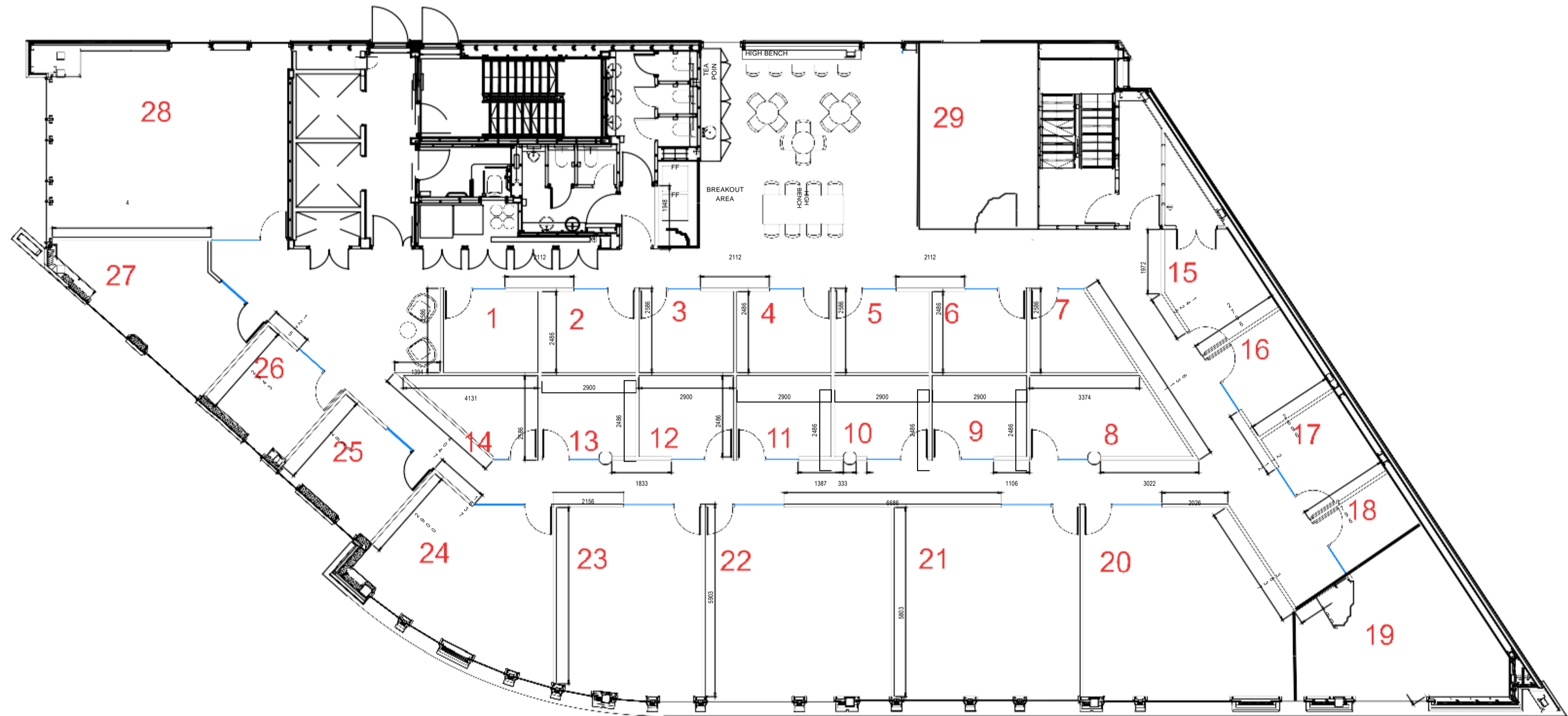

Rev	Date	Description	By
-----	------	-------------	----

1 FIRST FLOOR
Scale: 1:75