



71-91 Aldwych House

First Floor: Office 05-100

71-91 Aldwych

Aldwych House

London, WC2B



Floors: LG - 2 & 5 WeWork Total: 81,111 SQ FT

Aldwych House located at the intersection of culture and commerce.

- On the ground level, oversized windows open up to tree-lined Aldwych Street.
- Collaborative coworking spaces inspire casual conversations, while sleek private offices and meeting rooms help drive focus.
- There is a 100-capacity event space, which is bookable out of hours.
- The Strand and Somerset House are moments away, while the West End Theatre District and the big business of Fleet Street are all within walking distance.
- Commuting couldn't be easier, as nearby Holborn, Temple and Covent Garden tube stations put the entire city close at hand.

Selection of amenities



Event space



Outside space



Wellness room



Complimentary barista



Cycle storage



Showers



Dog-friendly



WeWork Market



WEBSITE

VIRTUAL TOUR

Fifth Floor

19,160 SQ FT | 231 Desks

12 Internal rooms

419 Person Office - Self Contained Full Floor

Currently programmed as:

- Up to 231 physical desks
- Private Pantry and extra teapoint
- 12 internal meeting rooms
- 3x phone booths
- Storage room
- Breakout space
- Proximity to roof terrace
- Floor is customisable and subject to redevelopment

Membership passes included: 419

Monthly credits: 838

Enjoy access to shared building amenities:

- Access to communal amenity space
- 35 bookable meeting rooms
- 27 communal phone booths
- Access to roof terrace
- In house Barista, Event Space, WeWork Honesty Market, Beer Taps, Parents Room, Showers, Bike Storage

NB: Floor plan as per current configuration, pending redevelopment

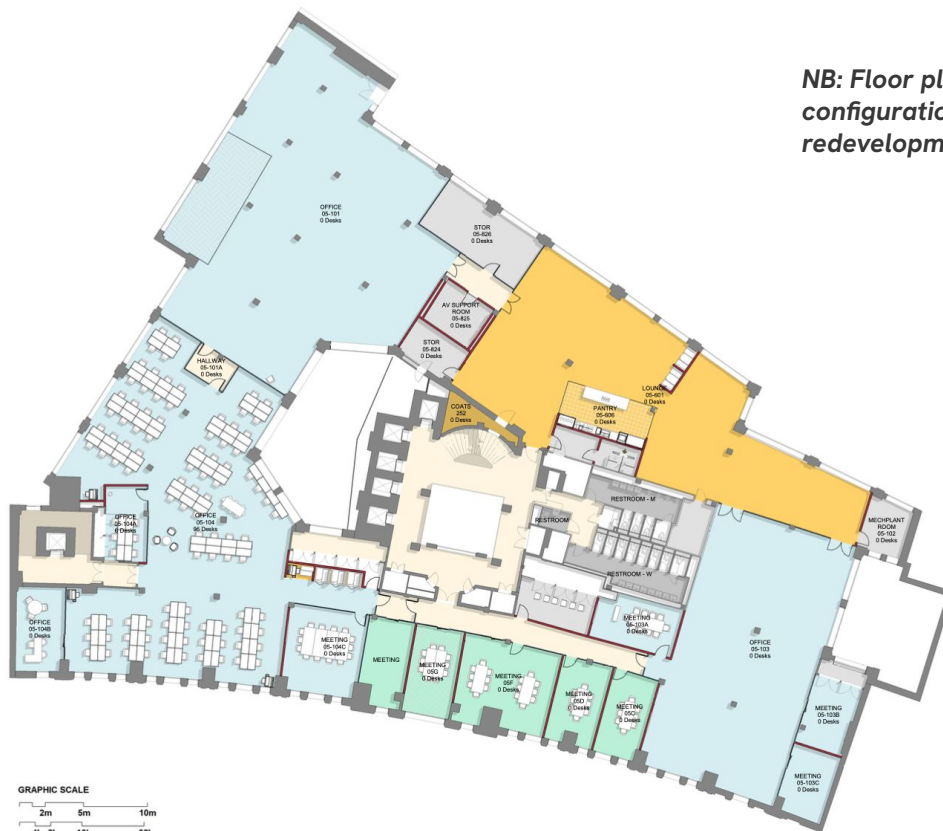

NB. Pricing is based on a total square footage (dedicated sqft + pro rata allocation of shared space).

1 The layouts presented are for illustrative purposes only; the maximum occupancy assumes WeWork's standards and density.

2 Layouts can be configured to fit client's desired needs, preferred density and programming.

Contact

For all office requirements please contact:

Suzy Richardson

Leasing Director

suzy.richardson@wework.com

wework

© 2023 WeWork. The WeWork trademark and related logos are the property of WeWork Companies LLC. Photographs contained herein may be representative examples of various WeWork locations and do not necessarily depict the WeWork location referenced in the brochure. While reasonable efforts have been made to check the accuracy of the information contained here, WeWork, its officers, employees, directors, and representatives make no warranty, express or implied, regarding the accuracy of the information and disclaim any liability arising from the use of the information contained herein. All dimensions are approximate and subject to variances. It is your obligation to independently verify particulars of the property. WeWork reserves the right to make changes.