

// 2nd Floor Cuprum Building //

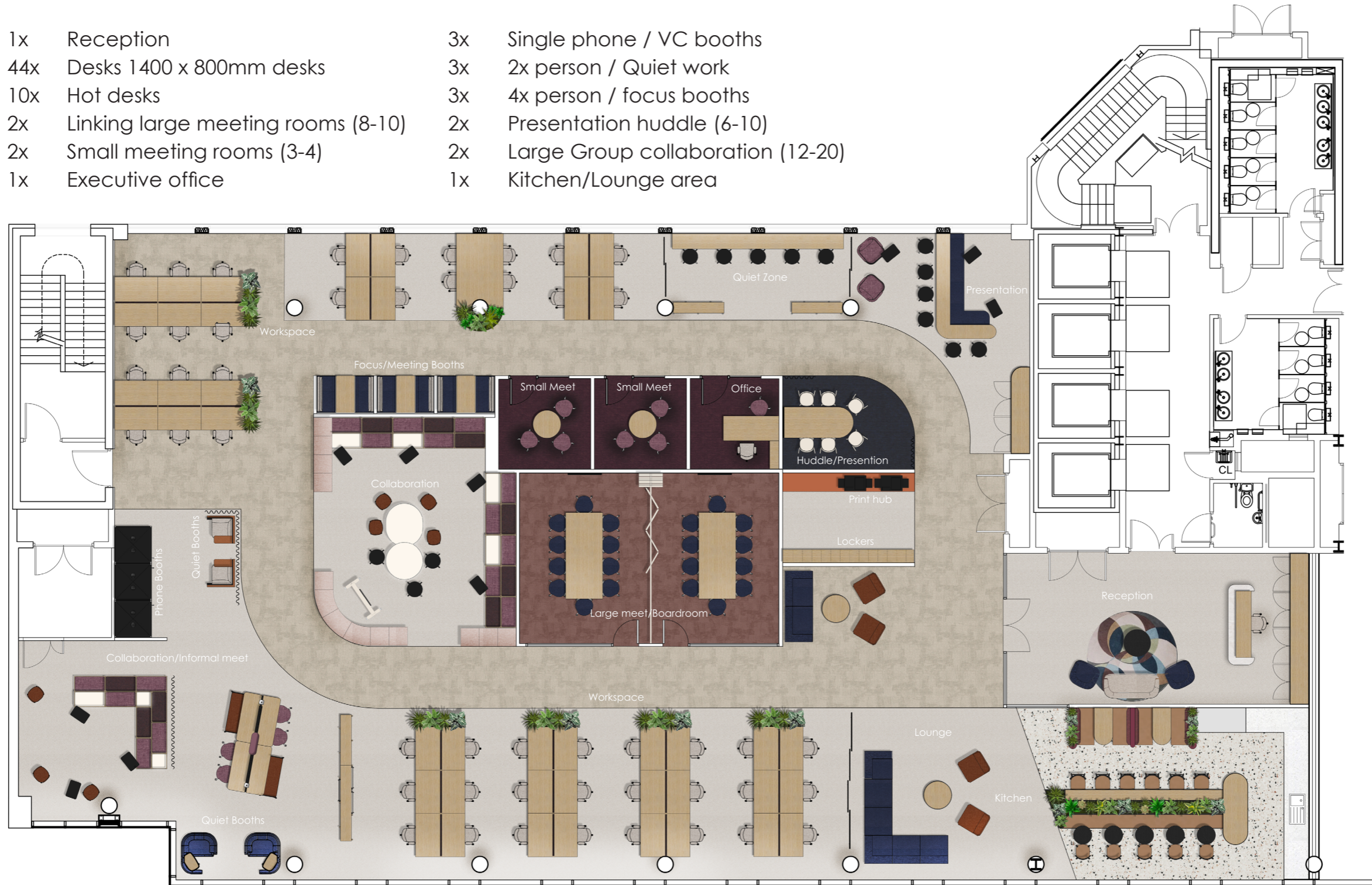

# Second Floor // Proposed Plan

- |                                       |                                      |
|---------------------------------------|--------------------------------------|
| 1x Reception                          | 3x Single phone / VC booths          |
| 44x Desks 1400 x 800mm desks          | 3x 2x person / Quiet work            |
| 10x Hot desks                         | 3x 4x person / focus booths          |
| 2x Linking large meeting rooms (8-10) | 2x Presentation huddle (6-10)        |
| 2x Small meeting rooms (3-4)          | 2x Large Group collaboration (12-20) |
| 1x Executive office                   | 1x Kitchen/Lounge area               |



# Second Floor // Proposed Plan

