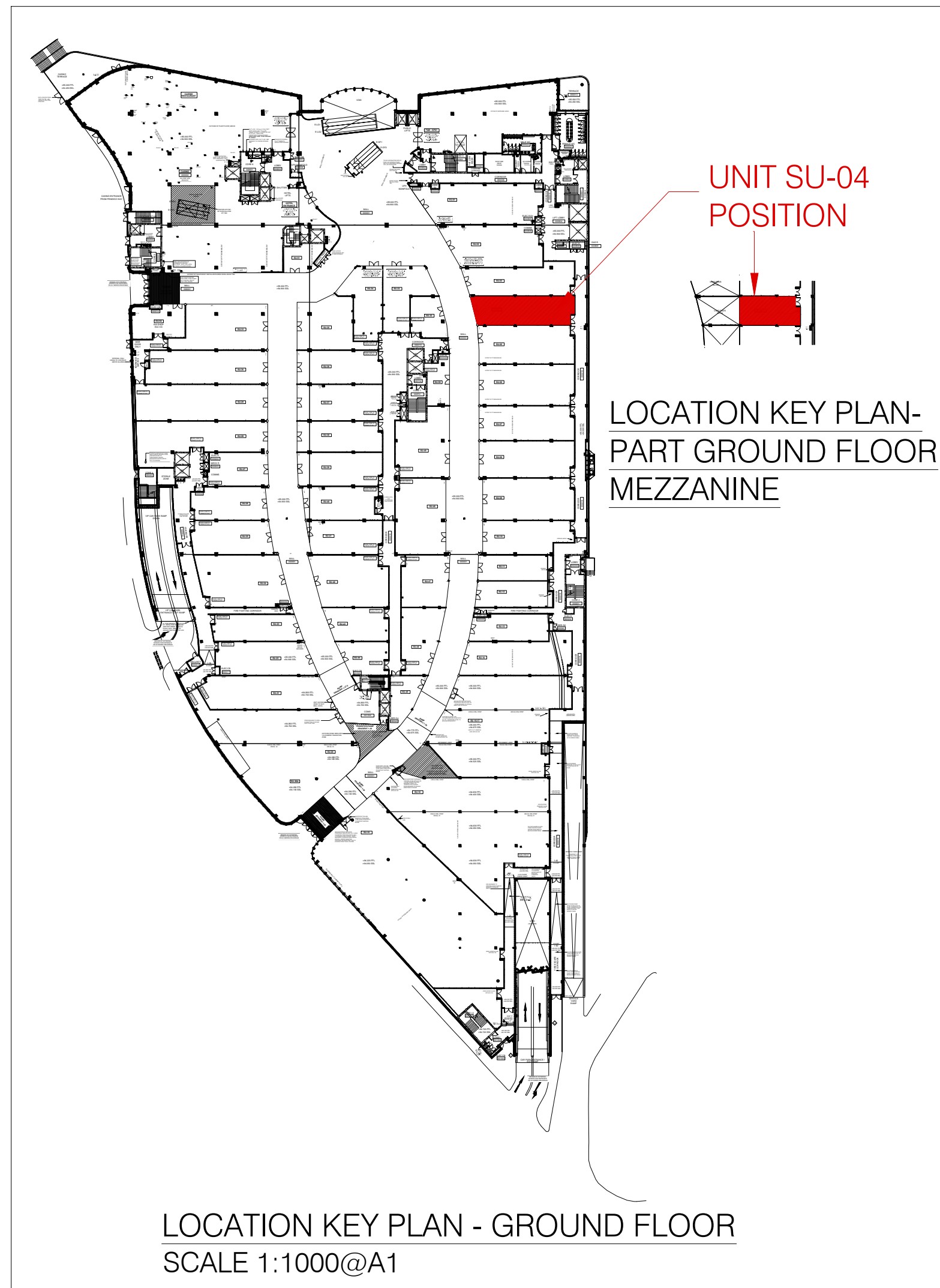

All dimensions to be checked on site prior to work commencing as this property has not been surveyed by MR+P. Any discrepancies must be reported to MR+P

WALL TILE FINISH

FLOOR FINISH SCHEDULE

Accessible WC - Polysafe non slip flooring.

Kitchenette - Polysafe non slip flooring.

Shop Floor - Vinyl tile floor finish Ref: Rustic Oak 3337,
Weld Rod Ref: 3330

ADDITIONAL LININGS

Additional 12mm plywood sheet behind plasterboard up to ceiling height.

FIRE SAFETY SYMBOLS
Internally Illuminated Exit Sign
Non Illuminated Exit Sign
Emergency Lighting Illuminator
Water Fire Extinguisher
Carbon Dioxide Fire Extinguisher
Dry Powder Fire Extinguisher
Fire Blanket
Foam Fire Extinguisher
Sprinkler
Half Hour Fire Resisting Door
One Hour Fire Resisting Door
Self Closing Device
Panic Bolt with Push Bar to Open sign
Vision Panel
Fire Door - Keep Shut Sign
Fire Door - Keep Locked Sign
Magnetic Door Closer
Smoke Detector
Heat Detector
Fire Alarm Call Point
Fire Alarm Sounder
Fire Alarm Visual Warning

FIRE SAFETY NOTES

All emergency lighting to comply with BS 5266
Fire resisting doors and partitions to comply with BS 476.
Fire alarm system to comply with BS 5839 Cat. L1
Automatic detection, sounders and beacons to provide complete coverage to the unit in accordance with BS 5839

Rev B - 04.09.15 - Bulkhead reduced in height. Shop/floor floor finish added.
Rev A - 24.05.15 - Mezzanine floor plans added.

MR+P
ARCHITECTS

MELLING RIDGEWAY + PARTNERS LTD
CHARTER HOUSE MOORE STREET
SHEFFIELD S3 7UR
t: (0114) 2723321
f: (0114) 2727395
e: info@mrp-architects.co.uk

PROJECT
GENTING SOLIHULL LTD
RESORTS WORLD, NEC
BIRMINGHAM

TITLE
PROPOSED WHITE BOX UNIT SU-04

DRAWING STATUS

CONSTRUCTION

DRAWN BY

DATE: MAY 2015

SCALE: 1:50@A1

DRAWING No.

D.J.L.

MAY 2015

1:50@A1

5404 / 201B