

SUMMARY OF AREAS

COEDCAE LANE INDUSTRIAL ESTATE, Llantrisant, PONTYCLUN, CF72

Unit Number: F1-2**Gross Internal Areas**

FLOOR	USE	AREA	AREA	INCLUDED AREAS		EXCLUDED AREAS	
		sq m	sq ft	sq m	sq ft	sq m	sq ft
GROUND	Warehouse	1080.3	11628				
	Office	142.8	1537				
	Ground Floor Total	1223.1	13165				
OVERALL TOTAL		1223.1	13165				

AREA PLAN

COEDCAE LANE IND. ESTATE

Llantrisant, PONTYCLUN, CF72

Unit Number: F1-2
Ground Floor

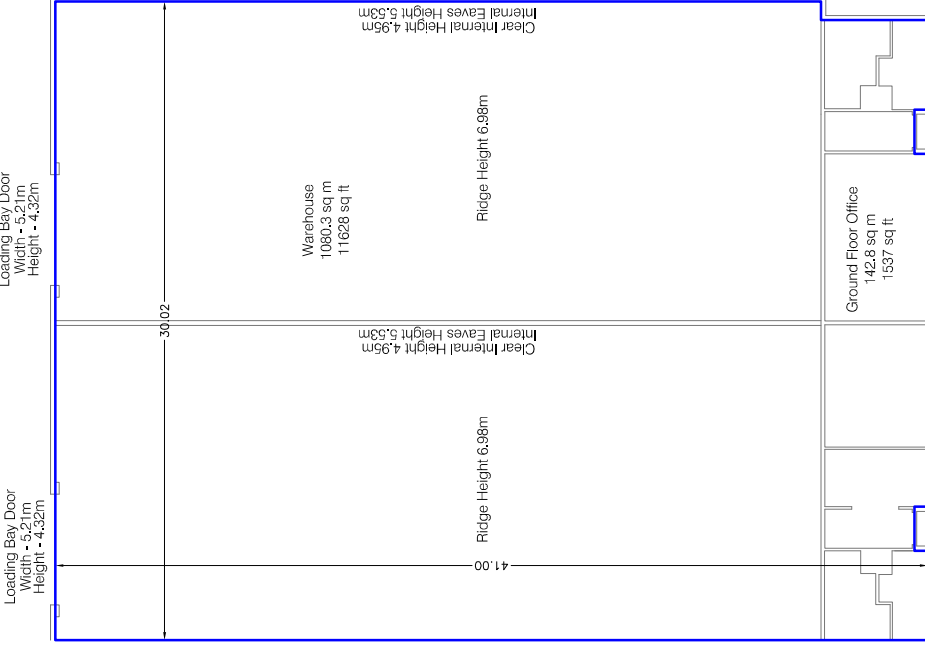

Gross Internal Area
□ GIA 1223.1 sq m 13165 sq ft

TOTAL GIA: 1223.1 sq m 13165 sq ft

Condition of Site:
Occupied
Vacant
Heavy Fit-Out
Shell & Core
Under Construction
Cat. A Fit-Out

Notes:
This drawing complies with the 6th edition of the RICS code and indicates the extent of the areas quoted, produced to an accuracy commensurate with standard presentation scales.
It is held in a scaled digital CAD format.

Revisions:
A - Original Issue (January 2014)

Dwg No. 30298-CL-UJF1_2-AG
Issue A
January 2014
Scaled for presentation purposes

Plowman Craven
Regulated by RICS



+44(0)1582 765566 www.plowmancraven.co.uk

SUMMARY OF AREAS

COEDCAE LANE INDUSTRIAL ESTATE, Llantrisant, PONTYCLUN, CF72

Unit Number: F3
Gross Internal Areas

FLOOR	USE	AREA	AREA	INCLUDED AREAS		EXCLUDED AREAS	
		sq m	sq ft	sq m	sq ft	sq m	sq ft
GROUND	Warehouse	541.4	5828				
	Office	69.5	748				
	Ground Floor Total	610.9	6576				
OVERALL TOTAL		610.9	6576				

AREA PLAN

COEDCAE LANE IND. ESTATE

Llantrisant, PONTYCLUN, CF72

Unit Number: F3
Ground Floor

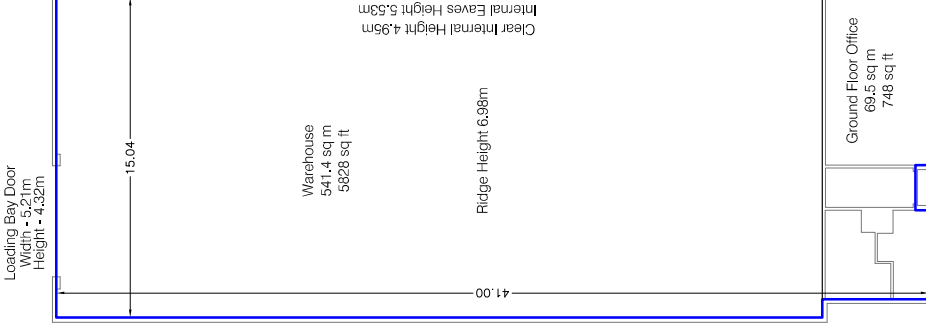

Gross Internal Area

□ GIA 610.9 sq m 6576 sq ft

TOTAL GIA: 610.9 sq m 6576 sq ft

Condition of Site:
Occupied
Vacant
Heavy Fit-Out
Shell & Core
Under Construction
Cat. A Fit-Out

Notes:
This drawing complies with the 6th edition of the RICS code and indicates the extent of the areas quoted, produced to an accuracy commensurate with standard presentation scales.
It is held in a scaled digital CAD format.

Revisions:
A - Original Issue (January 2014)

Dwg No. 30298-CL-UF3-AG

Issue A January 2014

Scaled for presentation purposes



+44(0)1582 765566 www.plowmancraven.co.uk