

The door notes below refer to the minimum fire & smoke resistance required. Some doors will have a greater resistance than this as per the door schedule but this is due to acoustic performance requirements

FD30S sc 30 minute fire & smoke resisting door & frame with overhead door closer

FD30S kl 30 minute fire & smoke resisting door, kept locked. Fitted with 'Fire door - keep locked' sign

vp all doors between staircase & corridor to have vision panels at high & low level

826 indicates door leaf width

60 minute fire separation
30 minute fire separation
SVP soil & vent pipe, boxed in & lagged by others
SS stub stack, boxed in & lagged by others

Drops only shown, refer Dynamic Design drawings for further details

indicates internal walls & doors etc designed & installed as part of fit-out works

indicates approx location of sanitary-ware or kitchen/utility, all to be designed & installed as part of fit-out works

No.	Location	Type	Leaf Size
BA-01	Rear Service Stair	FD30S sc vp	2040x926
BA-02	Main Stair	FD30S sc vp	2040x926
BA-03	Stair Lobby	FD30S sc vp	2040x926

This drawing remains the Copyright of the architects and may not be reproduced in whole or in part without their written permission

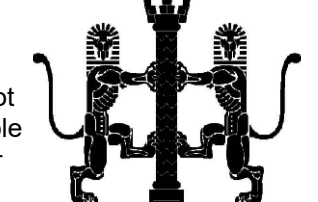

NOTES
Do not scale

Verify all dimensions on site before commencing any work or preparing any shop drawings

All building materials, components and workmanship to comply with the appropriate Public Health Acts, Building Regulations, British & European Standards and Codes of Practice and to the appropriate manufacturers recommendations.

For all specialist work see relevant drawings

All schemes to be set out completely including buildings, roads, drainage and levels prior to the commencement of works

Sites to be checked against Land Registry plans and any necessary Easements to be established

Any discrepancies, errors or omissions to be reported to the architect for further instructions before commencement of works

K		
J		
H		
G		
F		
E		
D		
C		
B		
16.07.24	Door schedule	JR
A		
19.04.24	All notes reviewed & revised to cover fit out as well as shell & core works	JR
Date	Revisions	By

DAC
Architects

21 Stone Street, Gravesend, Kent, DA11 0NP
Tel: 01474 566996 Fax: 01474 320374
Design@DACarchitects.co.uk

Project Title
DEVELOPMENT AT 201-207 KENSINGTON HIGH STREET, LONDON W8 6BA

Client
201 KEN LTD

Drawing Title
BASEMENT

FIT OUT

Scale	Date	Drawn By
1:50@A1	17.04.24	JR

Project No.	Dwg. No.	Rev.
5248	WD-310	B

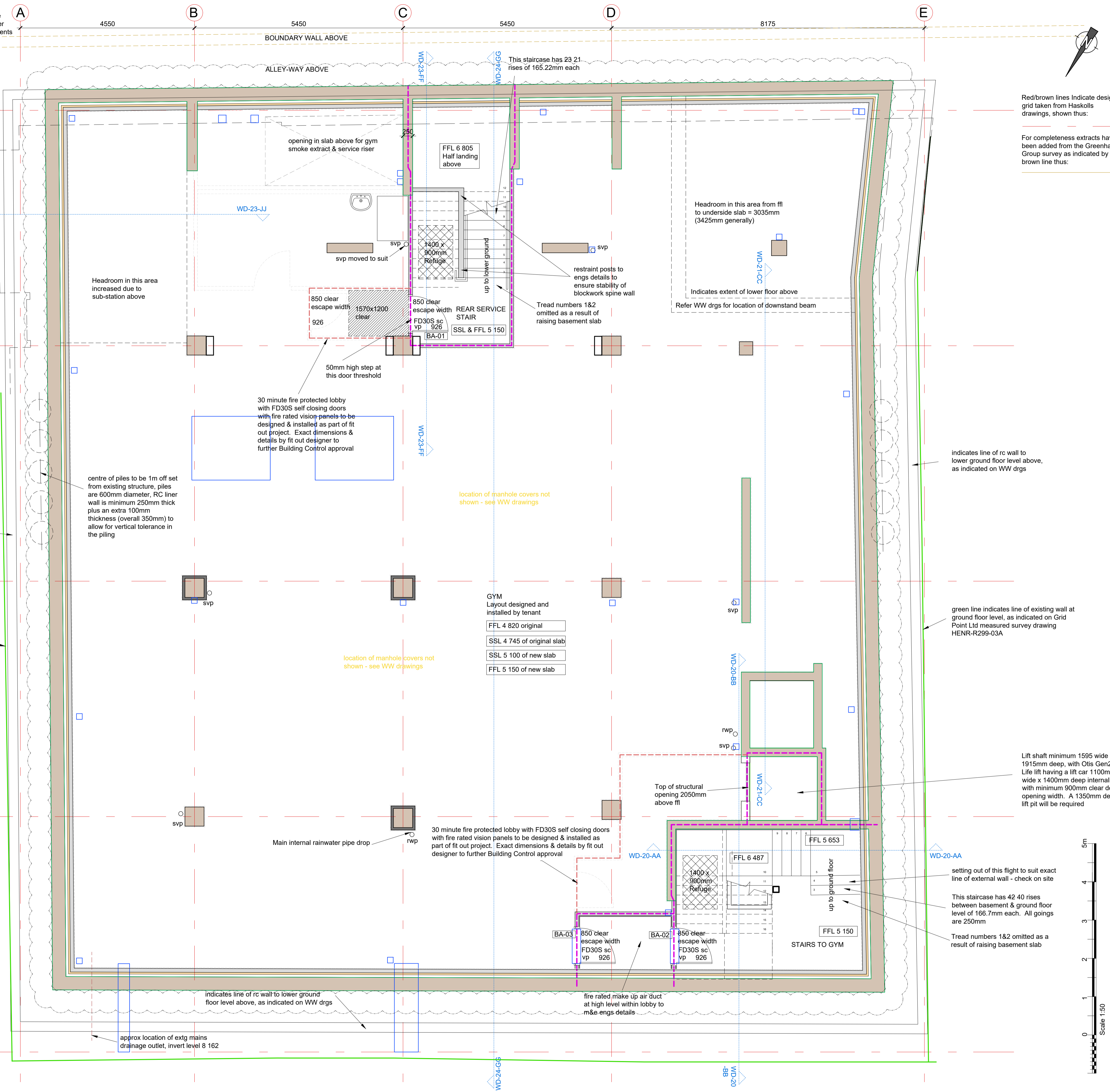

Red/brown lines indicate design grid taken from Haskolls drawings, shown thus:

For completeness extracts have been added from the Greenhatch Group survey as indicated by a brown line thus:

indicates line of rc wall to lower ground floor level above, as indicated on WW drgs

green line indicates line of existing wall at ground floor level, as indicated on Grid Point Ltd measured survey drawing HENR-R299-03A

Lift shaft minimum 1595 wide x 1915mm deep, with Otis Gen2 Life lift having a lift car 1100mm wide x 1400mm deep internally with minimum 900mm clear door opening width. A 1350mm deep lift pit will be required

setting out of this flight to suit exact line of external wall - check on site

This staircase has 42 40 rises between basement & ground floor level of 166.7mm each. All goings are 250mm

Tread numbers 1&2 omitted as a result of raising basement slab

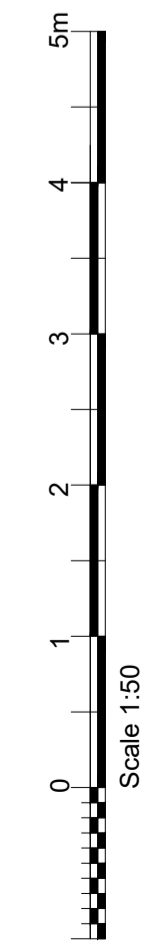

GYM Layout designed and installed by tenant

FFL 4 820 original
SSL 4 745 of original slab
SSL 5 100 of new slab
FFL 5 150 of new slab

30 minute fire protected lobby with FD30S self closing doors with fire rated vision panels to be designed & installed as part of fit out project. Exact dimensions & details by fit out designer to further Building Control approval

30 minute fire protected lobby with FD30S self closing doors with fire rated vision panels to be designed & installed as part of fit out project. Exact dimensions & details by fit out designer to further Building Control approval

centre of piles to be 1m off set from existing structure, piles are 600mm diameter, RC liner wall is minimum 250mm thick plus an extra 100mm thickness (overall 350mm) to allow for vertical tolerance in the piling

location of manhole covers not shown - see WW drawings

fire rated make up air duct at high level within lobby to m&e engs details

approx location of extg mains drainage outlet, invert level 8 162

indicates line of rc wall to lower ground floor level above, as indicated on WW drgs

indicates line of rc wall to lower ground floor level above, as indicated on WW drgs

restraint posts to engs details to ensure stability of blockwork spine wall

Tread numbers 1&2 omitted as a result of raising basement slab

Headroom in this area from ffl to underside slab = 3035mm (3425mm generally)

Indicates extent of lower floor above

Refer WW drgs for location of downstand beam

FFL 6 805 Half landing above

This staircase has 23 21 rises of 165.22mm each

opening in slab above for gym smoke extract & service riser

Headroom in this area increased due to sub-station above

850 clear escape width
1570x1200 clear
926

850 clear escape width
1400 x 900mm Refuge

REAR SERVICE STAIR
SSL & FFL 5 150

50mm high step at this door threshold

30 minute fire protected lobby with FD30S self closing doors with fire rated vision panels to be designed & installed as part of fit out project. Exact dimensions & details by fit out designer to further Building Control approval

location of manhole covers not shown - see WW drawings

GYM Layout designed and installed by tenant

FFL 4 820 original
SSL 4 745 of original slab
SSL 5 100 of new slab
FFL 5 150 of new slab

30 minute fire protected lobby with FD30S self closing doors with fire rated vision panels to be designed & installed as part of fit out project. Exact dimensions & details by fit out designer to further Building Control approval

30 minute fire protected lobby with FD30S self closing doors with fire rated vision panels to be designed & installed as part of fit out project. Exact dimensions & details by fit out designer to further Building Control approval

centre of piles to be 1m off set from existing structure, piles are 600mm diameter, RC liner wall is minimum 250mm thick plus an extra 100mm thickness (overall 350mm) to allow for vertical tolerance in the piling

location of manhole covers not shown - see WW drawings

fire rated make up air duct at high level within lobby to m&e engs details

approx location of extg mains drainage outlet, invert level 8 162

indicates line of rc wall to lower ground floor level above, as indicated on WW drgs

indicates line of rc wall to lower ground floor level above, as indicated on WW drgs

restraint posts to engs details to ensure stability of blockwork spine wall

Tread numbers 1&2 omitted as a result of raising basement slab

Headroom in this area from ffl to underside slab = 3035mm (3425mm generally)

Indicates extent of lower floor above

Refer WW drgs for location of downstand beam

FFL 6 805 Half landing above

This staircase has 23 21 rises of 165.22mm each

opening in slab above for gym smoke extract & service riser

Headroom in this area increased due to sub-station above

850 clear escape width
1570x1200 clear
926

850 clear escape width
1400 x 900mm Refuge

REAR SERVICE STAIR
SSL & FFL 5 150

50mm high step at this door threshold

30 minute fire protected lobby with FD30S self closing doors with fire rated vision panels to be designed & installed as part of fit out project. Exact dimensions & details by fit out designer to further Building Control approval

location of manhole covers not shown - see WW drawings

GYM Layout designed and installed by tenant

FFL 4 820 original
SSL 4 745 of original slab
SSL 5 100 of new slab
FFL 5 150 of new slab

30 minute fire protected lobby with FD30S self closing doors with fire rated vision panels to be designed & installed as part of fit out project. Exact dimensions & details by fit out designer to further Building Control approval

30 minute fire protected lobby with FD30S self closing doors with fire rated vision panels to be designed & installed as part of fit out project. Exact dimensions & details by fit out designer to further Building Control approval

centre of piles to be 1m off set from existing structure, piles are 600mm diameter, RC liner wall is minimum 250mm thick plus an extra 100mm thickness (overall 350mm) to allow for vertical tolerance in the piling

location of manhole covers not shown - see WW drawings

fire rated make up air duct at high level within lobby to m&e engs details

approx location of extg mains drainage outlet, invert level 8 162

indicates line of rc wall to lower ground floor level above, as indicated on WW drgs

indicates line of rc wall to lower ground floor level above, as indicated on WW drgs

restraint posts to engs details to ensure stability of blockwork spine wall

Tread numbers 1&2 omitted as a result of raising basement slab

Headroom in this area from ffl to underside slab = 3035mm (3425mm generally)

Indicates extent of lower floor above

Refer WW drgs for location of downstand beam

FFL 6 805 Half landing above

This staircase has 23 21 rises of 165.22mm each

opening in slab above for gym smoke extract & service riser

Headroom in this area increased due to sub-station above

850 clear escape width
1570x1200 clear
926

850 clear escape width
1400 x 900mm Refuge

REAR SERVICE STAIR
SSL & FFL 5 150

50mm high step at this door threshold

30 minute fire protected lobby with FD30S self closing doors with fire rated vision panels to be designed & installed as part of fit out project. Exact dimensions & details by fit out designer to further Building Control approval

location of manhole covers not shown - see WW drawings

GYM Layout designed and installed by tenant

FFL 4 820 original
SSL 4 745 of original slab
SSL 5 100 of new slab
FFL 5 150 of new slab

30 minute fire protected lobby with FD30S self closing doors with fire rated vision panels to be designed & installed as part of fit out project. Exact dimensions & details by fit out designer to further Building Control approval

30 minute fire protected lobby with FD30S self closing doors with fire rated vision panels to be designed & installed as part of fit out project. Exact dimensions & details by fit out designer to further Building Control approval

centre of piles to be 1m off set from existing structure, piles are 600mm diameter, RC liner wall is minimum 250mm thick plus an extra 100mm thickness (overall 350mm) to allow for vertical tolerance in the piling

location of manhole covers not shown - see WW drawings

fire rated make up air duct at high level within lobby to m&e engs details

approx location of extg mains drainage outlet, invert level 8 162

indicates line of rc wall to lower ground floor level above, as indicated on WW drgs

indicates line of rc wall to lower ground floor level above, as indicated on WW drgs

restraint posts to engs details to ensure stability of blockwork spine wall

Tread numbers 1&2 omitted as a result of raising basement slab

Headroom in this area from ffl to underside slab = 3035mm (3425mm generally)

Indicates extent of lower floor above

Refer WW drgs for location of downstand beam

FFL 6 805 Half landing above

This staircase has 23 21 rises of 165.22mm each

opening in slab above for gym smoke extract & service riser

Headroom in this area increased due to sub-station above

850 clear escape width
1570x1200 clear
926

850 clear escape width
1400 x 900mm Refuge

REAR SERVICE STAIR
SSL & FFL 5 150

50mm high step at this door threshold

30 minute fire protected lobby with FD30S self closing doors with fire rated vision panels to be designed & installed as part of fit out project. Exact dimensions & details by fit out designer to further Building Control approval

location of manhole covers not shown - see WW drawings

GYM Layout designed and installed by tenant

FFL 4 820 original
SSL 4 745 of original slab
SSL 5 100 of new slab
FFL 5 150 of new slab

30 minute fire protected lobby with FD30S self closing doors with fire rated vision panels to be designed & installed as part of fit out project. Exact dimensions & details by fit out designer to further Building Control approval

30 minute fire protected lobby with FD30S self closing doors with fire rated vision panels to be designed & installed as part of fit out project. Exact dimensions & details by fit out designer to further Building Control approval

centre of piles to be 1m off set from existing structure, piles are 600mm diameter, RC liner wall is minimum 250mm thick plus an extra 100mm thickness (overall 350mm) to allow for vertical tolerance in the piling

location of manhole covers not shown - see WW drawings

fire rated make up air duct at high level within lobby to m&e engs details

approx location of extg mains drainage outlet, invert level 8 162

indicates line of rc wall to lower ground floor level above, as indicated on WW drgs

indicates line of rc wall to lower ground floor level above, as indicated on WW drgs

restraint posts to engs details to ensure stability of blockwork spine wall

Tread numbers 1&2 omitted as a result of raising basement slab

Headroom in this area from ffl to underside slab = 3035mm (3425mm generally)

Indicates extent of lower floor above

Refer WW drgs for location of downstand beam

FFL 6 805 Half landing above

This staircase has 23 21 rises of 165.22mm each

opening in slab above for gym smoke extract & service riser

Headroom in this area increased due to sub-station above

850 clear escape width
1570x1200 clear
926

850 clear escape width
1400 x 900mm Refuge

REAR SERVICE STAIR
SSL & FFL 5 150

50mm high step at this door threshold

30 minute fire protected lobby with FD30S self closing doors with fire rated vision panels to be designed & installed as part of fit out project. Exact dimensions & details by fit out designer to further Building Control approval

location of manhole covers not shown - see WW drawings

GYM Layout designed and installed by tenant

FFL 4 820 original
SSL 4 745 of original slab
SSL 5 100 of new slab
FFL 5 150 of new slab

30 minute fire protected lobby with FD30S self closing doors with fire rated vision panels to be designed & installed as part of fit out project. Exact dimensions & details by fit out designer to further Building Control approval

30 minute fire protected lobby with FD30S self closing doors with fire rated vision panels to be designed & installed as part of fit out project. Exact dimensions & details by fit out designer to further Building Control approval

centre of piles to be 1m off set from existing structure, piles are 600mm diameter, RC liner wall is minimum 250mm thick plus an extra 100mm thickness (overall 350mm) to allow for vertical tolerance in the piling

location of manhole covers not shown - see WW drawings

fire rated make up air duct at high level within lobby to m&e engs details

approx location of extg mains drainage outlet, invert level 8 162

indicates line of rc wall to lower ground floor level above, as indicated on WW drgs

indicates line of rc wall to lower ground floor level above, as indicated on WW drgs

restraint posts to engs details to ensure stability of blockwork spine wall

Tread numbers 1&2 omitted as a result of raising basement slab

Headroom in this area from ffl to underside slab = 3035mm (3425mm generally)

Indicates extent of lower floor above

Refer WW drgs for location of downstand beam

FFL 6 805 Half landing above

This staircase has 23 21 rises of 165.22mm each

opening in slab above for gym smoke extract & service riser

Headroom in this area increased due to sub-station above

850 clear escape width
1570x1200 clear
926

850 clear escape width
1400 x 900mm Refuge

REAR SERVICE STAIR
SSL & FFL 5 150

50mm high step at this door threshold

30 minute fire protected lobby with FD30S self closing doors with fire rated vision panels to be designed & installed as part of fit out project. Exact dimensions & details by fit out designer to further Building Control approval

location of manhole covers not shown - see WW drawings

GYM Layout designed and installed by tenant

FFL 4 820 original
SSL 4 745 of original slab
SSL 5 100 of new slab
FFL 5 150 of new slab

30 minute fire protected lobby with FD30S self closing doors with fire rated vision panels to be designed & installed as part of fit out project. Exact dimensions & details by fit out designer to further Building Control approval

30 minute fire protected lobby with FD30S self closing doors with fire rated vision panels to be designed & installed as part of fit out project. Exact dimensions & details by fit out designer to further Building Control approval

centre of piles to be 1m off set from existing structure, piles are 600mm diameter, RC liner wall is minimum 250mm thick plus an extra 100mm thickness (overall 350mm) to allow for vertical tolerance in the piling

location of manhole covers not shown - see WW drawings

fire rated make up air duct at high level within lobby to m&e engs details

approx location of extg mains drainage outlet, invert level 8 162

indicates line of rc wall to lower ground floor level above, as indicated on WW drgs

indicates line of rc wall to lower ground floor level above, as indicated on WW drgs

restraint posts to engs details to ensure stability of blockwork spine wall

Tread numbers 1&2 omitted as a result of raising basement slab

Headroom in this area from ffl to underside slab = 3035mm (3425mm generally)

Indicates extent of lower floor above

Refer WW drgs for location of downstand beam

FFL 6 805 Half landing above

This staircase has 23 21 rises of 165.22mm each

opening in slab above for gym smoke extract & service riser

Headroom in this area increased due to sub-station above

850 clear escape width
1570x1200 clear
926

850 clear escape width
1400 x 900mm Refuge

REAR SERVICE STAIR
SSL & FFL 5 150

50mm high step at this door threshold

30 minute fire protected lobby with FD30S self closing doors with fire rated vision panels to be designed & installed as part of fit out project. Exact dimensions & details by fit out designer to further Building Control approval

location of manhole covers not shown - see WW drawings

GYM Layout designed and installed by tenant

FFL 4 820 original
SSL 4 745 of original slab
SSL 5 100 of new slab
FFL 5 150 of new slab

30 minute fire protected lobby with FD30S self closing doors with fire rated vision panels to be designed & installed as part of fit out project. Exact dimensions & details by fit out designer to further Building