



103

—

MOUNT STREET

MAYFAIR W1

4,158 sq ft of Fully Fitted and Furnished Workspace



CLASSIC MAYFAIR

This impressive building features a bright and spacious 4th floor office, offering 4,158 sq ft of new, fully fitted and furnished workspace. Overlooking both the serene Mount Street Gardens and Mount Street, the office benefits from a refurbished, manned reception, while the building itself boasts outstanding amenities and exceptional end of trip facilities.



Building reception



Bespoke height adjustable desking with industry leading ergonomic task chairs



HIGHLIGHTS



Fully refurbished
manned reception



Furnished client
waiting area



2x new automatic
passenger lifts



Fully fitted



Shower rooms with
towel service and lockers



Air-conditioning



Cycle storage facilities



High quality furnishing



EPC B - 40





Executive office suite designed with high-end luxury tailored furnishings

4TH FLOOR

4,158 sq ft
(386.3 sq m)

16x Person Boardroom
6x Person Meeting Room
Executive Chairperson Suite
2x Private Offices
18x Workstations
Fully Fitted Kitchen

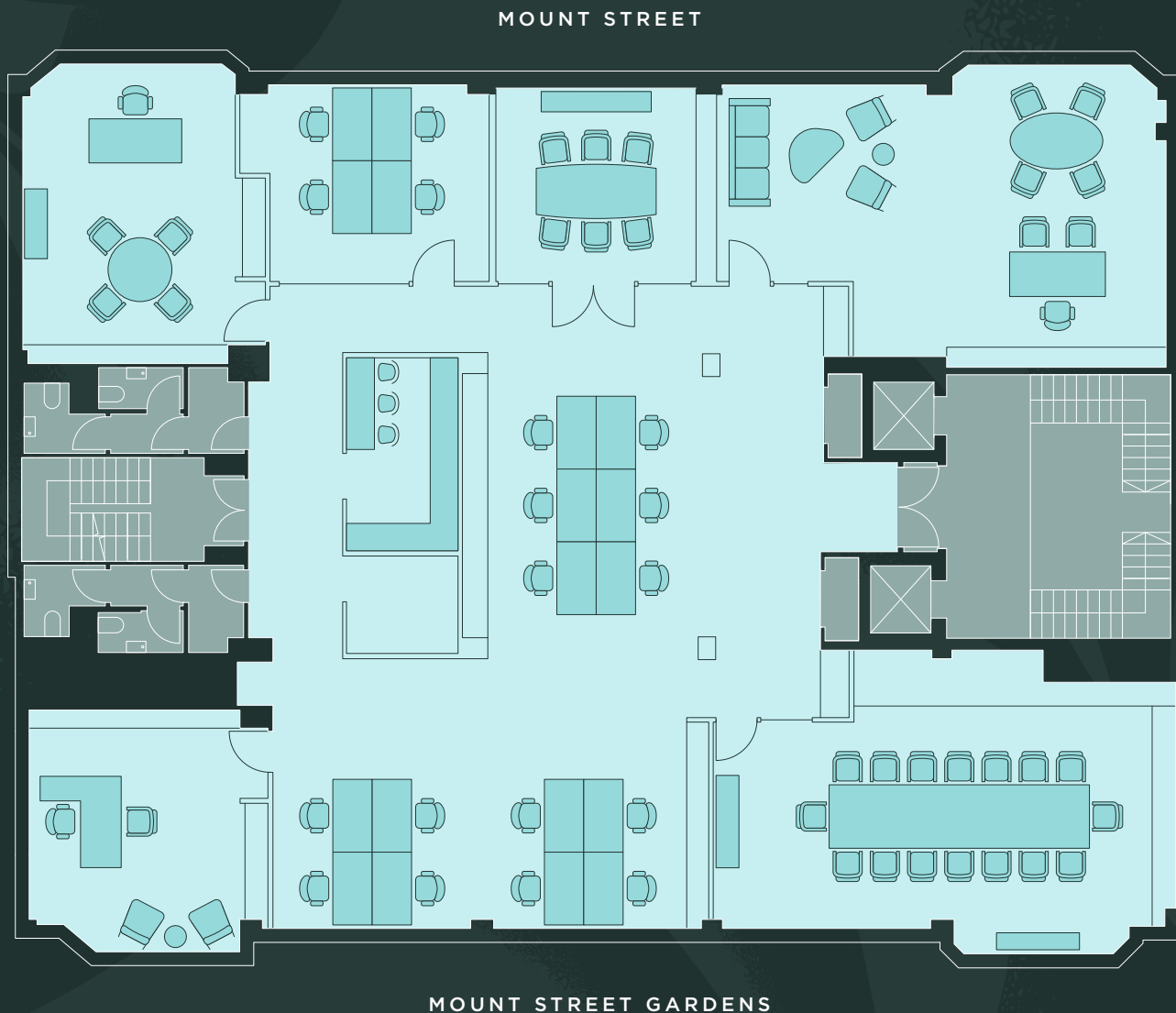



Conference table with 16x mid-back executive meeting chairs



103 MOUNT STREET

EXCLUSIVE MAYFAIR



Mount Street embodies the character of Mayfair, this exclusive street is home to world-class fashion, fine dining, and renowned art, all set against a backdrop of elegant green spaces. A prestigious destination, it boasts some of the most esteemed retail, restaurant, bar, and hotel offerings in the world. With Green Park and Bond Street underground stations just a short walk away, it also benefits from excellent connectivity.

RESTAURANTS

- | | | | |
|---|------------|----|----------------|
| 1 | Mercato | 8 | Cipriani |
| 2 | NAC | 9 | Jamavar |
| 3 | Lucky Cat | 10 | Kai |
| 4 | Ikedo | 11 | Sparrow Italia |
| 5 | 34 Mayfair | 12 | Delfino |
| 6 | Scott's | 13 | MiMi Mei Fair |
| 7 | KOYN | 14 | BiBi |

HOTELS

- | | |
|----|---------------------|
| 1 | Native |
| 2 | The Twenty Two |
| 3 | The Beaumont |
| 4 | London Marriott |
| 5 | Claridge's |
| 6 | The Biltmore |
| 7 | The Connaught |
| 8 | The Dorchester |
| 9 | The Grosvenor House |
| 10 | Chancery Rosewood |

MEMBERS CLUBS

- | | |
|---|-------------|
| 1 | George |
| 2 | Annabel's |
| 3 | Harry's Bar |

BARS

- | | |
|---|--------------------|
| 1 | The Pine Bar |
| 2 | The Punch Bowl |
| 3 | The Coach & Horses |
| 4 | Guinea Grill |
| 5 | The Audley |
| 6 | The Footman |
| 7 | The Barley Mow |

CAFÉS

- | | |
|---|--------------|
| 1 | Marchesi |
| 2 | LALÍ |
| 3 | ARC Le Salon |
| 4 | Hideaway |





MOUNT STREET

MAYFAIR W1



Sanderson
Weatherall



STUART FRICKER

07775 702 370

stuart.fricker@sw.co.uk

ROSS BLANCHFLOWER

07734 365 141

ross.blanchflower@sw.co.uk

HARRY THEAKSTON

07500 847 045

harry.theakston@allsop.co.uk

RICHARD TOWNSEND

07787 153 408

richard.townsend@allsop.co.uk

Misrepresentation Act: 1. Sanderson Weatherall on its own behalf and on behalf of the vendor/lessor of this property whose agent Sanderson Weatherall is, gives notice that: (a) these particulars do not constitute in whole or in part an offer or contract for sale or lease; (b) none of the statements contained in these particulars as to the property are to be relied on as statements or representations of fact; and (c) the vendor/lessor does not make or give, and Sanderson Weatherall nor any of its members or any person in its employment has any authority to make or give, any representation or warranty whatsoever in relation to the property. The only representations, warranties, undertakings and contractual obligations to be given or undertaken by the vendor/lessor are those contained and expressly referred to in the written contract for sale or agreement for lease between the vendor/lessor and a purchaser or tenant. 2. Prospective purchasers or tenants are strongly advised to: (a) satisfy themselves as to the correctness of each statement contained in these particulars; (b) inspect the property and the neighbouring area; (c) ensure that any items expressed to be included are available and in working order; (d) arrange a full structural (and where appropriate environmental) survey of the property; and (e) carry out all necessary searches and enquiries. May 2025.