

SUBJECT TO FULL SITE SURVEYS AND BUILDING REGULATION CHECKS

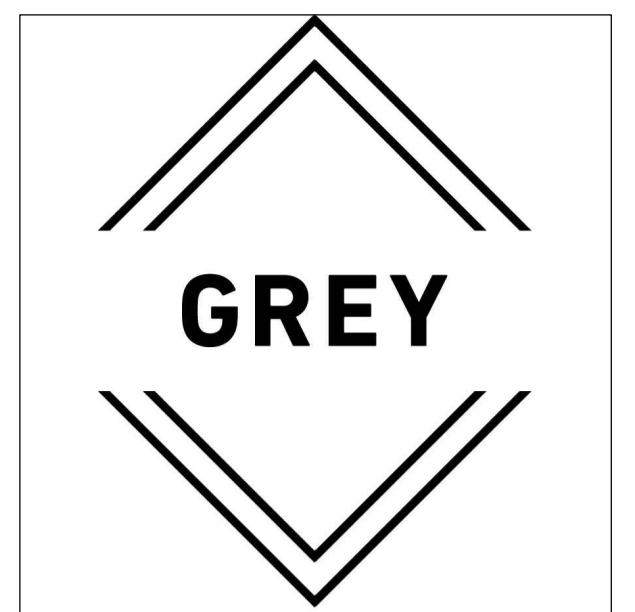

THINK. DESIGN. BUILD

7 MURRELL GREEN
BUSINESS PARK
LONDON ROAD
RG27 9GR

T. 01252 543097
hello@grey.limited
www.greyinteriors.co.uk

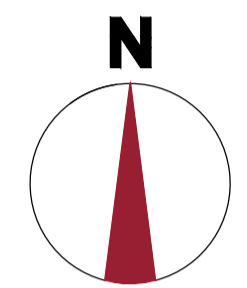

THIS DRAWING IS PROTECTED UNDER COPYRIGHT. THIS DRAWING IS NOT TO BE REPRODUCED IN WHOLE OR PART UNLESS AUTHORISED BY GREY. © COPYRIGHT THIS DRAWING IS NOT TO BE SCALED. THE GENERAL CONTRACTOR IS TO CHECK ALL DIMENSIONS AND NOTIFY THE DESIGNERS OF ANY DISCREPANCIES OR OMISSIONS.

APPROX AREA: 283.7 sqm/
3054 sq ft

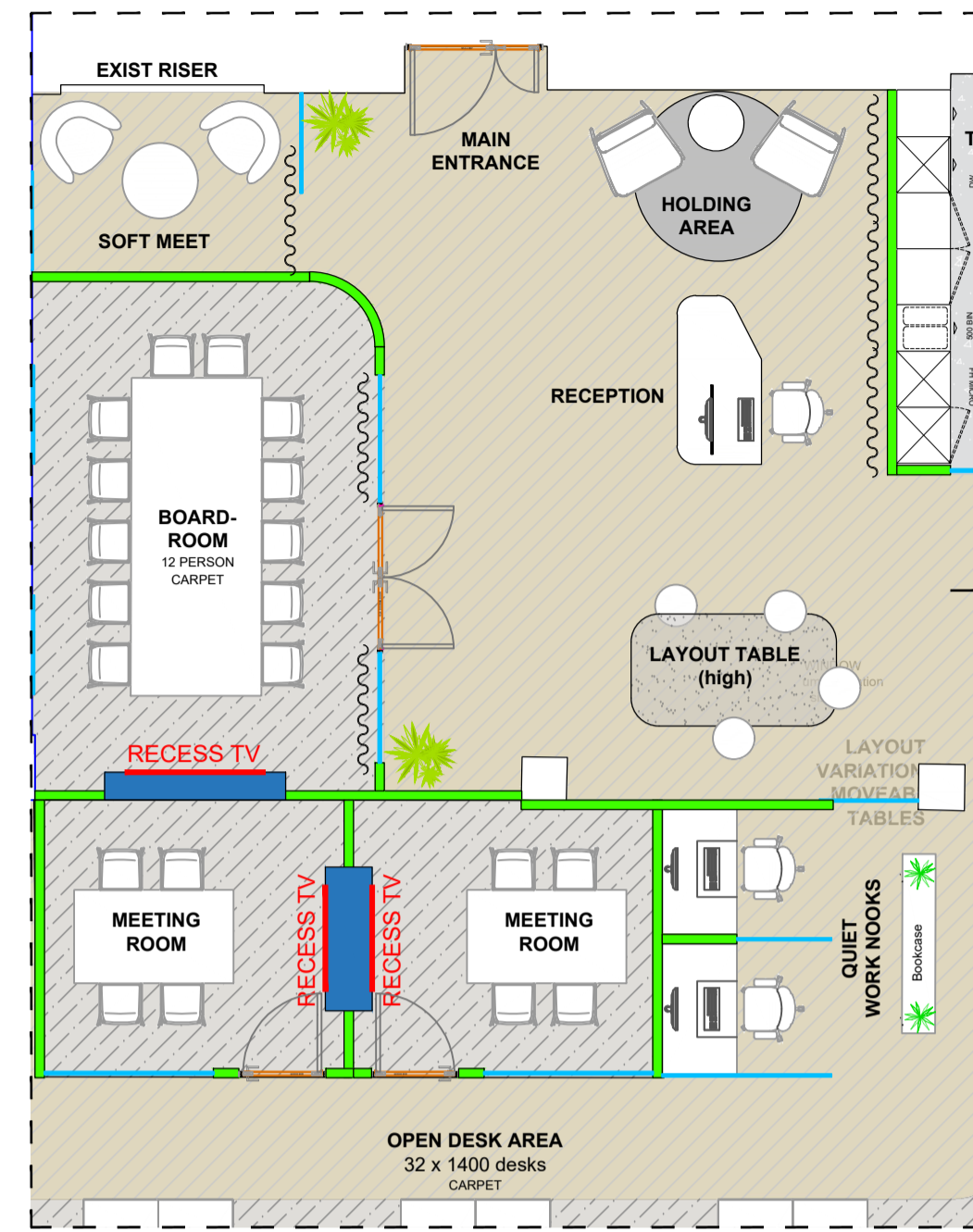

RECEPTION LAYOUT VARIATION



FIRST

Proposed First Floor General arrangement plan Option 1

12-18 NEW BRIDGE STREET 1st FLOOR OPTION 1 DRAWING DATA- AREA = 3054 sqft/283.7 sqm

Area	No	Seats	Total Fixed desks	Total spaces to work	Total closed spaces to meet	Total open spaces to meet
Holding Area	1	4	0	0	0	1
Soft Meet	1	2	0	0	0	1
Boardroom	1	12	0	0	1	0
Tea point	1	0	0	3	0	0
Breakout	1	9	0	3	0	3
Flexible Room Break out extention/games/training	1	4	4	4	1	0
Meeting rooms	2	8	0	0	2	0
Quiet Work Nooks	2	2	0	0	0	0
Print Points	1	0	0	0	0	0
Open Plan desks(1400 x 800)	32	32	32	32	0	0
Collab/Agile Working	2	16	0	4	0	2
1 Person Booth	1	1	0	0	1	0
comms	1	0	0	0	0	0
Lockers	tbc	0	0	0	0	0
TOTALS	47	90	36	46	5	7

01.01.24 A specify revisions here...

DATE	REV	REVISIONS	SIGN

CLIENT
Landlord.

PROJECT
16-18 New Bridge Street
London
EC2V

TITLE
Proposed First Floor General arrangement plan Option 1

SCALE: 1:75 @ A1
DATE: 01.05.2026
DRAWING: G_26_2419_01_GA_opt1
DRAWING STATUS: PRELIMINARY

PROJECT NO: 2026_2419
DESIGNER: AT
REV: .

CLIENT SIGNATURE: SIGNOFF DATE: