

UP TO 35,000 SQ.FT LEISURE & F&B OPPORTUNITIES

SWAN WALK
HORSHAM RH12 1HQ





Prime Central Location

Horsham is an affluent and attractive town in the South East England, 33 miles south of London.

Horsham is an extremely desirable location to live, work and play. The town was crowned 4th of the UK's best places to live in 2020 (Sunday Times) due to its high life expectancy, excellent health and high average earnings.

Horsham is a commuter town with excellent connectivity to London and other major towns

The subject unit, formerly Wilko's is located in Horsham Town Centre at the junction of West Street, Springfield Road, Worthing Road and the pedestrianised section of Bishopric. The property sits adjacent to national brands including Wetherspoons, H&M, Sostrene Grene, Sports Direct and Greggs.

The scheme is anchored by a full line Marks & Spencer's (81,230 sq. ft) and benefits from a 900 space car park.

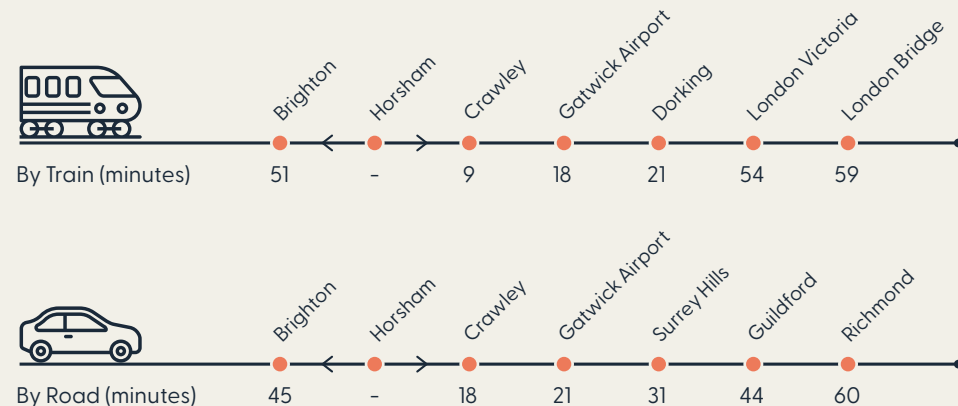



6.7m
footfall



83.7%
market share in
primary catchment



900
space
car park



64%
in the ABC1 social
grade category



386,632
residents in the
Horsham area



Affluent area
over half of the population
being within either "Affluent

Achievers" (46.3%)
and "Rising Prosperity"
(12.7%) Acorn groups





Existing Plans



28,990 sq. ft



Potential to split

	Area (sq. ft)	Area (sq. m)
Ground Floor	16,474	1,530.48
First Floor	12,518	1,162.96

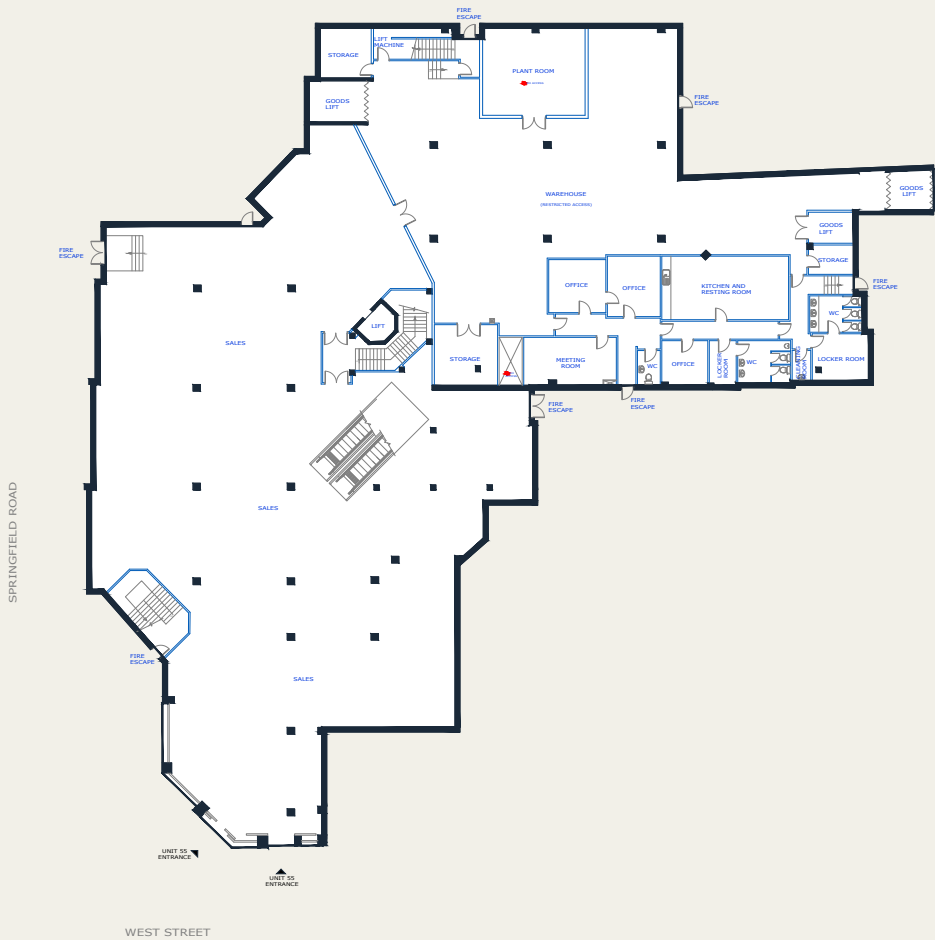

Ground Floor

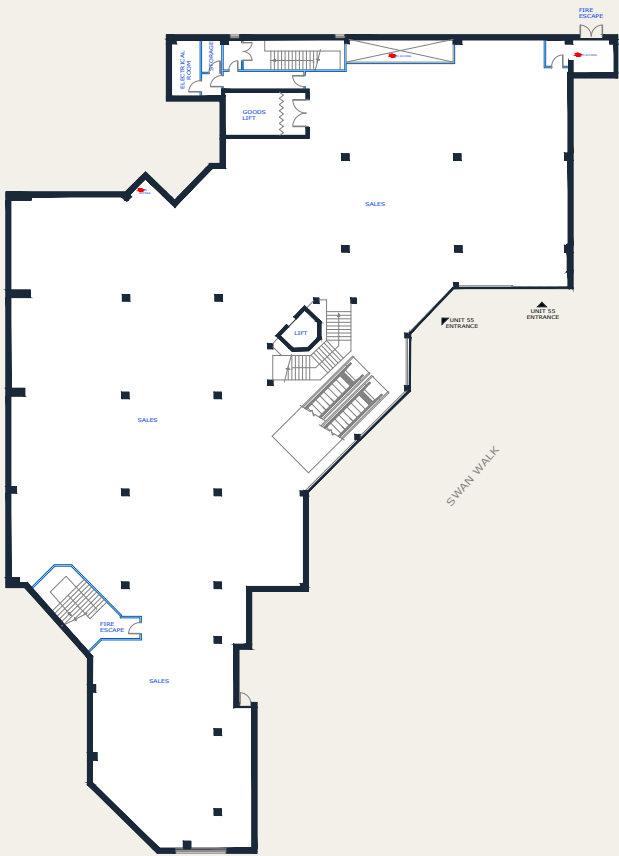

Upper Ground Floor

Proposed Plans



35,391 sq. ft



Potential to split

Area (sq. ft) Area (sq. m)

Ground Floor Up to 16,474 1,530.48

First Floor 18,917 1,757

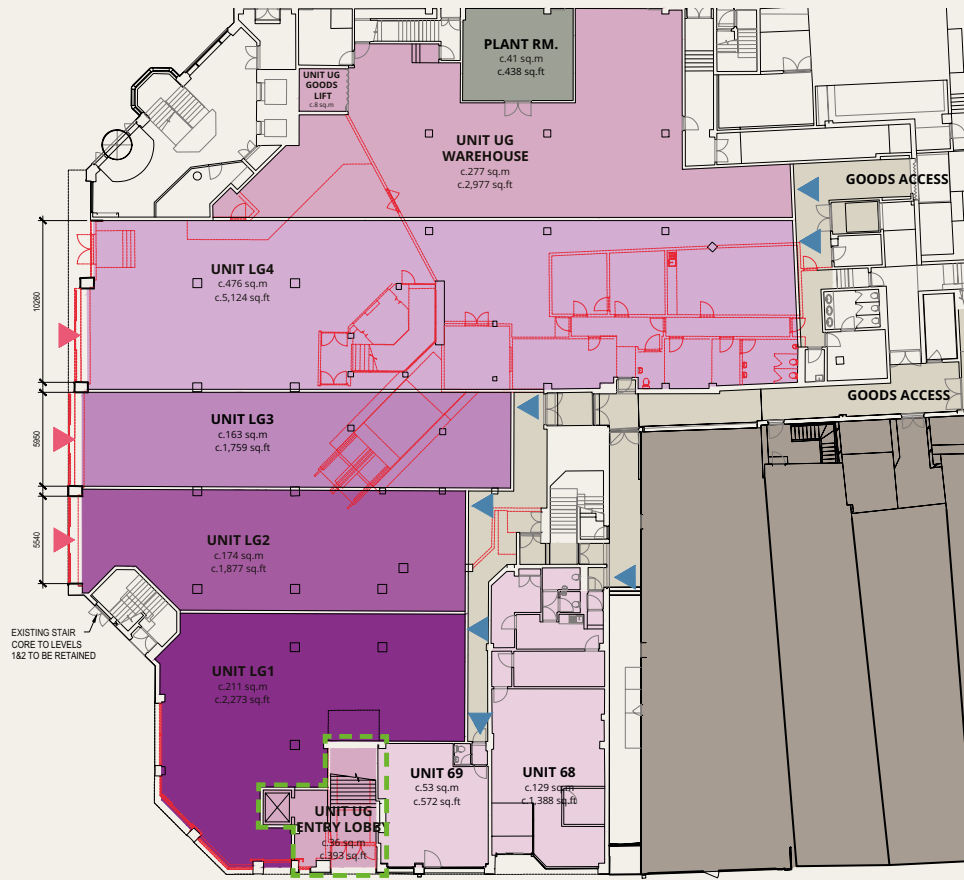

Ground Floor

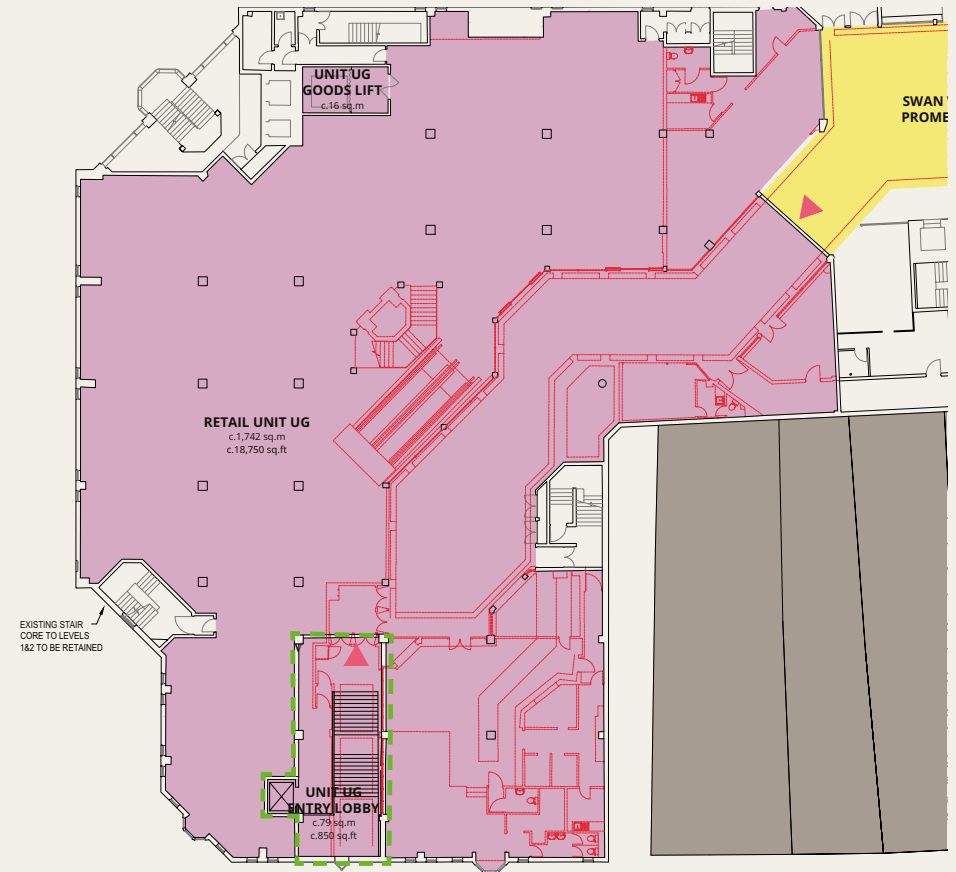

Upper Ground Floor

Lease

The subject property is available by way of a new FRI lease for a term to be agreed.

Rent

On application.

Rates

Rateable value: £191,000
UBR: £0.546
Rates payable: £104,286

Contacts

For all leasing enquiries, please contact:

CRICKMAY SURVEYORS

22 London Road, Horsham,
West Sussex RH12 1AY



JONATHAN MACK

jm@crickmay.co.uk
07557 562699

DANIEL LASCELLES

dl@crickmay.co.uk
07786 298025

SAVILLS

33 Margaret Street,
London, W1G 0JD



RETAIL:

MICHAEL LOCKHART

michael.lockhart@savills.com
07779248780

RYAN SIMPSON

ryan.simpson@savills.com
07812 686388

LEISURE:

JESSICA HILL

jessica.hill@savills.com
07976747891

MISREPRESENTATIONS ACT: Savills (UK) Ltd for themselves and for the vendors/lessors of the property whose agents they are, give notice that: 1. These particulars are set out as a general outline for the guidance of the intended purchasers or lessees, and do not constitute part of, an offer or contract; 2. All descriptions, dimensions, reference to, tenure, tenancies, condition and necessary permissions for the use and occupation, and other details are given without responsibility and any intending purchaser or tenant should not rely on them as statements or representations of fact but must satisfy themselves by inspection or otherwise as to the correctness of each of them; 3. No person in the employment of Savills (UK) Ltd has any authority to make or give any representations or warranty in relation to this property. March 2025.

IMPORTANT NOTICE: Maps are reproduced from the Ordnance Survey Map with the permission of the Controller of H.M. Stationery Office. © Crown copyright licence number 100022432 Savills (UK) Ltd, published for the purposes of identification only and although believed to be correct accuracy is not guaranteed. Savills, their clients and any joint agents give notice that: 1. They are not authorised to make or give any representations or warranties in relation to the property either here or elsewhere, either on their own behalf or on behalf of their client or otherwise. They assume no responsibility for any statement that may be made in these particulars. These particulars do not form part of any offer or contract and must not be relied upon as statements or representations of fact. 2. Any areas, measurements or distances are approximate. The text, photographs and plans are for guidance only and are not necessarily comprehensive. It should not be assumed that the property has all necessary planning, building regulation or other consents and Savills have not tested any services, equipment or facilities. Purchasers must satisfy themselves by inspection or otherwise. 105056. Designed by tccommunications.com