

TO LET GRADE A WORKSPACE

ONE

EAST PARADE • LEEDS • LS1 2AA

FIFTH FLOOR **6,254 SQ FT (581 SQ M)**

TO LET
GRADE A WORKSPACE
FIFTH FLOOR
6,254 SQ FT (581 SQ M)

ONE

EAST PARADE • LEEDS • LS1 2AA



LOCATION

One East Parade occupies a prominent position in the heart of the Central Business District with Leeds Train Station a convenient 5 minutes' walk from the building. A selection of Leeds' finest restaurants, bars and cafés are situated on the doorstep of the building.

Greek Street, home to some of Leeds' best drinking establishments, is situated adjacent and makes a perfect location for entertaining clients and staff.



SPECIFICATION

1 East Parade has undergone a refurbishment of the common areas to provide a best in class specification and environment for businesses to thrive.

The fifth floor comprises a West and East wing and is available to let as a whole.

The West Wing is finished to a Cat A standard with carpet finish & tea point and benefits from 2 separate entrances.

The East Wing benefits from a high-quality occupier fit out with Boardroom, 5 x meeting rooms, open plan office area with kitchen and break out facilities and private office / workshop / store.

The demise benefits from the following specification:



Excellent natural light



VRF Air Conditioning



Exposed Services



Raised Floors



Fibre leased line installed



LED Lighting



X5 Basement car parking spaces



Kitchenette



Cycle Storage



Building Commissionaire



DDA Compliant



Showers & Changing Facilities

ACCOMMODATION

The space plan here highlights the current layout:



33
fixed desks



3 x 10 person
meeting room



1 x 6 person
meeting room



1 x 14 person
meeting room



Touch down
workspaces



Kitchen / staff
break out area

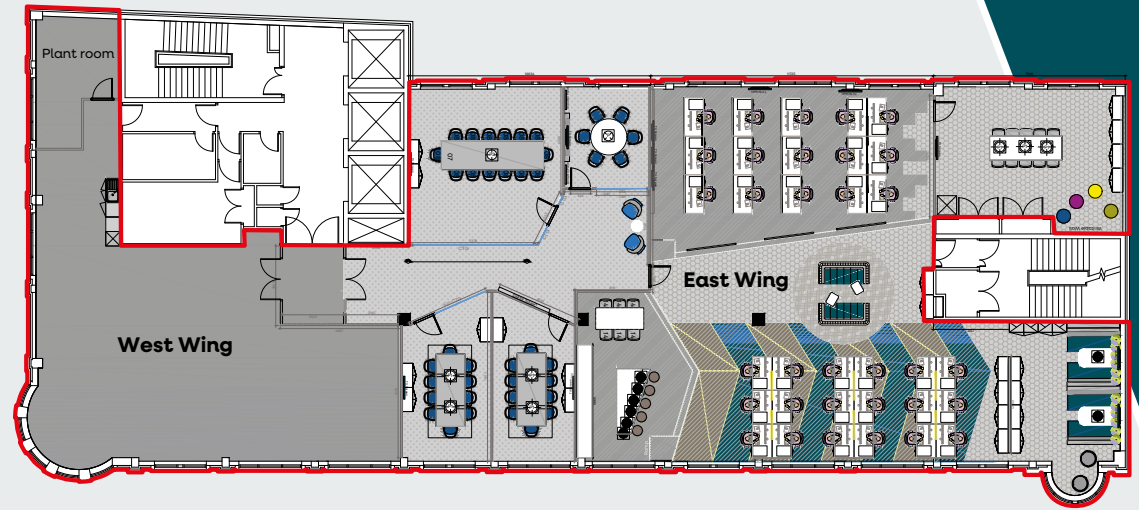

FIFTH FLOOR SPACE PLAN



ONE

EAST PARADE • LEEDS • LS1 2AA

TO LET
GRADE A WORKSPACE
FIFTH FLOOR
6,254 SQ FT (581 SQ M)

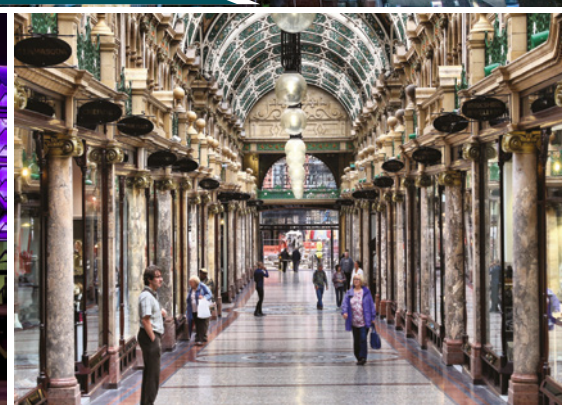
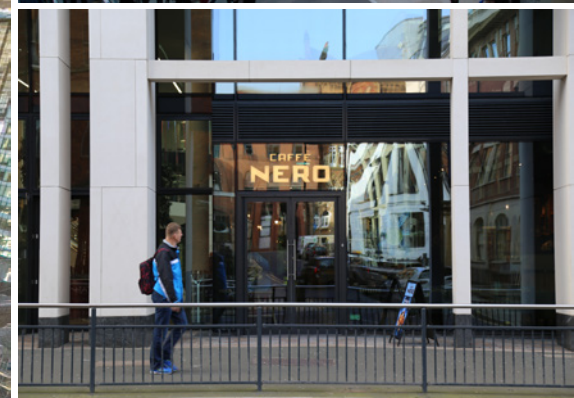



TERMS

The fifth floor is available by way of an assignment or underletting of the lease which expires on 28th May 2028.

Alternatively, a new lease directly from the Landlord may be available by negotiation, subject to contract.

RENT

Available upon request.

EPC

The property has achieved a B (37) rating. A full copy of the EPC is available on request.

RATEABLE VALUE

The property has been assessed in the 2026 rating list and has a rateable value of £165,000.

CONTACTS

Richard Dunn

M: 07801 767859

E: richard.dunn@sw.co.uk

Jay Dhesi

M: 07518 290500

E: jay.dhesi@sw.co.uk

Matthew Tootell

M: 07525 237325

E: matthew.tootell@pph-commercial.co.uk



Sanderson
Weatherall

PPH

01904 276017

pph-commercial.co.uk



ONE

EAST PARADE • LEEDS • LS1 2AA

PPH Commercial and Sanderson Weatherall for themselves and for the vendors or lessor of this property for whom they act, give notice that:- i) these particulars are a general outline only, for the guidance of prospective purchasers or tenants, and do not constitute the whole or any part of an offer or contract; ii) PPH Commercial and Sanderson Weatherall cannot guarantee the accuracy of any description, dimensions, references to condition, necessary permissions for use and occupation and other details contained herein and prospective purchasers or tenants must not rely on them as statements of fact or representations and must satisfy themselves as to their accuracy; iii) rents quoted in these particulars may be subject to VAT in addition; iv) PPH Commercial and Sanderson Weatherall will not be liable, in negligence or otherwise, for any loss arising from the use of these particulars; v) the reference to any plant, machinery, equipment, services, fixtures or fittings at the property shall not constitute a representation (unless otherwise stated) as to its state or condition or that it is capable of fulfilling its intended function. Prospective purchasers/ tenants should satisfy themselves as to the fitness of such items for their requirements; vi) no employee of PPH Commercial and Sanderson Weatherall has any authority to make or give any representation or warranty or enter into any contract whatever in relation to the property. The information contained within these particulars was last verified as at March 2026. Designed by www.thedesignexchange.co.uk