



# **Glendale** **Point**

**TO LET UNIT 3/4**  
**75,610 sq ft (7,024 sq m)**

Glendale Avenue, Sandycroft, CH5 2QP

## DESCRIPTION

The premises provide a large refurbished warehouse / manufacturing unit consisting of:



Concrete frame construction



Sub divided main warehouse facility



Concrete floor



LED lighting



Level access loading doors



Eaves height - approx 5.5m



Office accommodation which provides open plan and private accommodation



Canteen and WC facilities



Extensive secure yard area



Designated staff and visitor parking

[HOME](#)

[DESCRIPTION](#)

[LOCATION](#)

[ACCOMMODATION](#)

[FURTHER INFORMATION](#)

# LOCATION

The property is located in the town of Sandycroft situated within close proximity to Chester and approximately 1.3 miles south of Deeside.

The premises are located close to the A494 / A550 / and A5117 dual carriageway which links with the M56 approximately 7 miles to the North East and the A55 which connects the North West of England with North Wales and forms part of the outer ring road of Chester.

Focusing more specifically on the situation of the property it is located on the northern side of Glendale Avenue linking directly onto the B5129 (Chester Road).



SITUATED  
WITHIN CLOSE  
PROXIMITY TO  
CHESTER AND  
APPROXIMATELY  
1.3 MILES SOUTH  
OF DEESIDE.



# ACCOMMODATION

OFFICES / STAFF	3,666 SQ FT	(341 SQ M)
WAREHOUSE	71,944 SQ FT	(7,024 SQ M)
TOTAL	75,610 SQ FT	(7,024 SQ M)

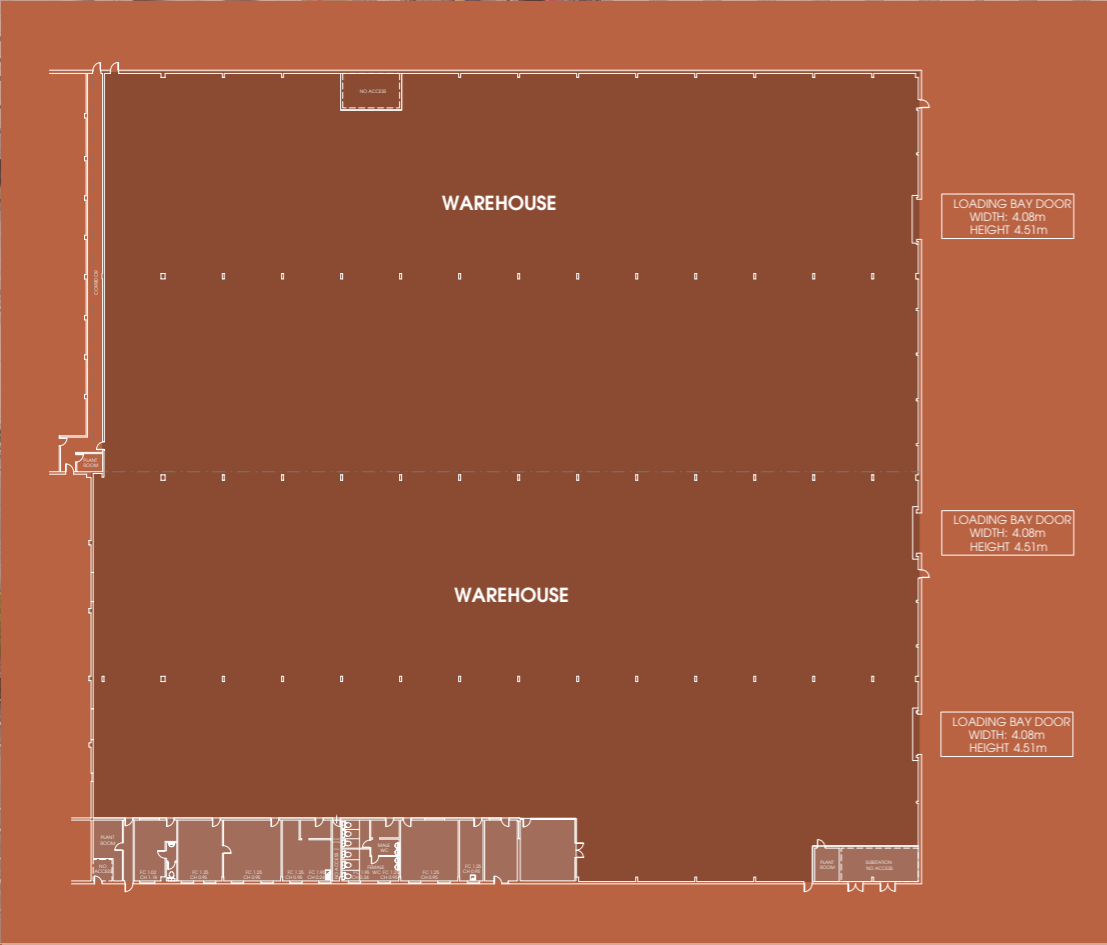

C.39 METRES



[HOME](#)

[DESCRIPTION](#)

[LOCATION](#)

[ACCOMMODATION](#)

[FURTHER INFORMATION](#)

## TERMS

The property is available to let for a term of years to be agreed.

## RENT

On application.

## EPC

The property has an EPC rating of C(56).

## RATEABLE VALUE

The property has a rateable value of £111,000.

## CODE FOR LEASE BUSINESS PREMISES

Please be aware of the RICS Code for Leasing Business Premises which is found **here**. We recommend you obtain professional advice if you are not represented.

## AML

In Accordance with Anti Money Laundering Regulations the tenant will be required to satisfy the relevant checks prior to exchange of contracts.



## VIEWING/ FURTHER INFORMATION

For further information, please contact either:

**Mark Diaper**  
07734 711 409  
markdiaper@legatowen.co.uk

**Harriet Cope**  
07548 845 167  
harriette@legatowen.co.uk

**LegatOwen**  
CHARTERED SURVEYORS  
**01244 408200**  
www.legatowen.co.uk

**Sam Royle**  
07793 808 264  
s.royle@box4realestate.co.uk

**James Goode**  
07891 810 260  
j.goode@box4realestate.co.uk

**BOX4**  
BOX4REALESTATE.CO.UK  
**0161 327 0444**

Misrepresentation Act 1967. Unfair Contract Terms Act 1977 The Property Misdescriptions Act 1991. These particulars are issued without any responsibility on the part of the agent and are not to be construed as containing any representation or fact upon which any person is entitled to rely. Neither the agent nor any person in their employ has any authority to make or give any representation or warranty whatsoever in relation to the property. July 2025. RB&Co 0161 833 0555. www.richardbarber.co.uk

[HOME](#) [DESCRIPTION](#) [LOCATION](#) [ACCOMMODATION](#) [FURTHER INFORMATION](#)