

All designs are the sole property of Knotel Inc. and may not be used, transferred, or disclosed to a third party without their express permission. No dimensions or other information should be inferred from the electronic copy unless specifically shown on the hard copy drawings or specifications. Do not scale from this drawing. Figured dimensions only are to be used For Construction and any scaling of the drawing will be at the Contractor's risk. Contractor to verify all dimensions, levels and components on-site. Any discrepancies shall be addressed in writing to Knotel Inc. for clarification prior to the commencement of the work, otherwise Contractor shall bear the full responsibility for any associated cost. Any claims for variations or extras shall be submitted to Knotel Inc. for assessment prior to approval of any such variation or extra. This drawing is to be read in conjunction with all other contract documentation.

GENERAL NOTES

LEGEND:

- DENOTES AREA OUTSIDE OF SCOPE (AREA OUTSIDE OF PROJECT SCOPE)
- DENOTES AREA OUTSIDE OF DEMISE (AREA OF LANDLORDS DEMISE)

ROOM NAME

ROOM NUMBER

REVISIONS

ID	NAME	DATE	COMMENTS
P1	GD	28.08.24	GA Design Options
P2	SM	18.09.24	Issued To Contractor
P3	SM	25.09.24	Landlord Issue.

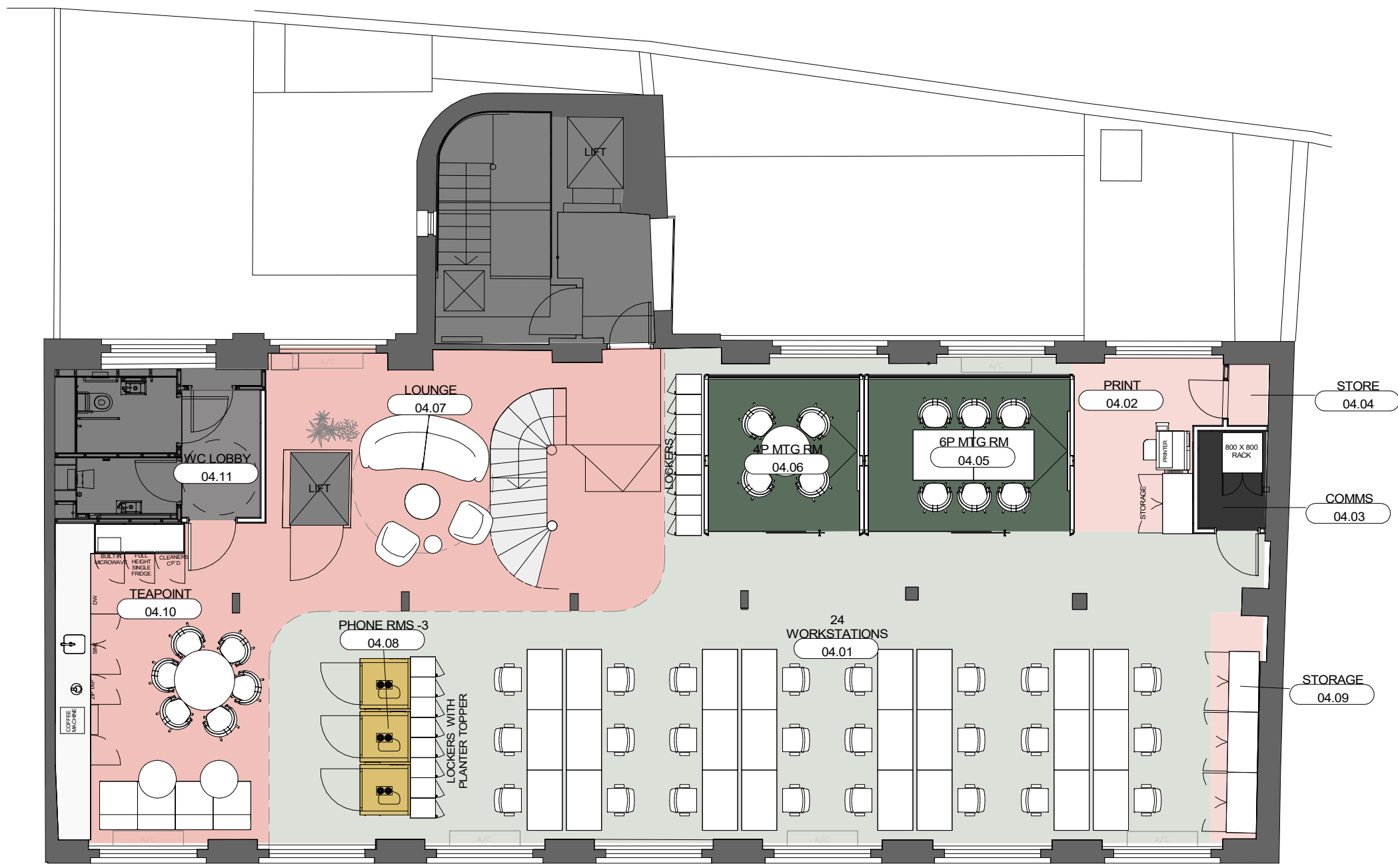

LEGEND

- Workspace
- Reception
- Meeting Room
- Communal
- Wellness
- Storage
- Circulation
- Phone Booths
- IT/ Comms
- Toilets
- Building Core

FLOORPLAN

PROPERTY ADDRESS
Weybourne
2 Pear Tree Court, London, EC1

RENTABLE SIZE 2,316 sqft	SCALE As indicated@A3
-----------------------------	--------------------------

DRAWN BY NR-MM	CHECKED BY EN-KN
-------------------	---------------------

FILE NAME
LEVEL 04 GENERAL ARRANGEMENT PLAN

KNOTEL