

TO LET

Prominent Industrial / Trade Counter Unit

UNIT C2  
**PORTFIELD  
INDUSTRIAL  
ESTATE**

NEVIL SHUTE ROAD, PORTSMOUTH  
PO3 5RX

**3,578 SQ FT**  
332 SQ M | Available Now

**HARGREAVES**  
PROPERTY INVESTMENT  
& DEVELOPMENT

[www.hargreaves.co.uk](http://www.hargreaves.co.uk)



PORTFIELD INDUSTRIAL ESTATE, **UNIT C2**  
**Nevil Shute Road, Portsmouth, PO3 5RX**

**PROPERTY  
 DETAILS**

Unit C2 is a mid-terrace unit of steel portal frame construction with a pitched roof, incorporating roof lights throughout the warehouse. The warehouse area has a clear minimum eaves height of 5.3m.

The unit is self-contained with its own WC facilities and benefits from an office / show room area with a glazed frontage, a roller shutter door with separate pedestrian access, and ample parking complemented by a convenient loading forecourt.



**PROMINENT  
 TRADE COUNTER  
 LOCATION**



**FORECOURT  
 AND LOADING**



**MIN EAVES  
 HEIGHT 5.3M**



**REFURBISHED  
 THROUGHOUT**



**NEXT DOOR  
 TO WOLSELEY  
 & JEWSON**



**GENEROUS  
 PARKING PER UNIT**



Unit C2



Unit C2

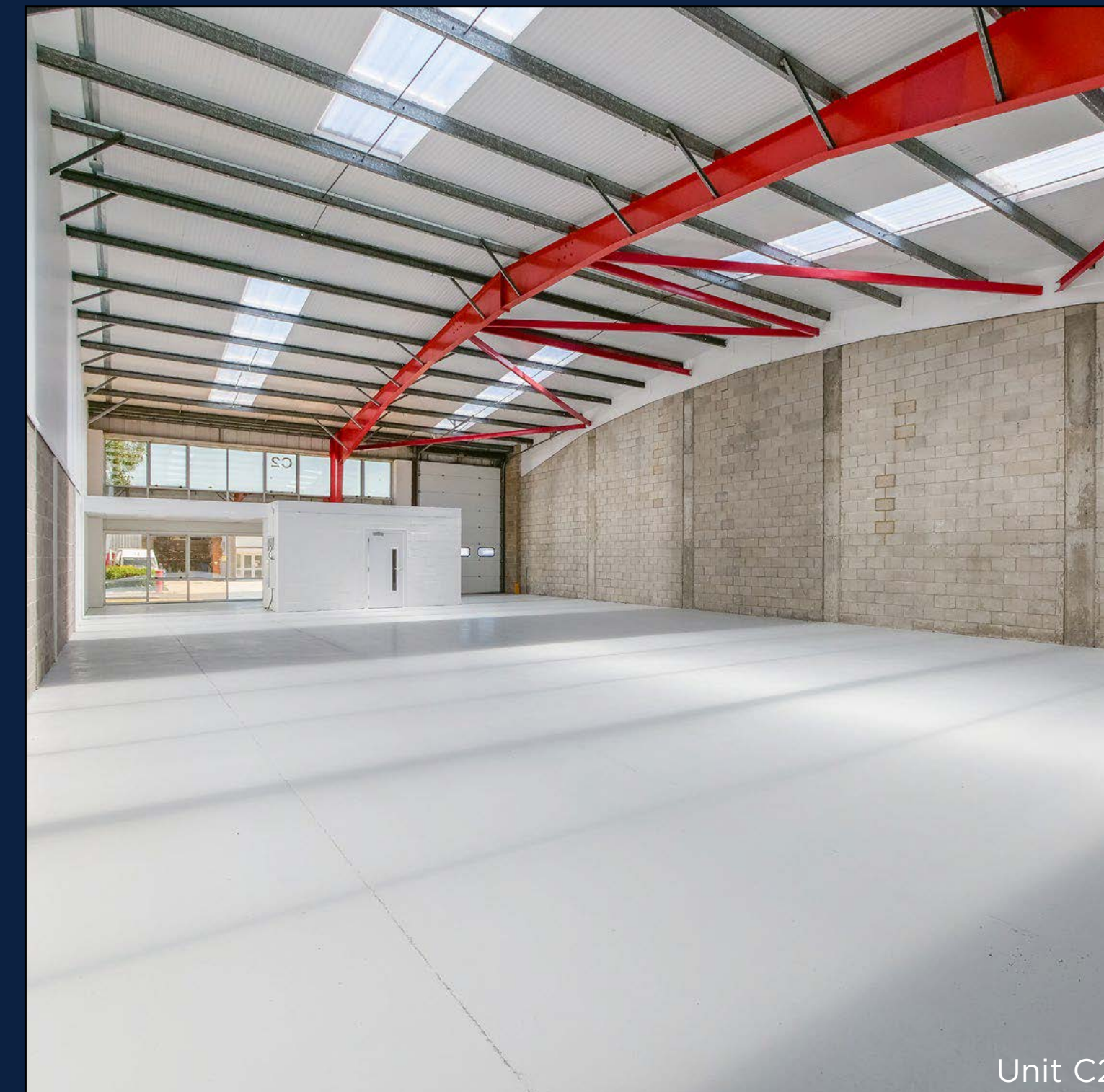

Unit C2

**ACCOMODATION**

	<b>SQ FT</b>	<b>SQ M</b>
C2 TRADE COUNTER/ WAREHOUSE	3,578	332

# PORTFIELD INDUSTRIAL ESTATE, UNIT C2

## Nevil Shute Road, Portsmouth, PO3 5RX

### PROPERTY LOCATION

Portsmouth is a major South Coast conurbation having excellent road communications to the M27 motorway providing direct access to Southampton and the M3 as well as the A27 / A3(M) providing rapid access along the South Coast to the east and via the A3(M) to London, Guildford and the M25.

#### DRIVE TIMES

	Miles	Time
PORTSMOUTH CENTRE	4	10 mins
SOUTHAMPTON	20	35 mins
BRIGHTON	47	1hr 15 mins
LONDON	72	1hr 45 mins
M27 (JUNCTION 12)	3	8 mins
M3	21	35 mins
A3	5	10 mins

SAT NAV: PO3 5RX  
[///actor.awards.glad](http://actor.awards.glad)



# PORTFIELD INDUSTRIAL ESTATE, UNIT C2

## Nevil Shute Road, Portsmouth, PO3 5RX

### FURTHER INFORMATION

**TERMS:** The property is available by way of new FRI leases for a term to be agreed. Rent on application'.

**VAT:** All prices, premiums and rents, etc are quoted exclusive of VAT at the prevailing rate.

**LEGAL COSTS:** Each party is to be responsible for their own legal costs incurred in any transaction.

**EPC:** The Energy Performance Asset Rating is as follows:  
Unit C2 - C(51)

**BUSINESS RATES:** Parties should make enquiries with Portsmouth City Council.

### AGENT DETAILS



**Alex Gauntlett**  
M: 07584 657826  
E: agauntlett@vailwilliams.com

**Russell Mogridge**  
M: 07815 737175  
E: rmogridge@vailwilliams.com



**Elise Evans**  
M: 07703 393120  
E: eevans@lsh.co.uk

**George Cook**  
M: 07596 578707  
E: gcook@lsh.co.uk



**OWNED & MANAGED BY:**



**01903 777777**

**[hargreaves.co.uk](http://hargreaves.co.uk)**

Misrepresentation Act: Hargreaves and their agents give notice that these particulars are set out as a general outline only for the guidance of intending Purchasers or Lessees and do not constitute any part of an offer or contract. Details are given without any responsibility and any intending Purchasers, Lessees or Third Party should not rely on them as statements or representations of fact, but must satisfy themselves by inspection or otherwise as to the correctness of each of them. No person in the Hargreaves or their agents has any authority to make any representation or warranty whatsoever in relation to this property. Brochure by Virtualoom.

INDUSTRIAL TRADE COUNTER UNIT TO LET | PORTFIELD UNIT C2

PORTFIELD INDUSTRIAL ESTATE, **UNIT C2**  
**Nevil Shute Road, Portsmouth, PO3 5RX**

## OUR COMMITMENT TO OUR CUSTOMERS

Hargreaves, established 60 years ago, is a family-owned property investment and development business. Our properties are concentrated along the south coast and increasingly across the wider southeast. As a long-term investor, we take pride in what we own and in our responsibilities within the communities in which we operate. We have three core principles that we uphold:

- Build long term relationships with our customers and help them achieve their goals by providing high quality real estate solutions to suit their needs.
- Deliver a best-in-class property management service from our locally based offices in Rustington.
- Execute on our commitment to our environmental and social goals to achieve better solutions for people and the local environment.

For full details please visit:

[www.hargreaves.co.uk/about-us](http://www.hargreaves.co.uk/about-us)

**HARGREAVES**  
PROPERTY INVESTMENT  
& DEVELOPMENT

Rustington House, Worthing  
Road, Rustington, West Sussex,  
BN16 3PS

01903 777777



INDUSTRIAL TRADE COUNTER UNIT TO LET | PORTFIELD UNIT C2