



**New Executive Office B:**  
Constructed to sizes indicated using 12.8mm acoustic laminated glazing set in p/ coated aluminium channels to floor, walls and ceiling (colour ref. RAL 9005) all to underside of the extg. boarded ceiling (approx. 2375 above f.f.l.).

**New Executive Office A:**  
Constructed to sizes indicated using acoustic partitioning comprising of 70mm galv. steel Gyproc Acoustuds (or other approved) at 600mm c/s with horizontal sheeting rails at 1200mm c/s and lined both sides with 12.5mm t.e. plasterboard, all to underside of extg boarded ceiling (approx 2375 above f.f.l.). Partition void to be filled with 50mm mineral wool insulation to achieve 55dB rating. Partition to be finished at base with 15mm x 100mm high mdf skirting (square edged).

UN-MARKED COMPONENT KEY:	
	Kitt Cleaning Cupboard
	3 compartment staff locker
	Extg A/C - Heating unit to be retained

DOOR SCHEDULE	
Door A	835 x 1981 x 45mm solid timber door with vertical vision panel (to match extg. Office Entrance door). Door to be fitted (to both sides) with a 600mm long vertical p/ coated alum. handle (spec. to be approved by Project Manager) in a black finish. Door to be complete with o/head self closer and black finished p/ coated aluminium lever latch set.
Door B	Glazed door at approx 800 x 2000 formed in 12.8mm acoustic laminated glazing and secured with proprietary p/ coated aluminium fixings. Door to be fitted (to both sides) with a 600mm long vertical p/ coated alum. handle (spec. to be approved by Project Manager) in a black finish. Door to be complete with o/head self closer and black finished p/ coated aluminium lever latch set.
Door C	As per Door A - seeabove
Door D	760 x 1981 x 38mm internal plywood door in s/wood frame hung to open as indicated. Door to be fitted with o/head self closer and black p/ coated aluminium lockable latch set.
<b>Doors general</b>	
<ul style="list-style-type: none"> <li>All existing doors are to be retained.</li> <li>All new doors (excluding Door B) are to be finished with a suitable primer, undercoat and 2 coats white gloss paint finish.</li> </ul>	

Drgs to be read in conjunction with this drawing (DDP).	
Survey Floor Plan	
Survey RCP	
Proposed Layout & Shopfitting Drawing	
Proposed RCP	
Proposed Small Power/Data Drawing	
Proposed Decorations Drawing	

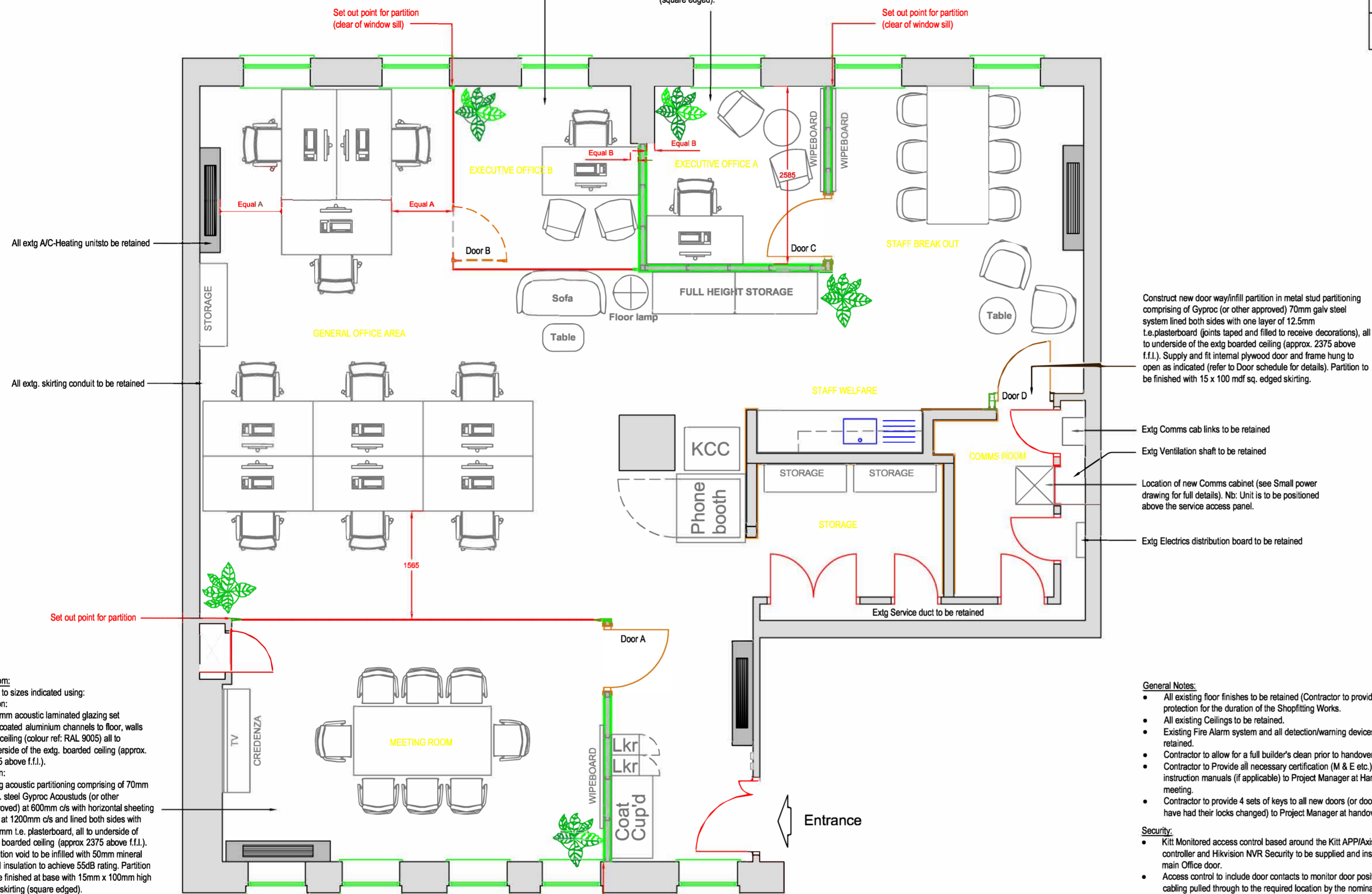

All extg A/C-Heating units to be retained

All extg. skirting conduit to be retained

**Meeting Room:**  
Constructed to sizes indicated using:  
Front partition:  
12.8mm acoustic laminated glazing set in p/ coated aluminium channels to floor, walls and ceiling (colour ref. RAL 9005) all to underside of the extg. boarded ceiling (approx. 2375 above f.f.l.).  
Side partition:  
using acoustic partitioning comprising of 70mm galv. steel Gyproc Acoustuds (or other approved) at 600mm c/s with horizontal sheeting rails at 1200mm c/s and lined both sides with 12.5mm t.e. plasterboard, all to underside of extg boarded ceiling (approx 2375 above f.f.l.). Partition void to be filled with 50mm mineral wool insulation to achieve 55dB rating. Partition to be finished at base with 15mm x 100mm high mdf skirting (square edged).

- Equipment spec for meeting room:**
- Install a 55" Commercial 4k Samsung LED TV on a flat panel wall mount.
  - Install a Logitech Meetup camera on to the TV mount kit.
  - A double switched socket outlet will be provided for TV power and brush plates for AV cable exit
  - Also required are 2no HDMI 2.0 capable cables between TV and meeting room table input plate and 1no USB 3.0 capable cable to Meetup camera.

Construct new door way/infill partition in metal stud partitioning comprising of Gyproc (or other approved) 70mm galv steel system lined both sides with one layer of 12.5mm t.e. plasterboard (joints taped and filled to receive decorations), all to underside of the extg boarded ceiling (approx. 2375 above f.f.l.). Supply and fit internal plywood door and frame hung to open as indicated (refer to Door schedule for details). Partition to be finished with 15 x 100 mdf sq. edged skirting.

- Extg Comms cab links to be retained
- Extg Ventilation shaft to be retained
- Location of new Comms cabinet (see Small power drawing for full details). N.b: Unit is to be positioned above the service access panel.
- Extg Electrics distribution board to be retained

- General Notes:**
- All existing floor finishes to be retained (Contractor to provide suitable protection for the duration of the Shopfitting Works).
  - All existing Ceilings to be retained.
  - Existing Fire Alarm system and all detection/warning devices to be retained.
  - Contractor to allow for a full builder's clean prior to handover.
  - Contractor to Provide all necessary certification (M & E etc.) and instruction manuals (if applicable) to Project Manager at Handover meeting.
  - Contractor to provide 4 sets of keys to all new doors (or doors which have had their locks changed) to Project Manager at handover meeting.
- Security:**
- Kitt Monitored access control based around the Kitt APP/Axis relay controller and Hikvision NVR Security to be supplied and installed to the main Office door.
  - Access control to include door contacts to monitor door position via cabling pulled through to the required location by the nominated Contractor.
  - Access control to further include 1no x 2.8 Hikvision 4MP dome camera and 1no x 6W 100V line surface mount speaker (cabling as above item).



REV	DATE	DESCRIPTION

Project  
LVL2, 4-6 YORK STREET  
W1U 6QD

Status  
CONSTRUCTION DRAWING

Drawing title  
PROPOSED GENERAL ARRANGEMENT

Scale	Sheet size	Drawn	Checked
1:50	A1	AC	CH

Proj no.    Dwg no.    Rev.

**DWGNO**

Do not scale from this drawing. All dimensions must be checked on site. Any discrepancies must be reported to the designer for verification prior to commencement of the affected works. This drawing is copyright.