

Notes:

1. All structural elements to be confirmed by Engineer.
2. Drawing to be read in conjunction with schedule of works/specifications.

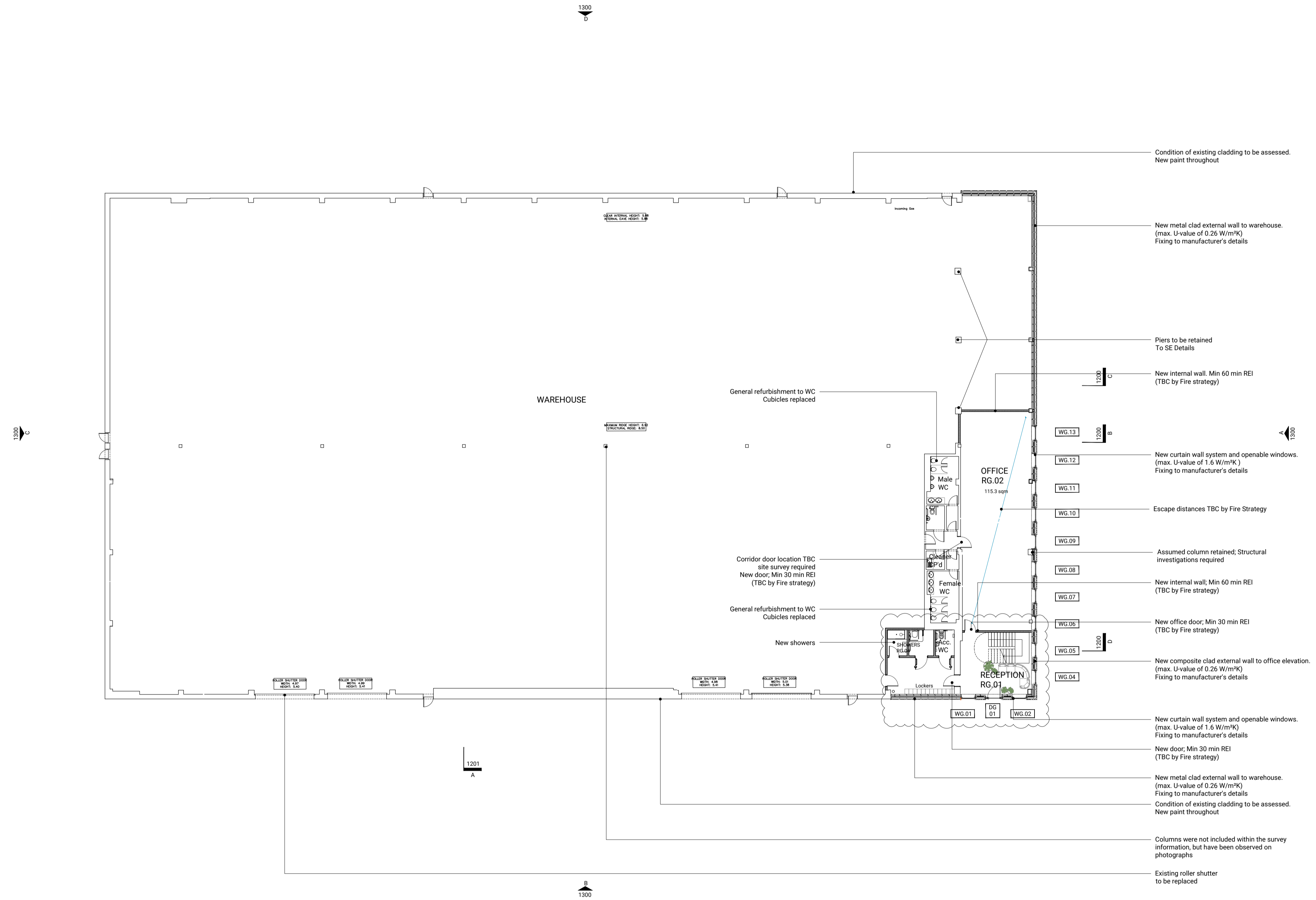

T0	29.08.25	For comment
T1	31.10.25	Stage 3 issue
T2	19.12.25	Stage 4 issue
T3	20.01.26	Section marker added
T4	30.01.26	Shower block added
T5	17.02.26	Layout amended

REV.	DATE	ISSUE
------	------	-------

552 FAIRLIE ROAD
Slough Trading Estate, SL1 4PY

Proposed Ground Floor Plan

STATUS	SIZE	REV.
Tender	A1	T5

DRAWING NO.
24453-FA-XX-00-DR-A-01100

Note/Heading:
Assumptions have been made with regard to the existing structure. These will need to be confirmed during investigative works on site.
All structure to be confirmed by a Structural Engineer.
Architectural design to Cat A only. Cat B layout shown for reference only.

