

FLOORING KEY

- Engineered Wood Flooring
Havwoods - Venture Plank - Blanco
HW3005-16 - Herringbone
600 x 120 mm
- Existing timber stairs
Sanded & restained
White oak finish
- Porcelain Tile
Florim - Casual Life
Colour - Talc
600 x 600 x 9mm thickness
- Carpet
Edge Reform Artworks
Angle Cement - 079701148
96cm x 96cm tile
- Area Rug
Rugvista - Flowie White
200 x 300cm
- WCs/Shower Microcement Topping
(applied over existing floor tiles)
Cement Plus
Nanofin 50 Velvet - Creme

FURNITURE KEY

- Bespoke Joinery
- Furniture

DECORATION

- Half Height Acoustic Wall
Panels above worktops
- Feature Painted Wall
Farrow & Ball -
Preference Red No. 297

THIS DRAWING REMAINS THE PROPERTY OF BASE INTERIORS LTD. IT MAY NOT BE COPIED OR REPRODUCED WITHOUT EXPRESS WRITTEN CONSENT. FIGURED DIMENSIONS SHOULD BE USED WHERE GIVEN. DO NOT SCALE.

GENERAL NOTES
Total Area: sqft - 2925 sq ft

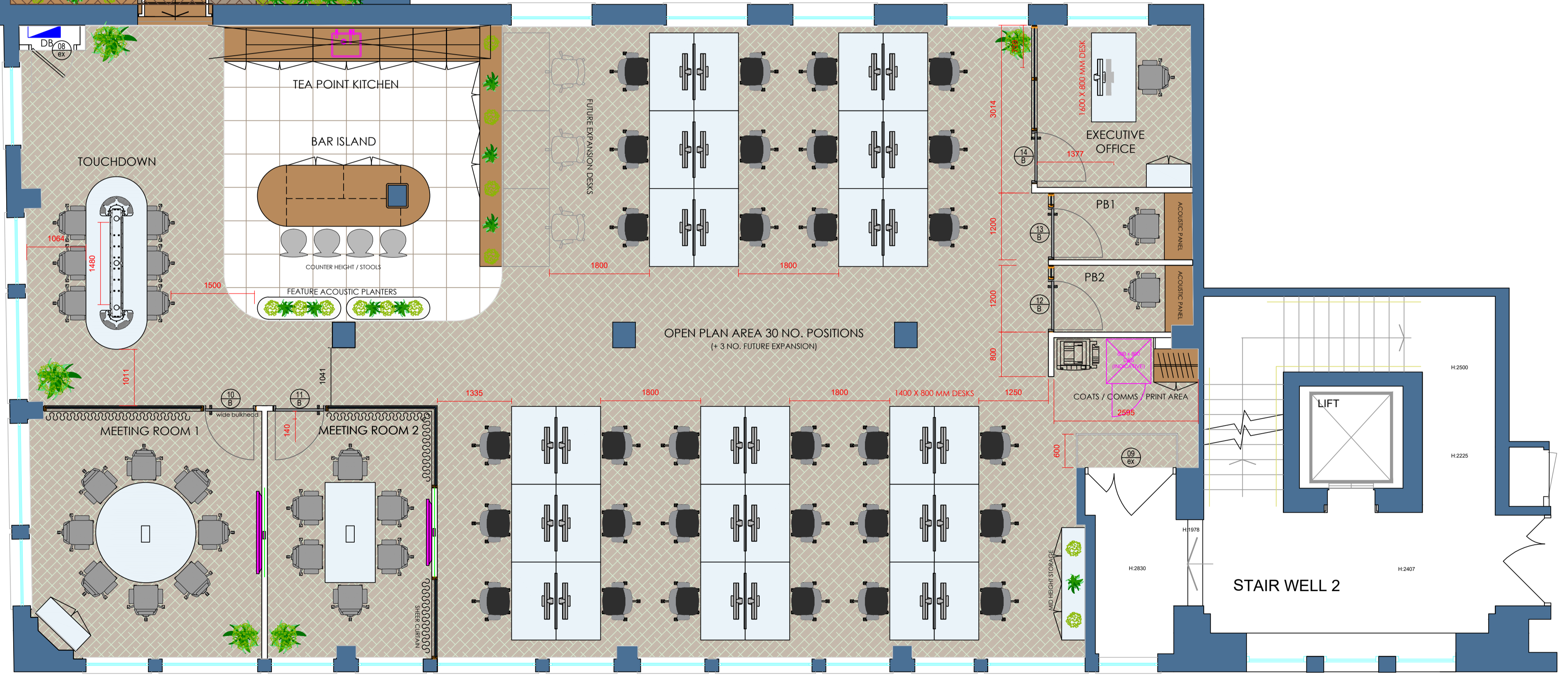

PROPOSED THIRD FLOOR GENERAL LAYOUT

A	Herringbone floor setout	22.04.24
REV	DESCRIPTION	DATE
ESTATES & AGENCY		
CLIENT		
30-32 Whitfield Street		
London W1T 2RG		
SITE ADDRESS		
Proposed third floor layout		
DRAWING TITLE		
EAW 629	3 001	A
PROJECT NO.	DRAWING NO.	REV.
1:100 - A3	General	
1:50 - A1	DESCRIPTION	
SCALE		
LB	21-10-25	
DRAWN	DATE	
T. 020 7487 3222		
F. 020 7487 3555		
BASEINTERIORS		
BASE		
15 BERKELEY MEWS LONDON W1H 7AX		