

# BEASLEY COURT - FIRST FLOOR

BEASLEY COURT - FIRST FLOOR - 3005 SQF	
Meet & Greet	1
4 person meeting room	1
9 person meeting room	1
Desks (1400x800)	28
Phone Booth	1
Lockers (3 high)	30
Informal Meeting	2
Project Area	1
Collaboration Area	2
Teapoint & Breakout	1
Printing Station	1

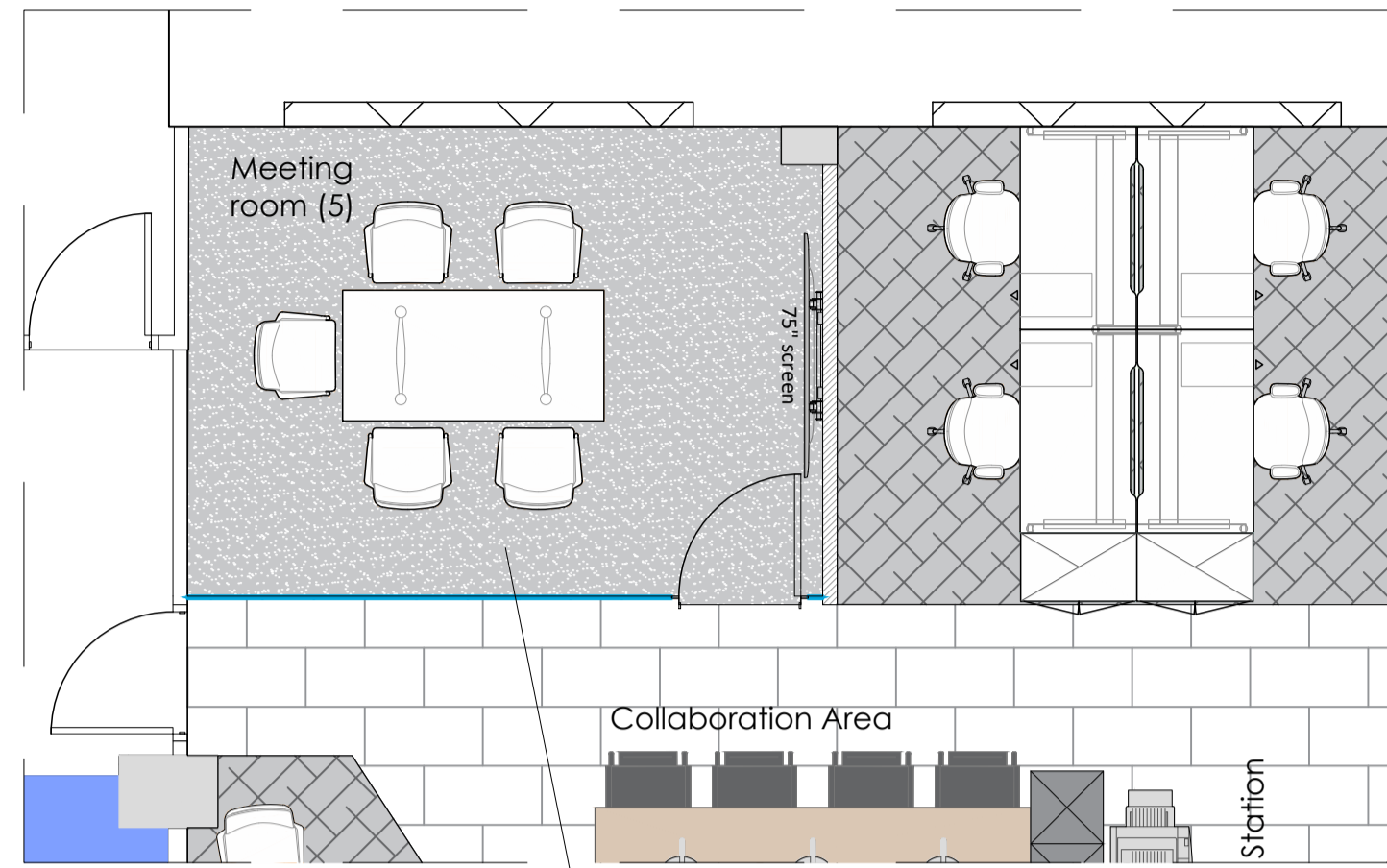

ALTERNATIVE LAYOUT - 6 PERSON MEETING ROOM  
SCALE 1:50@A1

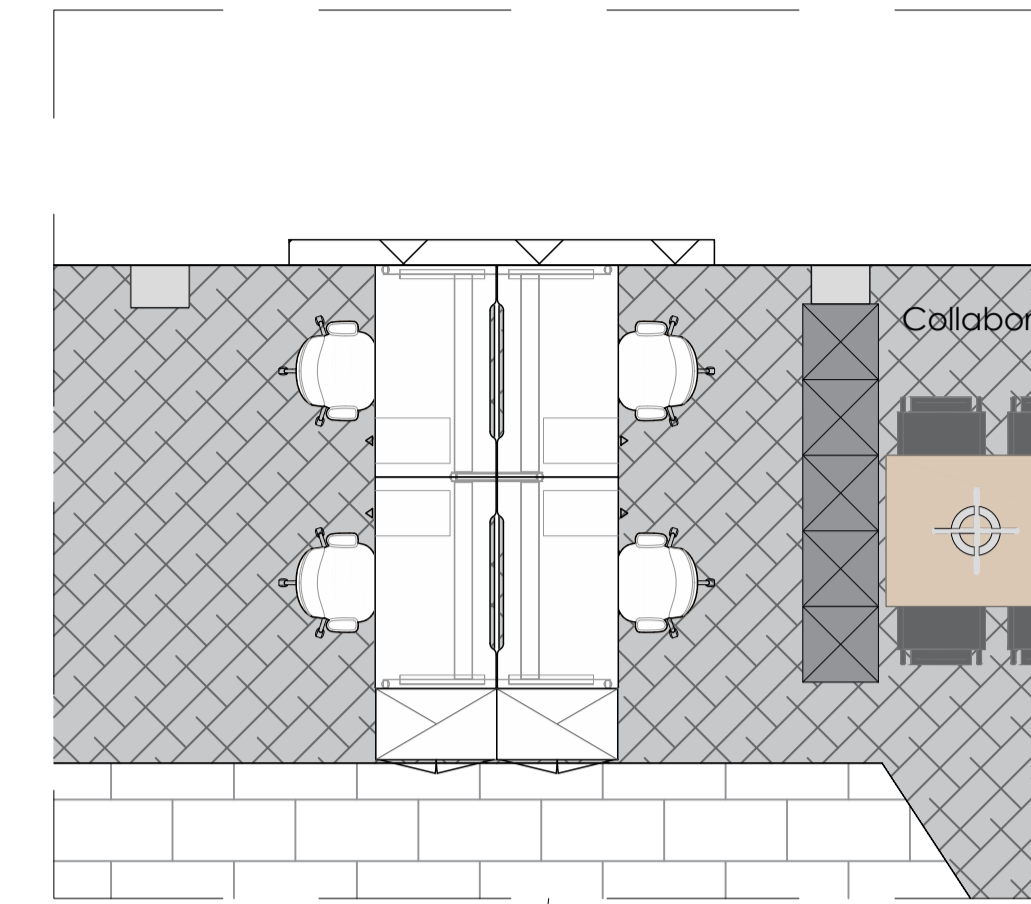

FUTURE EXPANSION OF 4 No. DESKS  
SCALE 1:50@A1



## GENERAL ARRANGEMENT

This drawing is copyright of Curve Workplaces Limited & must not be copied or reproduced in any way without written permission.

Do not scale! If in doubt ask.

DATE: SIGNATURE:

Client sign-off:

Rev	Date	Description
P2	25/07/22	Added meet and greet area
P1	30/06/22	First issue

Revisions:

www.curveworkplaces.co.uk

The Lightbox  
Willoughby Road  
Bracknell  
RG12 8FB

Client:  
BEASLEY COURT  
WARWICK PI  
UXBRIDGE  
UB8 1PE

Drawing title:  
FIRST FLOOR  
GENERAL ARRANGEMENT

Drawn: SH Checked: RM  
Scale: A1 @ 1:75 Date: 30.06.22

Drawing Number:  
JOB NUMBER FLOOR TYPE REVISION  
1689 - 01 - GA P2

FOR INFORMATION