

Checked + Amended B-1
 Engineering Manager
 Damiano Maccanese 10/12/24
 Review Date 10/12/25

- The Drawing and Design are Copyright and may not be reproduced without the written consent of Derrick, Wade & Waters.
- Do Not Scale - Use Figured Dimensions Only.
- The Contractor is to check and verify all Figured Dimensions, Size and Drains/Lines, prior to commencement of work and notify Derrick, Wade & Waters of any discrepancies.
- The Contractor is to check the Drawing against all other relevant drawings, specifications and/or bills of quantities as issued.
- IF IN DOUBT - ASK.
- This preliminary scheme is prepared on the basis of limited information, and is subject to site survey, structural survey, local authority planning requirements and the detailed requirements of local authorities and statutory bodies.

S - Sun
 E - East
 (H) - Horse River
 (F) - Falconer Footpath

SCHEDULE OF AREAS (GROSS EXTERNAL)

	SQ METRES	SQ FEET
OFFICES		
EXISTING	451	4855
PROPOSED	301	3240
TOTAL	752	8095
FACTORY		
EXISTING	1155	12432
PROPOSED	958	10356
TOTAL	2113	22788
GRAND TOTAL	2865	30883

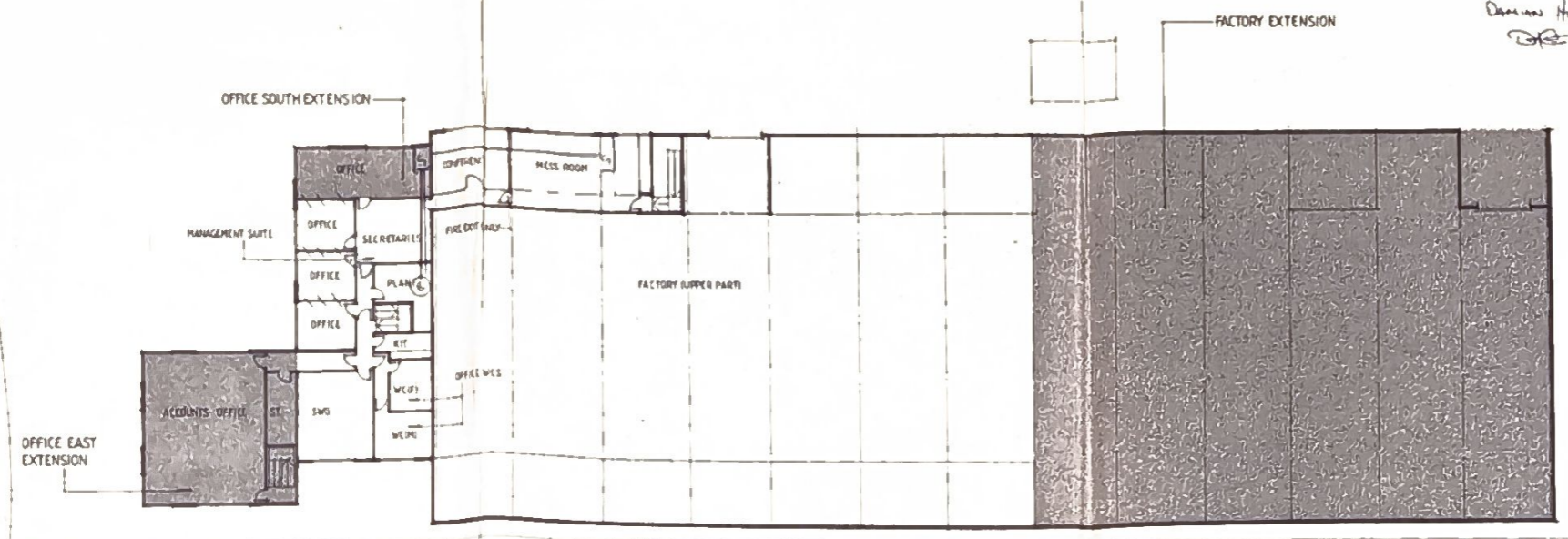

FIRST FLOOR

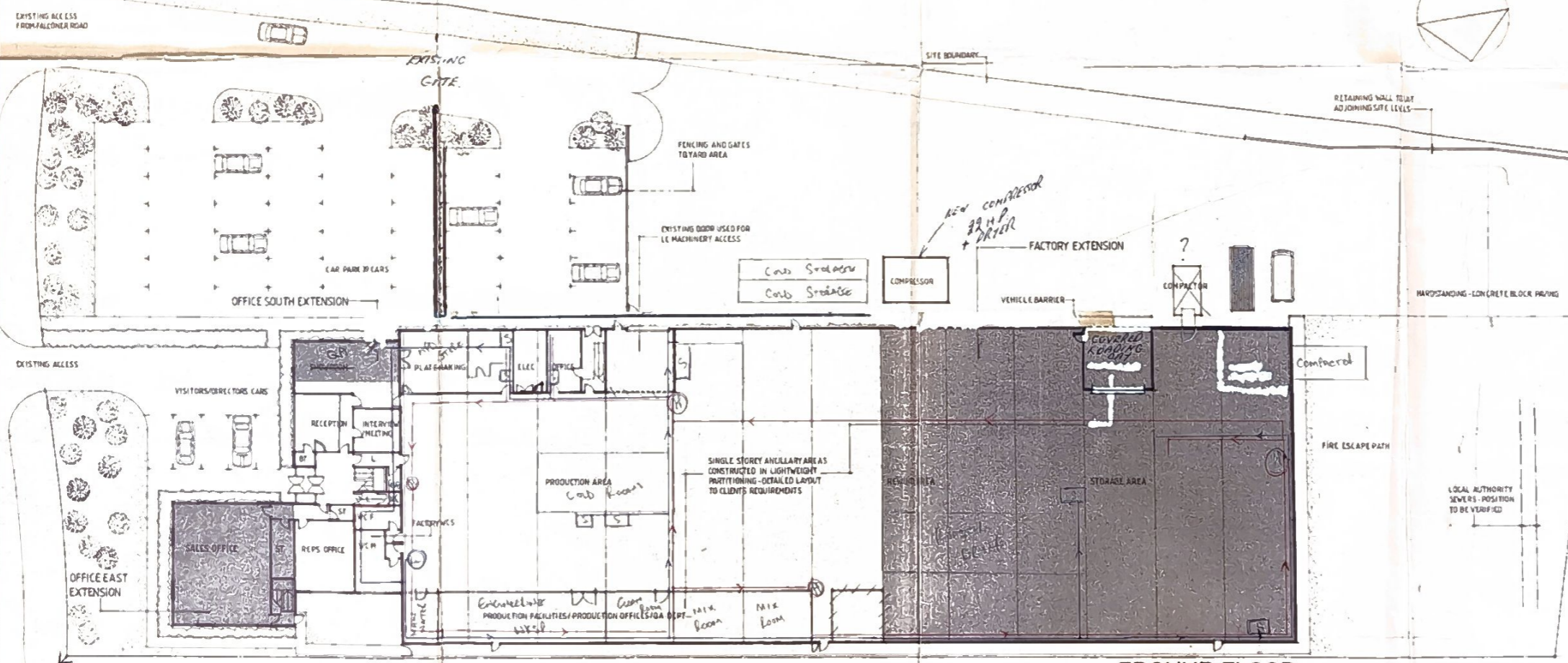

GROUND FLOOR

LABEL CONVERTERS LTD
 FALCONER ROAD HAVERHILL
 PHASE II

GROUND FLOOR PLAN
 FIRST FLOOR PLAN

SCALE 1:500

LONDON 01-487-5791
 PRESTON 0772-323668
 HARLOW 0279-725048 CA

DERRICK WADE & WATERS
 ARCHITECTURE
 STRUCTURAL ENGINEERING
 CIVIL & STRUCTURAL ENGINEERING
 15 WOODSIDE SQUARE LONDON E14 3UG
 High Wycombe HARLOW Essex CM17 9NQ
 01462 450000 01462 450000
 01462 450000 01462 450000

SCALE 1:500
 DATE 12/86
 DRAWING NUMBER H18632/01