

Unit 5

Kites Croft

9,588 sq ft
(890.7 sq m)

Detached Industrial / Warehouse Unit
in close proximity to M27 (J9)

- **8m Eaves Height**
- **150 kVA power**
- **Office space**
- **Secure yard**



Warsash Road, Fareham, PO14 4LW



Key Features

Warehouse

- 8m eaves height
- 7m haunch height
- Floor loading 35kn/m²
- 150 kVA power supply
- LED lighting
- Clear span warehouse
- 2x 5.4 x 5.0m electric up and over doors
- B1(c), B2 and B8 use
- 10% day light panels

Office

- Suspended ceiling with LED lighting
- Office areas fully carpeted
- Kitchen area
- VRF air conditioning
- Ground & first floor WC's & ground floor accessible WC
- Glazed entrance lobby
- 8 person passenger lift

External

- Front car park with 14 spaces
- Secure concrete yard
- 25m yard depth



Location

SAT NAV: **PO14 4LW** what3words.com/dustbin.pinch.witty

The unit is strategically located between Southampton and Portsmouth at junction 9 off the M27. It provides excellent motorway access and a unique opportunity to an occupier who requires a modern building with 10% office content, clear span warehouse and large secure yard.



M27 (J9)

Unit 5

National Maritime Operations Centre



A27

Under Offer



Waitrose



Description

Unit 5 is a traditional steel portal frame building clad with insulated profile metal sheet to the elevations and roof. The roof is interspersed with approximately 10% roof lights. The external elevations of the building are a mix of profile metal sheet and full height glazing.

Externally the unit benefits from a tarmac car park in front of the offices and a secure concrete yard to the side of the unit which is triangular in shape. Access to the unit is via 2 ground level electric up and over doors.

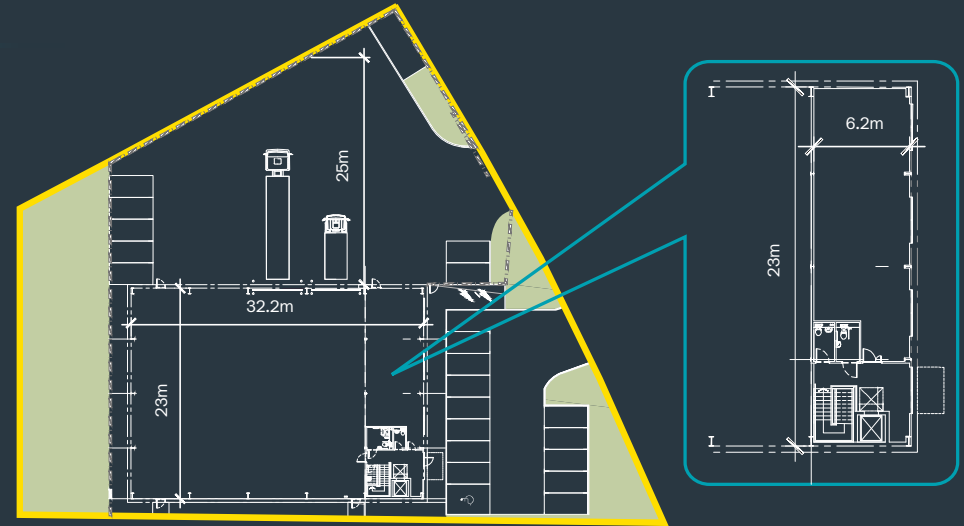

Accommodation (GIA)

Unit 5	SQ FT	SQ M
Warehouse & ancillary areas	8,025	745.5
First Floor Offices	1,563	145.2
Total	9,588	890.7

Terms

The premises are available by way of a new Full Repairing and Insuring lease for a term to be agreed.

Rent

On application.

Rates

We understand from the Valuation Office website, that the current 2026 Rateable Value is £144,000.

Legal Costs

Each party to be responsible for their own legal costs incurred in this transaction.

EPC

The current EPC is C-59.

**Lambert
Smith
Hampton**

01489 579579
www.lsh.co.uk

**HELLIER
LANGSTON**

02382 022111

hlp.co.uk

Elise Evans
t. 07703 393 120
e. eevans@lsh.co.uk

Dan Rawlings
t. 07702 809 192
e. drawlings@lsh.co.uk

Matt Poplett
t. 07971 824 525
e. matt@hlp.co.uk

Jason Webb
t. 07989 959 064
e. jason@hlp.co.uk

Lambert Smith Hampton and Hellier Langston for themselves and for the vendors or lessors of this property whose agents they are give notice that (i) the particulars are set out as a general outline only for the guidance of intended purchasers or lessees, and do not constitute part of an offer or contract; (ii) all descriptions, dimensions, reference to condition and necessary permissions for use and occupation, and other details are given without responsibility and any intending purchasers or tenants should not rely on them as statements or representations of fact but must satisfy themselves by extension or otherwise as to the correctness of each of them; (iii) no person in the employment of Lambert Smith Hampton and Hellier Langston has any authority to make or give any representation or warranty whatever in relation to this property, APRIL 2026. Designed by threesixtygroup