

**Project Name**  
**DAMAC Tower**  
**Nine Elms**  
**London**  
 69-71 Bondway  
 London, UK

**Employer**  
 Nine Elms Property Limited

**Contractor**  
 Multiplex Construction Europe Limited

**Architect**  
 Kohn Pedersen Fox Associates  
 Architects & Planning Consultants  
 7a Langley Street, Covent Garden  
 London, WC2H 9JA  
 Tel: +44 (0) 203 119 5300 Fax: 020 7497 1175

--- SITE BOUNDARY

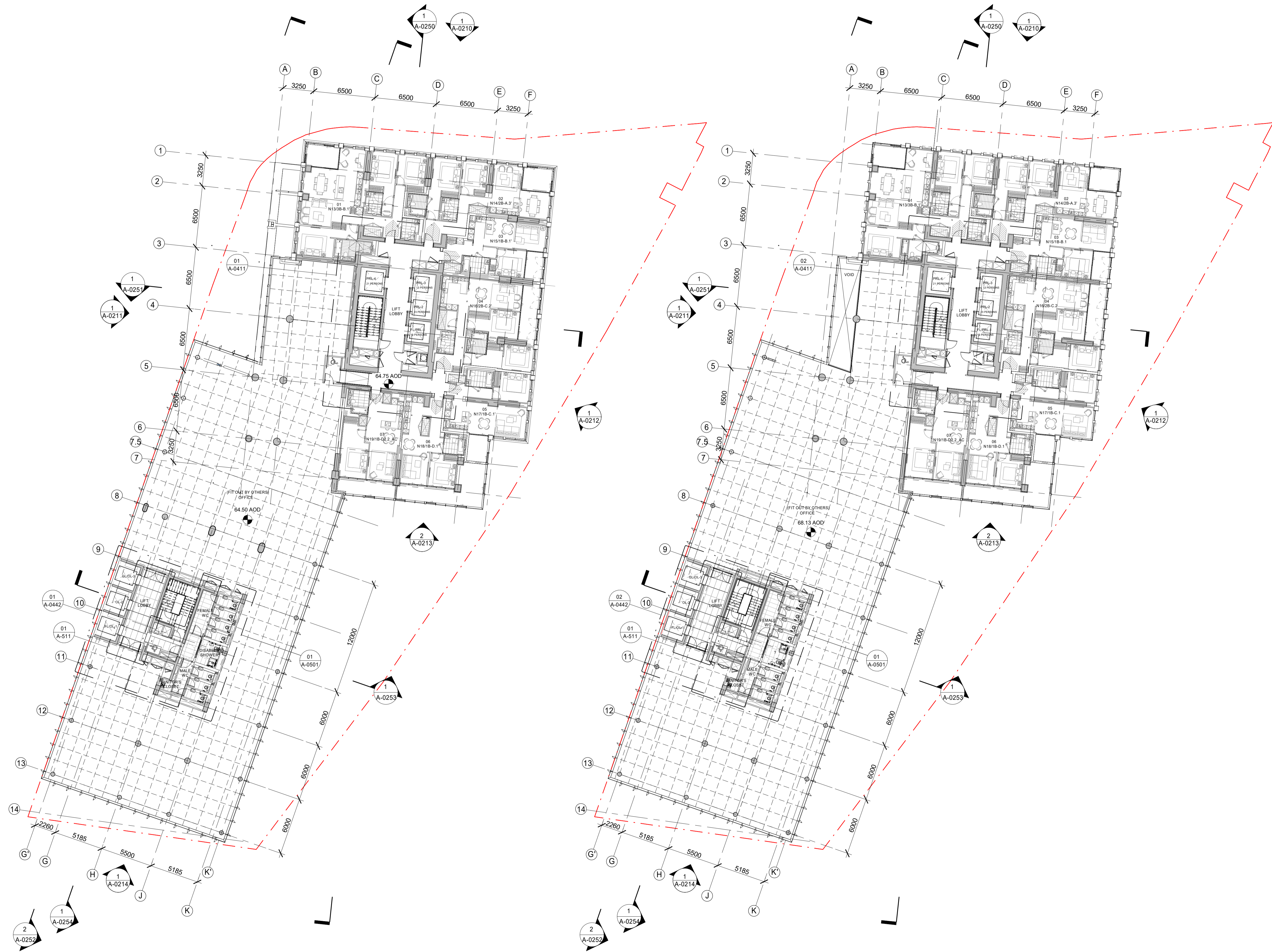

RE1	Record Information	19.10.2021
No.	Issue	Date

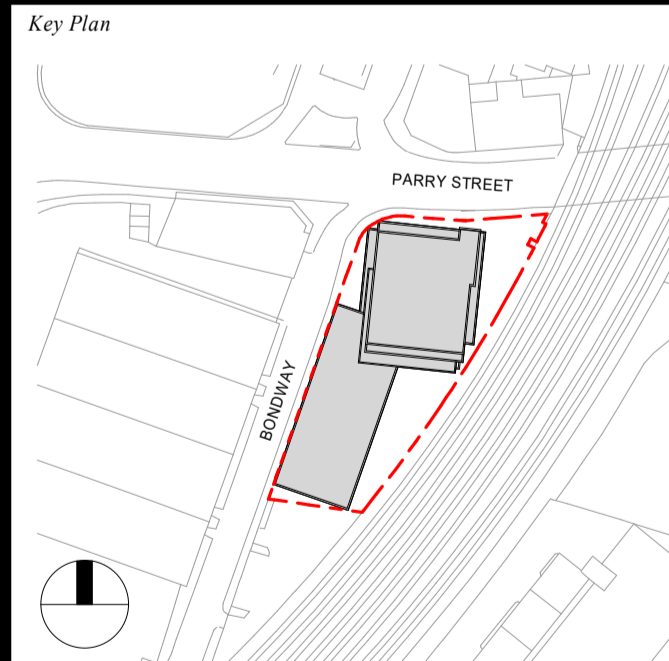

Date  
 03.02.2014  
 Scale  
 As indicated @ A1  
 Project No.  
 2215  
 Drawn by  
 NY

**LEVEL 18/19 NORTH TOWER - 19/20 SOUTH BUILDING**

No. \_\_\_\_\_ Rev. \_\_\_\_\_  
**ALO-KPF-20-ML-PL-A-0111 RE1**

**1** LEVEL 18 NORTH TOWER (+64.75m AOD) - LEVEL 19 SOUTH BUILDING (+64.50m AOD)  
 SCALE: 1: 200

**2** LEVEL 19 NORTH TOWER - LEVEL 20 SOUTH BUILDING (VARIES)  
 SCALE: 1: 200

J:\2215\_VauxhallBondway\Drawings\BIM\Arch\2215\_ARCH1\_KPF\_MAIN-GA\_Record\format\6140\2021\_10.17.37