



HEALTHCARE / RETAIL TO LET

12-13 THE WATERFRONT

Brighton Marina Village, Brighton, BN2 5WA

FORMER HEALTH SPA UNIT TO LET

2,820 SQ FT

Eightfold
property

Tel: 01273 672 999

Website: www.eightfold.agency

Summary

Available Size	2,820 sq ft
Rent	£28,200 per annum Exclusive of rates, VAT & all other outgoings
Rates Payable	£12,350.25 per annum To be assessed.
Rateable Value	£24,750
Service Charge	The estimated service charge budget for the year ending December 2023 is £29,022.82 for this unit
Car Parking	Free parking is currently available on site
VAT	Applicable
Legal Fees	Each party to bear their own costs
Estate Charge	N/A
EPC Rating	D (77)

Accommodation

The accommodation comprises of the following

Name	sq ft	sq m
Ground	2,820	261.99
Total	2,820	261.99

Description

An impressive unit situated on the ground floor level of the Waterfront Scheme at Brighton Marina. The unit in recent years has been used as a health spa but could be suitable for a variety of uses subject to planning. there is the ability to create a large predominately open plan space that could be suitable for variety of leisure or alternative uses.

Location

The property is situated in a recessed location close to the entrance of Mal Maison Hotel. Brighton Marina is a mixed use complex located approximately 1 mile to the east of Brighton City Centre with a variety of leisure facilities which include David Lloyd Gym, Casino, an 8 screen Cineworld Multiplex cinema, 23 lane Hollywood Bowl bowling alley and Mal Maison 71 bedroom boutique Hotel. A 1,500 space multi-storey car park helps accommodate an annual car count of approximately 3.5 million to the marina. In addition there is also a variety of shops and restaurants in the marina which include Vroom, Globalbs, a serviced office operator, Asda, Pizza Express, Café Rouge, McDonalds, Nandos and Five Guys. The Marina also has a variety of dwellings and 1,600 boat berths.

Terms

Available on a new effective full repairing and insuring lease by way of service charge for a minimum term to be agreed.

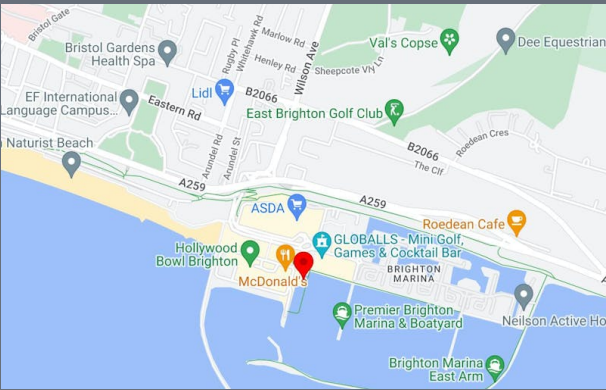

Get in touch

Max Pollock

01273 672999 | 07764 794936
max@eightfold.agency

James Hawley

01273 672999 | 07935 901 877
james@eightfold.agency

Alex Gardner

01273 672999 | 07511 017289
alex@eightfold.agency

Eightfold Property

The above information contained within this email is sent subject to contract. These particulars are for general information only and do not constitute any part of an offer or contract. All statements contained therein are made without responsibility on the part of the vendors or lessors and are not to be relied upon as statement or representation of fact. Intending purchasers or lessees must satisfy themselves, by inspection, or otherwise, as to the correctness of each of the statements of dimensions contained in these particulars. Generated on 03/12/2025



Energy performance certificate (EPC)

12-13 WATERFRONT BRIGHTON MARINA BRIGHTON BN2 5WA	Energy rating D	Valid until: 9 June 2031 Certificate number: 0009-4239-2002-0296-2506
--	---------------------------	--

Property type

A1/A2 Retail and Financial/Professional services

Total floor area

259 square metres

Rules on letting this property

Properties can be let if they have an energy rating from A+ to E.

Energy rating and score

This property's current energy rating is D.

Properties get a rating from A+ (best) to G (worst) and a score.

The better the rating and score, the lower your property's carbon emissions are likely to be.

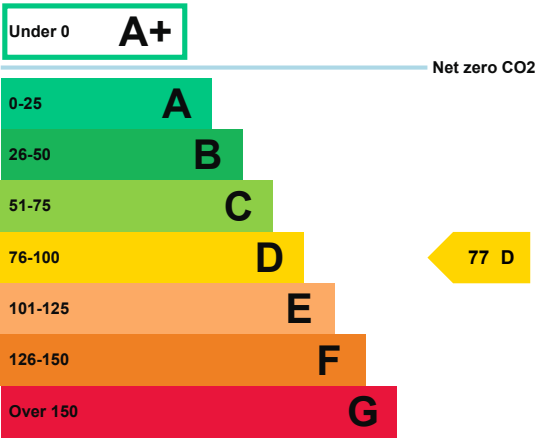

How this property compares to others

Properties similar to this one could have ratings:

If newly built	25 A
If typical of the existing stock	73 C

Breakdown of this property’s energy performance

Main heating fuel	Natural Gas
Building environment	Heating and Natural Ventilation
Assessment level	3
Building emission rate (kgCO2/m2 per year)	111.85
Primary energy use (kWh/m2 per year)	659

Recommendation report

Guidance on improving the energy performance of this property can be found in the [recommendation report \(/energy-certificate/0960-0202-4409-2029-2500\)](#).

Who to contact about this certificate

Contacting the assessor

If you're unhappy about your property's energy assessment or certificate, you can complain to the assessor who created it.

Assessor's name	Damian Williamson
Telephone	0345 111 7700
Email	info@vitaldirect.co.uk

Contacting the accreditation scheme

If you're still unhappy after contacting the assessor, you should contact the assessor's accreditation scheme.

Accreditation scheme	Quidos Limited
Assessor's ID	QUID207806
Telephone	01225 667 570
Email	info@quidos.co.uk

About this assessment

Employer	Vital Direct Ltd
Employer address	Grenville Court, Britwell Road, Burnham, Slough, SL1 8DF
Assessor's declaration	The assessor is not related to the owner of the property.
Date of assessment	10 June 2021
Date of certificate	10 June 2021

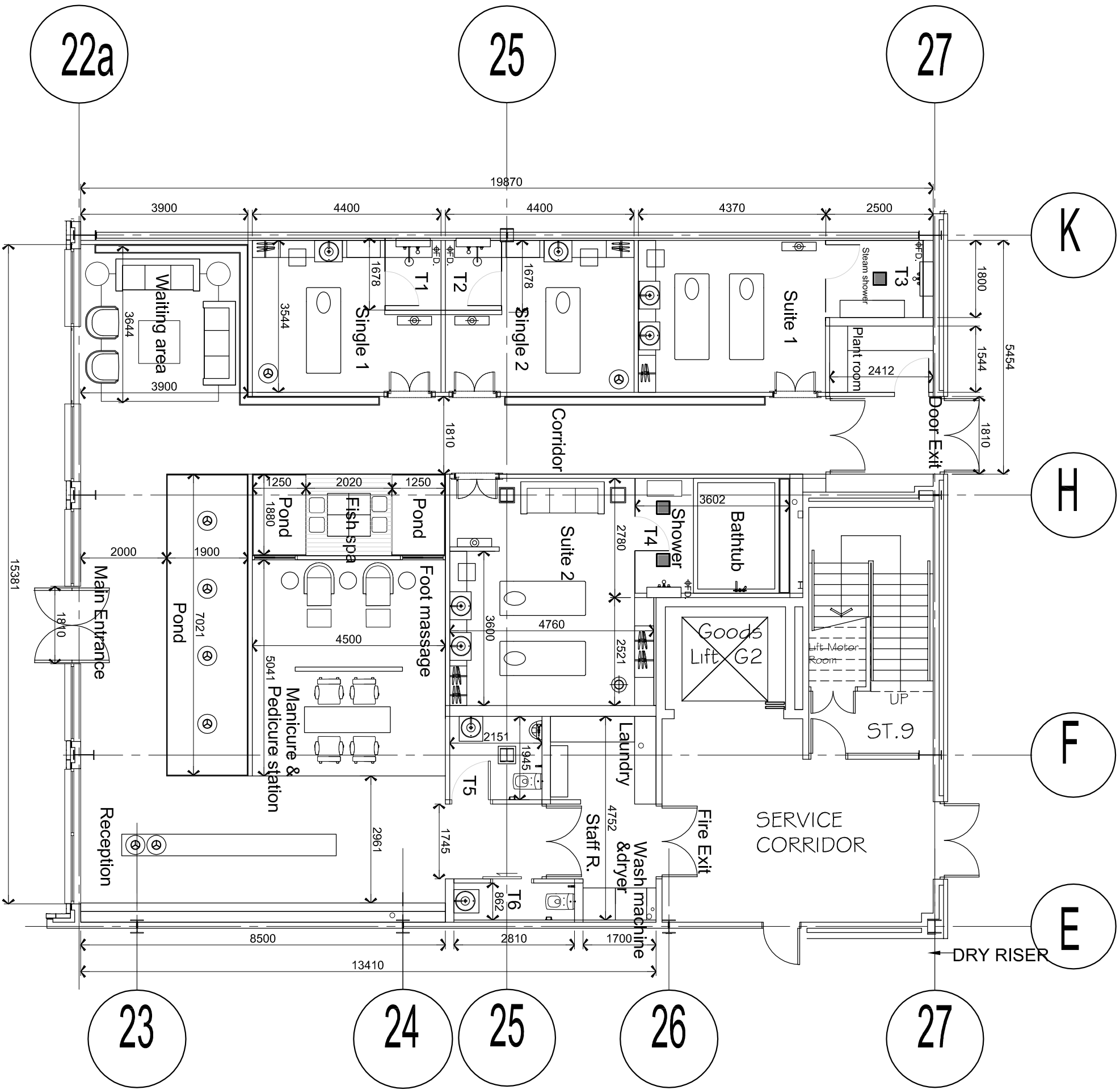

Contractor to verify all dimensions on site before commencing work.
Figured dimensions given are to be taken in preference to scaling.
Copyright of designs shown herein is retained by this office.
Authority is required for any reproduction.

Project
SPA TARA
Brighton Marina, Brighton
England
Owner
Ms. Laochariyakul

Date
11-10-10 A For Approval

Project No. : UK_SPA TARA
Scale : A3 = 1 : 100
Drawn by :
Checked : Tanya Rajawat
Plot Date :
Cad File : IN 103

Sheet title
Furniture layout

IN - 103

12-13 Waterfront, Brighton Marina Village, Brighton, BN2

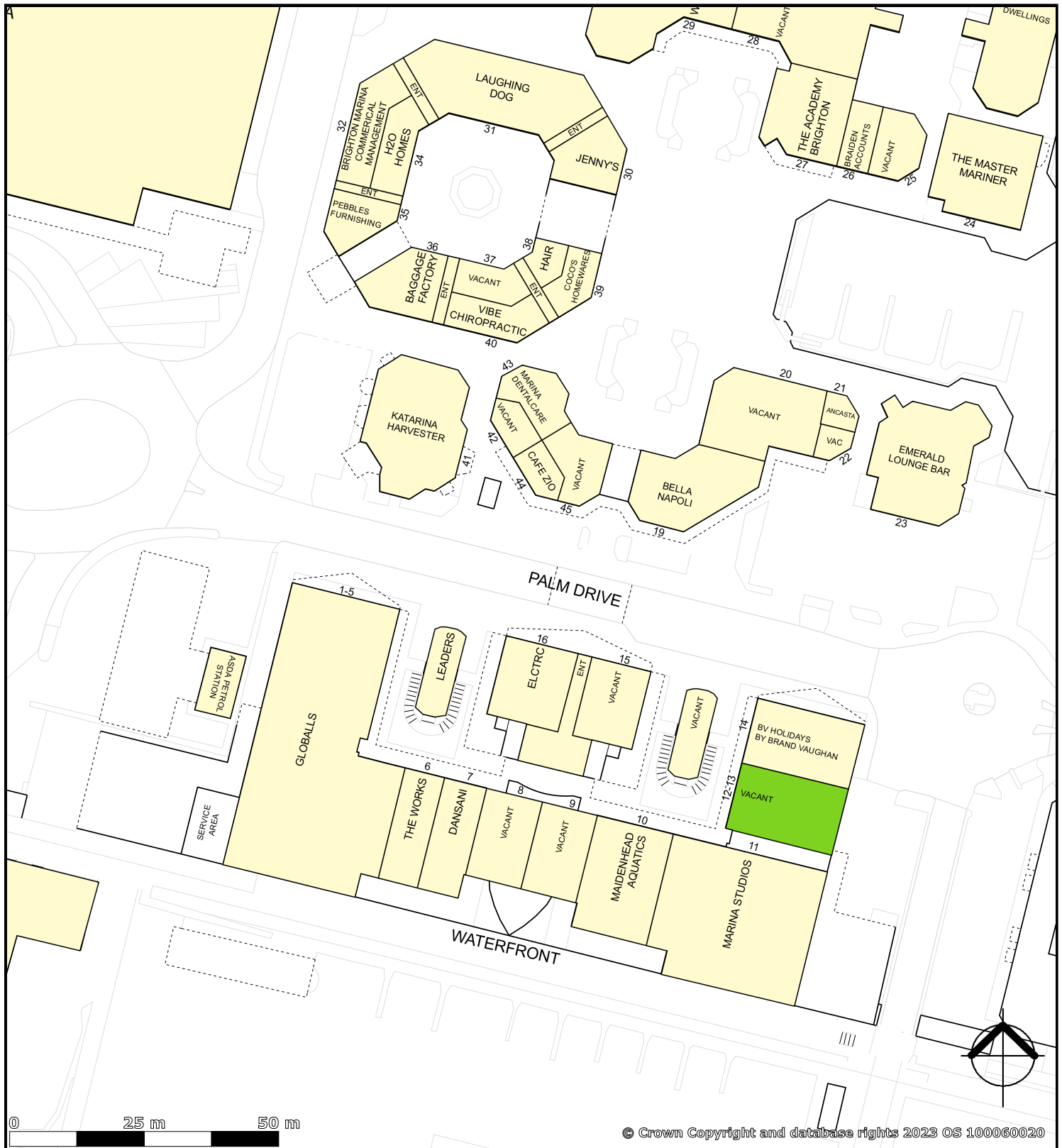

© Crown Copyright and database rights 2023 OS 100060020