

No.2

LONDON

BRIDGE

LANDMARK BUILDING

No.2 London Bridge occupies an island site bounded by London Bridge to the east, the River Thames to the north and Montague Close to the south. It is perfectly positioned between The City and all the Southbank has to offer.



STYLISH REDESIGNED RECEPTION



OFFICE SPACE



FULLY FITTED & FURNISHED OFFICES

The part 4th floor East provides fitted offices that have been redecorated and re-carpeted, with metal tiled ceilings and newly refurbished WC's. The office suite benefits from natural light on all elevations and is ready for immediate occupation.



MEETING ROOM



BOARD ROOM

KITCHEN



CYCLE AND SHOWER FACILITIES



4 PIPE FAN COIL AIR CONDITIONING



CAT A AND FITTED ACCOMMODATION



MANNED RECEPTION



METAL TILED SUSPENDED CEILINGS



NEWLY REFURBISHED WC'S

4TH FLOOR EAST

5,369 SQ FT 499 SQ M

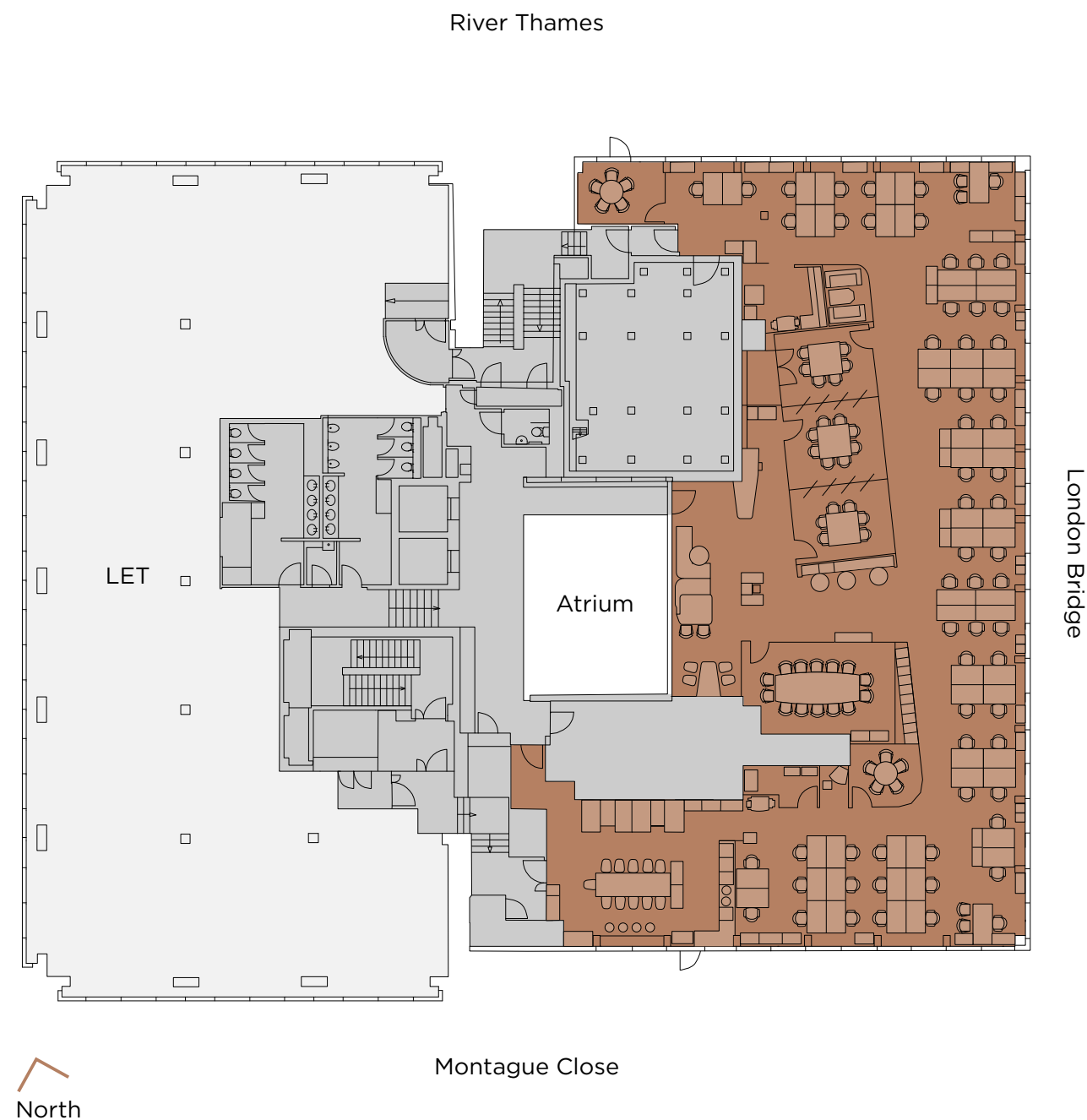

62 Open Plan Desks 1 Reception / Collaboration Room
 1 Kitchen / Breakout Area 2 Print Areas 1 Boardroom
 5 Meeting Rooms 72 Lockers

3RD FLOOR EAST

8,529 SQ FT 792.36 SQ M



The part 3rd floor East is currently being refurbished to a Category A condition to include a new metal tiled suspended ceiling and raised floors. The suite benefits from excellent natural light and views of the river Thames and City of London.

PERFECTLY POSITIONED

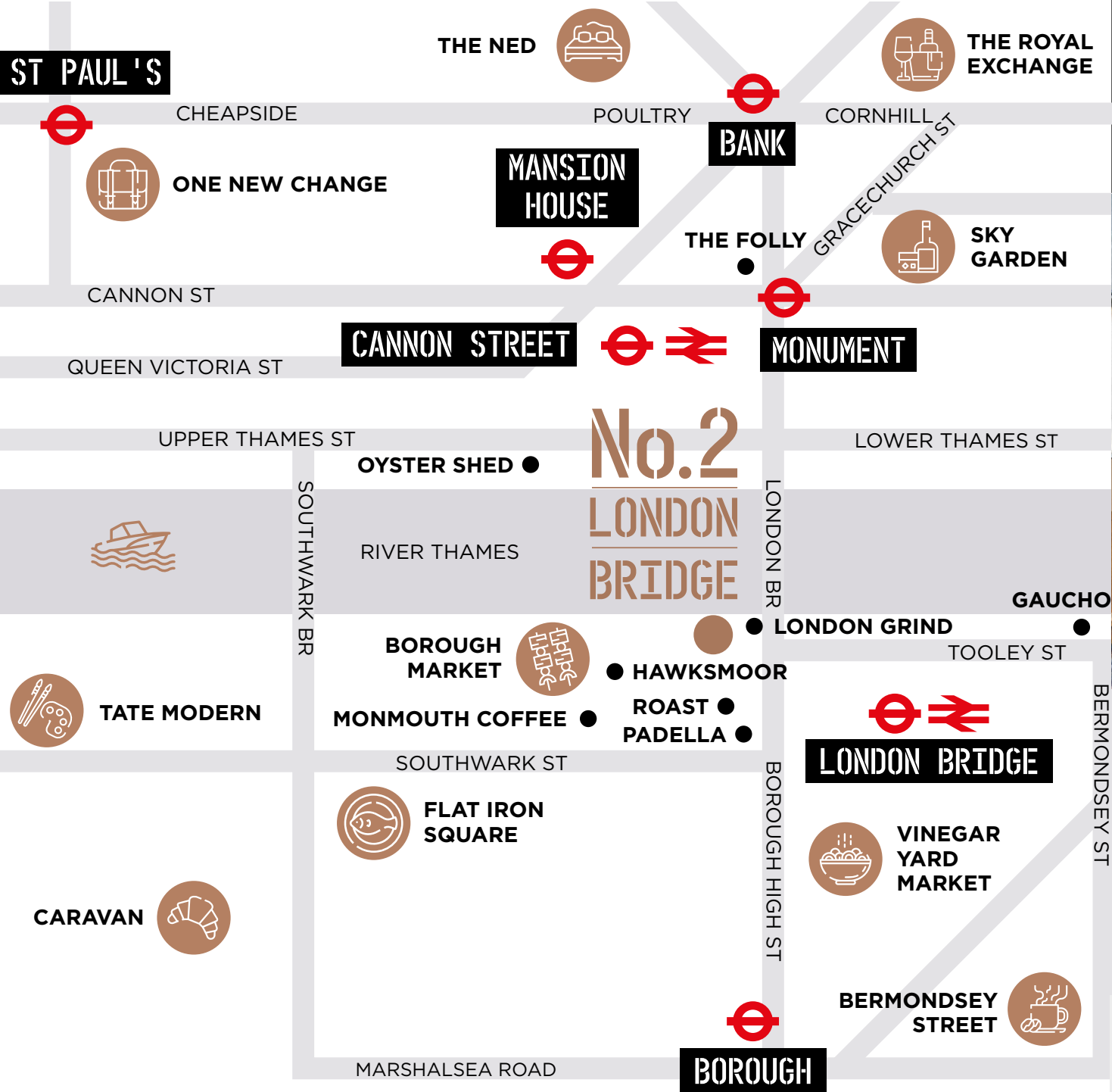

HIGH-END MEETS EDGY

Sitting equidistant between the luxurious restaurants and bars of The City and food markets of Borough, the building is in a prime position to enjoy an amazing range of options. It is also very well connected, with London Bridge Station, Blackfriars Station, Bank and Monument just moments away.



PLEASE CONTACT

SARAH SHELL

07808 290 853

020 7399 5708

sarah.shell@eu.jll.com



JASON COLLIER

07525 159 861

020 7399 5514

jason.collier@eu.jll.com

TOM BREMNER

07715 200 972

020 3296 4717

tom.bremner@cushwake.com



**CUSHMAN &
WAKEFIELD**

CORNELIA DE BOINVILLE

07787 506 029

020 3296 2013

cornelia.deboinvill@cushwake.com

JLL for themselves and for the vendors or lessors of this property whose agents they are, give notice that:- a. the particulars are set out as a general outline only for guidance and do not constitute, nor constitute part of, an offer or contract; b. all descriptions, dimensions, references to condition and necessary permissions for use and occupation, and other details are believed to be correct, but any intending purchasers, tenants or third parties should not rely on them as statements or representations of fact but satisfy themselves that they are correct by inspection or otherwise; c. All properties are measured in accordance with the RICS property measurement, 1st Edition May 2015 (incorporating IPMS) unless designated NIA/GIA/GEA, in which case properties are measured in accordance with the RICS Code of Measuring Practice (6th Edition); d. Any images may be computer generated. Any photographs show only certain parts of the property as they appeared at the time they were taken. November 2021.

Design and production: www.stuartchapmandesign.co.uk 020 3983 1665