



To Let

COMING SOON
Warehouse / distribution unit 2 mins
from M4 J.16

- Exceptional Transport Links
- 10m minimum eaves height
- 5x loading doors
- 24/7 onsite security
- Additional yard/open storage available
- Available December 2025

Unit 2 Clearwater Business Park

Swindon, SN5 8YZ

57,801 sq ft
5,369.75 sq m

Unit 2 Clearwater Business Park

Swindon, SN5 8YZ

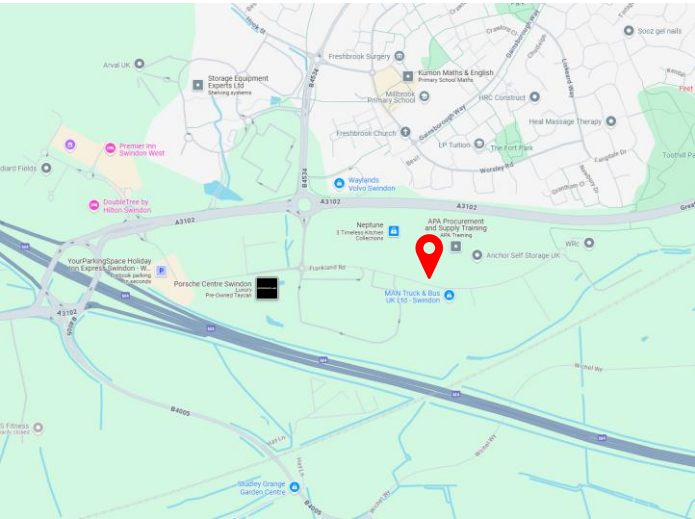
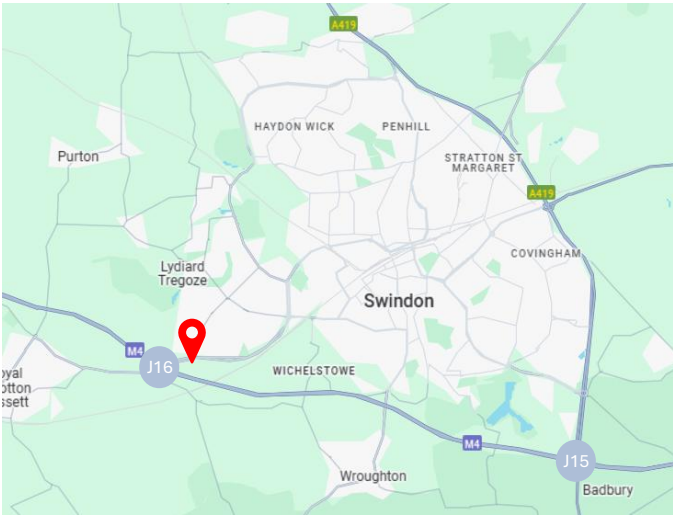

Description

Unit 2 comprises a semi-detached warehouse / distribution unit constructed around a steel portal frame.

The unit comprises open plan warehouse accommodation with 10m eaves and benefits from a covered canopy/loading area to the front and a separate office block and WCs. There are 5x loading doors (3 dock and 2 level access).

Externally, the unit benefits from a yard and allocated parking in front of the unit. There is also the option to lease an additional 0.5 acres of open storage/yard space elsewhere on the estate to provide additional parking.

The estate also benefits from secure gated access, 24/7 onsite security and CCTV monitoring.

If further space is required, the neighbouring Unit 3 is also available, providing an additional 13,980 sq ft of warehouse accommodation.

Specification

- Lighting – LED
- Minimum Eaves Height – 10m
- Dock Level Doors – 3
- Level Access Doors – 2
- Construction – Steel Portal Frame
- Utilities – electric & water. No gas.

Location

Clearwater Business Park is a secure commercial estate located within the established Blagrove Industrial Estate.

The estate is excellently located being just 2 mins from M4 J.16 providing access to the east and west. It is also just 4 miles from Swindon Town Centre & Swindon Railway Station.

The estate is a hub of notable occupiers and car dealerships including MAN Truck & Bus, Ferrari, Maserati, Catalent, CHEP, Grant and Anchor Storage.

Accommodation

The property comprises the following areas:

Name	Sq ft	Sq m	Availability
Warehouse	46,595	4,328.68	Available Dec 25
Covered loading bay	7,227	671.42	Available Dec 25
Office & ancillary	3,979	369.65	Available Dec 25
Total	57,801	5,369.75	

Unit 2 Clearwater Business Park

Swindon, SN5 8YZ

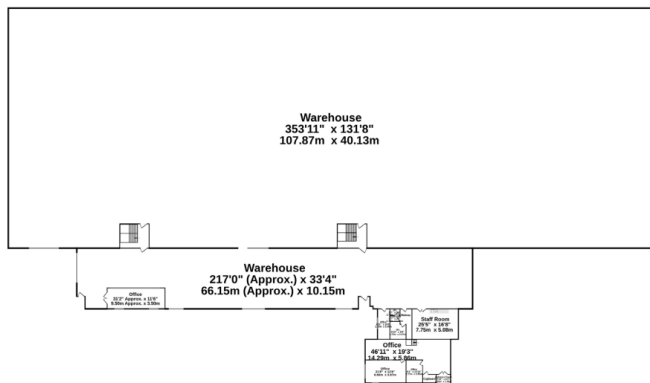

EPC

The property has an EPC rating of B(42)

Tenure

The unit is available on full repairing and insuring lease terms.

Rent

Quoting rent £350,000 per annum (exclusive of VAT)

VAT

All costs are subject to VAT where applicable

Legal Costs

The incoming tenant is to make a contribution of £1,500+VAT towards the landlord's legal costs.

Rateable Value

The property has a rateable value of £262,500

Service Charge

A service charge is levied for the up keep of communal areas

Contacts:

Sophie Parsons

07709 507 300

Sophie.parsons@jll.com

Chris Yates

07850 658 050

Chris.Yates@jll.com

JLL for themselves and for the vendors or lessors of this property whose agents they are, give notice that:- a. the particulars are set out as a general outline only for guidance and do not constitute, nor constitute part of, an offer or contract; b. all descriptions, dimensions, references to condition and necessary permissions for use and occupation, and other details are believed to be correct, but any intending purchasers, tenants or third parties should not rely on them as statements or representations of fact but satisfy themselves that they are correct by inspection or otherwise; c. no person in the employment of JLL has any authority to make or give any representation or warranty whatever in relation to the property; d. Any images may be computer generated. Any photographs show only certain parts of the property as they appeared at the time they were taken. For properties in Scotland: e. This correspondence is expressly subject to completion of formal legal missives in accordance with Scots Law. Financial Crime: In accordance with the Money Laundering, Terrorist Financing and Transfer of Funds Regulations 2017 and Proceeds of Crime Act 2002 Jones Lang LaSalle may be required to establish the identity and source of funds of all parties to property transactions. © 2023 Jones Lang LaSalle IP, Inc. Jones Lang LaSalle Limited, Registered in England and Wales Number 1188567 Registered office: 30 Warwick Street London W1B 5NH. June 2025