

Unit 10 Oakwood Trade Park
Crawley, RH10 9AZ
///elder.line.song

3,182 sq ft / 295.6 sq m
Comprehensively Refurbished
Targeting EPC A



Industrial space.
Made better.

3,182 sq ft. Industrial / Trade Counter Unit. Available now.



Unit 10

GATWICK ROAD

CRAWLEY ↘

Asset managed by:
ARGO
Real Estate Limited

Better industrial space. Full stop.

Unit 10 at Oakwood Trade Park provides 3,182 sq ft of excellent industrial or trade counter space.

It makes sense to work somewhere that reflects your ambitions. That's why Unit 10 has been transformed into top-of-the-line space.

Ideal as a last-mile logistics hub or a trade counter, this space is ready to deliver on all fronts.



1 Level Access Loading Door



21m Deep Yard

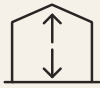

5.5m Clear Height



8 Parking Spaces



24/7 Access

Oakwood Trade Park is just four minutes from London Gatwick. The M23 provides direct access to London and the M25, offering excellent regional and national road links.

Road

M23 J10	1 Mile	3 Mins
M25	12 Miles	20 Mins
Croydon	21 Miles	35 Mins
Brighton	26 Miles	37 Mins

Rail & Air

Crawley Train Station	➔	0.2 Miles
Gatwick Airport		1 Mile
Heathrow Airport		42 Miles

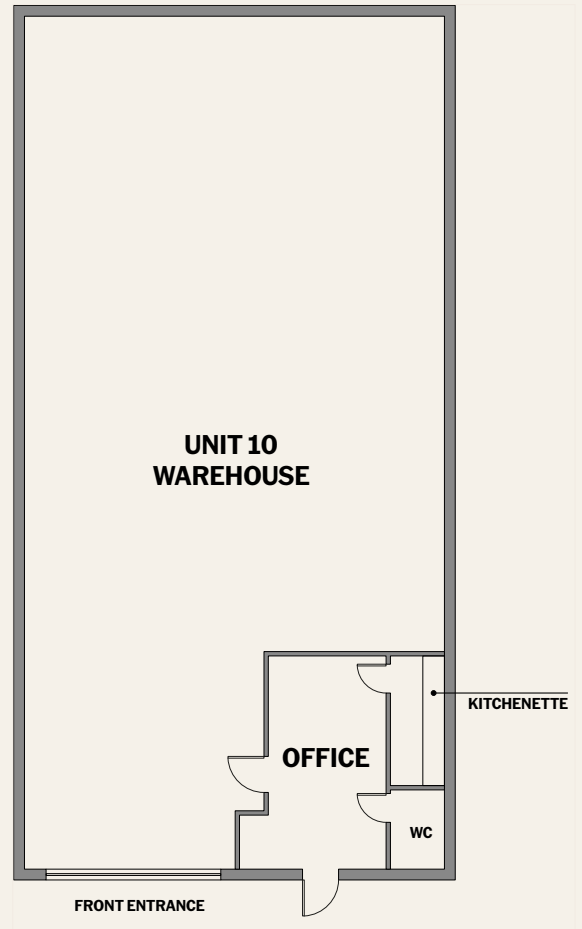

Warehouse - 2,948 sq ft - 273.9 sq m

Office - 234 sq ft - 21.7 sq m

Total - 3,182 sq ft - 295.6 sq m



Peter Davidson
peter.davidson@jll.com
+44 (0) 7920 597 574

Seb Deacon Jackson
s.deacon-Jackson@jll.com
+44 (0) 7711 938 967

Oliver Hockley
oliver.hockley@jll.com
+44 (0) 7704 687 459

FTDJOHNS

Michael Deacon-Jackson
mdj@ftdjohns.co.uk
+44 (0) 7939 136 295

dotindustrial.co.uk