

LEGEND

- Workspace
- Reception
- Meeting Room
- Communal
- Storage
- Circulation
- Phone Booths
- IT/ Comms
- Toilets
- Building Core

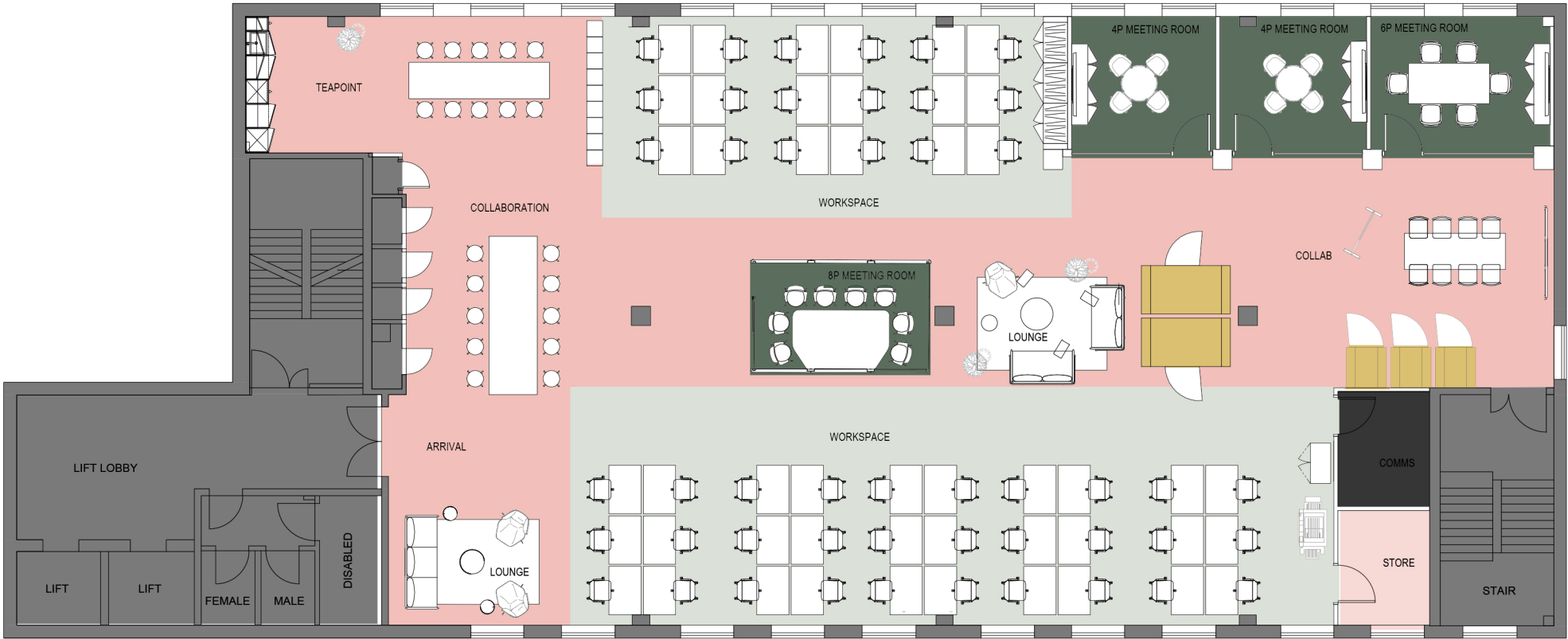

All designs are the sole property of Knotel Inc. and may not be used, transferred, or disclosed to a third party without their express permission. No dimensions or other information should be inferred from the electronic copy unless specifically shown on the hard copy drawings or specifications. Do not scale from this drawing. Figured dimensions only are to be used for Construction and any scaling of the drawing will be at the Contractor's risk. Contractor to verify all dimensions, levels and components on-site. Any discrepancies shall be addressed in writing to Knotel Inc. for clarification prior to the commencement of the work, otherwise to Contractor shall bear the full responsibility for any associated cost. Any claims for variations or extras shall be submitted to Knotel Inc. for assessment prior to approval of any such variation or extra. This drawing is to be read in conjunction with all other contract documentation.

GENERAL NOTES



DAY 2 DESK

REVISIONS

ID	NAME	DATE	COMMENTS
----	------	------	----------

FLOORPLAN

PROPERTY ADDRESS
LEVEL 3
49 SOUTHWARK BRIDGE ROAD, LONDON, SE1 9HH

RENTABLE SIZE 4,492 Sqft	SCALE 1:150 @A3
-----------------------------	--------------------

DRAWN BY EN	CHECKED BY HT
----------------	------------------

FILE NAME
KNOTEL GENERAL ARRANGEMENT PLAN - LEVEL 03

KNOTEL

Square Footage

Net Internal Area	(sqft)	4,492
-------------------	--------	-------

Workplace Strategy

Collaboration Seats	18
Dedicated Workstations	48
Enclosed Meeting Seats	22

Room Counts

WORKSPACE		COMMUNAL		PHONE BOOTHS	
WORKSPACE	2	COLLABORATION	2	(1P) PHONE BOOTH	3
RECEPTION		LOUNGE	2	(2P) PHONE BOOTH	2
ARRIVAL	1	TEA POINT	1	IT/ COMMS	
MEETING				IT/ COMMS ROOM	1
MEETING ROOM (4P)	2	STORAGE		TOILETS	
MEETING ROOM (6P)	1	KNOTEL STORE	1	ACCESSIBLE TOILET	1
MEETING ROOM (8P)	1	MEMBERS STORE	1	M/F TOILET	2